

DATE	
BY	
FINAL SURVEY	SURVEYED
NOTE BOOK	PLOTTED
NO.	TEMPLATE
	AREAS CHECKED

DATE	
BY	
ORIGINAL SURVEY	SURVEYED
NOTE BOOK	PLOTTED
NO.	TEMPLATE
	AREAS CHECKED

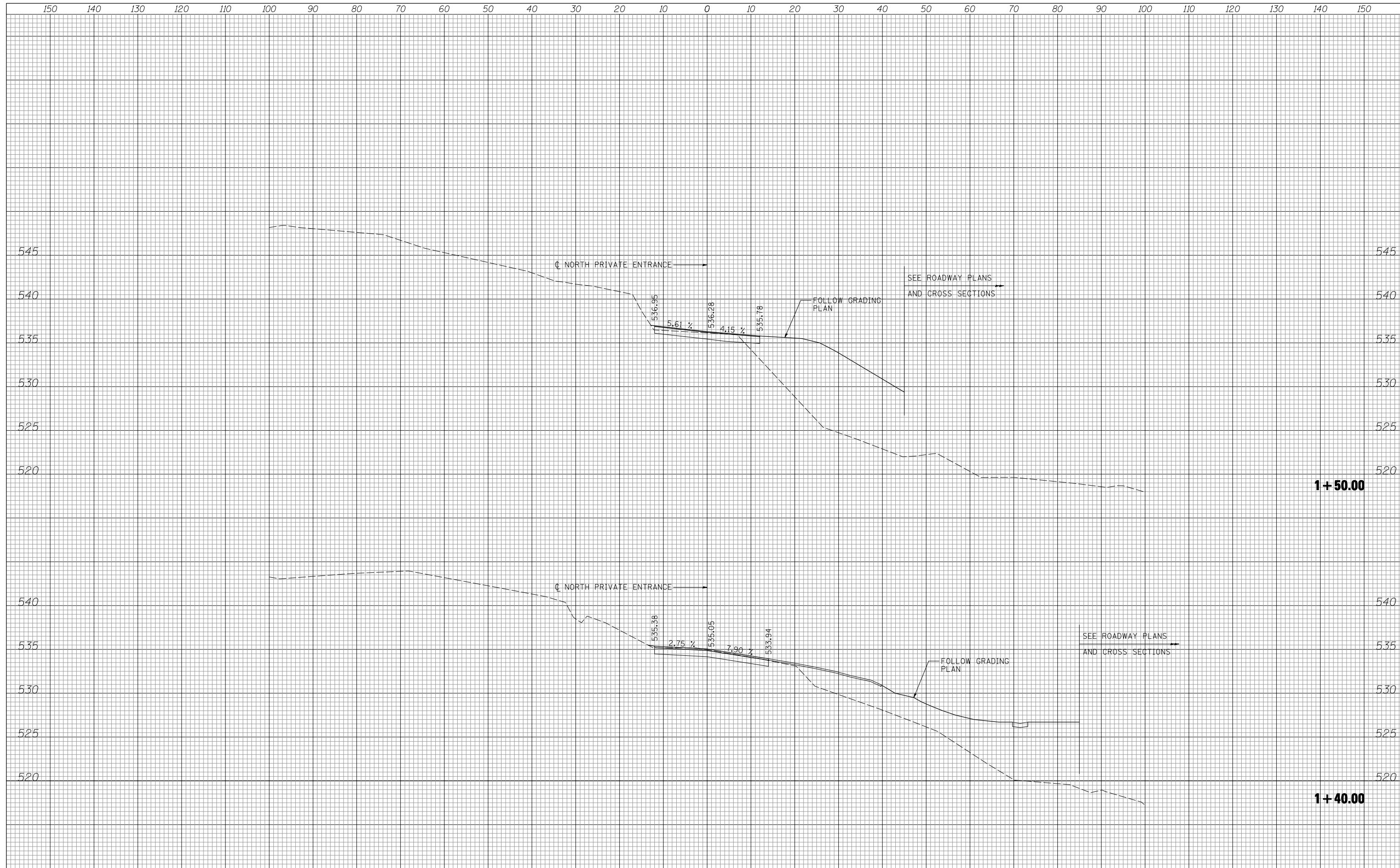

FILE NAME = ...D672867-shr-xshxht-NorthPE.dgn  
 \*MODELNAME\*

USER NAME = Plotted by Roadways7	DESIGNED - RC	REVISIED -
	DRAWN - RC	REVISIED -
PLOT SCALE = 20.0000' / IN.	CHECKED - AS	REVISIED -
PLOT DATE = 10/19/2012	DATE - 10/2012	REVISIED -

**STATE OF ILLINOIS  
DEPARTMENT OF TRANSPORTATION**

**IL ROUTE 96 OVER INLET DITCH  
NORTH PE CROSS SECTIONS**  
 SCALE: 1"=10'H, 5'V SHEET 02 OF 03 SHEETS STA. 1+40.00 TO STA. 1+50.00

F.A.P. RTE.	SECTION	COUNTY	TOTAL SHEETS	SHEET NO.
510	510	HANCOCK	38	37
FED. ROAD DIST. NO. 6 ILLINOIS FED. AID PROJECT			CONTRACT NO. 72B67	