

LEGEND

- ① PR PREFORMED PLASTIC PAVEMENT MARKING, TYPE B-INLAID-LETTERS & SYMBOLS
 - ② PR PREFORMED PLASTIC PAVEMENT MARKING, TYPE B-INLAID-LINE 5" (WHITE SKIP DASH)
 - ③ PR PREFORMED PLASTIC PAVEMENT MARKING, TYPE B-INLAID-LINE 5" (YELLOW SKIP DASH)
 - ④ PR PREFORMED PLASTIC PAVEMENT MARKING, TYPE B-INLAID-LINE 6" (SOLID WHITE)
 - ⑤ PR PREFORMED PLASTIC PAVEMENT MARKING, TYPE B-INLAID-LINE 6" (WHITE 2' DASH 6' SKIP)
 - ⑥ PR PREFORMED PLASTIC PAVEMENT MARKING, TYPE B-INLAID-LINE 8" (GORE, ISLAND AREAS)
 - ⑦ PR PREFORMED PLASTIC PAVEMENT MARKING, TYPE B-INLAID-LINE 12" (SOLID, ISLAND AREAS)
 - ⑧ PR PREFORMED PLASTIC PAVEMENT MARKING, TYPE B-INLAID-LINE 12" (CHEVRON, YELLOW)
 - ⑨ PR THERMOPLASTIC PAVEMENT MARKING LINE 5" (WHITE)
 - ⑩ PR THERMOPLASTIC PAVEMENT MARKING LINE 5" (YELLOW)
 - ⑪ PR THERMOPLASTIC PAVEMENT MARKING LINE 5" (YELLOW CENTER LINE)
 - ⑫ PR THERMOPLASTIC PAVEMENT MARKING LINE 5" (YELLOW SKIP DASH)
- ▨ PR PREFORMED PLASTIC PAVEMENT MARKING, TYPE B-INLAID-LINE 24"

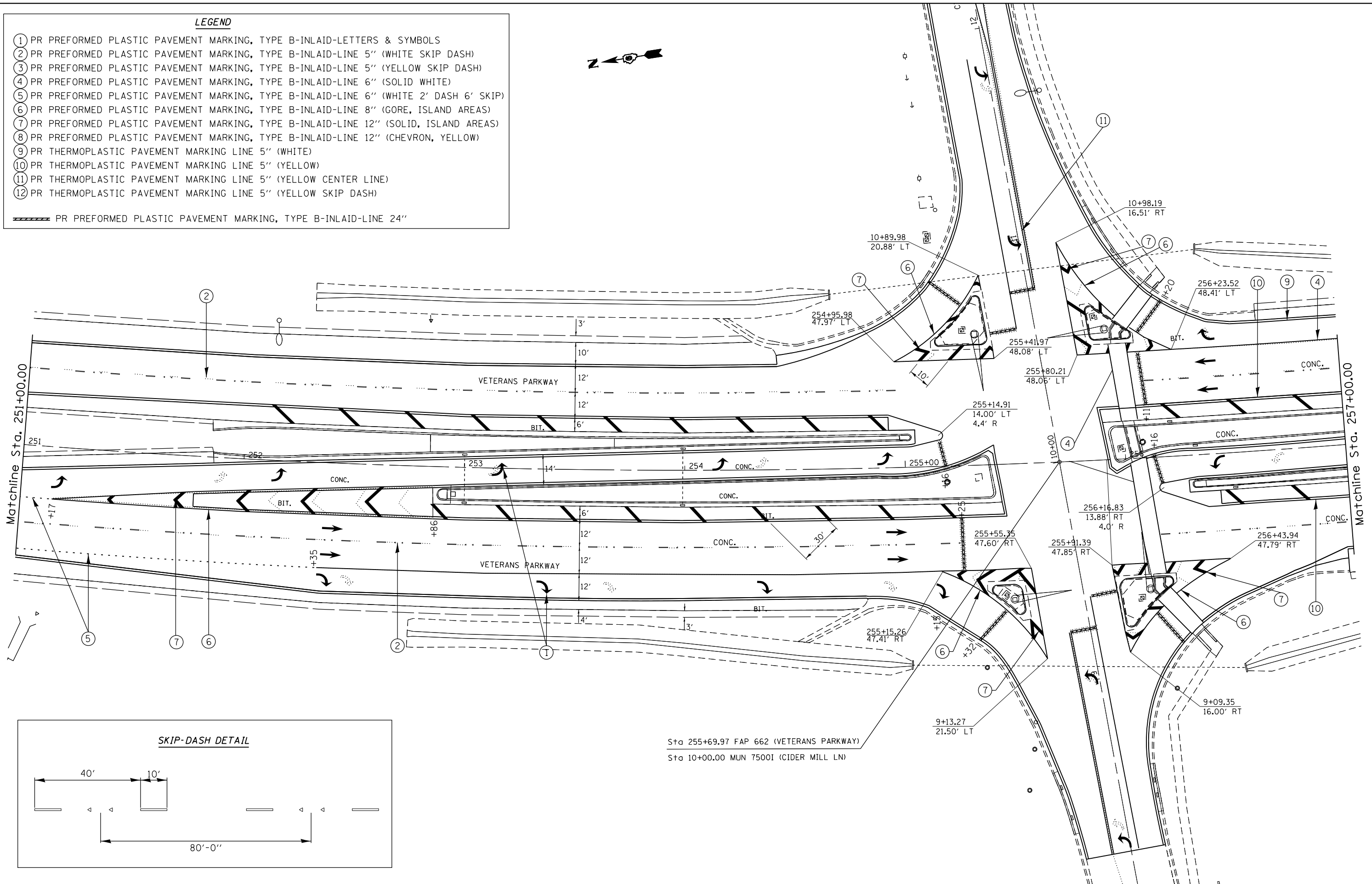

SKIP-DASH DETAIL

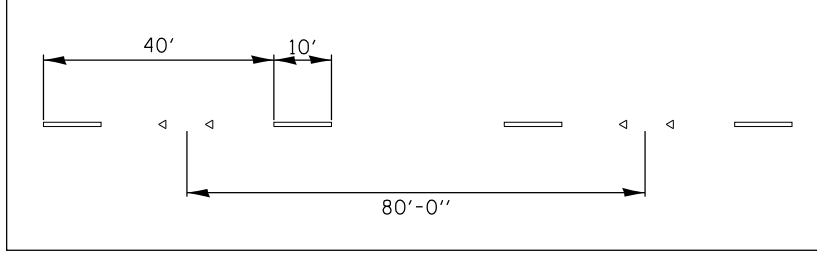

Sta 255+69.97 FAP 662 (VETERANS PARKWAY)
Sta 10+00.00 MUN 75001 (CIDER MILL LN)

FILE NAME =	USER NAME = sparksgw	DESIGNED -	REVISED -
ct:\pw\work\p\dtdot\sparksgw\10290859\0672\F32-sht-pmk_2.dgn		DRAWN -	REVISED -
Default	PLOT SCALE = 40.0000' / in.	CHECKED -	REVISED -
	PLOT DATE = Oct-19-2012 03:56:11PM	DATE -	REVISED -

**STATE OF ILLINOIS
DEPARTMENT OF TRANSPORTATION**

**PAVEMENT MARKING SHEETS
FAP 662 (IL 4)**

SCALE: SHEET OF SHEETS STA. TO STA.

F.A.P. RTE.	SECTION	COUNTY	TOTAL SHEETS	SHEET NO.
1(RS),2(RS),5(RS-6)		SANGAMON	116	69
			CONTRACT NO. 72F23	
ILLINOIS FED. AID PROJECT				