

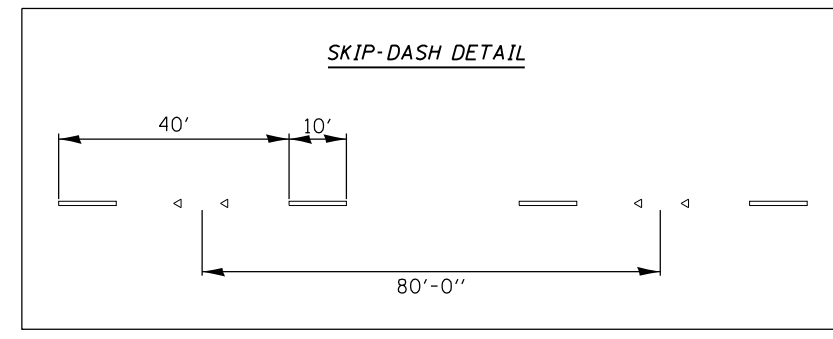

Sta 255+69.97 FAP 662 (VETERANS PARKWAY)
 Sta 10+00.00 MUN 7500I (CIDER MILL LN)

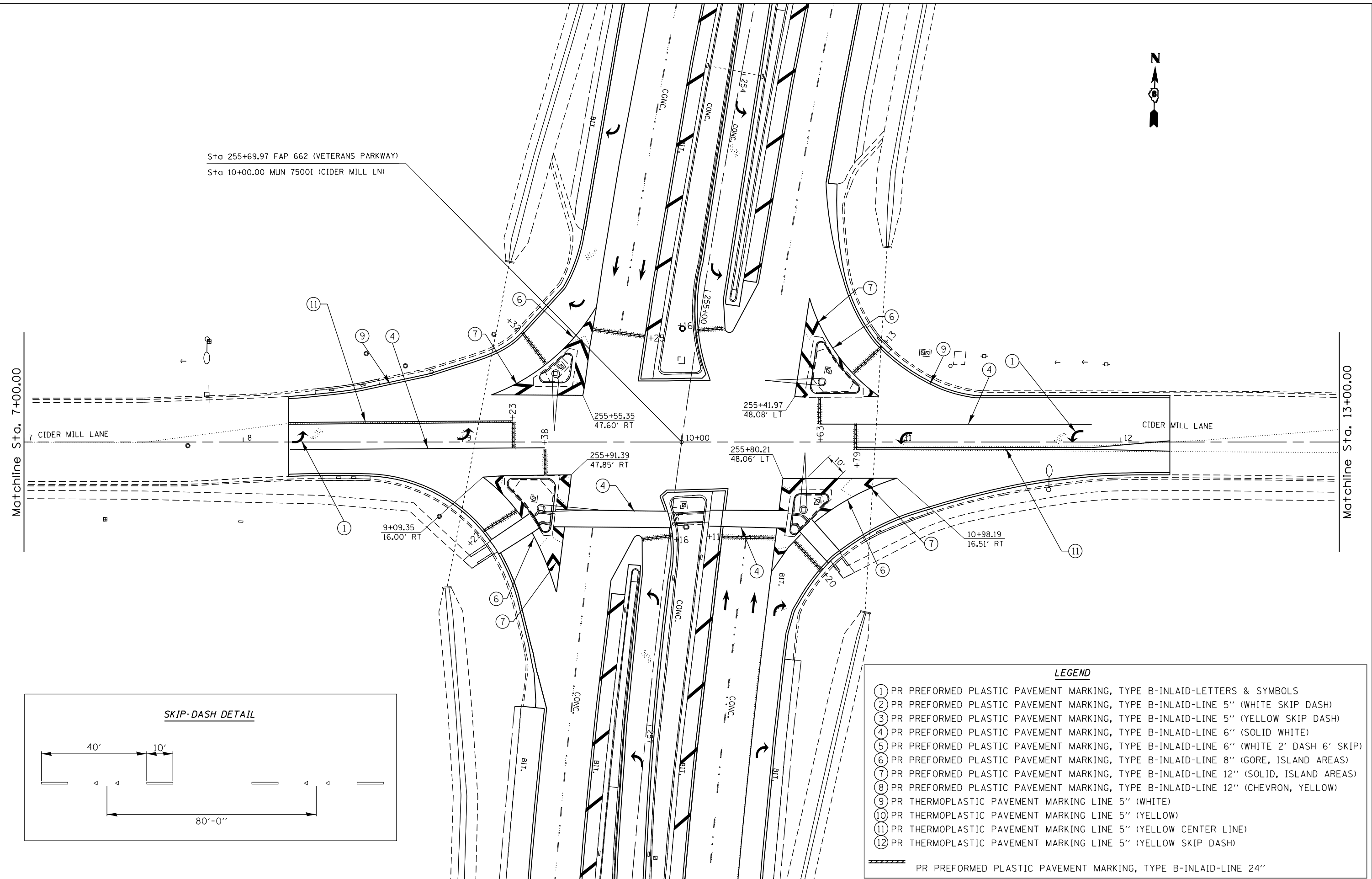

LEGEND

- ① PR PREFORMED PLASTIC PAVEMENT MARKING, TYPE B-INLAID-LETTERS & SYMBOLS
- ② PR PREFORMED PLASTIC PAVEMENT MARKING, TYPE B-INLAID-LINE 5" (WHITE SKIP DASH)
- ③ PR PREFORMED PLASTIC PAVEMENT MARKING, TYPE B-INLAID-LINE 5" (YELLOW SKIP DASH)
- ④ PR PREFORMED PLASTIC PAVEMENT MARKING, TYPE B-INLAID-LINE 6" (SOLID WHITE)
- ⑤ PR PREFORMED PLASTIC PAVEMENT MARKING, TYPE B-INLAID-LINE 6" (WHITE 2' DASH 6' SKIP)
- ⑥ PR PREFORMED PLASTIC PAVEMENT MARKING, TYPE B-INLAID-LINE 8" (GORE, ISLAND AREAS)
- ⑦ PR PREFORMED PLASTIC PAVEMENT MARKING, TYPE B-INLAID-LINE 12" (SOLID, ISLAND AREAS)
- ⑧ PR PREFORMED PLASTIC PAVEMENT MARKING, TYPE B-INLAID-LINE 12" (CHEVRON, YELLOW)
- ⑨ PR THERMOPLASTIC PAVEMENT MARKING LINE 5" (WHITE)
- ⑩ PR THERMOPLASTIC PAVEMENT MARKING LINE 5" (YELLOW)
- ⑪ PR THERMOPLASTIC PAVEMENT MARKING LINE 5" (YELLOW CENTER LINE)
- ⑫ PR THERMOPLASTIC PAVEMENT MARKING LINE 5" (YELLOW SKIP DASH)

▬▬▬ PR PREFORMED PLASTIC PAVEMENT MARKING, TYPE B-INLAID-LINE 24"

FILE NAME =	USER NAME = sparksgw	DESIGNED -	REVISED -
et:\pw\work\p\id\sparksgw\10290859\0672\F32-sht-pmk_2.dgn		DRAWN -	REVISED -
Default	PLOT SCALE = 40.0000' / in.	CHECKED -	REVISED -
	PLOT DATE = Oct-19-2012 03:56:22PM	DATE -	REVISED -

**STATE OF ILLINOIS
 DEPARTMENT OF TRANSPORTATION**

**PAVEMENT MARKING SHEETS
 FAP 67 (IL 97)**

F.A.P. RTE.	SECTION	COUNTY	TOTAL SHEETS	SHEET NO.
	1(RS),2(RS),5(RS-6)	SANGAMON	116	83
CONTRACT NO. 72F23				
ILLINOIS FED. AID PROJECT				

SCALE: SHEET OF SHEETS STA. TO STA.