

SECTION D-D THRU BRIDGE PARAPET

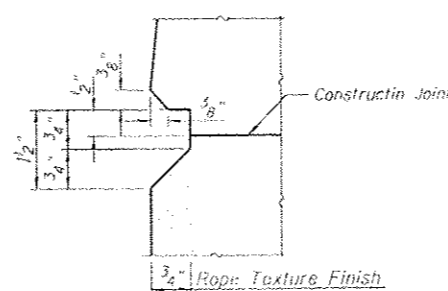

DETAIL A

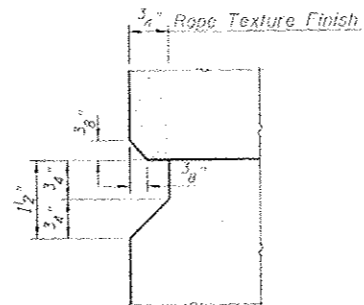

DETAIL B

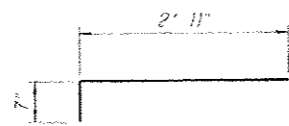

BAR b (E)

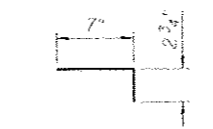

#5 BAR u (E)

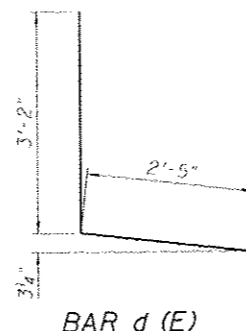

BAR d (E)

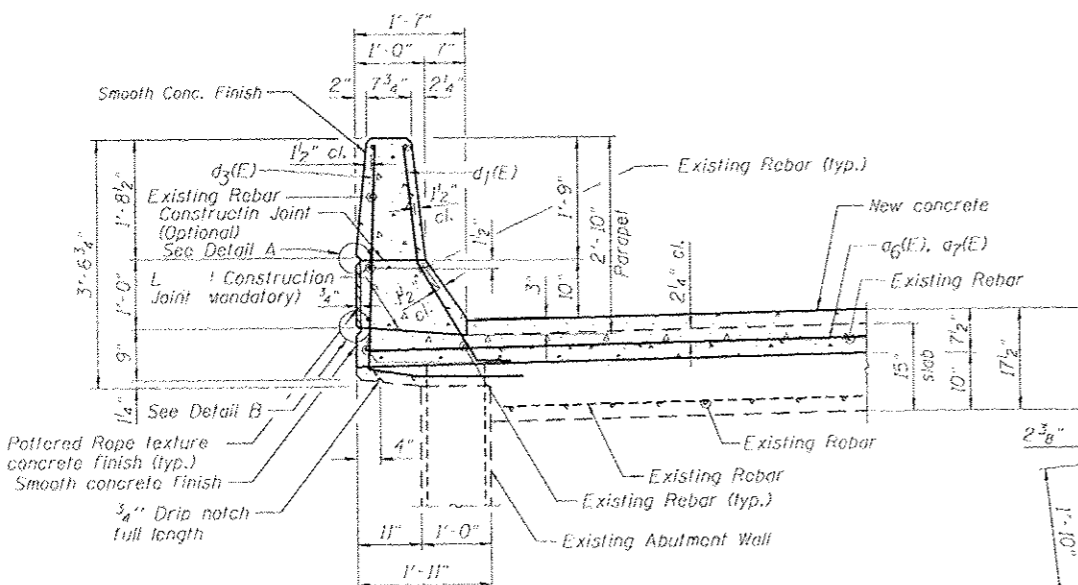

SECTION C-C THRU ABUTMENT PARAPET

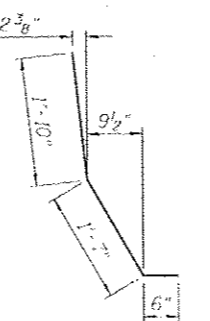

BAR d1 (E)

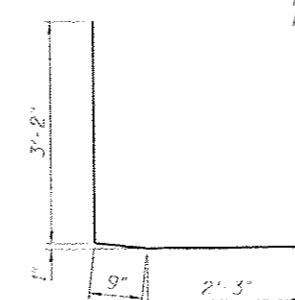

BAR d3 (E)

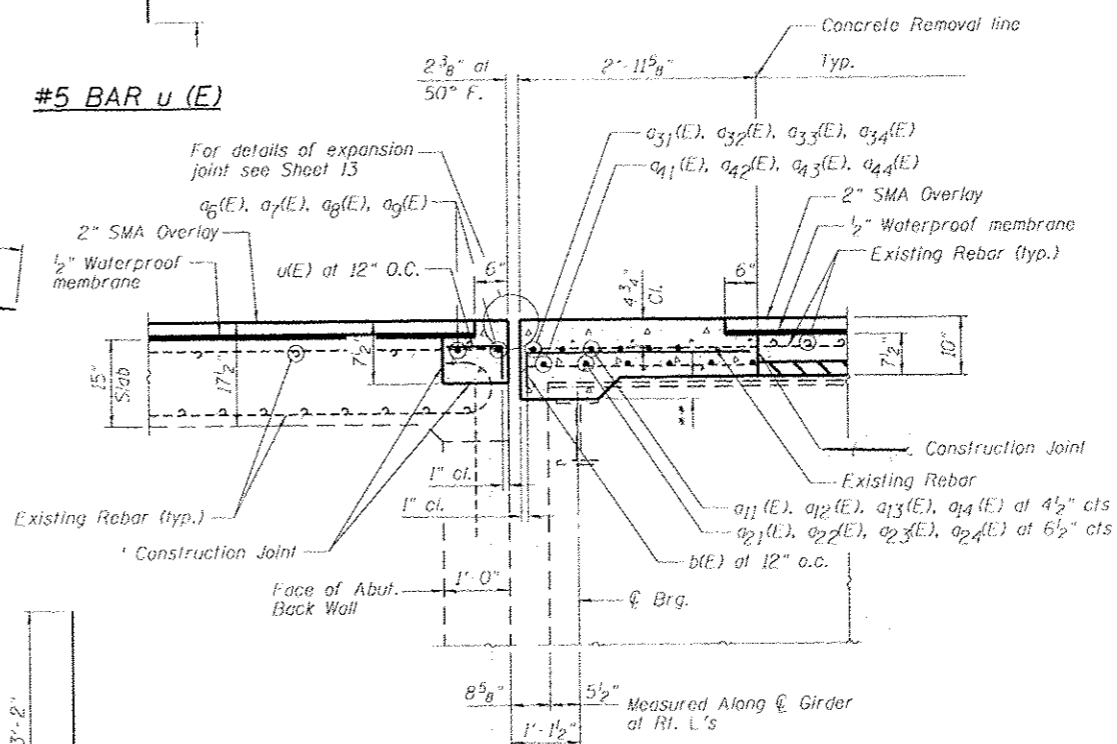

SECTION B-B

NORTH ABUTMENT
BILL OF MATERIAL

Bar	No.	Size	Length	Shape
a6(E)	4	#5	23'-1"	
a8(E)	2	#5	28'-4"	
a11(E)	14	#5	23'-7"	
a13(E)	7	#5	29'-4"	
a21(E)	10	#5	23'-7"	
a23(E)	5	#5	29'-4"	
a31(E)	2	#6	23'-10"	
a33(E)	1	#6	29'-4"	
a41(E)	2	#6	23'-10"	
a43(E)	1	#6	29'-4"	
b(E)	72	#5	3'-6"	
u(E)	12	#5	1'-4"	
d(E)	12	#4	5'-2"	L
d1(E)	12	#5	3'-11"	L
d3(E)	4	#4	6'-2"	L
Item		Unit	Quantity	
Reinforcement Bars, Epoxy Coated		Pound	1800	
Bar Splicers		Each	16	

SOUTH ABUTMENT
BILL OF MATERIAL

Bar	No.	Size	Length	Shape
a7(E)	2	#5	31'-10"	
a9(E)	2	#5	28'-4"	
a12(E)	7	#5	32'-10"	
a14(E)	7	#5	29'-4"	
a22(E)	5	#5	32'-10"	
a24(E)	5	#5	29'-4"	
a32(E)	1	#6	32'-10"	
a34(E)	1	#6	29'-4"	
a42(E)	1	#6	32'-10"	
a44(E)	1	#6	29'-4"	
b(E)	61	#5	3'-4"	
u(E)	61	#5	1'-4"	
d(E)	12	#4	5'-2"	L
d1(E)	12	#5	3'-11"	L
d3(E)	4	#4	6'-2"	L
Item		Unit	Quantity	
Reinforcement Bars, Epoxy Coated		Pound	1500	
Bar Splicers		Each	16	

** Height of corbel varies
Elevation of end diaphragm
constant between all girders.

8/24/2012 10:26:05 PM - C:\CEN\0033\B-1\0602\0201\06020201\06020201-Deck-Joint-Details-NB.dwg

FILE NAME: 06020201-Deck-Joint-Details-NB.dwg
 USER NAME: DMG
 PLOT SCALE: 2/8" = 1'-0"
 PLOT DATE: 8/24/2012

DESIGNED - WAE	REVISD -
CHECKED - FAS	REVISD -
DRAWN - DMG	REVISD -
CHECKED - SLZ	REVISD -

STATE OF ILLINOIS
DEPARTMENT OF TRANSPORTATION

DECK JOINT DETAILS NORTH BOUND
STRUCTURE NO. 060-0206 (NB)
SHEET NO. 8 OF 17 SHEETS

F.A.I. RTE. 255	SECTION 60-(7.8) RS-2	COUNTY MADISON	TOTAL SHEETS 261	SHEET NO. 218
CONTRACT NO. 76A89			ILLINOIS FED. AID PROJECT	

