

CONCRETE REMOVAL
(NB South Abutment shown)

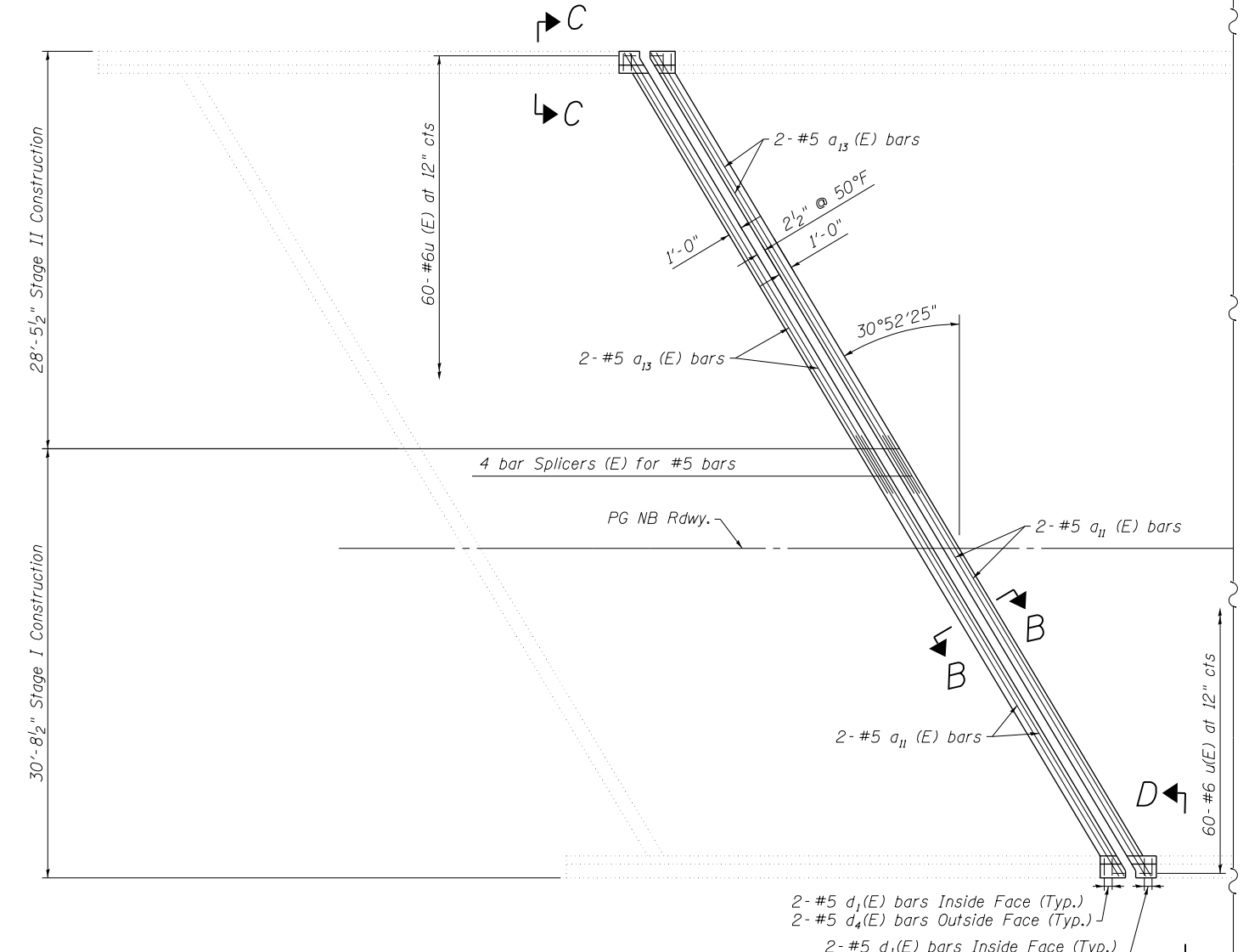

CONCRETE REPLACEMENT
(NB South Abutment shown)

NOTES:

- Existing reinforcement extending into the removal area shall be cleaned, straightened and incorporated into the new construction. Any reinforcement bars that are damaged during concrete removal shall be replaced with an approved bar splicer or anchorage system. Cost shall be included with Concrete Removal.
- Trim existing reinforcement to accommodate proposed expansion joint.
- See sheet 11 for section A-A, B-B, C-C and D-D.
- Bars indicated thus: "4x2-#5 etc...", indicates 4 lines of bars with 2 lengths per line.

BILL OF MATERIAL

Item	Unit	Total
Concrete Removal	Cu. Yd.	3.4
Concrete Superstructure	Cu. Yd.	3.8
Protective Coat	Sq. Yd.	8

MIN. LAP
#5 Bar 2'-7" Min. Lap.
#6 Bar 3'-1" Min. Lap.

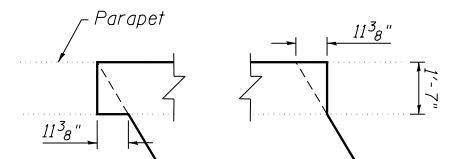

DETAIL C

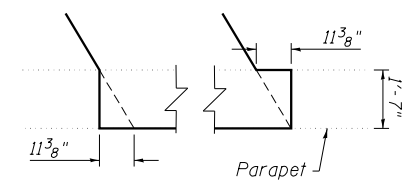

DETAIL D

LEGEND
 Concrete Removal

8/24/2012 10:07:23 PM - G:\CHIN\0013\Bridges\CADD\060-0214\0253\0600214-76A89-06-S.Abut.Exp.Joint_NB.dgn

FILE NAME = 0600214-76A89-06-S.Abut.Exp.Joint_NB.dgn



USER NAME = DMGoias	DESIGNED - WAE	REVISED -
PLOT SCALE = 1/8" = 1' / in.	CHECKED - FAS	REVISED -
PLOT DATE = 8/24/2012	DRAWN - DMG	REVISED -
	CHECKED - SLZ	REVISED -

STATE OF ILLINOIS
DEPARTMENT OF TRANSPORTATION

SOUTH ABUTMENT EXPANSION JOINT CONCRETE
STRUCTURE NO. 060-0214

SHEET NO. 6 OF 16 SHEETS

F.A.I. RTE.	SECTION	COUNTY	TOTAL SHEETS	SHEET NO.
255	60-(7,8) RS-2	MADISON	261	233
CONTRACT NO. 76A89				

ILLINOIS FED. AID PROJECT