

**TOTAL BILL OF MATERIAL**

ITEM	UNIT	SUPER	SUB	TOTAL
Fabric Formed Concrete Revetment Mat	Sq. Yd.		328	328
Structure Excavation	Cu. Yd.		414	414
Concrete Structures	Cu. Yd.	51.6	79.6	131.2
Concrete Superstructure	Cu. Yd.	605.8		605.8
Bridge Deck Grooving	Sq. Yd.	978		978
Protective Coat	Sq. Yd.	1,426		1,426
Furnishing and Erecting Structural Steel	L Sum			
Stud Shear Connectors	Each	3,906		3,906
Reinforcement Bars, Epoxy Coated	Pound	127,440	11,170	138,610
Bar Splicers	Each	174		174
Furnishing Metal Shell Piles 14" x 0.312"	Foot		2,028	2,028
Driving Piles	Foot		2,028	2,028
Test Pile Metal Shells	Each		4	4
Name Plates	Each	2		2
Anchor Bolts, 1"	Each	56		56
Geocomposite Wall Drain	Sq. Yd.		174	174
Geotextile Retaining Wall	Sq. Ft.		2,001	2,001
Pipe Underdrains for Structures 4"	Foot		314	314
Porous Granular Embankment, Special	Cu. Yd.		334	334

STATION 623+23.94  
 BUILT 20... BY  
 STATE OF ILLINOIS  
 F.A.P. RT. 788 SEC. 520-1-2B  
 LOADING HL-93  
 STRUCTURE NO. 082-0385

**NAME PLATE**  
 See Std. 515001

STATION 623+23.94  
 BUILT 20... BY  
 STATE OF ILLINOIS  
 F.A.P. RT. 788 SEC. 520-1-2B  
 LOADING HL-93  
 STRUCTURE NO. 082-0386

**NAME PLATE**  
 See Std. 515001

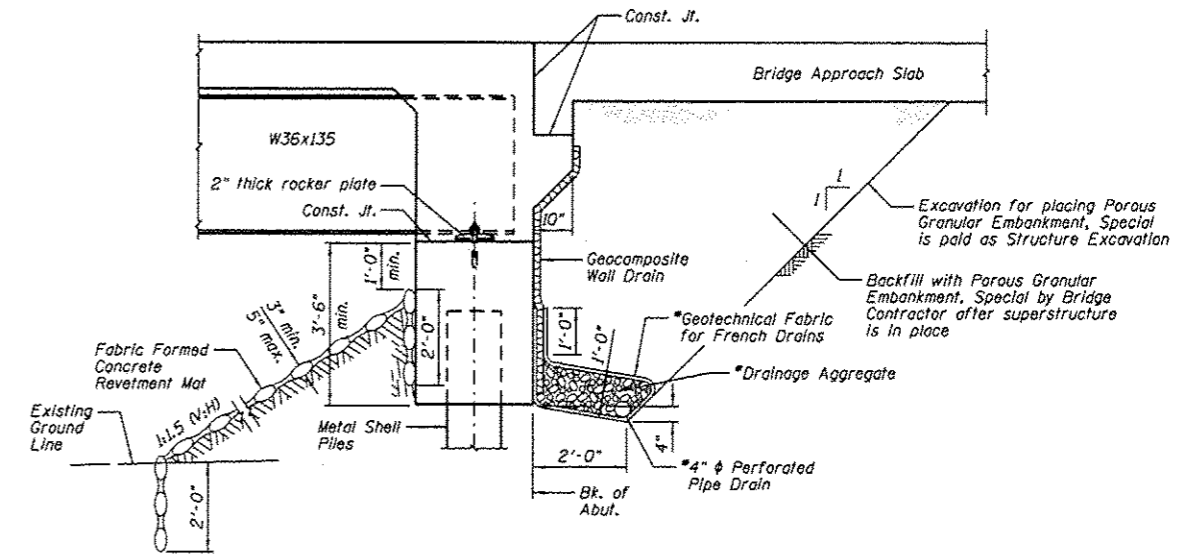

**SECTION THRU NORTH ABUTMENTS**  
 (Similar for South Abutments)

- NOTES:**
- Horizontal dimensions @ Rt. L's to Abutment.
  - Included in the cost of Pipe Underdrains for Structures 4".
  - All drainage system components shall extend to 2'-0" from the end of each wingwall except an outlet pipe shall extend until intersecting with the side slopes (1:3 V:H) embankment slopes only). The pipes shall drain into concrete headwalls. (See Article 601.05 of the Standard Specifications and Highway Standard 601(01))

**GENERAL NOTES:**

- Fasteners shall be AASHTO M164 Type 1, mechanically galvanized bolts in painted areas and M164 Type 3 in unpainted areas. Bolts 7/8 in.  $\phi$ , holes 1 1/16 in.  $\phi$ , unless otherwise noted.
- Calculated weight of Structural Steel = 132,250 lbs.
- All structural steel shall be AASHTO M270 Grade 50W.
- No field welding is permitted except as specified in the contract documents.
- Reinforcement bars designated (E) shall be epoxy coated.
- Structural steel shall only be painted for a distance equal to the depth of embedment into the concrete cap plus 3 in. Painted areas shall be primed in the shop with a Department approved zinc rich primer. Field painting will not be required.
- The embankment configuration shown shall be placed and compacted prior to construction of the abutments.
- Slipforming of parapets is not allowed.
- Wick Drains shall be used to expedite the embankment settlement. See Roadway Plans for quantities, layout and locations.

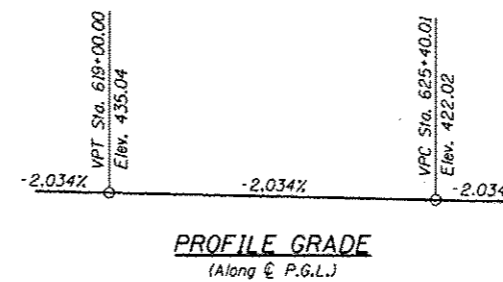
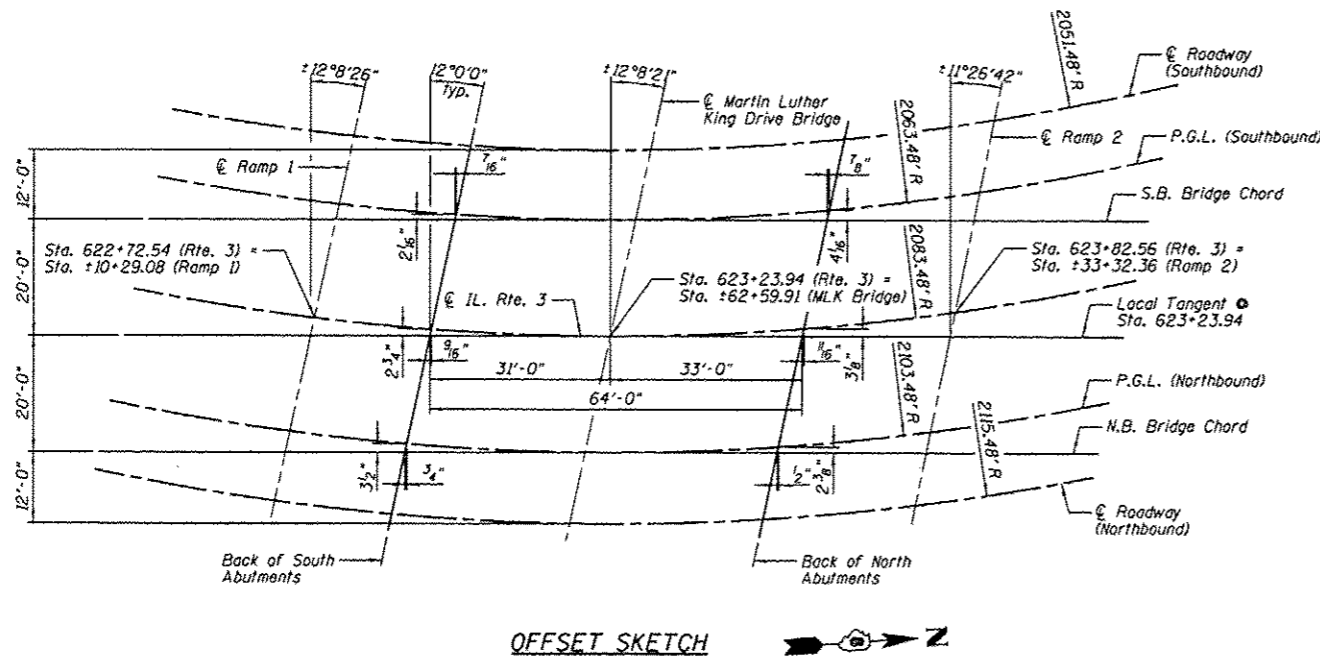

**RAMP 1 PROFILE GRADE**  
 (Along & P.G.L.)

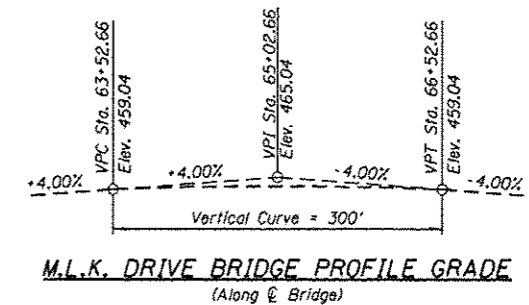

**M.L.K. DRIVE BRIDGE PROFILE GRADE**  
 (Along & Bridge)

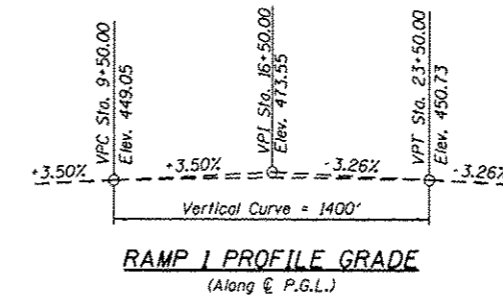

**RAMP 2 PROFILE GRADE**  
 (Along & P.G.L.)

**Farnsworth**  
 GROUP, INC.  
 2700 McGraw Drive  
 Bloomington, Illinois 61704  
 309/503-8433 309/503-1071 fax

DESIGNED - TCR/JCZ  
 CHECKED - JML  
 DRAWN - DJM/JWK  
 DATE - 06/26/12

REVISED  
 REVISED  
 REVISED  
 REVISED

**STATE OF ILLINOIS**  
**DEPARTMENT OF TRANSPORTATION**

**GENERAL DATA**  
**STRUCTURE NO. 082-0385 NB & 082-0386 SB**

SHEET NO. A2 OF 48 SHEETS

F.A.P. RTE.	SECTION	COUNTY	TOTAL SHEETS	SHEET NO.
788	520-1-2B	ST. CLAIR	94	33
CONTRACT NO. 76F69			ILLINOIS FED. AID PROJECT	