

SHOWING REINFORCEMENT

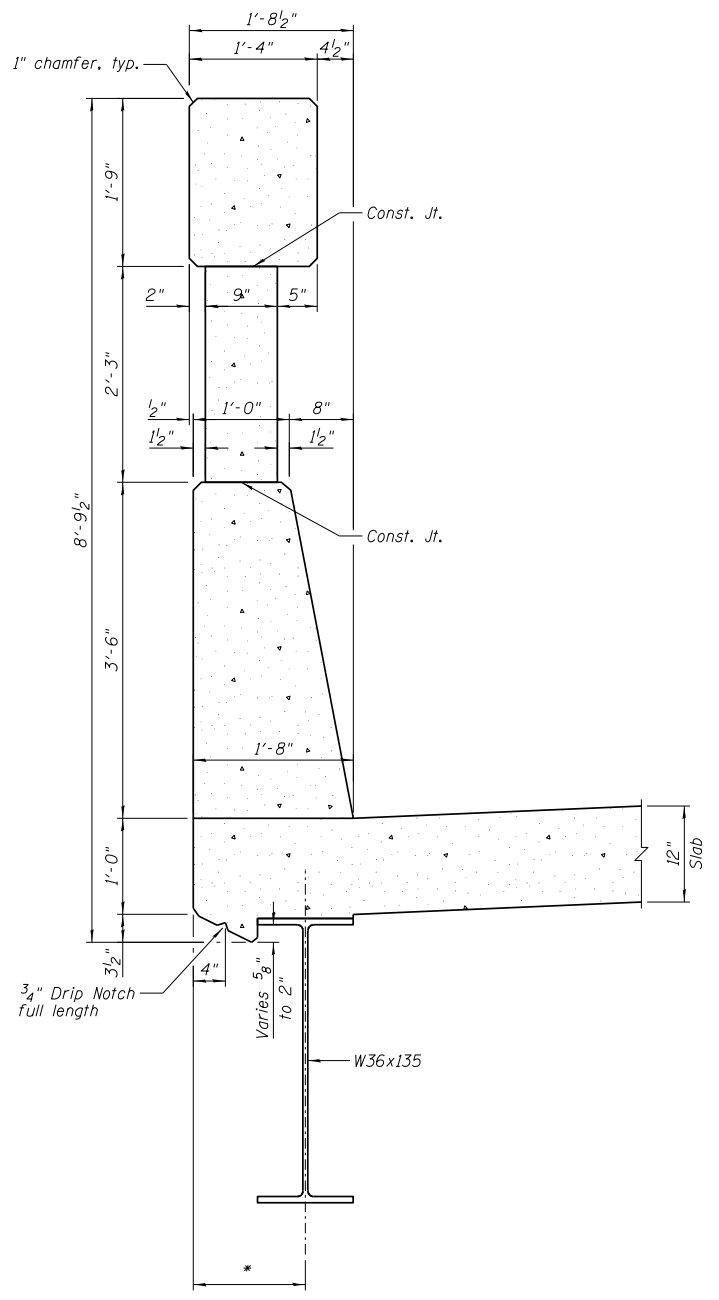

SHOWING DIMENSIONS

SECTION THRU RAIL

Southbound Bridge:
 *Varies from 1'-0" to 1'-5 1/4" (West Beam)
 or 1'-0 3/4" to 1'-4" (East Beam)
 Northbound Bridge:
 *Varies from 1'-0" to 1'-2 7/8" (West Beam)
 or 1 1/2" to 1'-4" (East Beam)

GENERAL NOTES:

- 1.) This rail has been evaluated and approved to be of equal strength to railings with like geometry, which have been crash tested to meet NCHRP Report 350 TL-6 Criteria.
- 2.) A Future Wearing Surface is not permitted with the use of this rail.
- 3.) Average weight of railing is 1,300 PLF.

NOTES:

- 1.) e103(E) bars required in 12'-0" Transition located in the Transition Panel. See "Inside Elevation Showing Typical Reinforcement".
- 2.) See Sheets A9 & A10 for Superstructure Details and Bill of Material.
- 3.) Slab overhang should not exceed 1'-0" beyond edge of beam top flange.



DESIGNED - TCR/JCZ	REVISED
CHECKED - JML	REVISED
DRAWN - DJM/JWK	REVISED
CHECKED - MSW	REVISED
DATE - 06/26/12	

STATE OF ILLINOIS
 DEPARTMENT OF TRANSPORTATION

RAIL DETAILS
 STRUCTURE NO. 082-0385 NB & 082-0386 SB

SHEET NO. A15 OF 48 SHEETS

F.A.P. RTE.	SECTION	COUNTY	TOTAL SHEETS	SHEET NO.
788	520-1-2B	ST. CLAIR	94	46
CONTRACT NO. 76F69				
ILLINOIS FED. AID PROJECT				