

PLAN

* Tilt #9 b102(E) bars as required to maintain clearance.
 ** Space between a111(E) bars, typ. each parapet.

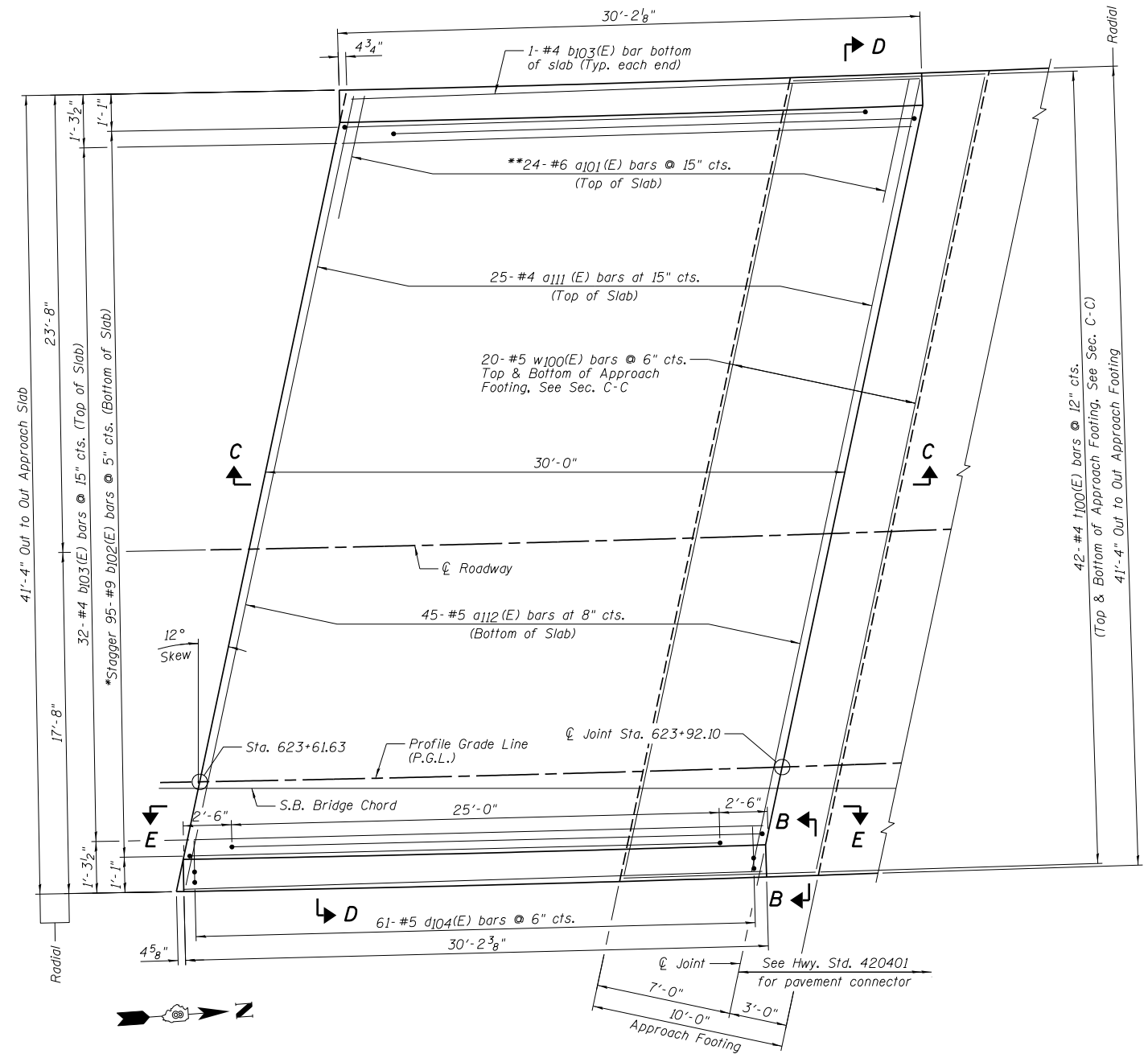

PLAN

* Tilt #9 b102(E) bars as required to maintain clearance.
 ** Space between a111(E) bars, typ. each parapet.

NOTES:

- 1.) See Sheet A21 for Sections C-C & D-D and Views B-B & E-E.
- 2.) a111(E) and a112(E) bar spacings measured along \varnothing Rdwy.

DESIGNED - TCR/JCZ	REVISED
CHECKED - JML	REVISED
DRAWN - DJM/JWK	REVISED
CHECKED - MSW	REVISED
DATE - 06/26/12	

F.A.P. RTE.	SECTION	COUNTY	TOTAL SHEETS	SHEET NO.
788	520-1-2B	ST. CLAIR	94	51
ILLINOIS FED. AID PROJECT			CONTRACT NO. 76F69	