

DATE	
BY	
FINISHED SURVEY	
PLOTTED TEMPLATE	
NOTE BOOK	
AREAS CHECKED	
NO.	

DATE	
BY	
ORIGINAL SURVEY	
PLOTTED TEMPLATE	
NOTE BOOK	
AREAS CHECKED	
NO.	

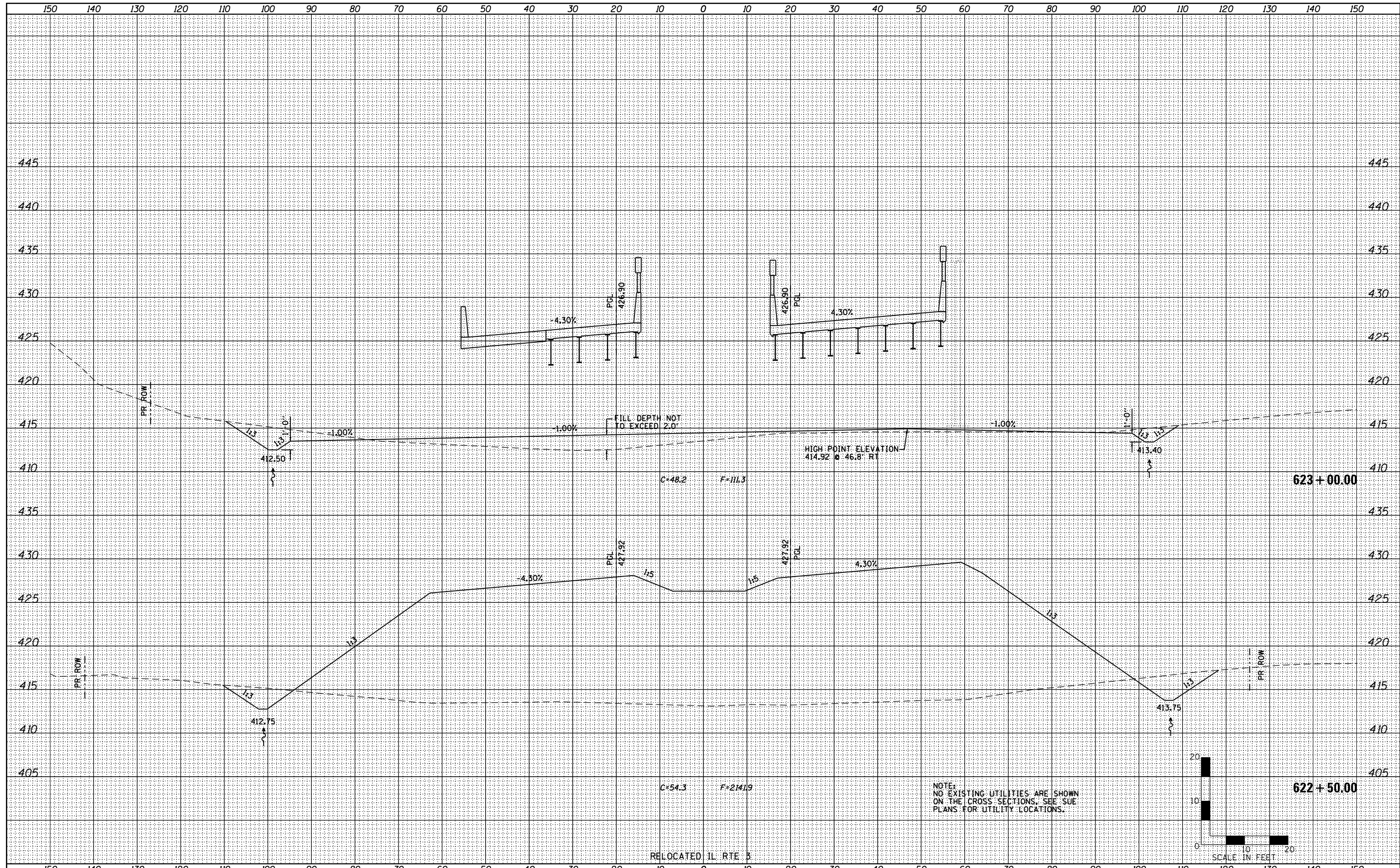

Farnsworth GROUP, INC.
 2709 McGraw Drive
 Bloomington, Illinois 61704
 309/663-8435, 309/663-1571 fax

USER NAME = jochaner	DESIGNED - JJ0	REVISED -
	DRAWN - JJ0	REVISED -
PLOT SCALE = 1/8" = 20.0000' / in.	CHECKED - PJM	REVISED -
PLOT DATE = 7/29/2012	DATE - 06/26/12	REVISED -

**STATE OF ILLINOIS
 DEPARTMENT OF TRANSPORTATION**

CROSS SECTIONS

SCALE:	SHEET NO.	OF SHEETS	STA. 622+50.00 TO STA. 623+00.00
--------	-----------	-----------	----------------------------------

F.A.P. RTE.	SECTION	COUNTY	TOTAL SHEETS	SHEET NO.
788	520-1-2B	ST. CLAIR	94	81
CONTRACT NO. 76F69				
ILLINOIS FED. AID PROJECT				