

BRIDGE NO. 4
SN. 076-0001
2011 ADT: 2850
19% TRUCKS
INVENTORY RATING: 25.1
OPERATING RATING: 41.9
COUNTY ROAD DISTRICT #02

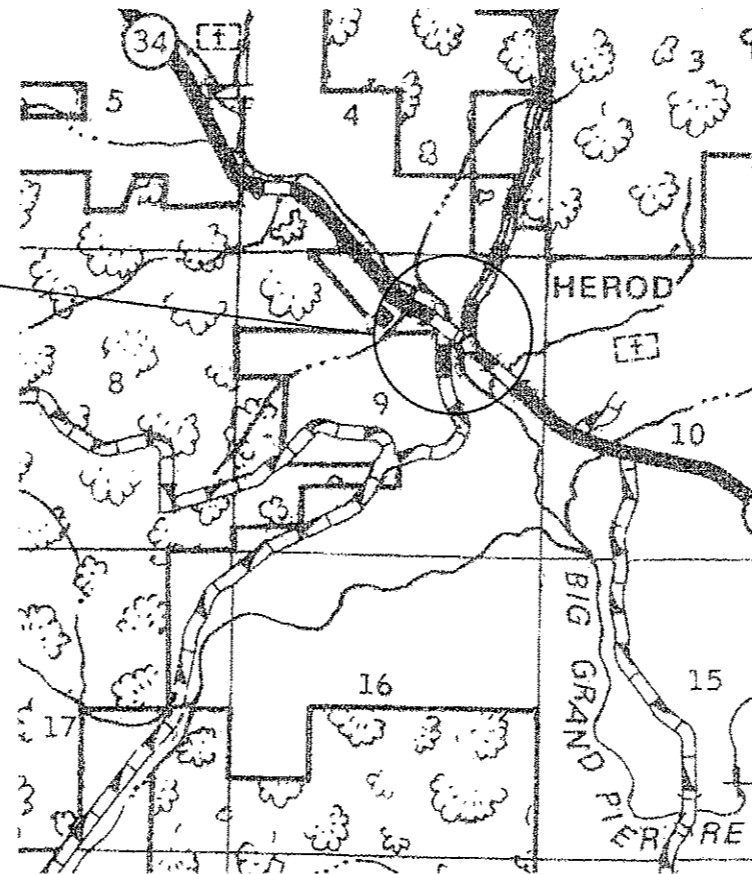

POPE COUNTY

NOTES

CLEANING AND PAINTING OF THE DESIGNATED EXISTING STRUCTURAL STEEL SHALL BE AS SPECIFIED IN THE SPECIAL PROVISIONS FOR "CLEANING AND PAINTING EXISTING STEEL STRUCTURES". ALL BEAMS, BEARINGS AND OTHER STRUCTURAL STEEL WITHIN 6 FEET (MEASURED ALONG THE BEAM) OF EITHER SIDE OF DECK JOINTS AND THE EXTERIOR SURFACES AND BOTTOM OF THE BOTTOM FLANGE OF THE FULL LENGTH OF FASCIA BEAMS SHALL BE CLEANED PER NEAR WHITE BLAST CLEANING - SSPC-SPI0. THE AREAS CLEANED PER NEAR WHITE BLAST CLEANING SHALL BE PAINTED ACCORDING TO THE REQUIREMENTS OF PAINT SYSTEM 1 - OZ/E/U. THE COLOR OF THE FINAL FINISH COAT FOR INTERIOR STEEL SURFACES SHALL BE GRAY, MUNSELL NO. 5B 7/1. THE COLOR OF THE FINAL FINISH COAT FOR EXTERIOR STEEL SURFACES OF FASCIA BEAMS SHALL BE REDDISH BROWN, MUNSELL NO. 2.5YR 3/4.

STRUCTURAL STEEL NEAR THE DECK JOINTS HAS AN EXISTING PAINT COATING, AND THE REMAINDER IS WEATHERING STEEL WITH NO EXISTING COATING. CONTAINMENT AND DISPOSAL OF CLEANING RESIDUES FROM THE PAINTED STRUCTURAL STEEL SHALL BE IN ACCORDANCE WITH THE SPECIAL PROVISION "CONTAINMENT AND DISPOSAL OF LEAD PAINT CLEANING RESIDUES". CONTAINMENT AND DISPOSAL OF CLEANING RESIDUES FROM THE UNPAINTED PORTION OF FASCIA BEAMS SHALL BE IN ACCORDANCE WITH EITHER THE SPECIAL PROVISION "CONTAINMENT AND DISPOSAL OF LEAD PAINT CLEANING RESIDUES" OR THE SPECIAL PROVISION "CONTAINMENT AND DISPOSAL OF NON-LEAD PAINT CLEANING RESIDUES", AT THE CONTRACTOR'S OPTION.

A MINIMUM OF THREE AIR MONITORS ARE REQUIRED TO MONITOR ABRASIVE BLASTING OPERATIONS AT THIS SITE.

FILE NAME *	USER NAME * gautneyrk	DESIGNED -	REVISED -	STATE OF ILLINOIS DEPARTMENT OF TRANSPORTATION	SN 076-0001 IL 34 OVER GIBBONS CREEK	RTE.	SECTION	COUNTY	TOTAL SHEETS	SHEET NO.	
g:\p\work\p\p\p\gautneyrk\00319688\78	41-shs-plan.dgn	DRAWN -	REVISED -			VAR.	D9 BRIDGE PAINTING 2013-1	VARIOUS	33	27	
PLT SCALE * 40.0026 1 / in.	CHECKED -	REVISED -	SCALE: _____			SHEET _____	OF _____	SHEETS	STA. _____	TO STA. _____	CONTRACT NO. 78341
PLT DATE * 12/17/2012	DATE -	REVISED -	ILLINOIS FED. AID PROJECT								