

PROP. CURVE
 PI STA. = 81+28.67
 $\Delta = 3^{\circ} 02' 09''$ (RT)
 $D = 12^{\circ} 27' 49''$
 $R = 459.70'$
 $T = 12.18'$
 $L = 24.36'$
 $E = 0.16'$
 $e =$ NORMAL CROWN
 P.C. STA. = 81+16.49
 P.T. STA. = 81+40.85

PROP. CURVE
 PI STA. = 80+71.44
 $\Delta = 65^{\circ} 36' 36''$ (LT)
 $D = 63^{\circ} 39' 43''$
 $R = 90.00'$
 $T = 58.01'$
 $L = 103.06'$
 $E = 17.08'$
 $e =$ NORMAL CROWN
 P.C. STA. = 80+13.43
 P.T. STA. = 81+16.49

CONTROL POINT #900
 N = 1702452.453
 E = 798377.774

PROP. CURVE
 PI STA. = 184+48.25
 $\Delta = 13^{\circ} 24' 30''$ (RT)
 $D = 4^{\circ} 46' 29''$
 $R = 1,200.00'$
 $T = 141.06'$
 $L = 280.82'$
 $E = 8.26'$
 $e =$ NORMAL CROWN
 P.C. STA. = 183+07.20
 P.T. STA. = 185+88.02

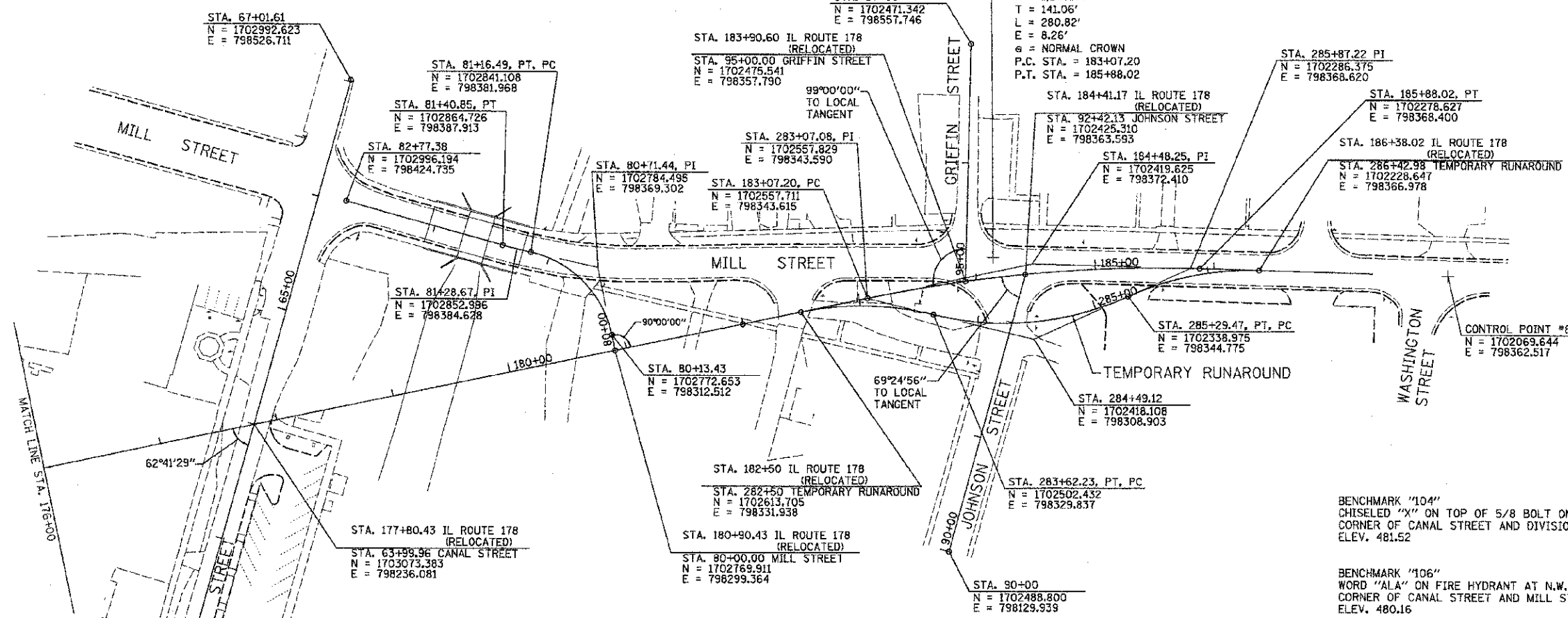

CONTROL POINT #9
 N = 1701670.503
 E = 798351.834

CONTROL POINT #8
 N = 1702069.644
 E = 798362.517

BENCHMARK "104"
 CHISELED "X" ON TOP OF 5/8 BOLT ON FIRE HYDRANT AT N.E. CORNER OF CANAL STREET AND DIVISION STREET.
 ELEV. 481.52

BENCHMARK "106"
 WORD "ALA" ON FIRE HYDRANT AT N.W. CORNER OF CANAL STREET AND MILL STREET
 ELEV. 480.16

BENCHMARK "107"
 CHISELED "X" ON TOP OF 5/8 BOLT ON FIRE HYDRANT AT N.E. CORNER OF CHURCH ST. AND MILL STREET
 ELEV. 479.74

BENCHMARK "108"
 CHISELED "X" ON WEST BOLT OF FIRE HYDRANT AT W. SIDE OF ILL. ROUTE 178, S. SIDE OF CANAL BRIDGE
 ELEV. 480.15

BENCHMARK "109"
 CHISELED "X" ON TOP OF 5/8 BOLT ON FIRE HYDRANT AT N.E. CORNER OF ILL ROUTE 178 AND GRIFFIN STREET
 ELEV. 473.78

PROP. CURVE
 PI STA. = 283+07.08
 $\Delta = 25^{\circ} 43' 18''$ (RT)
 $D = 22^{\circ} 55' 06''$
 $R = 250.00'$
 $T = 57.08'$
 $L = 112.23'$
 $E = 6.43'$
 $e =$ NORMAL CROWN
 P.C. STA. = 282+50.00
 P.T. STA. = 283+62.23

PROP. CURVE
 PI STA. = 284+49.12
 $\Delta = 38^{\circ} 19' 43''$ (LT)
 $D = 22^{\circ} 55' 06''$
 $R = 250.00'$
 $T = 86.88'$
 $L = 167.24'$
 $E = 14.67'$
 $e =$ NORMAL CROWN
 P.C. STA. = 283+62.23
 P.T. STA. = 285+29.47

PROP. CURVE
 PI STA. = 285+87.22
 $\Delta = 26^{\circ} 00' 54''$ (RT)
 $D = 22^{\circ} 55' 06''$
 $R = 250.00'$
 $T = 57.75'$
 $L = 113.51'$
 $E = 6.58'$
 $e =$ NORMAL CROWN
 P.C. STA. = 285+29.47
 P.T. STA. = 286+42.98

NOTE:
 INFORMATION ON THIS SHEET FROM CONTRACT 66547

SEE SHEET 9 FOR SWING TIES TO CONTROL POINTS.

FILE NAME = 0366547-SHT-A7B.DEN	USER NAME = ---	DESIGNED - JKC	REVISED - ---	STATE OF ILLINOIS DEPARTMENT OF TRANSPORTATION	IL RTE 178 (RELOCATED) ALIGNMENT & TIES	F.A.S. RTE. 1279	SECTION 06-00017-00-LS	COUNTY LASALLE	TOTAL SHEETS 29	SHEET NO. 8	
PLOT SCALE = 1"=50'	CHECKED - JKC/LAG	REVISIONS	SCALE: 1"=50'			SHEET NO. ___ OF ___ SHEETS	STA. 176+00 TO STA. 186+38.02	CONTRACT NO. 87355		FED. ROAD DIST. NO. - ILLINOIS FED. AID PROJECT	
PLOT DATE = 08/10	DATE - 08/10	REVISIONS									