

Notes:
 See sheet 9 of 18 for Sections C-C & D-D.
 See sheet 10 of 18 for Railing Connection.
 a(E) and a₁(E) bar spacings measured along \bar{C} Rdwy.

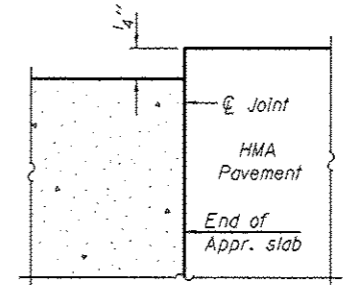
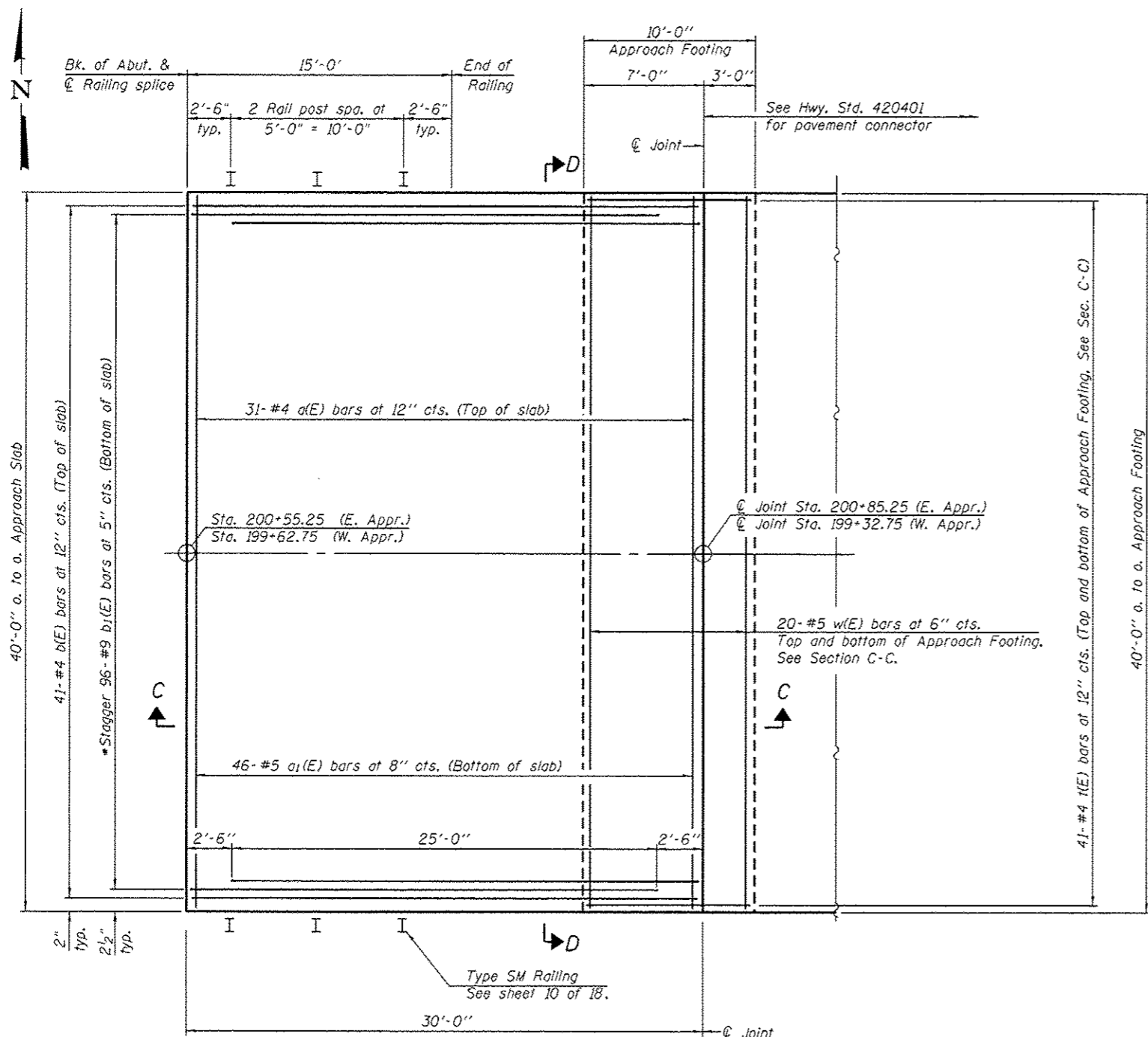

FLEXIBLE PAVEMENT
 DETAIL A

PLAN

(Shown for East Approach Slab)

* Tilt #9 b₁(E) bars as required to maintain clearances.

P:\P-18-2356 - Sandville Road Bridge\IGN\CAD00 Sheets\Structural\0723148-2356-088-AppSlabDetail.dgn
 5/8/15 11:51 PM

(Sheet 1 of 2)

INFRASTRUCTURE ENGINEERING
 456 Fulton Street | Suite 104 | Peoria, IL 61602
 P: 309.672.9888 | F: 309.672.9833 | www.infrastructureeng.com

USER NAME *	DESIGNED - LAN	REVISED -
	CHECKED - SPK	REVISED -
PLOT SCALE *	DRAWN - LAN	REVISED -
PLOT DATE *	CHECKED - SPK	REVISED -

**PEORIA COUNTY
 HIGHWAY DEPARTMENT**

**BRIDGE APPROACH SLAB DETAILS
 STRUCTURE NO. 072-3148**

F.A.S. RTE.	SECTION	COUNTY	TOTAL SHEETS	SHEET NO.
1381	10-00005-03-BR	PEORIA	55	30
				CONTRACT NO. 89464

SHEET NO. 8 OF 18 SHEETS

ILLINOIS FED. AID PROJECT