

FINI	DATE
SURVEY	
PLOTTED	
NOTE BOOK	
NO.	

**INFRASTRUCTURE**  
**ENGINEERING**  
 1500 N. State Street, Peoria, IL 61603  
 (309) 696-1111

ORIGINAL	DATE
SURVEY	
PLOTTED	
NOTE BOOK	
NO.	

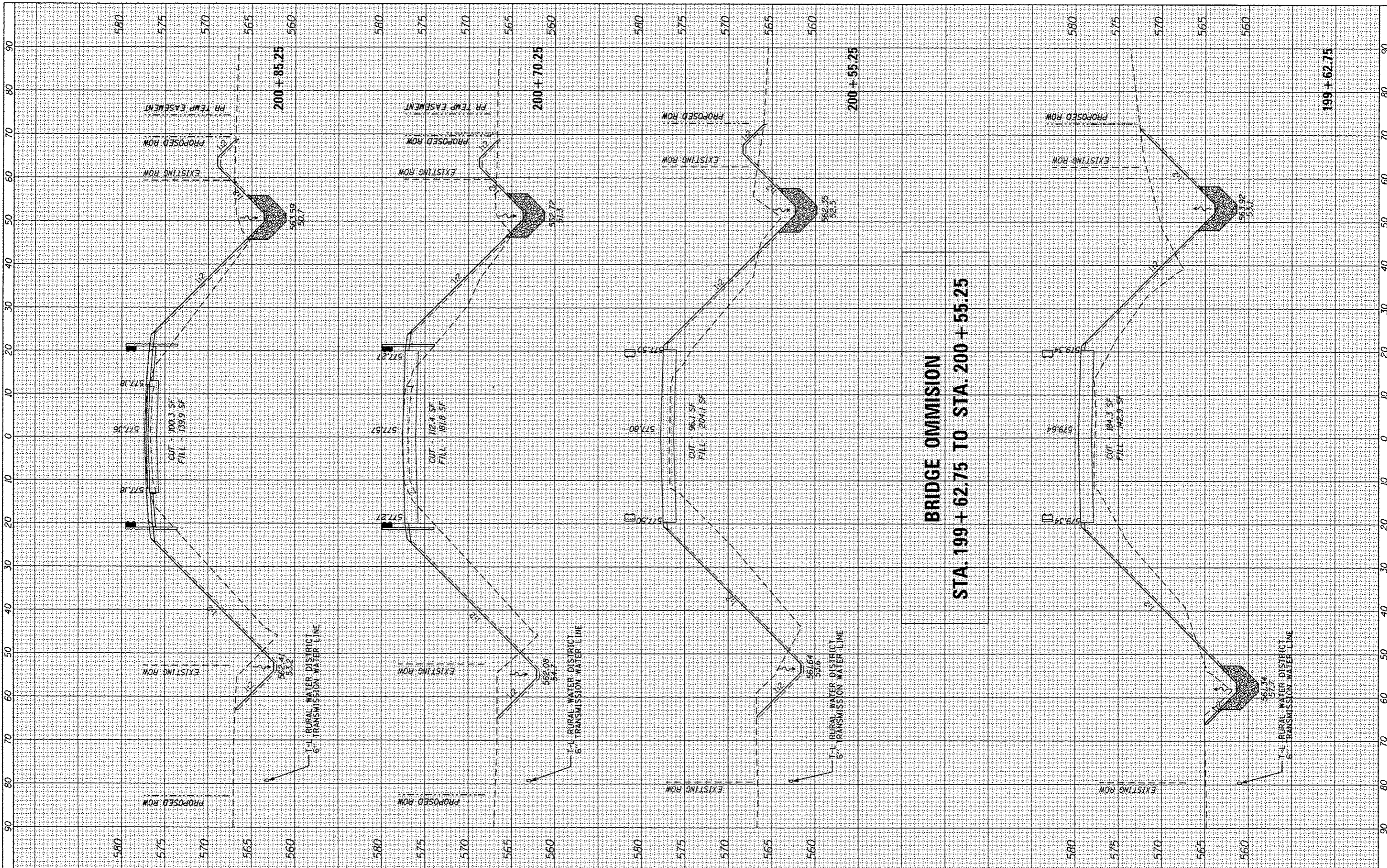

FILE NAME :  
 #FILE#

USER NAME = IEI  
 PLOT SCALE = 20.0000' / 1" =  
 PLOT DATE = 10/28/2012

DESIGNED - AJP  
 DRAWN - AJP  
 CHECKED - BAR  
 DATE - 11/02/2012

REVISED -  
 REVISED -  
 REVISED -  
 REVISED -

**PEORIA COUNTY**  
**HIGHWAY DEPARTMENT**

**CROSS SECTIONS**

SCALE: 10H : 5V SHEET 4 OF 6 SHEETS STA. 199+62.75 TO STA. 200+85.25

F.A.S. RTE.	SECTION	COUNTY	TOTAL SHEETS	SHEET NO.
1381	10-0005-03-BR	PEORIA	55	44
CONTRACT NO. 89464			ILLINOIS FED. AID PROJECT	