

ROUTE	SECTION	COUNTY	TOTAL SHEETS	SHEET NO.
TR 51	11-01200-00-BR	UNION	12	2
PROJECT NO. BROS-181(57)			CONTRACT NO. 99481	

B.M. - RR Spike in 9" Tree  
 25' Lt. Station 14+63  
 Assumed Elev. 416.00

Existing Structure - Timber deck on timber pile bent abutments. Timber deck has collapsed into creek. 20' W x 60' L.

Note: Iron pins set at  
 1/2 Sta. 14+50.10 Bk.  
 0.75' Rt. Sta. 15+95.10

Pipe Culvert, Class D, Type 1 18" - 34 Ft.  
 US E 18.4' Lt. Station 13+98.0 Elev. 413.4  
 OS E 21.5' Lt. Station 14+30.5 Elev. 413.2

Tree Removal  
 26' Lt. Sta. 14+63 - 9 Unit Dia.  
 23' Lt. Sta. 15+27 - 8 Unit Dia.  
 25' Lt. Sta. 15+36 - 18 Unit Dia.  
 22' Lt. Sta. 15+39 - 12 Unit Dia.

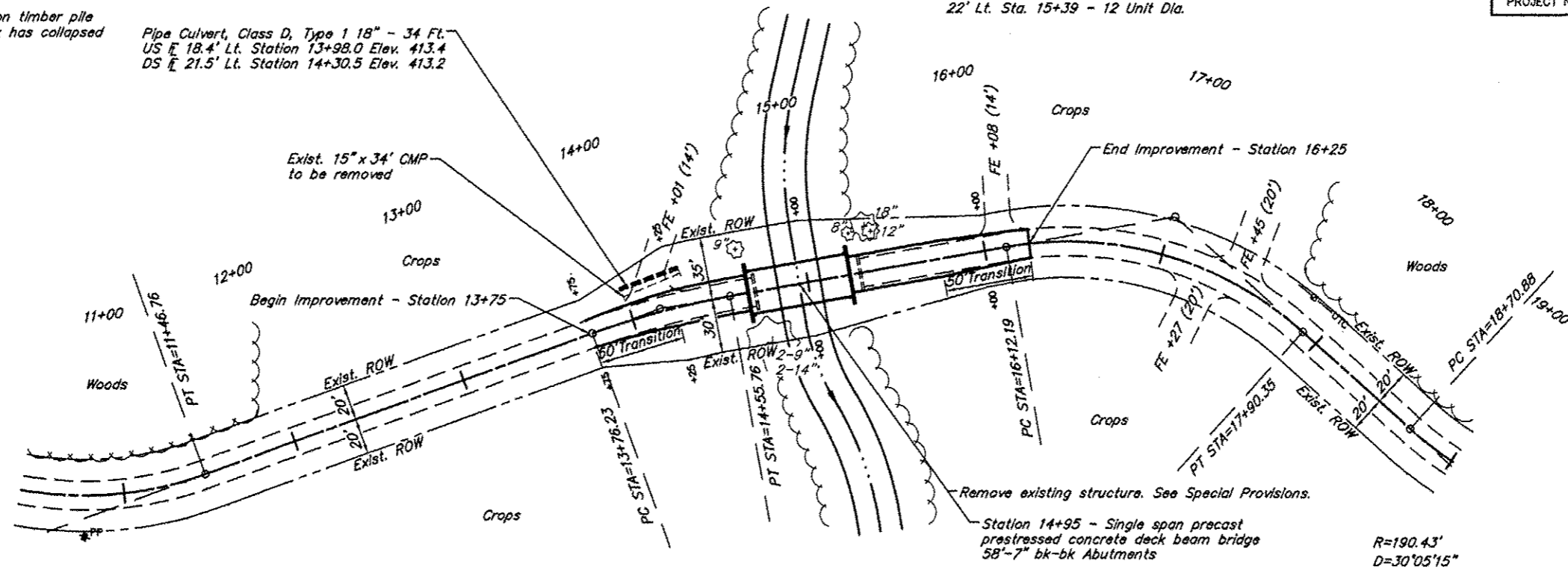

R=197.61'  
 D=28°59'40"

SCALES:  
 1" = 80' HOR  
 1" = 10' VER

CURVE DATA  
 PI STA=14+16.10  
 $\Delta = 9^{\circ}54'22''$  T = 39.86'  
 D = 12°27'20" L = 79.53'  
 R = 450.00' E = 1.72'  
 Normal Crown

CURVE DATA  
 PI STA=17+07.95  
 $\Delta = 52^{\circ}03'10''$  T = 95.76'  
 D = 29°12'58" L = 178.16'  
 R = 196.11' E = 22.13'  
 SE = 0.070'/Ft  
 Attain Sta. 15+25.0 to Sta. 16+46.5  
 Remove Sta. 17+09.1 to Sta. 18+30.6

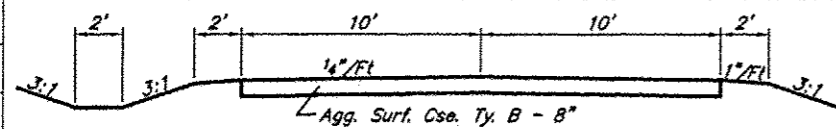

TYPICAL ROADWAY SECTION

