

ROUTE	SECTION	COUNTY	TOTAL SHEETS	SHEET NO.
TR 51	11-01200-00-BR	UNION	12	12
PROJECT NO. BROS-0181(057)			CONTRACT NO. 99481	

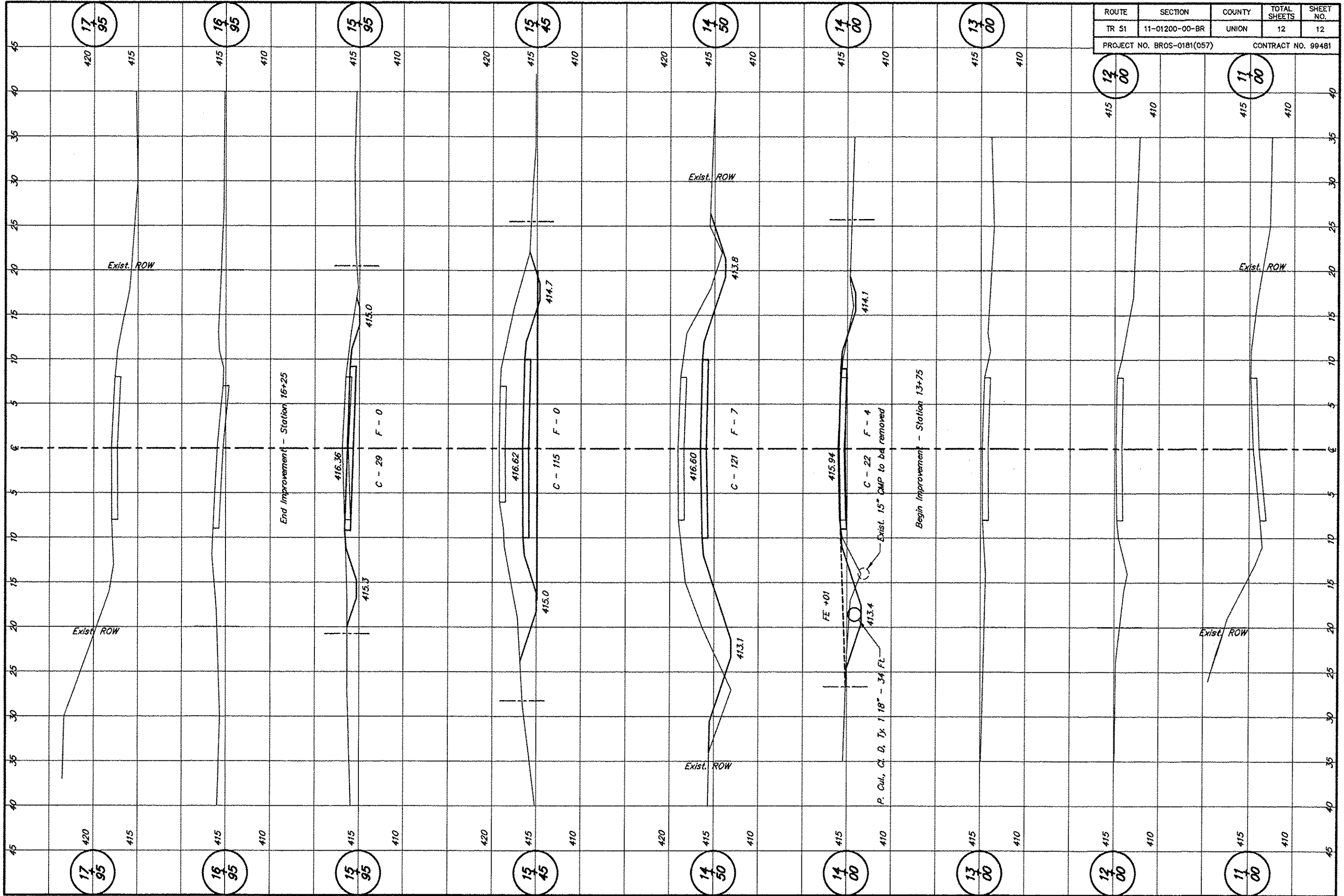

End Improvement - Station 16+25

Begin Improvement - Station 13+75

FE +01
 P. Cul., Cl. D, Tx 1 18" - 34 Ft
 C - 22 F - 4
 Exist. 15" CMP to be removed

C - 29 F - 0

C - 115 F - 0

C - 121 F - 7