

STATE OF ILLINOIS
DEPARTMENT OF TRANSPORTATION

F.A.P. ROUTE	SECTION	COUNTY	TOTAL SHEETS	SHEET NO.
327	D7 SEAL COAT 2019-1	RICHLAND	5	1
ILLINOIS			CONTRACT NO. 74888	

FOR INDEX OF SHEETS, SEE SHEET NO. 2

PROPOSED HIGHWAY PLANS

F.A.P. ROUTE 327 (OLD US 50)
SECTION D7 SEAL COAT 2019-1
A-2 SURFACE TREATMENT
RICHLAND COUNTY

C-97-012-19

D-97-003-19

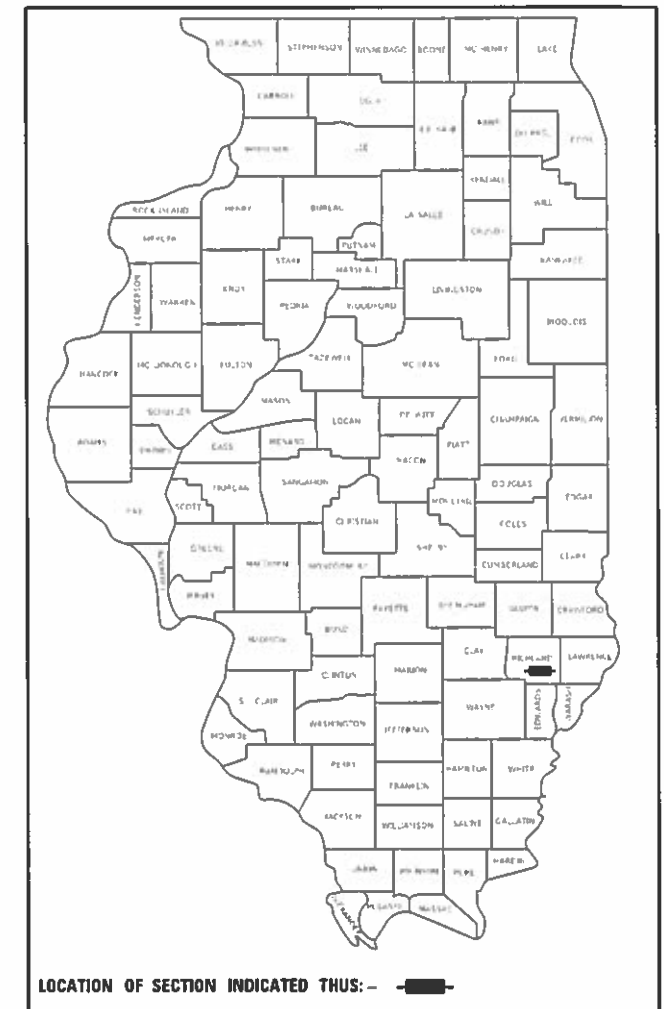

LOCATION 1 & 2
BEGINS

LOCATION # 2
ENDS

LOCATION # 1
ENDS

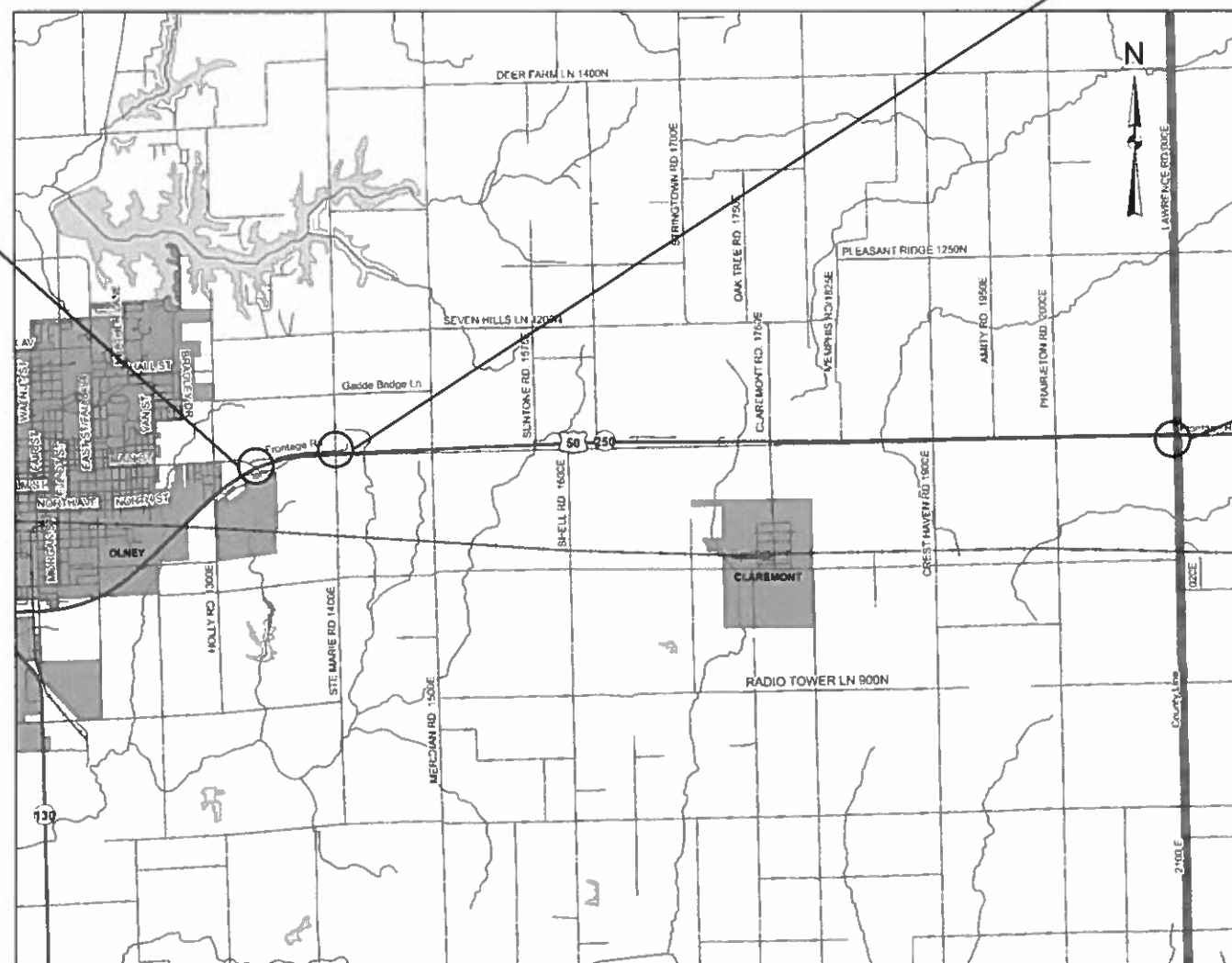

FULL SIZE PLANS HAVE BEEN PREPARED USING STANDARD ENGINEERING SCALES. REDUCED SIZED PLANS WILL NOT CONFORM TO STANDARD SCALES. IN MAKING MEASUREMENTS ON REDUCED PLANS, THE ABOVE SCALES MAY BE USED.

J.U.L.I.E.
JOINT UTILITY LOCATION INFORMATION FOR EXCAVATION
1-800-892-0123
OR 811

PROJECT ENGINEER: TOM RONAN
PROJECT MANAGER: TOM RONAN
PHONE: (217) 342-8320

CONTRACT NO. 74888

GROSS & NET LENGTH = 43,930 FEET (8.32 MILES)

STATE OF ILLINOIS
DEPARTMENT OF TRANSPORTATION

SUBMITTED OCTOBER 12 20 18
Jeffrey M South
REGIONAL ENGINEER

Doc J 20 18
ENGINEER OF DESIGN AND ENVIRONMENT

Doc J 20 18
DIRECTOR OF HIGHWAYS PROJECT IMPLEMENTATION

PRINTED BY THE AUTHORITY
OF THE STATE OF ILLINOIS

INDEX OF SHEETS

SHEET NO.	DESCRIPTION
1	TITLE SHEET
2	INDEX OF SHEETS, HIGHWAY STANDARDS, & GENERAL NOTES
3	SUMMARY OF QUANTITIES
4	SCHEDULE OF QUANTITIES
5	LOCATION MAP

THE FOLLOWING STANDARDS ARE A PART OF THESE PLANS AND ARE INCLUDED FOLLOWING SHEET NUMBER 5:

701001-02	OFF ROAD, 2L 2W, 15' MINIMUM FROM EDGE OF PAVEMENT, FOR SPEEDS \geq 45 MPH
701006-05	OFF ROAD, 2L 2W, 15' AWAY TO EDGE OF PAVEMENT, FOR SPEEDS \geq 45 MPH
701011-04	OFF ROAD, 2L, 2W, MOVING OPERATIONS DAY ONLY, FOR SPEEDS \geq 45 MPH
701201-05	LANE CLOSURE, 2L, 2W, DAY ONLY, FOR SPEEDS \geq 45 MPH
701301-04	LANE CLOSURE, 2L, 2W, SHORT TIME OPERATIONS
701901-08	TRAFFIC CONTROL DEVICES

GENERAL NOTES

THE PROPOSED WORK IS LOCATED AT TWO LOCATIONS ALONG US ROUTE 50 IN RICHLAND COUNTY. LOCATION 1 IS ON THE SOUTH SIDE OF US ROUTE 50. LOCATION 1 STARTS JUST WEST OF THE LAWRENCEVILLE CORRECTIONAL CENTER (CR 2100 E) AND EXTENDS WEST FOR 7.58 MILES TO US 50/ILL 250. LOCATION 2 IS ON THE NORTH SIDE OF US ROUTE 50. LOCATION 2 STARTS AT 1100 NORTH (ILL 250) AND EXTENDS EAST FOR 0.72 MILES TO 1400 EAST (ST. MARIE ROAD).

THE WORK IN THIS SECTION CONSISTS OF POTHOLE PATCHING, CONSTRUCTION OF SEAL COAT FOR BITUMINOUS SURFACE TREATMENT CLASS A-2, AGGREGATE BASE REPAIR, PREPARATION OF BASE, TRAFFIC CONTROL, AND ANY OTHER WORK NECESSARY TO COMPLETE THIS SECTION PER THE STANDARD SPECIFICATIONS.

AN ESTIMATED QUANTITY OF HOT-MIX-ASPHALT FOR PATCHING POTHOLES (COLD MIX) HAS BEEN INCLUDED FOR ANY NECESSARY POTHOLE PATCHING. THE QUANTITY AND LOCATIONS OF POTHOLE PATCHING WILL BE DETERMINED BY THE RESIDENT IN THE FIELD. AN ESTIMATED QUANTITY OF AGGREGATE BASE REPAIR HAS BEEN INCLUDED FOR ANY NECESSARY BASE REPAIR. THE QUANTITY AND LOCATIONS OF AGGREGATE BASE REPAIR WILL BE DETERMINED BY THE RESIDENT IN THE FIELD.

THE MATERIAL USED FOR SEAL COAT AGGREGATE SHALL BE CA-16 CRUSHED STONE.

SURVEY MONUMENT VALUTS AND SURVEY TABLETS SHALL BE KEPT FREE OF THE BITUMINOUS SURFACE TREATMENT. SURVEY MONUMENT VAULTS SHALL BE PROTECTED BY COVERING THEM WITH A MINIMUM OF 8" x 8" OF TAPE. SURVEY TABLETS SHALL BE PROTECTED BY COVERING THEM WITH A MINIMUM OF 4" x 4" OF TAPE. THE COST TO COVER AND REMOVE THE TAPE FROM THE SURVEY MONUMENT VAULTS AND SURVEY TABLETS WILL BE INCLUDED IN THE COST OF THE BITUMINOUS SURFACE TREATMENT.

REQUIRED RATES OF APPLICATION:

BITUMINOUS MATERIALS (PRIME COAT)	0.35 GALLONS / SQ. YD.
POLYMERIZED BIT. MATERIALS (COVER & SEAL COAT)	0.35 GALLONS / SQ. YD.
SEAL COAT AGGREGATE	25 LBS. / SQ. YD.
COVER COAT AGGREGATE	25 LBS. / SQ. YD.

MODEL: Default
 FILE: \\mhc-pw\ill08a\EBID\NTEC\Illinois.gov\PW\DOT\Documents\DOT Office\DIR\ct 7\Projects\74888\CADD\data\CAD\sheet\074888-rl-cen-nots.dgn

USER NAME = steffenmk	DESIGNED -	REVISED -	STATE OF ILLINOIS DEPARTMENT OF TRANSPORTATION	INDEX OF SHEETS, HIGHWAY STANDARDS, AND GENERAL NOTES		F.A.P. RTE.	SECTION	COUNTY	TOTAL SHEETS	SHEET NO.
DRAWN -	REVISD -	327				D7 SEAL COAT 2019-1	RICHLAND	5	2	
PLOT SCALE = 100,0000 ' / in.	CHECKED -	REVISED -				CONTRACT NO. 74888				
PLOT DATE = 10/15/2018	DATE -	REVISED -		SCALE:	SHEET OF SHEETS	STA.	TO STA.	ILLINOIS FED. AID PROJECT		

SURFACE TREATMENT SCHEDULE

SCHEDULE		LENGTH	PAVEMENT WIDTH	BITUMINOUS MATERIALS (PRIME COAT)	POLYMERIZED BITUMINOUS MATERIALS (COVERS AND SEAL COAT)	COVER COAT AGGREGATE	SEAL COAT AGGREGATE	PREPARATION OF BASE
STATION TO STATION	FEET	FEET	TON	TON	TON	TON	TON	SQ YD
SOUTH SIDE OF US ROUTE 50								
0+00	5+19	519	18	2	3	13	13	1038
5+19	9+35	416	18	1	2	10	10	
9+35	44+04	3469	18	CONCRETE - NO WORK				
44+04	52+50	846	18	3	5	21	21	
52+50	55+46	296	18	1	2	7	7	
55+46	61+96	650	18	2	4	16	16	1300
61+96	67+80	584	18	2	3	15	15	
67+80	73+26	546	18	2	3	14	14	1092
73+26	90+93	1767	18	5	10	44	44	
90+93	106+29	1536	18	5	9	38	38	3072
106+29	106+55	26	18	0.1	0.2	1	1	
106+55	146+98	4043	18	12	24	101	101	
146+98	159+50	1252	18	4	7	31	31	2504
159+50	178+46	1896	18	CONCRETE - NO WORK				
178+46	192+40	1394	18	4	8	35	35	2788
192+40	205+72	1332	18	4	8	33	33	
205+72	232+69	2697	18	CONCRETE - NO WORK				
232+69	250+82	1813	18	5	11	45	45	
250+82	255+22	440	18	1	3	11	11	880
255+22	267+78	1256	18	4	7	31	31	2512
267+78	281+85	1407	18	4	8	35	35	2814
281+85	284+89	304	18	1	2	8	8	608
284+89	308+26	2337	18	7	14	58	58	
308+26	327+55	1929	18	6	11	48	48	3858
327+55	353+81	2626	18	8	16	66	66	
353+81	370+14	1633	18	5	10	41	41	3266
370+14	384+70	1456	18	4	9	36	36	2912
384+70	400+45	1575	18	5	9	39	39	
NORTH SIDE OF US ROUTE 50								
0+00	37+97	3797	21	13	26	111	111	8860
PROJECT TOTALS				108	216	910	910	37504

LOCATION	RICHLAND COUNTY - OLD US 50
DIRECTION RAN	EAST (By Prison) TO WEST

STATION TO STATION	A-2	BASE REPAIR	WIDTH (FOOT)
0+00 - 5+19	X	X	18
5+19 - 9+35	X		18
9+35 - 44+04	CONCRETE NO WORK		18
44+04 - 52+50	X		18
52+50 - 55+46	X		18
55+46 - 61+96	X	X	18
61+96 - 67+80	X		18
67+80 - 73+26	X	X	18
73+26 - 90+93	X		18
90+93 - 106+29	X	X	18
106+29 - 106+55	X		18
106+55 - 146+98	X		18
146+98 - 159+50	X	X	18
159+50 - 178+46	CONCRETE NO WORK		18
178+46 - 192+40	X	X	18
192+40-205+72	X		18
205+72 - 232+69	CONCRETE NO WORK		18
232+69 - 250+82	X		18
250+82 - 255+22	X	X	18
255+22 - 267+78	X	X	18
267+78 - 281+85	X	X	18
281+85 - 284+89	X	X	18
284+89 - 308+26	X		18
308+26 - 327+55	X	X	18
327+55 - 353+81	X		18
353+81 - 370+14	X	X	18
370+14 - 384+70	X	X	
384+70 - 400+45	X		18

CENTER OF CROSSROADS	
STATION	ROAD
55+46	2000 E (N. PRAIRIETON ROAD)
106+55	1900 E (CREST HAVEN ROAD)
146+98	1825 E (MEMPHIS ROAD)
178+46	1760 E (CLAREMONT ROAD)
192+40	ROCK ACCES ROAD TO US 50
255+22	1625 E (PRIMROSE ROAD)
267+78	1600 E (SHELL ROAD)
281+85	1575 E (SUNTONE ROAD)
327+55	1500 E (MERIDIAN ROAD)
370+14	1400 E (ST. MARIE ROAD)

STRUCTURES	
STATION	STRUCTURE NUMBER
284+89	080-0017

MODEL: Default
FILE: \\mllc-pw\ulb\BEBID\NTEC\Illinois.gov\PW\DOT\Documents\DOT_Offices\Director_7\Projects\174888\CADDData\CADD\pkcs174888-Plc-Schedule.dgn

USER NAME = steffenmk	DESIGNED -	REVISED -
	DRAWN -	REVISED -
PLOT SCALE = 100.0000 ' / in.	CHECKED -	REVISED -
PLOT DATE = 10/15/2018	DATE -	REVISED -

**STATE OF ILLINOIS
DEPARTMENT OF TRANSPORTATION**

SUMMARY OF SCHEDULE

SCALE: SHEET OF SHEETS STA. TO STA.

F.A.P. RTE.	SECTION	COUNTY	TOTAL SHEETS	SHEET NO.
327	D7 SEAL COAT 2019-1	RICHLAND	5	4
			CONTRACT NO. 74888	
ILLINOIS		FED. AID PROJECT		

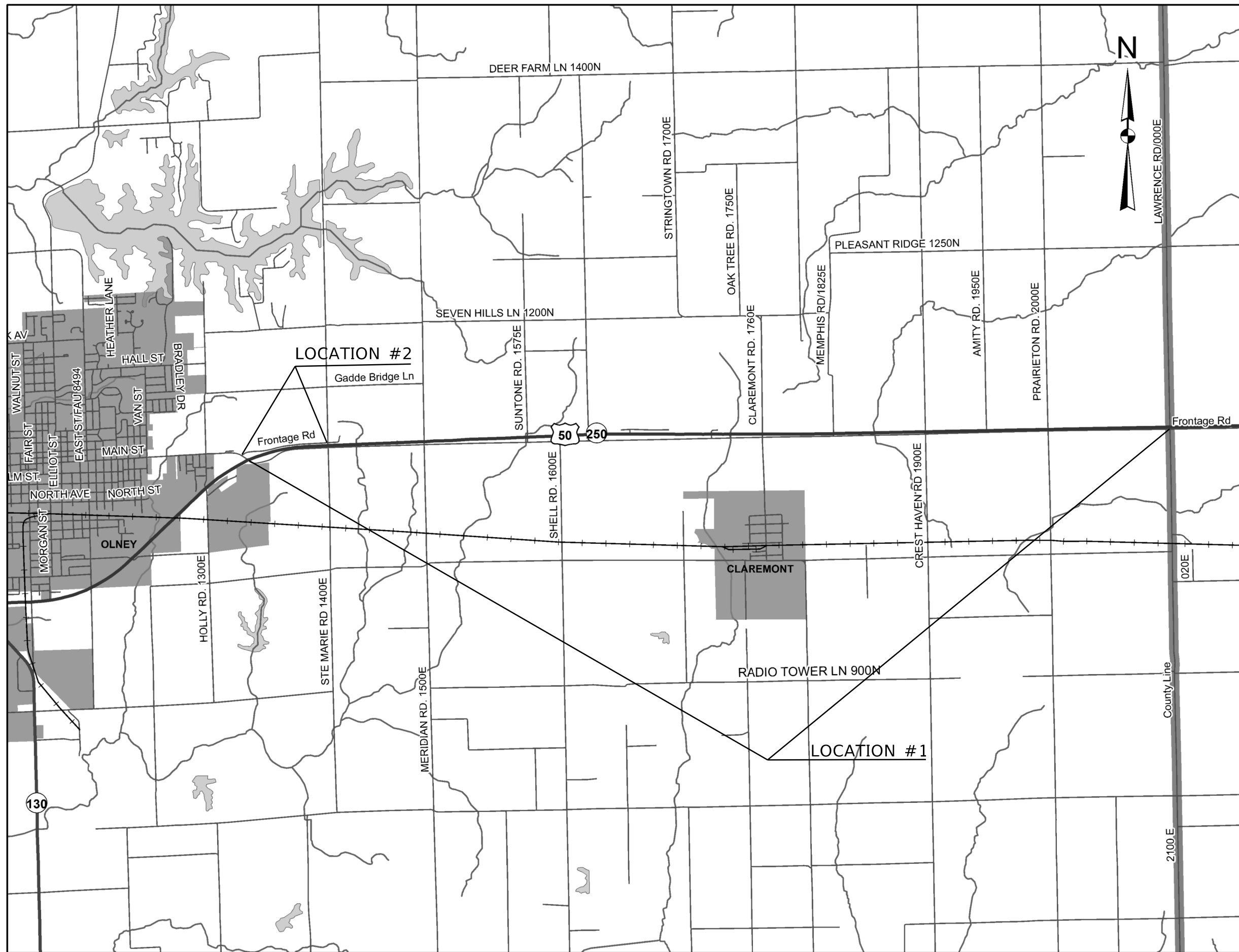

MODEL: Default
 FILE: \\mnp\p\ul\084E\BID\NTEC\Illinois\gov\PI\DOT\Documents\1\DOT_Offices\DI\erfct 7\proj\cst\74888\CADD\data\CAD\pkcs\ID74888-PI-draw\k.sgm

USER NAME = steffemk	DESIGNED -	REVISED -
	DRAWN -	REVISED -
PLOT SCALE = 100,0000' / in.	CHECKED -	REVISED -
PLOT DATE = 10/15/2018	DATE -	REVISED -

**STATE OF ILLINOIS
DEPARTMENT OF TRANSPORTATION**

LOCATION MAP

SCALE: SHEET OF SHEETS STA. TO STA.

F.A.P. RTE.	SECTION	COUNTY	TOTAL SHEETS	SHEET NO.
VAR.	D7 SEAL COAT 2019-2	COLES/SHELBY	5	5
CONTRACT NO. 74888			ILLINOIS FED. AID PROJECT	