

039

01-18-2019 LETTING ITEM 039

STATE OF ILLINOIS
DEPARTMENT OF TRANSPORTATION

F.A.I. ROUTE	SECTION	COUNTY	TOTAL SHEETS	SHEET NO.
57	(91-3)RS-4	UNION	27	1
		ILLINOIS	CONTRACT NO. 78693	

FOR INDEX OF SHEETS, SEE SHEET NO. 3

FOR SUMMARY OF QUANTITIES, SEE SHEET NO. 5-8

PROPOSED HIGHWAY PLANS

FAI 57 ROUTE SB I-57
SECTION (91-3)RS-4
PROJECT NHPP-E31Z(731)
PATCHING & RESURFACING
UNION COUNTY

C-99-002-19

TRAFFIC DATA

F.A.I. ROUTE 57 (I-57)
FUNCTIONAL CLASS: RURAL PRINCIPAL ARTERIAL (INTERSTATE)
DESIGN SPEED = 70 MPH
POSTED SPEED = 70 MPH
ADT = 13,040 (2019), 16,200 (2039)
54% TRUCKS

TOWNSHIPS STOKES

PROP. PROJECT BEGINS
FAI 57 SB STA. 2598+23.05

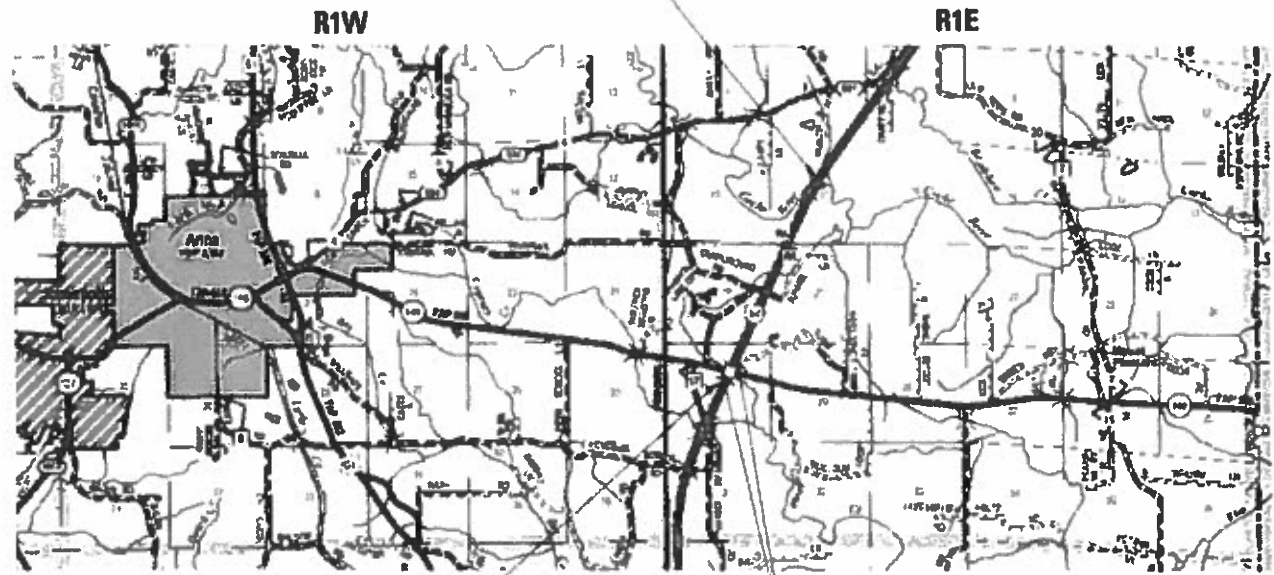

PROP. PROJECT ENDS
FAI 57 SB STA 2729+86.62

GAP SOUTH BOUND FAI 57 SB
STA. 2707+12.50 TO STA. 2710+62.00



DESIGN DESIGNATION : N/A

COORDINATE SYSTEM : ILLINOIS EAST

POSTED SPEED : 70 MPH

J.U.L.R.E.
JOINT UTILITY LOCATION INFORMATION FOR EXCAVATION
1-800-892-0123
OR 811

PROJECT ENGINEER: CHARLES STEIN
PROJECT DESIGNER: ROBERT HANDY

CONTRACT NO. 78693

GROSS LENGTH = 13,163.57 FT. = 2.49 MILES
NET LENGTH = 12,814.07 FT. = 2.43 MILES

STATE OF ILLINOIS
DEPARTMENT OF TRANSPORTATION

SUBMITTED Oct 19 20 18

Jeffrey Z Keen
REGION FIVE ENGINEER

Dec 7 20 18

[Signature]
ENGINEER OF DESIGN AND ENVIRONMENT

Dec 7 20 18

Paul P. [Signature]
DIRECTOR OF HIGHWAYS PROJECT IMPLEMENTATION

PRINTED BY THE AUTHORITY
OF THE STATE OF ILLINOIS

INDEX OF SHEETS

SHEET NO.	DESCRIPTION
1	COVER SHEET
2	SIGNATURE SHEET
3	INDEX OF SHEETS, STANDARDS, STATION EQUATIONS, MIXTURE DESIGN
4	GENERAL NOTES, COMMITMENTS, MTD
5 - 8	SUMMARY OF QUANTITIES
9 - 11	TYPICAL SECTION
12	IL 57 SB MAINLINE RESURFACING SCHEDULE, RAMP RESURFACING SCHEDULE
13	PAVEMENT DELINEATION SCHEDULE
14	PAVEMENT MARKING SCHEDULE
15	PATCHING SCHEDULE
16	PATCHING SCHEDULE
17 - 20	EXIT / ENTRANCE RAMP DETAILS
21	I-57 INTERCHANGE AT IL 146 PLAN
22 - 26	I-57 PLAN VIEW
27	DETAILS FOR HMA INLAY FOR RAMPS

STANDARDS

000001-07	701400-09
420701-03	701401-12
442101-09	701411-09
442201-03	701426-09
642001-02	701456-05
701101-05	701901-08
701106-02	780001-05
	781001-04

STATIONS EQUATIONS

NONE

COMMITMENTS

THE TRAIL OF TEARS REST AREA SHALL NOT BE USED TO PARK EQUIPMENT OR VEHICLES OR BE USED TO SCORE MATERIALS.

THE TRAIL OF TEARS REST AREA SHALL REMAIN OPEN DURING CONSTRUCTION OF THE PROJECT

HMA MIXTURE TABLE

Locations	Hot-Mix Asphalt Surface Course
Mixture Use(s):	Polymerized Hot-Mix Asphalt Surface Course, Mix D, N90
AB/PG:	SBS PG76-22
ABR % (Max):	See Special Provision
Design Air Voids:	4.0 %, 90 Gyration Design
Mixture (Gradation)	IL-9.5mm
Friction Aggregate:	D Surface
Mixture Weight:	112 lbs/Sq Yd/in
Quality	QCP
Program:	QCP
Sublot Size:	NA

Locations	Hot-Mix Asphalt Leveling Binder
Mixture Use(s):	Polymerized Hot-Mix Asphalt Leveling Binder, N90 Fine Graded
AB/PG:	SBS PG76-22
ABR % (Max):	See Special Provision
Design Air Voids:	4.0 %, 90 Gyration Design
Mixture Composition: (Gradation)	IL-9.5mm Fine Graded
Friction Aggregate:	None
Mixture Weight:	112 lbs/Sq Yd/in
Quality	QCP
Program:	QCP
Sublot Size:	NA

MODEL: Default
FILE NAME: P:\IL08\B&E\BIDD\ITEC\Illinois\gov\PIWDOT\Documents\11DOT_Offices\11dot\9\Projects\78693\CaddData\CAD\Sheets\07\8693_Sheets.dgn

USER NAME = rollavr	DESIGNED - _____	REVISED - _____
	DRAWN - _____	REVISED - _____
PLOT SCALE = 100.0000' / in.	CHECKED - _____	REVISED - _____
PLOT DATE = 11/30/2018	DATE - _____	REVISED - _____

**STATE OF ILLINOIS
DEPARTMENT OF TRANSPORTATION**

**INDEX OF SHEETS, GENERAL NOTES, MIXTURE DESIGN
STANDARDS, COMMITMENTS, STATION EQUATIONS, MTD**

SCALE: _____ SHEET ____ OF ____ SHEETS STA. _____ TO STA. _____

F.A.I. RTE.	SECTION	COUNTY	TOTAL SHEETS	SHEET NO.
57	(91-3)RS-4	UNION	27	3
			CONTRACT NO. 78693	
		ILLINOIS FED. AID PROJECT		

GENERAL NOTES

FACTORS USED FOR ESTIMATING PLAN QUANTITIES ARE AS FOLLOWS AND SHALL NOT BE USED FOR THE BASIS OF FINAL QUANTITIES:

ALL HOT-MIX ASPHALT 2.016 TONS/CU.YD.
 ALL AGGREGATE 2.05 TONS/CU.YD.

THE QUANTITY OF SHORT TERM PAVEMENT MARKING IS BASED ON ONE APPLICATION EACH FOR THE MILLED SURFACE, SURFACE COURSE AND BINDER COURSE.

THE CONTRACTOR SHALL STAMP STATIONING IN THE OUTSIDE PROPOSED HOT MIX ASPHALT SHOULDER AT 300 FT. INTERVALS ON THE INSIDE EDGE OF OUTSIDE SHOULDER AND AS DIRECTED BY THE ENGINEER. THE STATION SYMBOL STAMPS USED SHALL BE FURNISHED BY THE CONTRACTOR. THEY SHALL BE 5.5 IN. TALL, OF A DESIGN APPROVED BY THE ENGINEER, AND SHALL REMAIN THE PROPERTY OF THE CONTRACTOR.

PRIOR TO PLACEMENT OF THE FINAL PAVEMENT MARKINGS THE RESIDENT ENGINEER SHALL CONTACT THE BUREAU OF OPERATIONS AND ARRANGE FOR INSPECTION AND APPROVAL OF THE PAVEMENT MARKING LAYOUT.

IN ADDITION TO THE REQUIREMENTS OF ARTICLE 107.16, THE CONTRACTOR SHALL PROTECT THE SURFACE OF ALL BRIDGE DECKS AND BRIDGE APPROACH PAVEMENTS IN A MANNER SATISFACTORY TO THE ENGINEER BEFORE ANY EQUIPMENT IS ALLOWED TO CROSS THE STRUCTURE. PROTECTION SHALL BE PROVIDED FOR ALL EQUIPMENT AS DEFINED IN ARTICLE 101.17 REGARDLESS IF TRACK MOUNTED OR WHEELED.

MTD CROSSING RESTRICTIONS TABLE

SN & CENTERLINE STATION ROUTE (I-57)	EXISTING FILL HEIGHT OVER BOX CULVERT	THICKNESS OF EXISTING PAVEMENT OVER	MTD CROSSING RESTRICTIONS
	FOOT	FOOT	
<u>CULVERTS</u>			
091-7075			EMPTY MTD
091-2008	5.6	0.792	EMPTY MTD
091-2009	12.9	0.792	EMPTY MTD
091-2024	7.3	0.792	NO MTD
091-2025	2.1	0.792	EMPTY MTD
<u>BRIDGES</u>			
091-0012	N/A	0.67	EMPTY MTD
091-0014	N/A	0.63	EMPTY MTD

MODEL: Default
 FILE NAME: P:\IL08\EBID\NTEC\Illinois.gov\FWIDOT\Documents\DOT_Offices\Director_9\Projects\78693\CADD\data\CAD\Sheets\0778693_Sheets.dgn

<table border="1" style="width: 100%; border-collapse: collapse;"> <tr> <td style="font-size: small;">USER NAME = handyc</td> <td style="font-size: small;">DESIGNED -</td> <td style="font-size: small;">REVISED -</td> </tr> <tr> <td style="font-size: small;">DRAWN -</td> <td style="font-size: small;">REVISED -</td> <td style="font-size: small;">REVISED -</td> </tr> <tr> <td style="font-size: small;">PLOT SCALE = 100,0000 ' / in.</td> <td style="font-size: small;">CHECKED -</td> <td style="font-size: small;">REVISED -</td> </tr> <tr> <td style="font-size: small;">PLOT DATE = 10/31/2018</td> <td style="font-size: small;">DATE -</td> <td style="font-size: small;">REVISED -</td> </tr> </table>	USER NAME = handyc	DESIGNED -	REVISED -	DRAWN -	REVISED -	REVISED -	PLOT SCALE = 100,0000 ' / in.	CHECKED -	REVISED -	PLOT DATE = 10/31/2018	DATE -	REVISED -	STATE OF ILLINOIS DEPARTMENT OF TRANSPORTATION	INDEX OF SHEETS, GENERAL NOTES, MIXTURE DESIGN STANDARDS, COMMITMENTS, STATION EQUATIONS, MTD	<table border="1" style="width: 100%; border-collapse: collapse;"> <tr> <td style="font-size: x-small;">F.A.I. RTE.</td> <td style="font-size: x-small;">SECTION</td> <td style="font-size: x-small;">COUNTY</td> <td style="font-size: x-small;">TOTAL SHEETS</td> <td style="font-size: x-small;">SHEET NO.</td> </tr> <tr> <td style="text-align: center;">57</td> <td style="text-align: center;">(91-3)RS-4</td> <td style="text-align: center;">UNION</td> <td style="text-align: center;">27</td> <td style="text-align: center;">4</td> </tr> </table>	F.A.I. RTE.	SECTION	COUNTY	TOTAL SHEETS	SHEET NO.	57	(91-3)RS-4	UNION	27	4	CONTRACT NO. 78693 ILLINOIS FED. AID PROJECT
USER NAME = handyc	DESIGNED -	REVISED -																								
DRAWN -	REVISED -	REVISED -																								
PLOT SCALE = 100,0000 ' / in.	CHECKED -	REVISED -																								
PLOT DATE = 10/31/2018	DATE -	REVISED -																								
F.A.I. RTE.	SECTION	COUNTY	TOTAL SHEETS	SHEET NO.																						
57	(91-3)RS-4	UNION	27	4																						
SCALE:		SHEET OF SHEETS	STA. TO STA.																							

SUMMARY OF QUANTITIES

COUNTY: Union
 ROUTE: I-57
 FUNDING: 90% FED / 10% STATE
 LOCATION: RURAL

CODE NUMBER	ITEM DESCRIPTION	UNIT	0005
40600295	POLYMERIZED BITUMINOUS MATERIALS (TACK COAT)	POUND	23,065
40600847	POLYMERIZED LEVELING BINDER (MACHINE METHOD), IL-9.5FG, N90	TON	3,317
40600982	HOT-MIX ASPHALT SURFACE REMOVAL - BUTT JOINT	SQ YD	401
40600990	TEMPORARY RAMP	SQ YD	68
40603545	POLYMERIZED HOT-MIX ASPHALT SURFACE COURSE, MIX "D", N90	TON	3,317
44000161	HOT-MIX ASPHALT SURFACE REMOVAL, 3"	SQ YD	39,469
44200970	CLASS B PATCHES, TYPE II, 10 INCH	SQ YD	299
44200974	CLASS B PATCHES, TYPE III, 10 INCH	SQ YD	215
44200976	CLASS B PATCHES, TYPE IV, 10 INCH	SQ YD	310
44201299	DOWEL BARS 1 1/2"	EACH	1,268
44201765	CLASS D PATCHES, TYPE II, 10 INCH	SQ YD	166

MODEL: Default
 FILE NAME: P:\11084E8D\NTEG\Illinois.gov\PWIDOT\Documents\DOT_Offices\District 9\Projects\78693\CADDData\CAD\Sheets\078693_Sheets.dgn

USER NAME = handycr	DESIGNED -	REVISED -
	DRAWN -	REVISED -
PLOT SCALE = 100.0000' / in.	CHECKED -	REVISED -
PLOT DATE = 10/19/2018	DATE -	REVISED -

**STATE OF ILLINOIS
DEPARTMENT OF TRANSPORTATION**

SUMMARY OF QUANTITIES

SCALE: N.T.S. SHEET 1 OF 4 SHEETS STA. TO STA.

F.A.I. RTE.	SECTION	COUNTY	TOTAL SHEETS	SHEET NO.
57	(91-3)RS-4	UNION	27	5
CONTRACT NO. 78693				
ILLINOIS FED. AID PROJECT				

REV. - MS

SUMMARY OF QUANTITIES - CONT

COUNTY: Union
 ROUTE: I-57
 FUNDING: 90% FED / 10% STATE
 LOCATION: RURAL

CODE NUMBER	ITEM DESCRIPTION	UNIT	0005
44201769	CLASS D PATCHES, TYPE III, 10 INCH	SQ YD	96
44201771	CLASS D PATCHES, TYPE IV, 10 INCH	SQ YD	27
44213100	PAVEMENT FABRIC	SQ YD	525
44213200	SAW CUTS	FOOT	3,842
44213204	TIE BARS 3/4"	EACH	120
67100100	MOBILIZATION	L SUM	1
70100420	TRAFFIC CONTROL AND PROTECTION, STANDARD 701411	EACH	4
70100800	TRAFFIC CONTROL AND PROTECTION, STANDARD 701401	L SUM	1
70100825	TRAFFIC CONTROL AND PROTECTION, STANDARD 701456	L SUM	1
70103815	TRAFFIC CONTROL SURVEILLANCE	CAL DA	36
70107025	CHANGEABLE MESSAGE SIGN	CAL DA	65

MODEL: Default
 FILE NAME: P:\1108\B&E\BID\NTEC\Illinois.gov\PIWDOT\Documents\DOT_Offices\District 9\Projects\78693\CADD\Bids\CAD\Sheets\DS78693_Sheets.dgn

USER NAME = handyc	DESIGNED -	REVISED -
PLOT SCALE = 100.0000' / in.	DRAWN -	REVISED -
PLOT DATE = 10/19/2018	CHECKED -	REVISED -
	DATE -	REVISED -

**STATE OF ILLINOIS
 DEPARTMENT OF TRANSPORTATION**

SUMMARY OF QUANTITIES

SCALE: N.T.S. SHEET 2 OF 4 SHEETS STA. TO STA.

F.A.I. RTE.	SECTION	COUNTY	TOTAL SHEETS	SHEET NO.
57	(91-3)RS-4	UNION	27	6
CONTRACT NO. 78693			REV. - MS	
ILLINOIS FED. AID PROJECT				

SUMMARY OF QUANTITIES - CONT

COUNTY: Union
 ROUTE: I-57
 FUNDING: 90% FED / 10% STATE
 LOCATION: RURAL

CODE NUMBER	ITEM DESCRIPTION	UNIT	0005
70300100	SHORT TERM PAVEMENT MARKING	FOOT	7,538
70300150	SHORT TERM PAVEMENT MARKING REMOVAL	SQ FT	2,516
70300220	TEMPORARY PAVEMENT MARKING - LINE 4"	FOOT	26,239
70300250	TEMPORARY PAVEMENT MARKING - LINE 8"	FOOT	1,679
* 78000200	THERMOPLASTIC PAVEMENT MARKING - LINE 4"	FOOT	26,239
* 78000500	THERMOPLASTIC PAVEMENT MARKING - LINE 8"	FOOT	1,679
* 78004220	PREFORMED PLASTIC PAVEMENT MARKING, TYPE B - INLAID - LINE 5"	FOOT	3,401
* 78100100	RAISED REFLECTIVE PAVEMENT MARKER	EACH	415
78300200	RAISED REFLECTIVE PAVEMENT MARKER REMOVAL	EACH	415
* X7830072	GROOVING FOR RECESSED PAVEMENT MARKING 6"	FOOT	26,239

* SPECIALTY ITEM

MODEL: Default
 FILE NAME: P:\1108\AEBID\NTEC\Illinois.gov\PIWDOT\Documents\DOT_Offices\District 9\Projects\78693\CADDData\CAD\Sheets\DS78693_Sheets.dgn

REV. - MS

USER NAME = handycr	DESIGNED -	REVISED -	STATE OF ILLINOIS DEPARTMENT OF TRANSPORTATION	SUMMARY OF QUANTITIES			F.A. RTE.	SECTION	COUNTY	TOTAL SHEETS	SHEET NO.
DRAWN -	REVISED -	57					(91-3)RS-4	UNION	27	7	
PLOT SCALE = 100.0000' / in.	CHECKED -	REVISED -		SCALE: N.T.S. SHEET 3 OF 4 SHEETS STA. TO STA.			CONTRACT NO. 78693				
PLOT DATE = 10/19/2018	DATE -	REVISED -		ILLINOIS FED. AID PROJECT							

SUMMARY OF QUANTITIES - CONT

COUNTY: Union
 ROUTE: I-57
 FUNDING: 90% FED / 10% STATE
 LOCATION: RURAL

CODE NUMBER	ITEM DESCRIPTION	UNIT	0005
* X7830076	GROOVING FOR RECESSED PAVEMENT MARKING 9"	FOOT	1,679
Z0033700	LONGITUDINAL JOINT SEALANT	FOOT	12,814
Z0034105	MATERIAL TRANSFER DEVICE	TON	6,634

* SPECIALTY ITEM

MODEL: Default
 FILE NAME: P:\IL08\EBID\NTEC\Illinois.gov\PI\DOT\Documents\DOT_Offices\Director 9\Projects\78693\CADD\Drawings\CAD\Drawings\DOT\78693_Sheets.dgn

REV. - MS

USER NAME = handycr	DESIGNED -	REVISED -	STATE OF ILLINOIS DEPARTMENT OF TRANSPORTATION	SUMMARY OF QUANTITIES			F.A.1 RTE.	SECTION	COUNTY	TOTAL SHEETS	SHEET NO.
PLOT SCALE = 100.0000' / in.	DRAWN -	REVISED -		57	(91-3)RS-4	UNION	27	8			
PLOT DATE = 10/19/2018	CHECKED -	REVISED -		SCALE: N.T.S. SHEET 4 OF 4 SHEETS STA. TO STA.			CONTRACT NO. 78693				
	DATE -	REVISED -		ILLINOIS FED. AID PROJECT							

TYPICAL SECTION
I-57 SOUTHBOUND MAINLINE
N.T.S

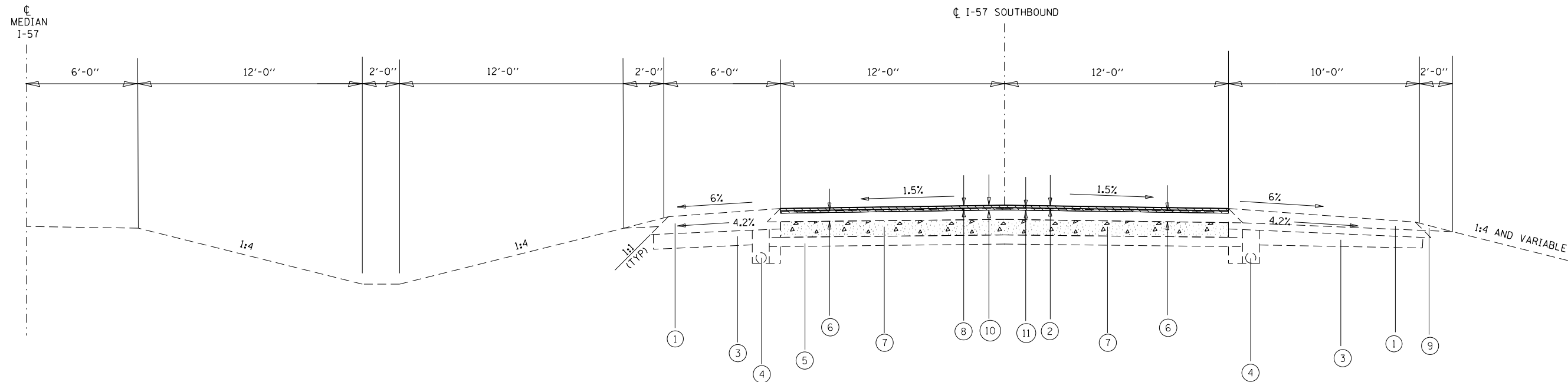

TO BE USED:

STA. 2598+23.05 TO STA. 2707+12.50
STA. 2710+62.00 TO STA. 2729+86.62

- | | |
|--|--|
| ① EXISTING 12 1/2"± HMA SHOULDERS | ⑦ EXISTING 10" RUBBLIZATION P.C.C. PAVEMENT |
| ② PROPOSED POLY. HMA SURFACE COURSE, MIX. D, N90, 1 1/2" | ⑧ EXISTING 2" HMA SURFACE COURSE |
| ③ EXISTING 9 1/2" CRUSHED STONE SHOULDER | ⑨ EXISTING 7" AGGREGATE WEDGE SHOULDERS, TYPE B (TYP) |
| ④ EXISTING 4" PIPE UNDERDRAIN | ⑩ PROPOSED HMA SURFACE REMOVAL, 3" |
| ⑤ EXISTING 6" SUB-BASE GRANULAR MATERIAL | ⑪ PROPOSED POLY. LEVELING BINDER (MACHINE METHOD), IL-9.5FG, N90, 1 1/2" |
| ⑥ EXISTING 7" HMA BINDER COURSE | |

MODEL: Default
FILE: \\nas01c.pva\illinois\BID\NTEC\Illinois\gov\PI\DOT\Documents\DOT_Offices\Director\9\Projects\78693\CaddData\CAD\Sheets\078693_Sheets.dgn

USER NAME = rollavr	DESIGNED - _____	REVISED - _____
	DRAWN - _____	REVISED - _____
PLOT SCALE = 100,0000' / in.	CHECKED - _____	REVISED - _____
PLOT DATE = 11/30/2018	DATE - _____	REVISED - _____

**STATE OF ILLINOIS
DEPARTMENT OF TRANSPORTATION**

TYPICAL SECTION	
I-57 S.B. MAINLINE	
SCALE: N.T.S.	SHEET 1 OF 3 SHEETS STA. _____ TO STA. _____

F.A.I. RTE. 57	SECTION (91-3)RS-4	COUNTY UNION	TOTAL SHEETS 27	SHEET NO. 9
CONTRACT NO. 78693			ILLINOIS FED. AID PROJECT	

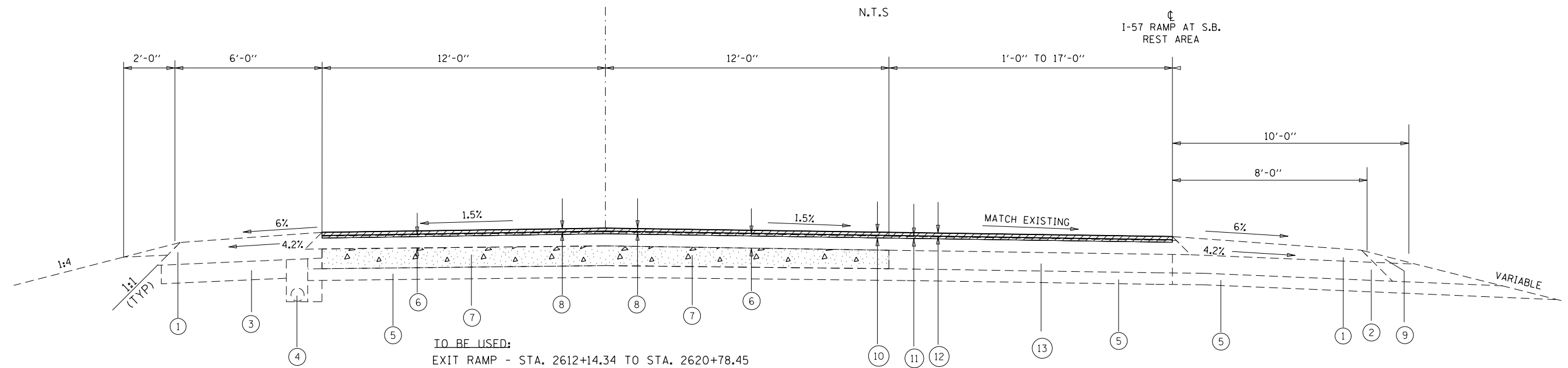

- TO BE USED:**
 EXIT RAMP - STA. 2612+14.34 TO STA. 2620+78.45
 ENTRANCE RAMP - STA. 2636+11.10 TO STA. 2647+91.66
- ① EXISTING 13"± HMA SHOULDERS
 - ② EXISTING 10"± STABILIZED SHOULDER
 - ③ EXISTING 9 1/2" CRUSHED STONE SHOULDER
 - ④ EXISTING 4" PIPE UNDERDRAIN
 - ⑤ EXISTING 4" TO 6" SUB-BASE GRANULAR MATERIAL
 - ⑥ EXISTING 7" HMA BINDER COURSE
 - ⑦ EXISTING 10" RUBBLIZATION OF P.C.C. PAVEMENT
 - ⑧ EXISTING 2" HMA SURFACE COURSE
 - ⑨ EXISTING AGGREGATE WEDGE SHOULDERS, TYPE B (TYP)
 - ⑩ HMA SURFACE REMOVAL, 3"
 - ⑪ PROPOSED POLY. LEVELING BINDER (MACHINE METHOD), IL-9.5FG, N90, 1 1/2"
 - ⑫ PROPOSED POLY. HMA SURFACE COURSE, MIX. D, N90, 1 1/2"
 - ⑬ EXISTING 10" P.C.C. PAVEMENT

TYPICAL SECTION
 RAMP AT REST AREA
 (LOOKING IN THE DIRECTION OF TRAVEL)
 N.T.S.

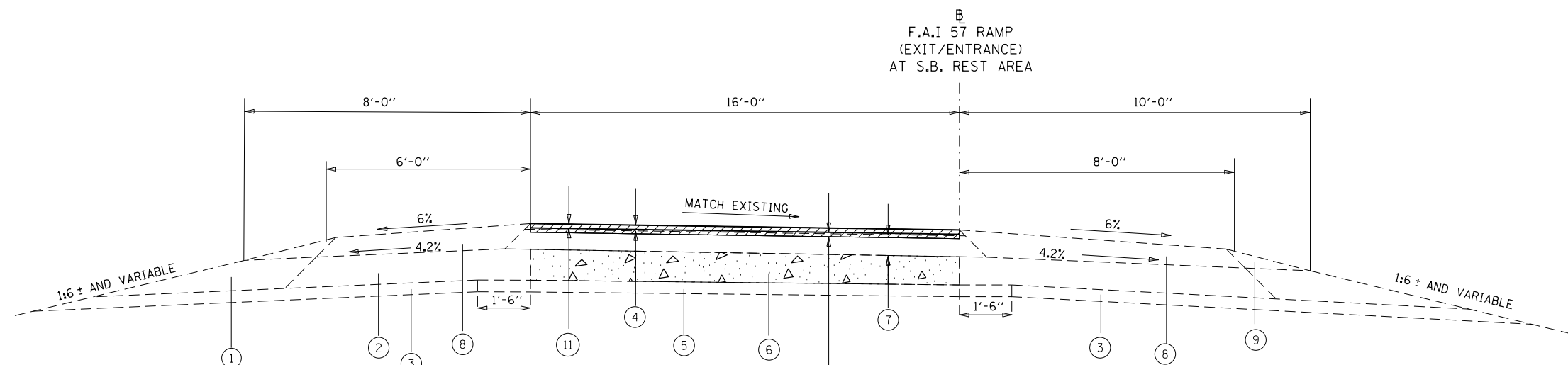

TO BE USED:
 EXIT RAMP - STA. 0+14.80 TO STA. 1+74.49
 ENTRANCE RAMP - STA. 17+93.37 TO STA. 19+60.42

- ① EXISTING AGGREGATE SHOULDER (TYP.)
- ② EXISTING 10" STABILIZED SHOULDER (TYP.)
- ③ EXISTING 4" SUB-BASED GRANULAR MATERIAL (TYP.)
- ④ EXISTING 2" HMA SURFACE COURSE
- ⑤ EXISTING 4" STABILIZED SUB-BASE
- ⑥ EXISTING 10" P.C.C. PAVEMENT
- ⑦ EXISTING HMA BINDER COURSE
- ⑧ EXISTING 7" TO 8" HMA SHOULDERS
- ⑨ EXISTING AGGREGATE WEDGE SHOULDERS, TYPE B (TYP)
- ⑩ PROPOSED POLY. LEVELING BINDER (MACHINE METHOD), IL-9.5FG, N90, 1 1/2"
- ⑪ PROPOSED POLY. HMA SURFACE COURSE, MIX. D, N90, 1 1/2"

MODEL: Default
 FILE: \\nas0101\BIBID\BIBID\TEC\Illinois\pov\p\WIDOT\Documents\DOT Office\BIBID\91303\3178693\CaddData\CAD\Sheets\0778693\Sheets.dgn

USER NAME = rollavr	DESIGNED - _____	REVISED - _____
DRAWN - _____	REVISIONS - _____	REVISIONS - _____
PLOT SCALE = 100.0000' / in.	CHECKED - _____	REVISIONS - _____
PLOT DATE = 11/30/2018	DATE - _____	REVISIONS - _____

**STATE OF ILLINOIS
 DEPARTMENT OF TRANSPORTATION**

TYPICAL SECTIONS	
I-57 INTERCHANGE RAMPS REST AREA	
SCALE: N.T.S.	SHEET 3 OF 3 SHEETS
STA. _____	TO STA. _____

F.A.I. RTE. 57	SECTION (91-3)RS-4	COUNTY UNION	TOTAL SHEETS 27	SHEET NO. 11
CONTRACT NO. 78693			ILLINOIS FED. AID PROJECT	

MAINLINE RESURFACING SCHEDULE

LOCATION STATION TO STATION UNION COUNTY				LENGTH	ROADWAY WIDTH	TEMP RAMP	HMA SUR. REMOVAL 3"	HOT-MIX ASP. SUR. CSE., MIX D, N 90 (1 1/2")	LEVELING BINDER (MM) N90 (1 1/2")	POLY BIT. MAT. (TACK COAT)	LONG JOINT SEALANT *
				FOR INFORMATIONAL PURPOSE ONLY							
				FEET	FEET	SQ YD	SQ YD	TON	TON	LBS	FEET
	2598+23.05	TO	2707+12.50								
LT	2598+23.05	TO	2707+12.50	10,889	12	13	14,520	1,220	1,220	9,801	10,889
RT	2598+23.05	TO	2707+12.50	10,889	12	13	14,520	1,220	1,220	9,801	
GAP STA 2707+12.50 TO STA 2710+62.00											
	2710+62.00	TO	2729+86.62								
LT	2710+62.00	TO	2729+86.62	1,925	12	13	2,567	216	216	1,732	1,925
RT	2710+62.00	TO	2729+86.62	1,925	12	13	2,567	216	216	1,732	
MAINLINE TOTALS						55	34,174	2,871	2,871	23,065	12,814

*LONGITUDINAL JOINT SEALANT SHALL BE PLACED UNDER THE HMA SURFACE LIFT

**PAVEMENT RESURFACING SCHEDULE - RAMPS
I-57/IL 146 INTERCHANGE RAMPS/ REST AREA RAMPS**

LOCATION	LENGTH (INFO ONLY)	EXIST. PAVE WIDTH	SHOULDER WIDTH	TEMP. RAMPS	HMA SURFACE REMOVAL BUTT JOINT	HMA SURFACE REMOVAL 3"	POLY HMA SURFACE COURSE 1 1/2"	POLY HMA BINDER COURSE 1 1/2"	POLY. BIT. MAT'LS. (TACK COAT)			
										FEET	FEET	FEET
EXIT RAMP (I-57) SOUTHBOUND AT REST AREA												
MAIN-I-57	2612+24	TO	2615+16	292				260	22	22	176	
MAIN RAMP	2615+16	TO	2619+17	401	16	6 FT LT & 8 FT RT		713	60	60	642	
MAIN STATION RAMP	+00	TO	1+74	174	16	6 FT LT & 8 FT RT	18	107	311	27	27	
ENTRANCE RAMP (I-57) SOUTHBOUND AT REST												
MAIN-I-57	2638+53	TO	2647+92	939	VAR.			1,173	99	99	792	
MAIN RAMP	17+93	TO	21+98	405	16	6 FT LT & 8 FT RT	18	107	720	61	61	486
RAMP D EXIT (I-57) SOUTHBOUND AT IL 146												
MAIN-I-57	2697+95	TO	2701+46	351	VAR.	6		405	35	35	274	
MAIN RAMP	+00	TO	1+65	165	14	4FT LT & 6 FT RT	16	94	294	22	22	174
RAMP C ENTRANCE (I-57) SOUTHBOUND AT IL 146												
MAIN-I-57	2719+98	TO	2727+98	800		6		889	75	75	600	
MAIN RAMP	+00	TO	3+40	340	14	4FT LT & 10 FT RT	16	93	530	45	45	358
RAMP TOTALS							68	401	5,295	446	446	3,502

MODEL: Default
FILE: \\nas101\pub\B&E\BID\ITEC\Illinois\gov\p\WIDOT\Documents\BID\Office\BIDirect\9\Projects\78693\CADDData\CAD\Sheet\078693_Sheets.dgn

USER NAME = rollavr	DESIGNED - _____	REVISED - _____
	DRAWN - _____	REVISED - _____
PLOT SCALE = 100.0000' / in.	CHECKED - _____	REVISED - _____
PLOT DATE = 11/30/2018	DATE - _____	REVISED - _____

**STATE OF ILLINOIS
DEPARTMENT OF TRANSPORTATION**

RESURFACING SCHEDULE			
SCALE: N.T.S.	SHEET 1 OF 5 SHEETS	STA. _____	TO STA. _____

F.A.I. RTE. 57	SECTION (91-3)RS-4	COUNTY UNION	TOTAL SHEETS 27	SHEET NO. 12
CONTRACT NO. 78693			ILLINOIS FED. AID PROJECT	

PAVEMENT DELINEATION SCHEDULE

LOCATION STATION TO STATION	LENGTH (INFORMATION ONLY)	RAISED REFLECTIVE PAVEMENT MARKER REMOVAL	RAISED REFLECTIVE PAVEMENT MARKERS		NOTES
			CRYSTAL	CRYSTAL	
SOUTHBOUND LANES	FEET	EACH	EACH	EACH	
MAIN S.B. LANE					
2598+23.05 TO 2707+12.50	10,889	137	137		
GAP STR. NO. 091-0012					
2707+12.50 TO 2710+62.00					BRIDGE STRUCTURE
MAIN S.B. LANE					
2710+62.00 TO 2729+86.62	1,925	25	25		
SUB-TOTALS SOUTHBOUND LANES					
		162	162		
IL 146 EXIT RAMP D					
2694+82.74 TO 2701+46.14	663	0	0		
I-57 STA. 2699+95.52 = RAMP D STA 0+00					
2697+94.87 TO 2701+46.14	351	20	20		
+00 TO 1+65.00	165	14	14		
SUB-TOTALS RAMP D					
		34	34		
IL 146 ENTRANCE RAMP C					
2718+45.79 TO 2727+97.66	952	0	0		
I-57 STA. 2718+97.79 = RAMP C STA 0+00					
2718+45.79 TO 2727+98.00	952	13	13		LF RT RAMP = 800 FT
+00 TO 3+48.00	348	48	48		LF CURVE=347 FT LF GORE = 152 FT
SUB-TOTALS RAMP C					
		61	61		
I-57 S.B. EXIT RAMP-REST AREA					
2612+24.00 TO 2620+78.45	854	0	0		
I-57 STA. 2615+16.35 = EXIT RAMP STA 0+00					
2612+24.00 TO 2620+78.45	854	29	29		LF CURVE = 175 FT LF GORE = 562 FT
+00 TO 1+74.49	174	44	44		LF RT = 693 FT
SUB-TOTALS EXIT RAMP REST AREA					
		73	73		
I-57 S.B. ENTRANCE RAMP REST AREA					
2636+11.10 TO 2647+92.00	1,181	0	0		
I-57 STA. 2638+52.70 = ENTRANCE RAMP STA 21+97.96					
2636+11.10 TO 2647+92.00	1,181	16	16		LF GORE = 242 FT LF = 938 FT
17+93.37 TO 21+97.96	405	68	68		
SUB-TOTALS ENTRANCE RAMP REST AREA					
		84	84		
TOTALS					
		415	415		

MODEL: Default
 FILE: \\mhc-pw\ulb\B&E\BID\ITEC\Illinois\gov\pww\DOT\Documents\DOT Office\DIR\et 9\Project\78693\CADD\Drawn\CAD\Sheet\078693_Sheets.dgn

USER NAME = handycr	DESIGNED -	REVISED -
	DRAWN -	REVISED -
PLOT SCALE = 100.0000 ' / in.	CHECKED -	REVISED -
PLOT DATE = 10/19/2018	DATE -	REVISED -

**STATE OF ILLINOIS
DEPARTMENT OF TRANSPORTATION**

**RESURFACING SCHEDULE
SHOULDER /RUMBLE STRIPS SCHEDULE**

SCALE: N.T.S. SHEET 2 OF 5 SHEETS STA. TO STA.

F.A.I RTE.	SECTION	COUNTY	TOTAL SHEETS	SHEET NO.
57	(91-3)RS-4	UNION	27	13
CONTRACT NO. 78693			ILLINOIS FED. AID PROJECT	

PATCHING SURVEY I-57 SOUTHBOUND MAIN LINE

LOC.	LANE	MILE	WIDTH	LENGTH	AREA	CLASS D TY II	CLASS D TY III	CLASS D TY IV
			FT	FT	SQYD	SQYD	SQYD	SQYD
SB	DL	0.0	12	6	8.00	8.00		
SB	DL	0.0	12	6	8.00	8.00		
SB	DL	0.0	12	6	8.00	8.00		
SB	DL	0.0	12	6	8.00	8.00		
SB	DL	0.0	12	6	8.00	8.00		
SB	DL	0.0	12	12			16.00	
SB	DL	0.4	12	12			16.00	
SB	DL	0.5	12	10	13.33	13.33		
SB	DL	0.5	12	6	8.00	8.00		
SB	DL	0.7	12	6	8.00	8.00		
SB	DL	0.7	12	6	8.00	8.00		
SB	DL	0.7	12	6	8.00	8.00		
SB	DL	0.8	12	6	8.00	8.00		
SB	DL	0.9	12	6	8.00	8.00		
SB	DL	1.0	12	10	13.33	13.33		
SB	DL	1.3	12	8	10.67	10.67		
SB	DL	1.5	12	12			16.00	
SB	DL	1.8	12	6	8.00	8.00		
SB	DL	1.8	12	12			16.00	
SB	DL	1.8	12	6	8.00	8.00		
SB	DL	1.8	12	12			16.00	
SB	DL	1.8	12	6	8.00	8.00		
SB	DL	1.9	12	12			16.00	
SB	DL	1.9	12	20				26.67
SB	DL	2.2	12	6	8.00	8.00		
						166	96	27

PATCHING QUANTITIES ARE FOR ESTIMATING PURPOSES ONLY.
THE FINAL LOCATIONS AND QUANTITIES WILL BE DETERMINED BY THE ENGINEER.

MODEL: Default
FILE NAME: P:\IL08\B&E\BIDD\ITEC\Illinois\gov\PI\DOT\Documents\DOT_Offices\Director\9\Projects\78693\CaddData\CAD\Sheet\07\8693_Sheets.dgn

USER NAME = rollavr	DESIGNED - _____	REVISED - _____	STATE OF ILLINOIS DEPARTMENT OF TRANSPORTATION	PATCHING SCHEDULE		F.A.I. RTE. =	SECTION	COUNTY	TOTAL SHEETS	SHEET NO.	
PLOT SCALE = 100,0000' / in.	DRAWN - _____	REVISED - _____		SCALE: N.T.S.	SHEET 5 OF 5 SHEETS	STA. _____ TO STA. _____	57	(91-3)RS-4	UNION	27	16
PLOT DATE = 11/30/2018	CHECKED - _____	REVISED - _____								CONTRACT NO. 78693	
	DATE - _____	REVISED - _____								ILLINOIS FED. AID PROJECT	

DETAILS - I-57 SOUTHBOUND ENTRANCE RAMP TERMINAL AT REST AREA

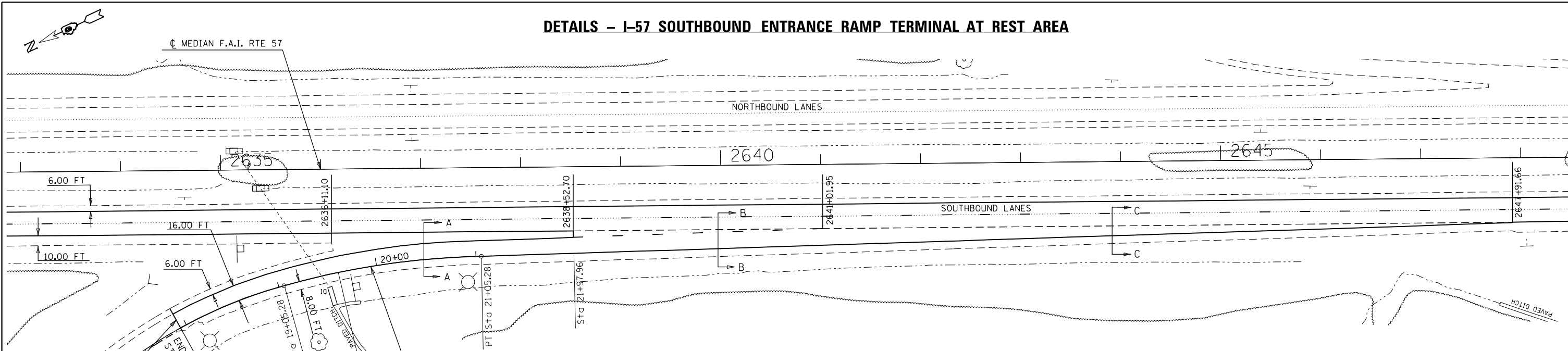

PROP. BUTT JOINT
SEE DETAIL SHEET 27

EXIST. CURVE SB-RA-S-1
PI STA. = 17+50.48
Δ = 38° 32' 31" (RT)
D = 11° 57' 26"
R = 479.17'
T = 167.53'
L = 322.33'
E = 28.44'
e = -----
T.R. = -----
S.E. RUN = -----
P.C. STA. = 15+82.95
P.T. STA. = 19+05.28

EXIST. CURVE SB-RA-S-2
PI STA. = 20+05.83
Δ = 14° 37' 03" (RT)
D = 7° 18' 31"
R = 783.94'
T = 100.55'
L = 200.00'
E = 6.42'
e = -----
T.R. = -----
S.E. RUN = -----
P.C. STA. = 19+05.28
P.T. STA. = 21+05.28

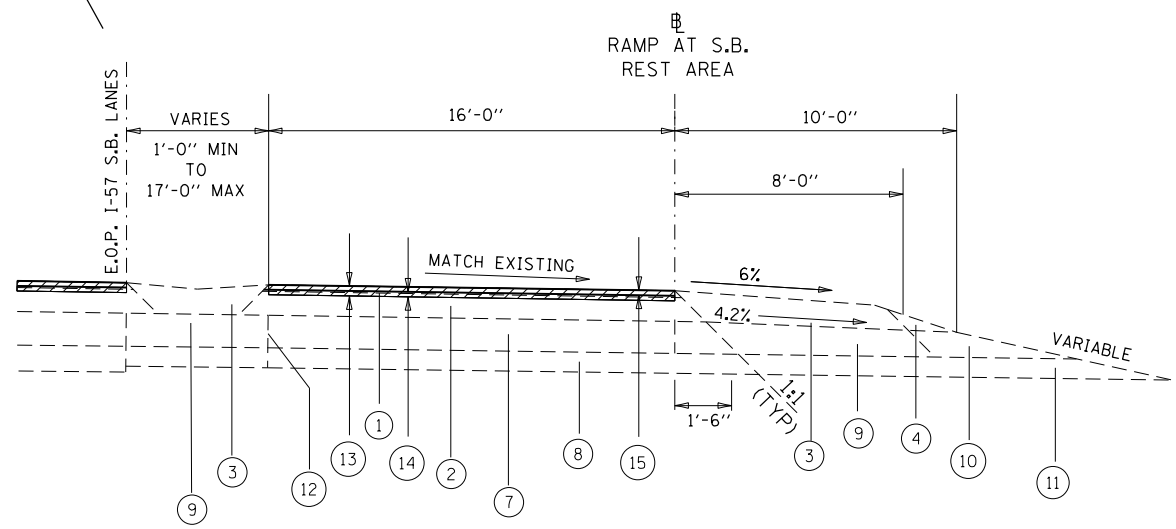

SECTION A-A

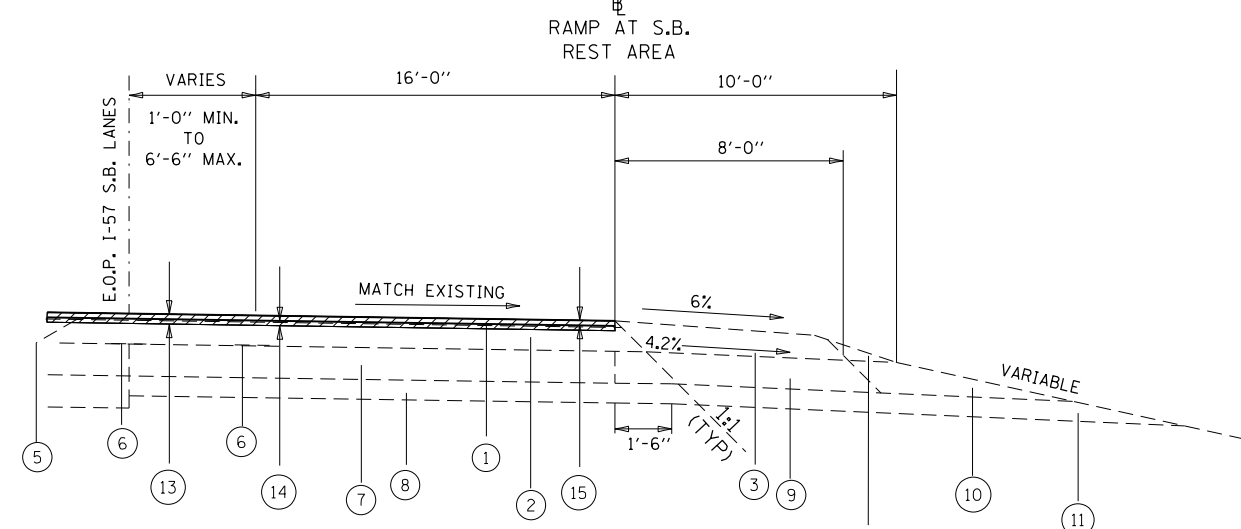

SECTION B-B

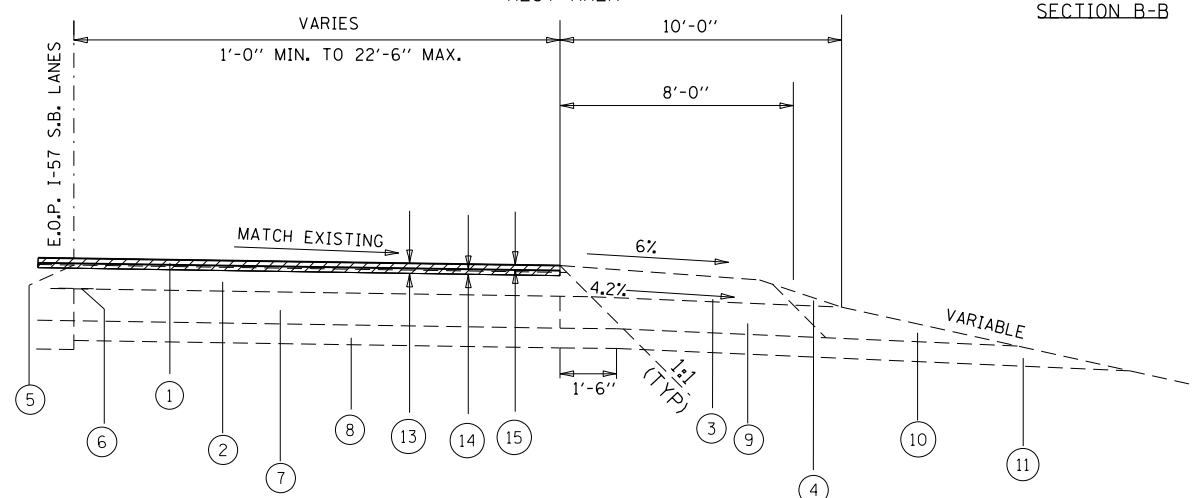

SECTION C-C

- ① 2" HMA SURFACE COURSE
- ② 7" HMA BINDER COURSE
- ③ EXISTING 7"± HMA SHOULDERS
- ④ EXISTING AGGREGATE SHOULDERS, TYPE B
- ⑤ EXISTING SAW JOINT WITH JOINT SEALER
- ⑥ EXISTING STRIP RELECTIVE CRACK CONTROL TREATMENT
- ⑦ EXISTING 10" P.C.C. PAVEMENT
- ⑧ EXISTING 4" SUB-BASE GRANULAR MATERIAL
- ⑨ EXISTING 10" STABILIZED SHOULDER
- ⑩ EXISTING AGGREGATE SHOULDER
- ⑪ EXISTING 4" SUB-BASE GRANULAR MATERIAL
- ⑫ EXISTING LONGITUDINAL METAL JOINT
- ⑬ PROPOSED HMA SURFACE REMOVAL, 3"
- ⑭ PROPOSED POLY. LEVELING BINDER (MACHINE METHOD), IL-9.5FG, N90, 1 1/2"
- ⑮ PROPOSED POLY. HMA SURFACE COURSE, MIX. D, N90, 1 1/2"

MODEL: Default
FILE: \\nas01\pwworking\Illinois\pwworking\Projects\78693\Cadd\Drawings\78693-Sheets.dwg
C:\Users\jrb\OneDrive\Documents\78693-Cadd\Drawings\78693-Sheets.dwg

USER NAME = rollavr	DESIGNED - _____	REVISED - _____
PLOT SCALE = 100,0000' / in.	DRAWN - _____	REVISED - _____
PLOT DATE = 11/30/2018	CHECKED - _____	REVISED - _____
	DATE - _____	REVISED - _____

**STATE OF ILLINOIS
DEPARTMENT OF TRANSPORTATION**

DETAILS	
ENTRANCE RAMP TERMINAL AT REST AREA	
SCALE: N.T.S.	SHEET ____ OF ____ SHEETS
STA. 2636+11.10 TO STA. 2647+91.66	

F.A.I. RTE. = 57	SECTION = (91-3)RS-4	COUNTY = UNION	TOTAL SHEETS = 27	SHEET NO. = 18
CONTRACT NO. 78693				
ILLINOIS FED. AID PROJECT				

DETAILS - I-57 SOUTHBOUND EXIT RAMP D TERMINAL AT ILL. RTE 146

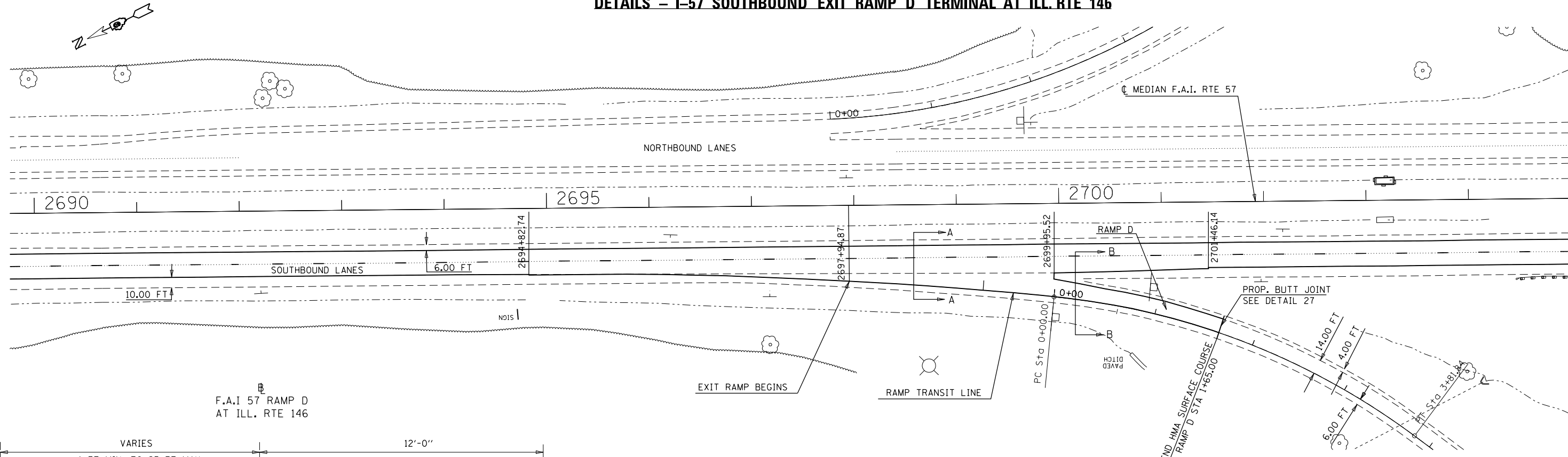

EXIST. CURVE SB-RA-N-1
 PI STA. = 1+00.50
 $\Delta = 13^\circ 42' 37''$ (RT)
 $D = 6^\circ 51' 13''$
 $R = 835.98'$
 $T = 100.50'$
 $L = 200.04'$
 $E = 6.02'$
 $e = \text{---}$
 $T.R. = \text{---}$
 $S.E. \text{ RUN} = \text{---}$
 $P.C. \text{ STA.} = 0+00.00$
 $P.T. \text{ STA.} = 2+00.04$

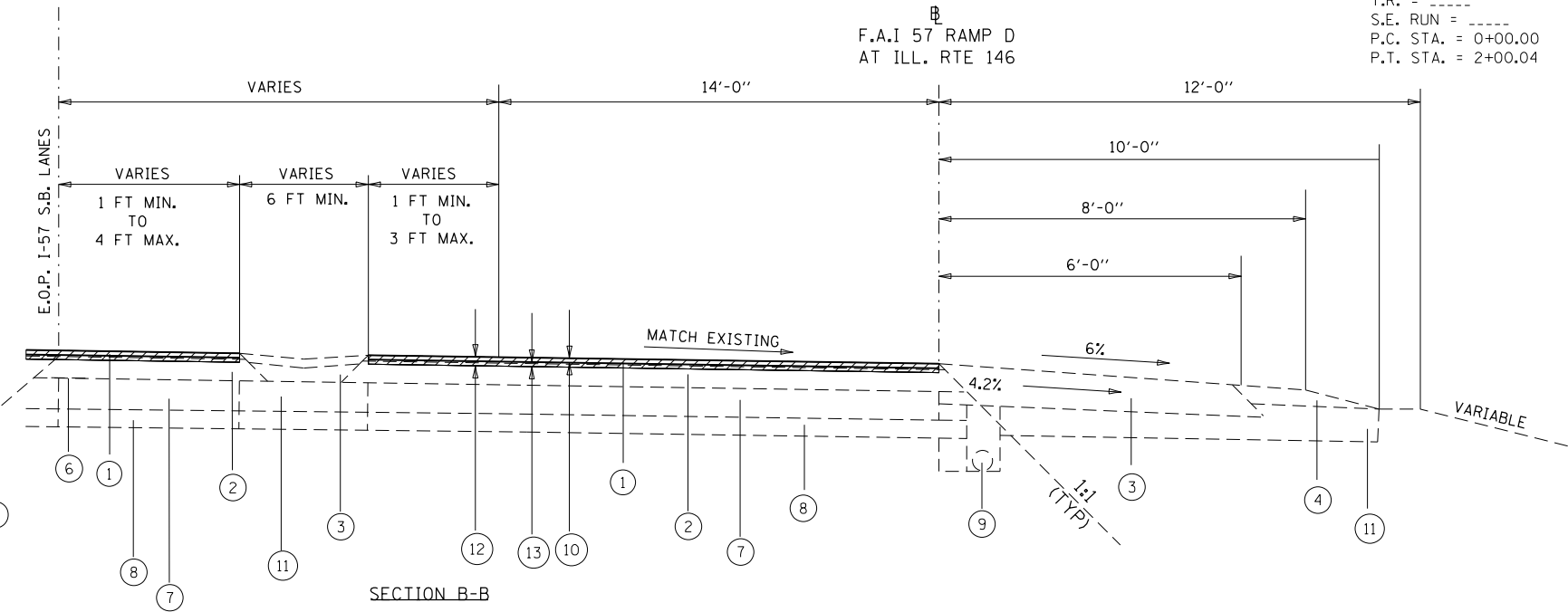
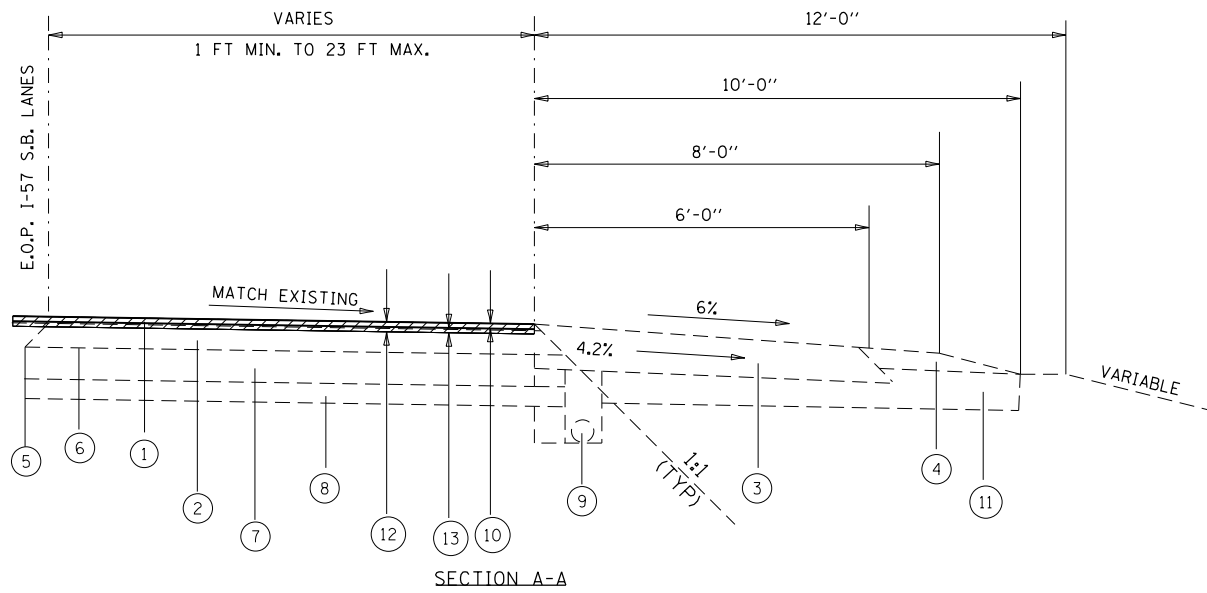

- ① EXISTING 2" HMA SURFACE COURSE
- ② EXISTING 7" HMA BINDER COURSE
- ③ EXISTING 13"± HMA SHOULDERS
- ④ EXISTING AGGREGATE SHOULDERS, TYPE B
- ⑤ EXISTING SAW JOINT WITH JOINT SEALER
- ⑥ EXISTING STRIP RELECTIVE CRACK CONTROL TREATMENT
- ⑦ EXISTING 10" P.C.C. PAVEMENT
- ⑧ EXISTING 6" SUB-BASE GRANULAR MATERIAL
- ⑨ EXISTING 4" PIPE UNDERDRAIN
- ⑩ PROPOSED POLY. HMA SURFACE COURSE, MIX. D, N90, 1 1/2"
- ⑪ EXISTING 5" AND VARIABLE DEPTH CRUSHED STONE SHOULDER
- ⑫ PROPOSED HMA SURFACE REMOVAL, 3"
- ⑬ PROPOSED POLY. LEVELING BINDER (MACHINE METHOD), IL-9.5FG, N90, 1 1/2"

MODEL: Default
 FILE: \\nas01c.psu.edu\BEBID\NTEC\Illinois\gov\pww\DOT\Documents\1801\91-31RS-4\91-31RS-4-19-18.dwg
 PROJECT: 91-31RS-4
 SHEET: 19

USER NAME = rollavr	DESIGNED - _____	REVISED - _____
DRAWN - _____	REVISIONS - _____	REVISIONS - _____
PLOT SCALE = 100,0000' / in.	CHECKED - _____	REVISIONS - _____
PLOT DATE = 11/30/2018	DATE - _____	REVISIONS - _____

STATE OF ILLINOIS
 DEPARTMENT OF TRANSPORTATION

DETAILS
 EXIT RAMP TERMINAL AT ILL. RTE 146
 SCALE: N.T.S. SHEET ___ OF ___ SHEETS STA. 2694+82.74 TO STA. 2701+46.14

F.A.I. RTE. = 57	SECTION = (91-31RS-4)	COUNTY = UNION	TOTAL SHEETS = 27	SHEET NO. = 19
CONTRACT NO. 78693			ILLINOIS FED. AID PROJECT	

DETAILS - I-57 SOUTHBOUND ENTRANCE RAMP C TERMINAL AT ILL. RTE 146

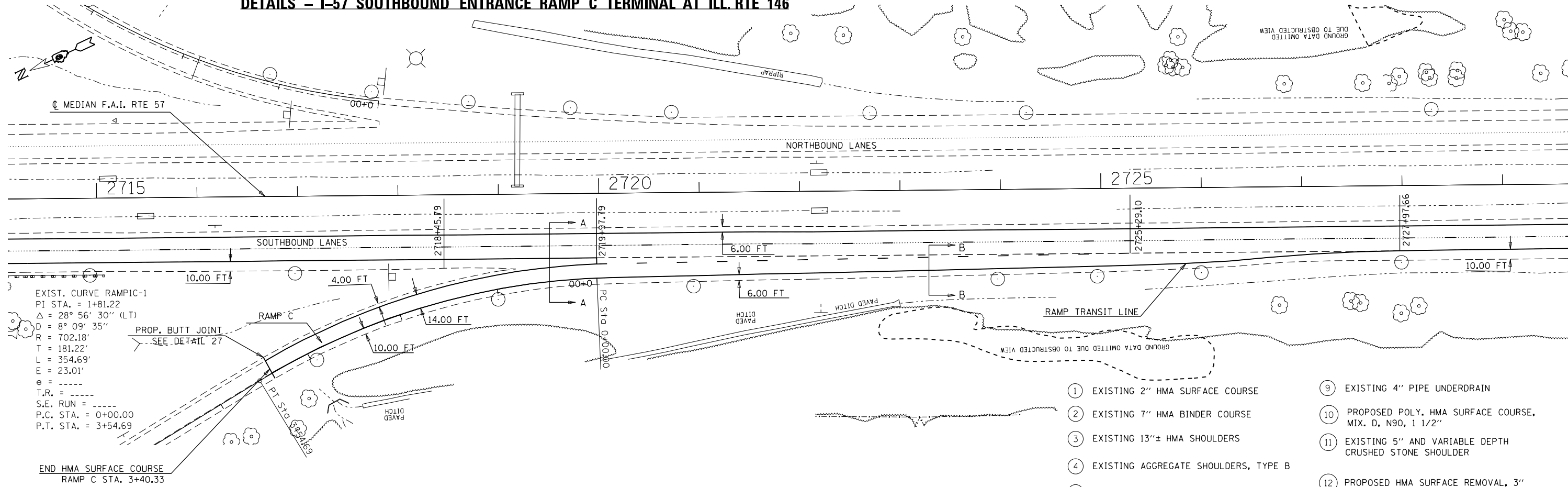

EXIST. CURVE RAMPIC-1
 PI STA. = 1+81.22
 $\Delta = 28^\circ 56' 30''$ (LT)
 $D = 8^\circ 09' 35''$
 $R = 702.18'$
 $T = 181.22'$
 $L = 354.69'$
 $E = 23.01'$
 $e =$
 $T.R. =$
 $S.E. RUN =$
 $P.C. STA. = 0+00.00$
 $P.T. STA. = 3+54.69$

- 1 EXISTING 2" HMA SURFACE COURSE
- 2 EXISTING 7" HMA BINDER COURSE
- 3 EXISTING 13"± HMA SHOULDERS
- 4 EXISTING AGGREGATE SHOULDERS, TYPE B
- 5 EXISTING SAW JOINT WITH JOINT SEALER
- 6 EXISTING STRIP SELECTIVE CRACK CONTROL TREATMENT
- 7 EXISTING 10" P.C.C. PAVEMENT
- 8 EXISTING 6" SUB-BASE GRANULAR MATERIAL
- 9 EXISTING 4" PIPE UNDERDRAIN
- 10 PROPOSED POLY. HMA SURFACE COURSE, MIX. D, N90, 1 1/2"
- 11 EXISTING 5" AND VARIABLE DEPTH CRUSHED STONE SHOULDER
- 12 PROPOSED HMA SURFACE REMOVAL, 3"
- 13 PROPOSED POLY. LEVELING BINDER (MACHINE METHOD), IL-9.5FG, N90, 1 1/2"

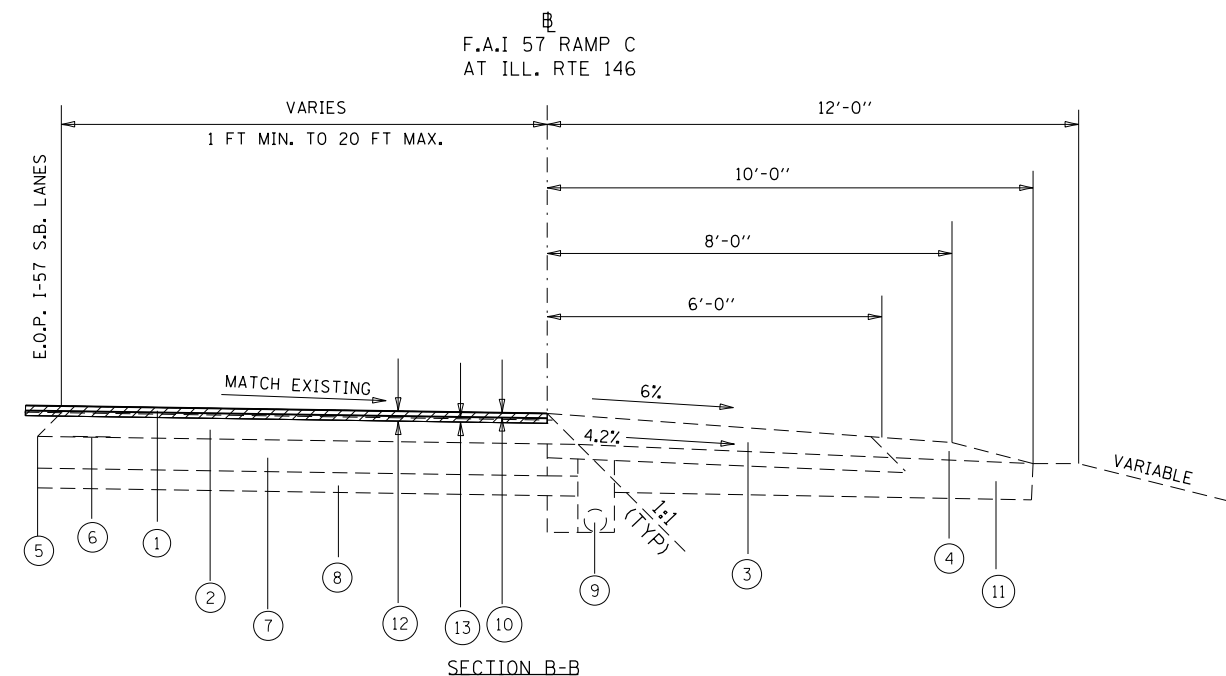
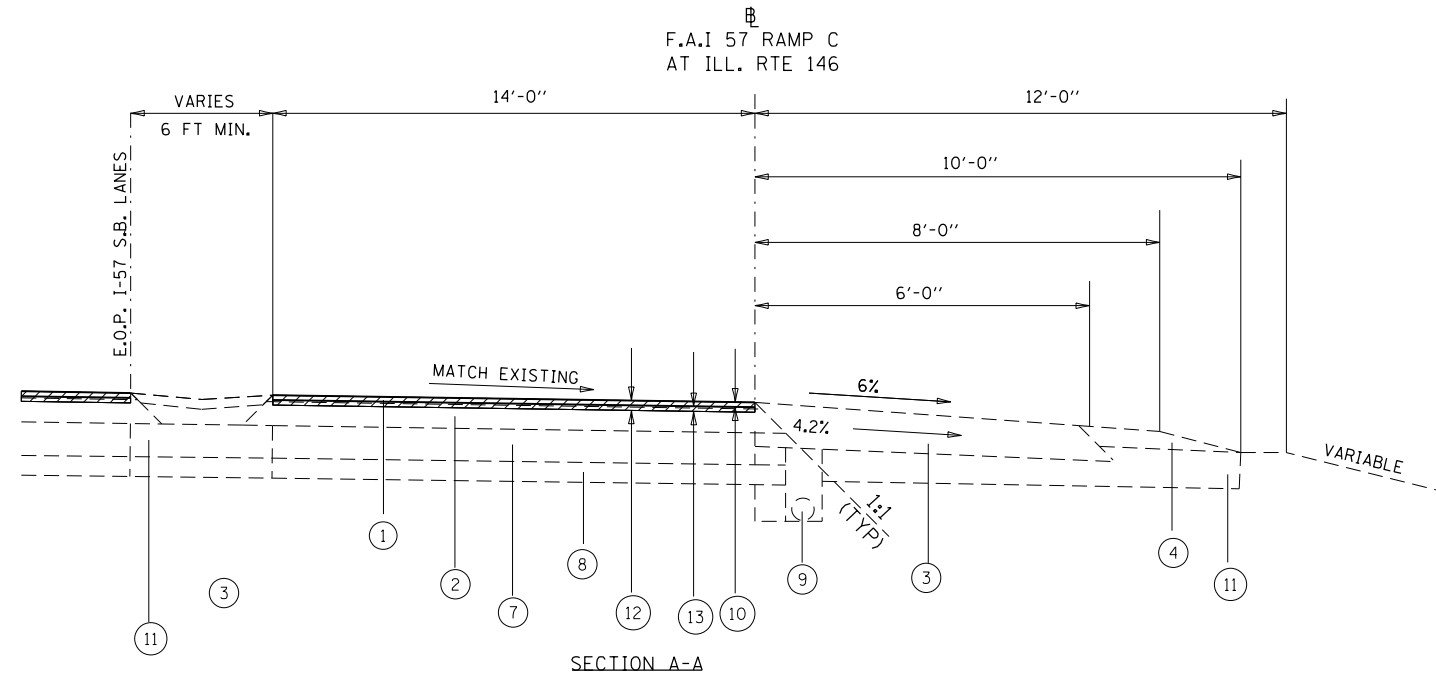

MODEL: Default
 FILE: \\nas0101\B&E\ID\NTEC\Illinois\gov\p\WIDOT\Documents\DOT_Offices\Director_9\Projects\78693\CaddData\CAD\Sheets\0778693_Sheets.dgn

USER NAME = rollavr	DESIGNED - _____	REVISED - _____
DRAWN - _____	REVISIONS - _____	REVISIONS - _____
PLOT SCALE = 100.0000' / in.	CHECKED - _____	REVISIONS - _____
PLOT DATE = 11/30/2018	DATE - _____	REVISIONS - _____

**STATE OF ILLINOIS
 DEPARTMENT OF TRANSPORTATION**

DETAILS
ENTRANCE RAMP TERMINAL AT ILL. RTE. 146

SCALE: N.T.S. SHEET ___ OF ___ SHEETS STA. 2718+45.79 TO STA. 2727+97.66

F.A.I. RTE.	SECTION	COUNTY	TOTAL SHEETS	SHEET NO.
57	(91-3)RS-4	UNION	27	20
CONTRACT NO. 78693				
ILLINOIS FED. AID PROJECT				

EXIST. CURVE RAMP1A-1
 PI STA. = 1+81.21
 $\Delta = 28^\circ 56' 30''$ (LT)
 $D = 8^\circ 09' 35''$
 $R = 702.18'$
 $T = 181.21'$
 $L = 354.69'$
 $E = 23.01'$
 $e = \text{---}$
 T.R. = ---
 S.E. RUN = ---
 P.C. STA. = 0+00.00
 P.T. STA. = 3+54.69

EXIST. CURVE RAMP1A-2
 PI STA. = 8+03.58
 $\Delta = 20^\circ 26' 57''$ (RT)
 $D = 8^\circ 09' 35''$
 $R = 702.18'$
 $T = 126.65'$
 $L = 250.61'$
 $E = 11.33'$
 $e = \text{---}$
 T.R. = ---
 S.E. RUN = ---
 P.C. STA. = 6+76.93
 P.T. STA. = 9+27.54

EXIST. CURVE RAMP1B-1
 PI STA. = 1+95.77
 $\Delta = 31^\circ 09' 26''$ (RT)
 $D = 8^\circ 09' 35''$
 $R = 702.18'$
 $T = 195.77'$
 $L = 381.84'$
 $E = 26.78'$
 $e = \text{---}$
 T.R. = ---
 S.E. RUN = ---
 P.C. STA. = 0+00.00
 P.T. STA. = 3+81.84

EXIST. CURVE RAMP1B-2
 PI STA. = 7+15.67
 $\Delta = 27^\circ 38' 37''$ (LT)
 $D = 8^\circ 09' 35''$
 $R = 702.18'$
 $T = 172.75'$
 $L = 338.78'$
 $E = 20.94'$
 $e = \text{---}$
 T.R. = ---
 S.E. RUN = ---
 P.C. STA. = 5+42.91
 P.T. STA. = 8+81.69

EXIST. CURVE RAMP1D-1
 PI STA. = 1+95.77
 $\Delta = 31^\circ 09' 26''$ (RT)
 $D = 8^\circ 09' 35''$
 $R = 702.18'$
 $T = 195.77'$
 $L = 381.84'$
 $E = 26.78'$
 $e = \text{---}$
 T.R. = ---
 S.E. RUN = ---
 P.C. STA. = 0+00.00
 P.T. STA. = 3+81.84

EXIST. CURVE RAMP1D-2
 PI STA. = 7+15.67
 $\Delta = 27^\circ 38' 37''$ (LT)
 $D = 8^\circ 09' 35''$
 $R = 702.18'$
 $T = 172.75'$
 $L = 338.78'$
 $E = 20.94'$
 $e = \text{---}$
 T.R. = ---
 S.E. RUN = ---
 P.C. STA. = 5+42.91
 P.T. STA. = 8+81.69

EXIST. CURVE RAMP1C-1
 PI STA. = 1+81.22
 $\Delta = 28^\circ 56' 30''$ (LT)
 $D = 8^\circ 09' 35''$
 $R = 702.18'$
 $T = 181.22'$
 $L = 354.69'$
 $E = 23.01'$
 $e = \text{---}$
 T.R. = ---
 S.E. RUN = ---
 P.C. STA. = 0+00.00
 P.T. STA. = 3+54.69

EXIST. CURVE RAMP1C-2
 PI STA. = 8+03.58
 $\Delta = 20^\circ 26' 57''$ (RT)
 $D = 8^\circ 09' 35''$
 $R = 702.18'$
 $T = 126.65'$
 $L = 250.61'$
 $E = 11.33'$
 $e = \text{---}$
 T.R. = ---
 S.E. RUN = ---
 P.C. STA. = 6+76.93
 P.T. STA. = 9+27.54

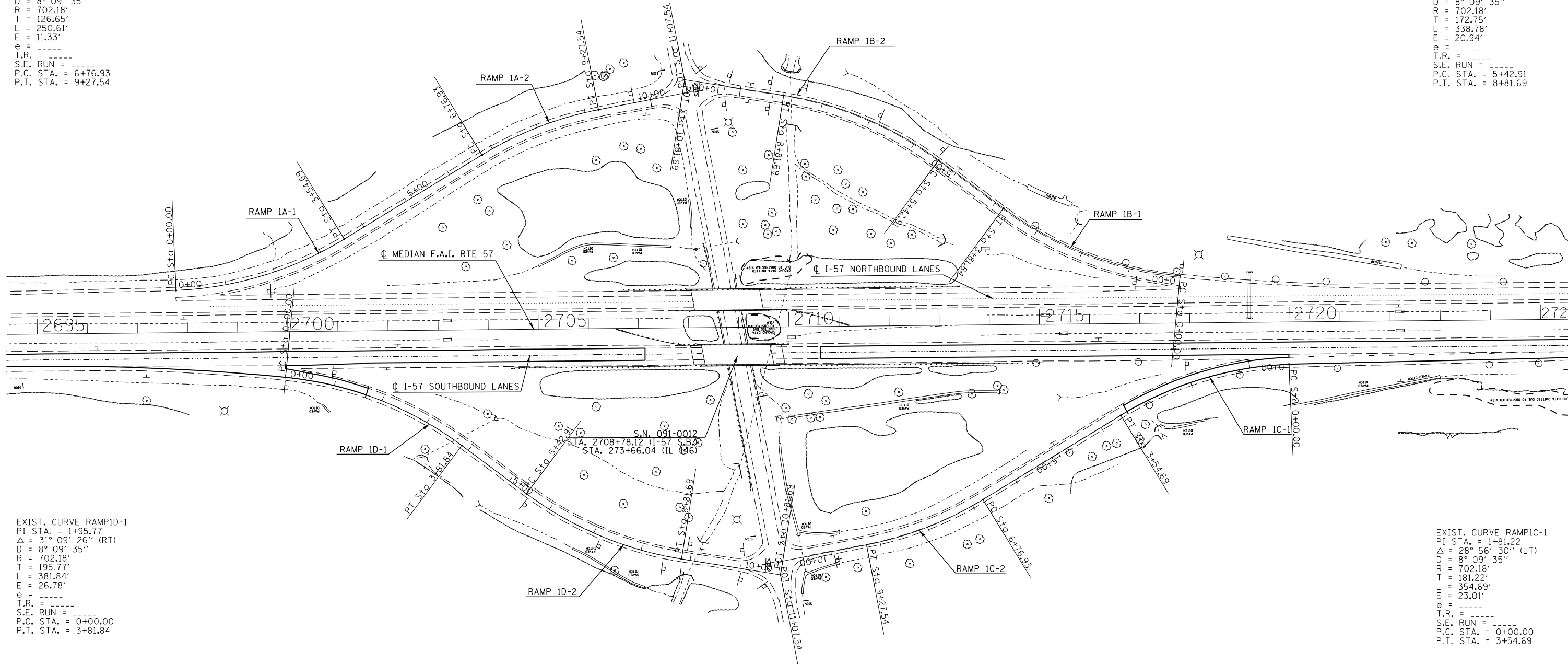
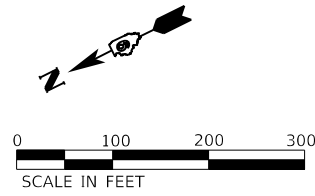

*GAP SOUTH BOUND I-57
 STA. 2707+12.50 TO STA. 2710+62.00

MODEL: Default
 FILE: \\nas0101\BIBED\NTEC\Illinois\pov\p\WDDOT\Documents\DOT_Offices\Director\Projects\78693\CADD\DATA\CAD\Sheet\0778693_Sheets.dgn

USER NAME = handyc	DESIGNED -	REVISED -
PLOT SCALE = 200.0000' / in.	DRAWN -	REVISED -
PLOT DATE = 10/19/2018	CHECKED -	REVISED -
	DATE -	REVISED -

**STATE OF ILLINOIS
 DEPARTMENT OF TRANSPORTATION**

PLAN	
I-57 INTERCHANGE AT ILL. RTE. 146	
SCALE: 1" = 100'	SHEET OF SHEETS STA. 2694+39.55 TO STA. 2725+60.91

F.A.I. RTE.	SECTION	COUNTY	TOTAL SHEETS	SHEET NO.
57	(91-3)RS-4	UNION	27	21
CONTRACT NO. 78693				
ILLINOIS FED. AID PROJECT				

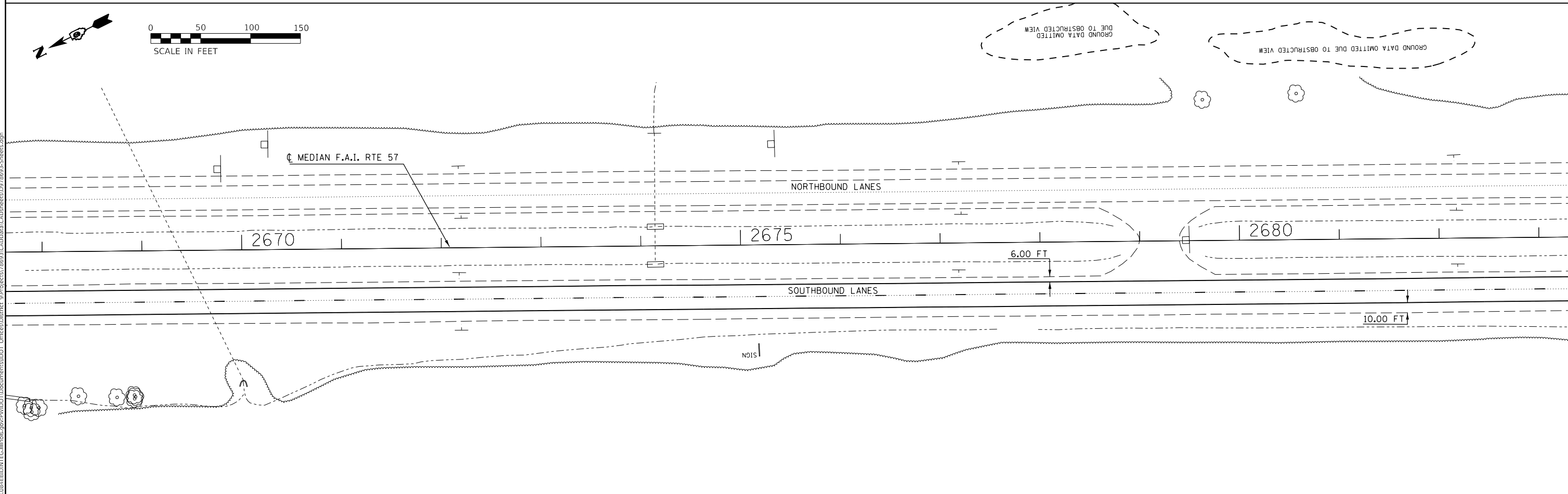
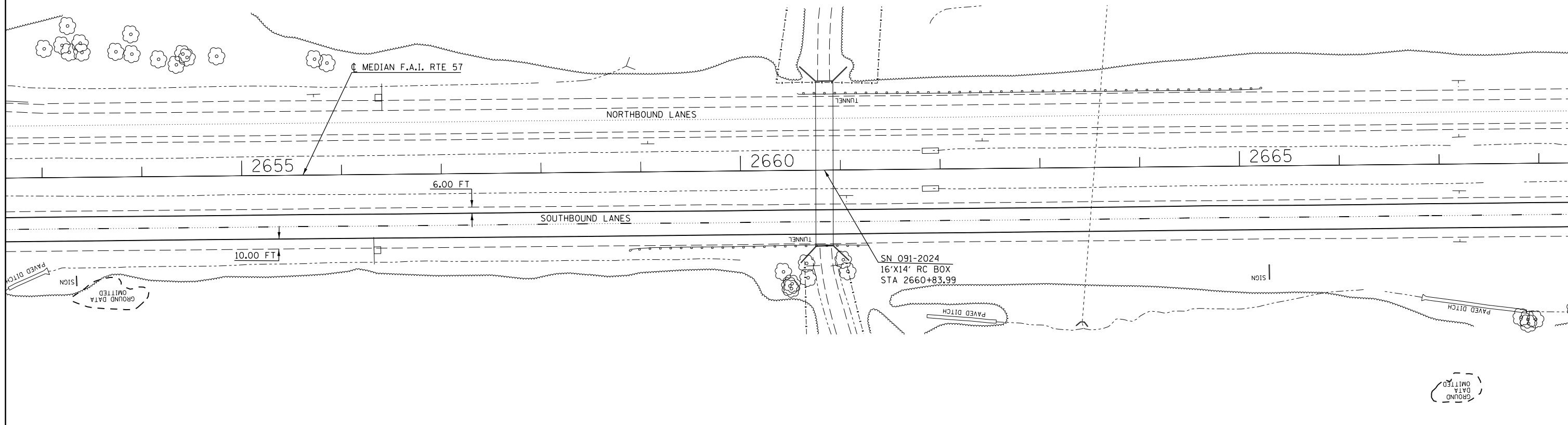

MODEL: Default
 FILE: \\nas0101\B&E\BID\NTEC\Illinois\gov\PIV\DOT\Documents\1\DOT_Offices\1\8693\CADD\B&E\DOT_8693_Sheets.dgn

USER NAME = handyc	DESIGNED -	REVISED -
PLOT SCALE = 100.0000' / in.	DRAWN -	REVISED -
PLOT DATE = 10/19/2018	CHECKED -	REVISED -
	DATE -	REVISED -

**STATE OF ILLINOIS
DEPARTMENT OF TRANSPORTATION**

I-57 PLAN			
SCALE: 1" = 50'	SHEET 3 OF 5 SHEETS	STA. 2652+63.23 TO STA. 2683+38.31	

F.A.I. RTE.	SECTION	COUNTY	TOTAL SHEETS	SHEET NO.
57	(91-3)RS-4	UNION	27	24
CONTRACT NO. 78693				
ILLINOIS FED. AID PROJECT				

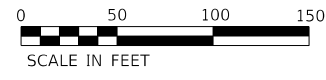

GROUND DATA OMITTED DUE TO OBSTRUCTED VIEW

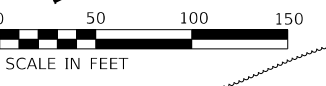
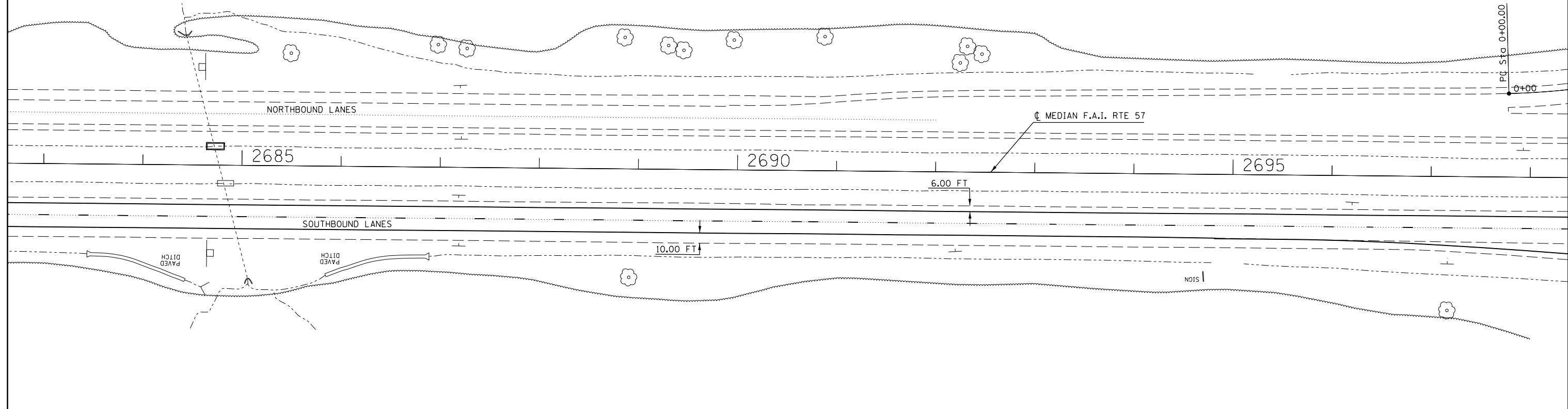

EXIST. CURVE RAMP1A-1
 PI STA. = 1+81.21
 $\Delta = 28^\circ 55' 30''$ (LT)
 $D = 8^\circ 09' 35''$
 $R = 702.18'$
 $T = 181.21'$
 $L = 354.69'$
 $E = 23.01'$
 $e =$
 $T.R. =$
 $S.E. RUN =$
 $P.C. STA. = 0+00.00$
 $P.T. STA. = 3+54.69$

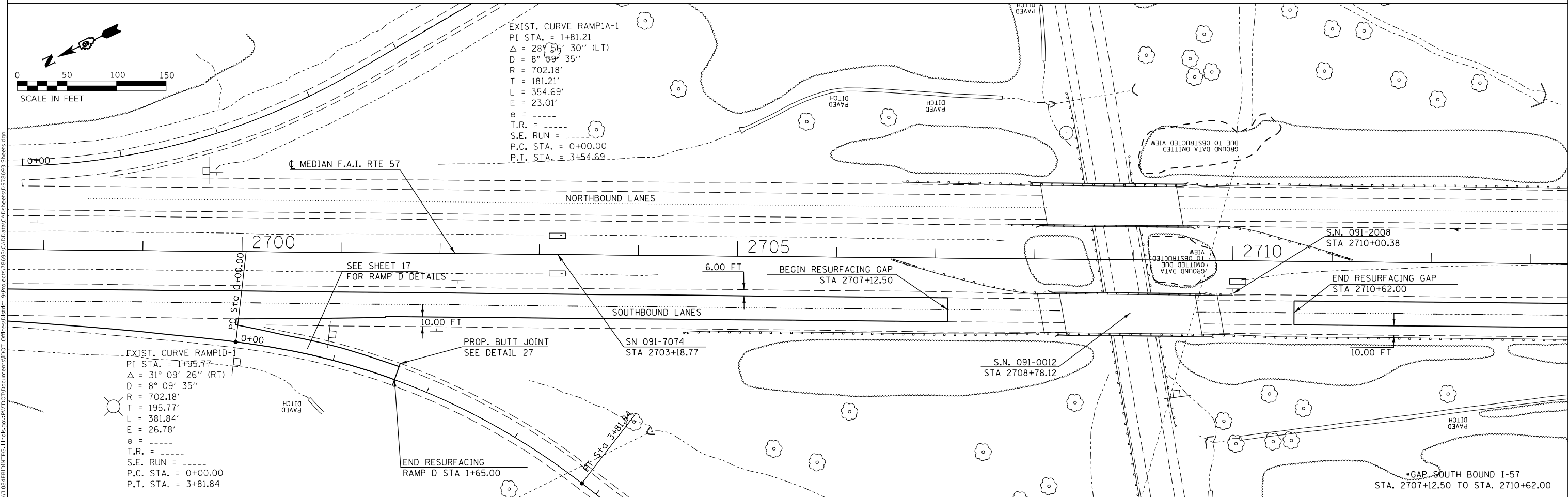

EXIST. CURVE RAMP1D-1
 PI STA. = 1+95.77
 $\Delta = 31^\circ 09' 26''$ (RT)
 $D = 8^\circ 09' 35''$
 $R = 702.18'$
 $T = 195.77'$
 $L = 381.84'$
 $E = 26.78'$
 $e =$
 $T.R. =$
 $S.E. RUN =$
 $P.C. STA. = 0+00.00$
 $P.T. STA. = 3+81.84$

MODEL: Default
 FILE: \\nas010\B&E\ID\NTEC\Illinois\poc\p\RD\DOT\Documents\DOT - Office\Drawings\91\Projects\78693\CADD\Drawings\91\78693_Sheets.dwg

USER NAME = handyc	DESIGNED -	REVISED -
PLOT SCALE = 100.0000' / in.	DRAWN -	REVISED -
PLOT DATE = 10/19/2018	CHECKED -	REVISED -
	DATE -	REVISED -

**STATE OF ILLINOIS
 DEPARTMENT OF TRANSPORTATION**

I-57 PLAN	
SCALE: 1" = 50'	SHEET 4 OF 5 SHEETS
STA. 2682+63.33 TO STA. 2713+38.41	

F.A.I. RTE.	SECTION	COUNTY	TOTAL SHEETS	SHEET NO.
57	(91-3)RS-4	UNION	27	25
CONTRACT NO. 78693				
ILLINOIS FED. AID PROJECT				



EXIST. CURVE RAMP1B-1
 PI STA. = 1+95.77
 $\Delta = 31^\circ 09' 26''$ (RT)
 $D = 8^\circ 09' 35''$
 $R = 702.18'$
 $T = 195.77'$
 $L = 381.84'$
 $E = 26.78'$
 $e =$
 $T.R. =$
 $S.E. RUN =$
 $P.C. STA. = 0+00.00$
 $P.T. STA. = 3+81.84$

CL MEDIAN F.A.I. RTE 57

NORTHBOUND LANES

SOUTHBOUND LANES

2715

2720

2725

EXIST. CURVE RAMP1C-1
 PI STA. = 1+81.22
 $\Delta = 28^\circ 56' 30''$ (LT)
 $D = 8^\circ 09' 35''$
 $R = 702.18'$
 $T = 181.22'$
 $L = 354.69'$
 $E = 23.01'$
 $e =$
 $T.R. =$
 $S.E. RUN =$
 $P.C. STA. = 0+00.00$
 $P.T. STA. = 3+54.69$

END RESURFACING
 RAMP C STA. 3+40.33

PROP. BUTT JOINT
 SEE DETAIL 27

SEE SHEET 18
 FOR RAMP C DETAILS



CL MEDIAN F.A.I. RTE 57

NORTHBOUND LANES

SOUTHBOUND LANES

2730

2745

2750

2755

PROP. PROJECT ENDS
 STA. 2729+86.62

MODEL: Default
 FILE: \\nas01\paulba\BID\NTEC\Illinois\proj\p1\DOT\Documents\DOT Office\Drawings\9\Projects\78693\CADD\DATA\CAD\Sheet\0778693.Sheet.dwg

USER NAME = handycr	DESIGNED -	REVISED -
PLOT SCALE = 100.0000' / in.	DRAWN -	REVISED -
PLOT DATE = 10/19/2018	CHECKED -	REVISED -
	DATE -	REVISED -

**STATE OF ILLINOIS
 DEPARTMENT OF TRANSPORTATION**

I-57 PLAN

SCALE: 1" = 50' SHEET 5 OF 5 SHEETS STA. 2712+51.96 TO STA. 2729+86.62

F.A.I. RTE.	SECTION	COUNTY	TOTAL SHEETS	SHEET NO.
57	(91-3)RS-4	UNION	27	26
CONTRACT NO. 78693				
ILLINOIS FED. AID PROJECT				

