

STATE OF ILLINOIS
DEPARTMENT OF TRANSPORTATION

F.A.P. RTE	SECTION	COUNTY	TOTAL SHEETS	SHEET NO.
VAR	(25) SFY	DEKALB	7	1
		ILLINOIS	CONTRACT NO. 66J13	

INDEX OF SHEETS

- 1 COVER SHEET
- 2 GENERAL NOTES
- 3-4 SUMMARY OF QUANTITIES
- 5-6 FLASHING BEACON LAYOUT PLAN
- 7 DETAILS

LIST OF ILLINOIS DOT HIGHWAY STANDARDS

- 000001-07 STANDARD SYMBOLS, ABBREVIATIONS AND PATTERNS
- 001006 DECIMAL OF AN INCH AND OF A FOOT
- 701001-02 OFF-ROAD OPERATIONS 2L, 2W, MORE THAN 15' (4.5 m) AWAY
- 701006-05 OFF-ROAD OPERATIONS 2L, 2W, 15' (4.5 m) TO 24" (600 mm) FROM PAVEMENT EDGE
- 701201-05 LANE CLOSURE, 2L, 2W, DAY ONLY, FOR SPEEDS ≥ 45 MPH
- 701901-08 TRAFFIC CONTROL DEVICES
- 720001-01 SIGN PANEL MOUNTING DETAILS
- 720006-04 SIGN PANEL ERECTION DETAILS
- 805001-01 ELECTRICAL SERVICE INSTALLATION DETAILS
- 814001-03 HANDHOLES
- 838001-01 BREAKAWAY DEVICES
- 862001-01 UNINTERRUPTABLE POWER SUPPLY (UPS)
- 873001-02 TRAFFIC SIGNAL GROUNDING & BONDING
- 878001-10 CONCRETE FOUNDATION DETAILS
- 880001-01 SPAN WIRE MOUNTED SIGNALS AND FLASHING BEACON INSTALLATION

PROPOSED HIGHWAY PLANS

FAP ROUTE 557 (IL 72) & FAP 324 (IL 23)
SECTION (25) SFY
PROJECT: HSIP-H5NW(429)
FLASHING BEACON INSTALLATION
DEKALB COUNTY

C-93-058-18

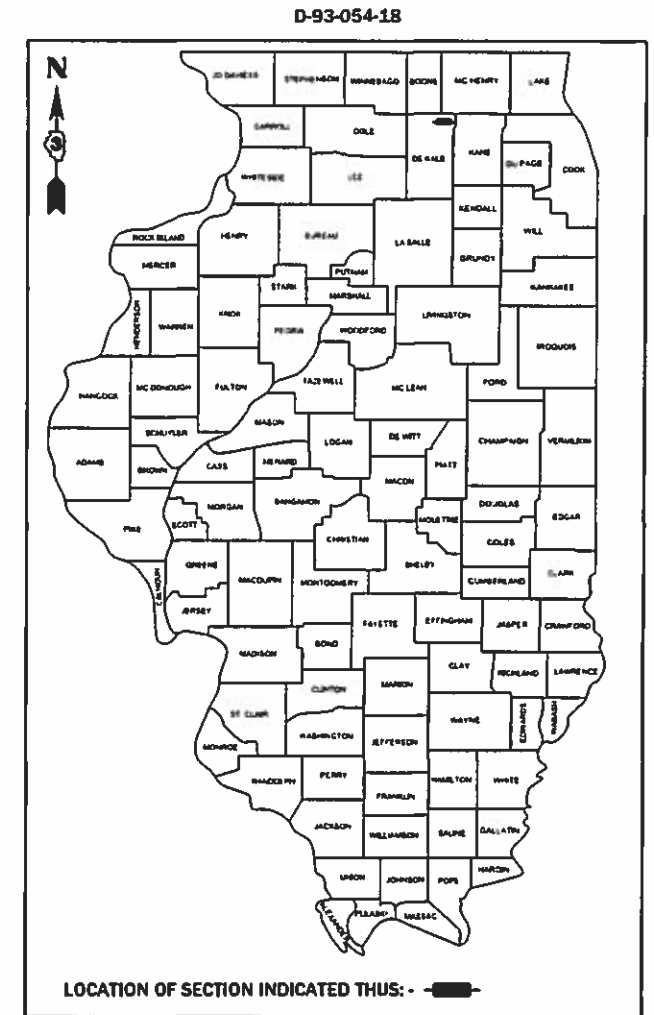

IL 72 - OTHER ARTERIAL
2017 ADT = 6475
P.V. = 92.2% S.U. = 3.0% M.U. = 4.8%

IL 23 - OTHER ARTERIAL
2017 ADT = 2400
P.V. = 91.6% S.U. = 3.8% M.U. = 4.6%

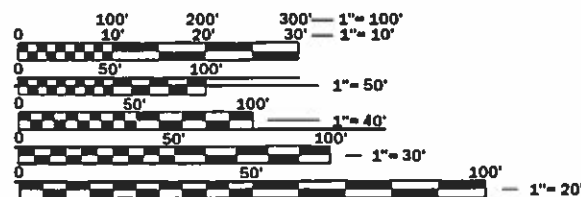

FULL SIZE PLANS HAVE BEEN PREPARED USING STANDARD ENGINEERING SCALES. REDUCED SIZED PLANS WILL NOT CONFORM TO STANDARD SCALES. IN MAKING MEASUREMENTS ON REDUCED PLANS, THE ABOVE SCALES MAY BE USED.

J.U.L.I.E.
JOINT UTILITY LOCATION INFORMATION FOR EXCAVATION
1-800-892-0123
OR 811

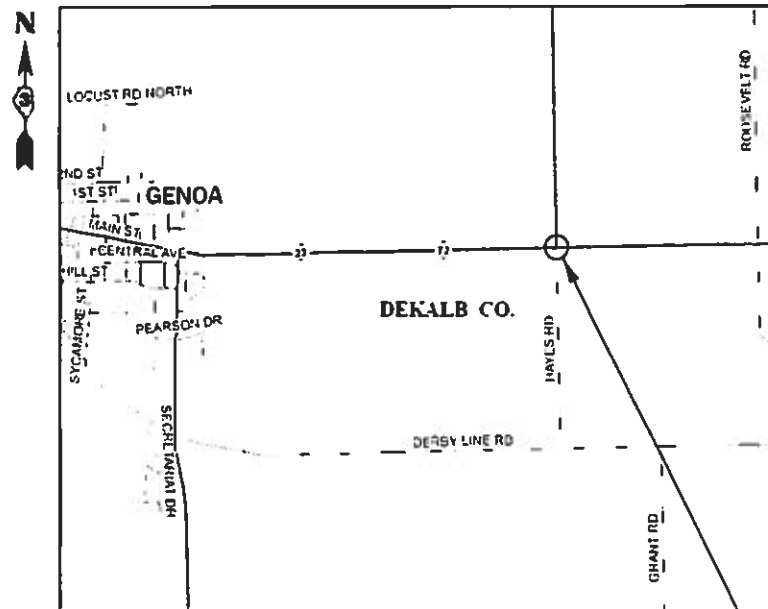

PROJECT LOCATION
INTERSECTION OF IL 72 & IL 23

GROSS LENGTH & NET LENGTH = POINT LOCATION

PROJECT ENGINEER: JOE KANNEL, P.E.
UNIT CHIEF: MARC BUDZYNSKI, P.E.
DISTRICT 3 NO. (815) 434-6131
CONTRACT NO. 66J13

STATE OF ILLINOIS
DEPARTMENT OF TRANSPORTATION

SUBMITTED 10-11-2018
12-7-2018 REGIONAL ENGINEER

Dec 7 2018
ENGINEER OF DESIGN AND ENVIRONMENT

Dec 7 2018
DIRECTOR OF HIGHWAYS PROJECT IMPLEMENTATION

PRINTED BY THE AUTHORITY
OF THE STATE OF ILLINOIS

TRAFFIC SIGNAL GENERAL NOTES

THE TRAFFIC SIGNAL SECTION AT THE ILLINOIS DEPARTMENT OF TRANSPORTATION, DISTRICT 3, SHALL BE NOTIFIED AT 815-434-8506 AT LEAST 72 HOURS PRIOR TO TURNING ON ANY FLASHER OR CONTROLLER UNITS.

THE CONTRACTOR SHALL BE RESPONSIBLE FOR PROTECTING UTILITY PROPERTY DURING CONSTRUCTION OPERATIONS AS OUTLINED IN ARTICLE 107.31 OF THE STANDARD SPECIFICATIONS. A MINIMUM OF 48 HOURS ADVANCE NOTICE IS REQUIRED FOR NON-EMERGENCY WORK. THE JULIE NUMBER IS 800-892-0123. THE MEMBERS OF JULIE KNOWN TO BE WITHIN THE LIMITS OF THE IMPROVEMENT ARE:

- FRONTIER
- COMED
- NICOR

ALL TRAFFIC CONTROL AND OTHER ADVISORY SIGNS NEEDED FOR CONSTRUCTION ARE TO BE FURNISHED BY THE CONTRACTOR IN ACCORDANCE WITH SECTION 701 OF THE STANDARD SPECIFICATIONS.

ALL TRAFFIC SIGNAL HEADS SHALL BE 12-INCH POLYCARBONATE.

TRAFFIC SIGNAL HEADS SHALL BE PROPERLY COVERED PRIOR TO INTERSECTION TURN-ON OR AS DIRECTED BY THE ENGINEER. THIS COST SHALL BE INCLUDED WITH THE COST OF THE ASSOCIATED TRAFFIC SIGNAL PAY ITEMS.

A 1/4" DIAMETER CONTINUOUS RODENT RESISTANT NYLON ROPE SHALL BE FURNISHED AND LEFT IN PLACE IN ALL CONDUITS BETWEEN HANDHOLES AND FOUNDATIONS OR CONTROLLER. THIS COST SHALL BE INCLUDED WITH THE COST OF CONDUIT PAY ITEM.

NO ADDITIONAL COMPENSATION WILL BE ALLOWED FOR PLACING CONDUIT AT A GREATER THAN 2' MINIMUM DEPTH TO AVOID OBSTACLES SUCH AS UNDERGROUND UTILITIES.

THE ELECTRICAL CONDUCTORS FOR ALL TRAFFIC SIGNAL HEADS SHALL BE SOLID, SOFT COPPER.

ALL THREADS OF BOLTS USED IN THE ASSEMBLY OF TRAFFIC SIGNAL COMPONENTS SHALL BE COATED WITH A NON-LEAD BASED ANTI-SEIZE COMPOUND, SIMILAR TO LEAD PLATE, PRIOR TO ASSEMBLY.

ALL HARDWARE SHALL BE TIGHTENED AND WELL SECURED, CABLES SHALL BE NEATLY WOUND IN HANDHOLES. CABLES SHALL BE NEATLY TRAINED IN THE CONTROLLER CABINET.

ALL TRAFFIC SIGNAL WIRING SHALL EXTEND FROM CONTROLLER TO SIGNAL. SPLICES IN JUNCTION BOXES WILL NOT BE ALLOWED.

THE CONTRACTOR SHALL BE RESPONSIBLE FOR OBTAINING ELECTRICAL SERVICE FOR THE TRAFFIC SIGNALS. THE CONTRACTOR SHALL CONTACT THE UTILITY COMPANY PRIOR TO BEGINNING WORK TO OBTAIN THE UTILITY COMPANY REQUIREMENTS FOR THE SERVICE INSTALLATION.

BACKPLATES SHALL BE POLYCARBONATE, LOUVERED FORMED BACKPLATES.

ALL VEHICLE AND PEDESTRIAN SIGNAL HEADS SHALL HAVE POLYCARBONATE BLACK HOUSING AND BLACK BRACKETS.

ALL UNINTERRUPTIBLE POWER SUPPLIES SHALL BE EQUIPPED WITH ALPHA GUARD MONITORS.

ALL GROUNDING MATERIALS FOR CONCRETE FOUNDATIONS SHALL REFER TO SECTION 807 OF THE STANDARD SPECIFICATIONS.

ALL AREAS DISTURBED BY THE CONTRACTOR SHALL BE RESTORED WITH SEED OR SOD TO THE SATISFACTION OF THE ENGINEER. SEEDING OR SODDING SHALL NOT BE PERMITTED AT ANY TIME WHEN THE GROUND IS FROZEN, WET, OR IN AN UNTILLABLE CONDITION.

ALL EXCAVATED MATERIAL, WHICH INCLUDES DIGGER OR GRADING OF ANY SOIL OR FILL MATERIAL, WITH THE EXCEPTION OF AGGREGATE FILLS, MUST BE INCORPORATED WITHIN THE IDOT RIGHT OF WAY DUE TO ENVIRONMENTAL DOCUMENTATION REQUIREMENTS.

COMMITMENTS:

STATE OF ILLINOIS
DEPARTMENT OF TRANSPORTATION
DISTRICT THREE
AS BUILT INFORMATION

SUPERVISING CONSTRUCTION FIELD ENGINEER

RESIDENT ENGINEER / TECHNICIAN

START & END DATES
OF CONSTRUCTION:

INSPECTORS:

STATE OF ILLINOIS
DEPARTMENT OF TRANSPORTATION
DISTRICT THREE

PREPARED BY: *Tom Benick*
DISTRICT STUDIES & PLANS ENGINEER

DATE: 10-11-18

EXAMINED BY: *[Signature]*
DISTRICT CONSTRUCTION ENGINEER

[Signature]
DISTRICT MATERIALS ENGINEER

[Signature]
DISTRICT OPERATIONS ENGINEER

FILE NAME =	USER NAME = budzynskim	DESIGNED - _____	REVISED - _____	STATE OF ILLINOIS DEPARTMENT OF TRANSPORTATION	GENERAL NOTES	F.A.P. RTE.	SECTION	COUNTY	TOTAL SHEETS	SHEET NO.	
pw:\IL084EBID\INTEG\Illinois.gov\PW\DOT Documents\IDOT Offices\District 3\Projects\D366J13\CADData\ID366J13-sh1-cv	DRAWN - _____	REVISED - _____	VAR			(25) SFY	DEKALB	7	2		
Default	PLOT SCALE = 100.0000' / in.	CHECKED - _____	REVISED - _____			CONTRACT NO. 66J13					
	PLOT DATE = 9/25/2018	DATE - _____	REVISED - _____			SCALE: _____	SHEET _____ OF _____ SHEETS	STA. _____	TO STA. _____	ILLINOIS FED. AID PROJECT	

CODE NO.	ITEM	UNIT	TOTAL QUANTITY	CONSTR. CODE	
				90% FED 10% STATE	
				ROADWAY	
				0021	
				RURAL	
67100100	MOBILIZATION	L SUM	1.0		1.0
70100450	TRAFFIC CONTROL AND PROTECTION, STANDARD 701201	L SUM	1.0		1.0
80500300	SERVICE INSTALLATION, TYPE C	EACH	1		1
81028200	UNDERGROUND CONDUIT, GALVANIZED STEEL, 2" DIA.	FOOT	205		205
81028350	UNDERGROUND CONDUIT, PVC, 2" DIA.	FOOT	2411		2411
81100500	CONDUIT ATTACHED TO STRUCTURE, 1 1/2" DIA., GALVANIZED STEEL	FOOT	50		50
81400700	HANDHOLE, PORTLAND CEMENT CONCRETE	EACH	7		7
85800100	FLASHER CONTROLLER	EACH	1		1
87200400	SPAN WIRE	FOOT	115		115
87200500	TETHER WIRE	FOOT	115		115
87301215	ELECTRIC CABLE IN CONDUIT, SIGNAL NO. 14 2C	FOOT	2900		2900
87301805	ELECTRIC CABLE IN CONDUIT, SERVICE, NO. 6 2 C	FOOT	5		5
87301900	ELECTRIC CABLE IN CONDUIT, EQUIPMENT GROUNDING CONDUCTOR, NO. 6 1C	FOOT	2900		2900
87302212	ELECTRIC CABLE AERIAL SUSPENDED, SIGNAL, NO. 14 2C	FOOT	320		320

FILE NAME =	USER NAME = budzynsklm	DESIGNED - _____	REVISED - _____	STATE OF ILLINOIS DEPARTMENT OF TRANSPORTATION	SUMMARY OF QUANTITIES			F.A.P. RTE.	SECTION	COUNTY	TOTAL SHEETS	SHEET NO.
pw:\il084EBID\INTEG\Illnotes.gov\PWIDOT\Documents\DOT Office\District 3\Projects\0366J13\CADDData\0366J13-sh-cv-drawn	DRAWN - _____	REVISED - _____	VAR					(25) SFY	DEKALB	7	3	
Default	PLOT SCALE = 100.0000' / in.	CHECKED - _____	REVISED - _____		CONTRACT NO. 66J13			ILLINOIS FED. AID PROJECT				
	PLOT DATE = 10/25/2018	DATE - _____	REVISED - _____		SCALE: _____	SHEET _____ OF _____ SHEETS	STA. _____ TO STA. _____					

CODE NO.	ITEM	UNIT	TOTAL QUANTITY	CONSTR. CODE	
				90% FED	10% STATE
				ROADWAY	
				0021	RURAL
87302705	ELECTRIC CABLE AERIAL SUSPENDED, EQUIPMENT GROUNDING CONDUCTOR, NO. 6 1C	FOOT	320		320
87800400	CONCRETE FOUNDATION, TYPE E 30-INCH DIAMETER	FOOT	24		24
88040030	SIGNAL HEAD, POLYCARBONATE, LED, 1-FACE, 1-SECTION, POST MOUNTED	EACH	3		3
X8620200	UNINTERRUPTABLE POWER SUPPLY, SPECIAL	EACH	1		1
X8800081	SIGNAL HEAD, LED, 4-FACE, 1-SECTION, SPAN WIRE MOUNTED	EACH	1		1
X1400357	STEEL STRAIN POLE, 30 FT	EACH	2		2

FILE NAME =	USER NAME = budzynsklm	DESIGNED - _____	REVISED - _____	STATE OF ILLINOIS DEPARTMENT OF TRANSPORTATION	SUMMARY OF QUANTITIES			F.A.P. RTE.	SECTION	COUNTY	TOTAL SHEETS	SHEET NO.
pw:\IL084EBID\INTEG\Illnotes.gov\PWIDOT\Documents\DOT Office\District 3\Projects\0366J13\CADDData\0366J13-sht-cov	DRAWN - _____	REVISED - _____	VAR					(25) SFY	DEKALB	7	4	
Default	PLOT SCALE = 100.0000' / in.	CHECKED - _____	REVISED - _____		CONTRACT NO. 66J13			ILLINOIS FED. AID PROJECT				
	PLOT DATE = 10/25/2018	DATE - _____	REVISED - _____		SCALE: _____	SHEET _ OF _ SHEETS	STA. _____ TO STA. _____					

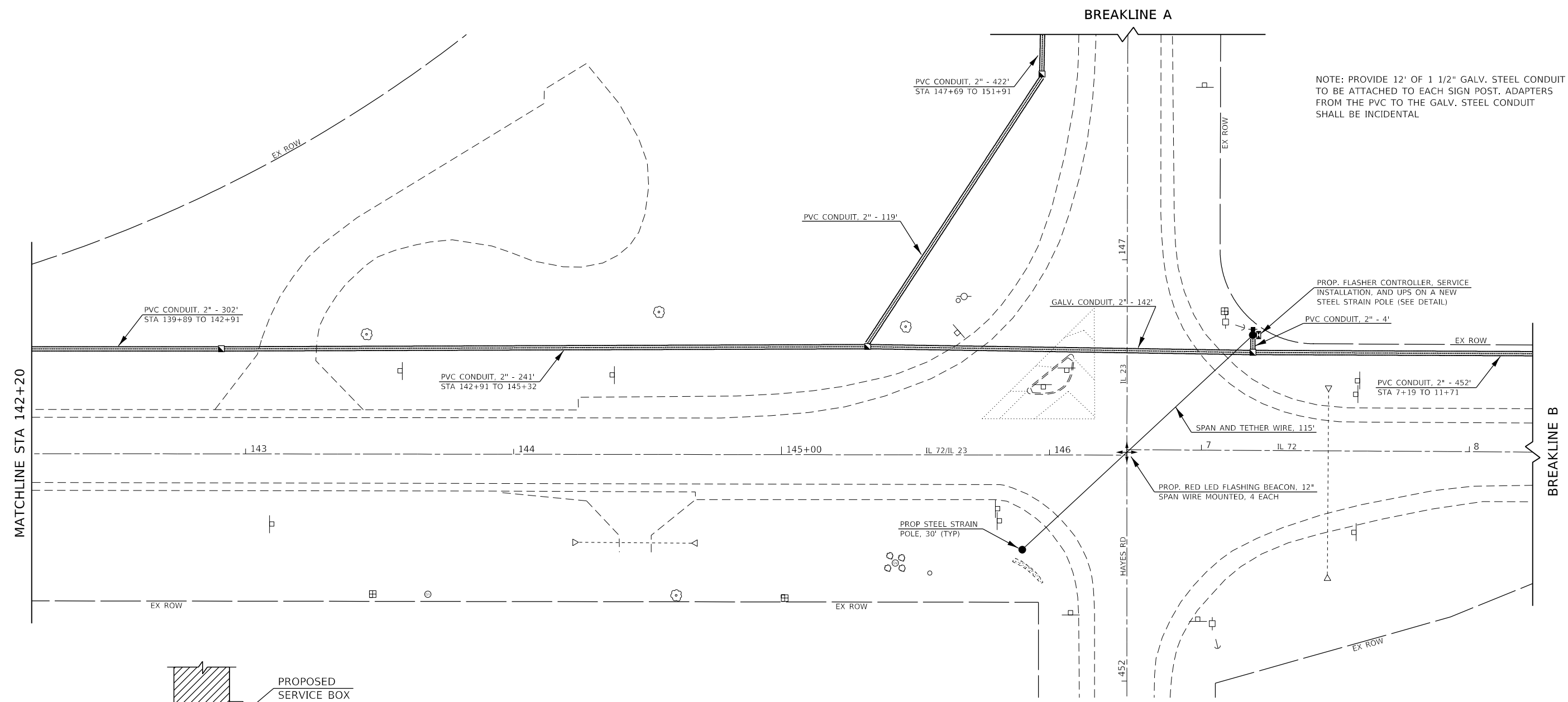

NOTE: PROVIDE 12' OF 1 1/2" GALV. STEEL CONDUIT TO BE ATTACHED TO EACH SIGN POST. ADAPTERS FROM THE PVC TO THE GALV. STEEL CONDUIT SHALL BE INCIDENTAL

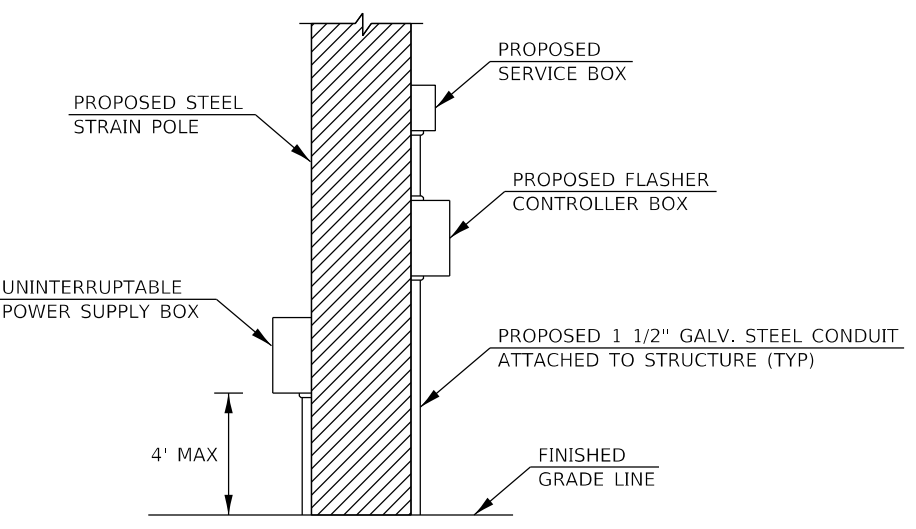





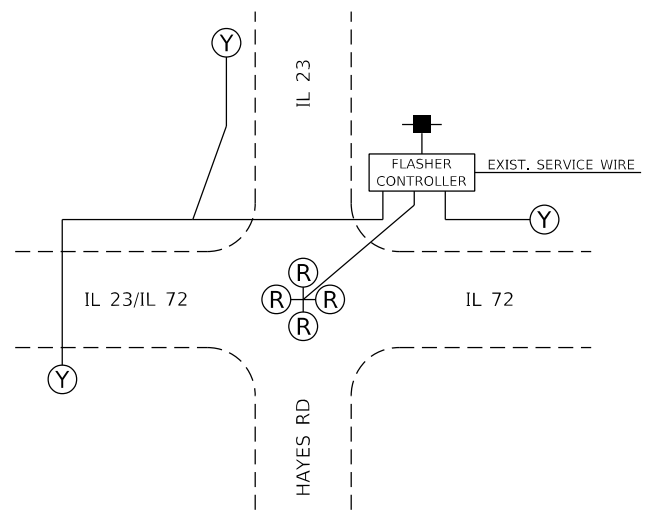

INTERSECTION CONTROLLER/SERVICE BOX INSTALLATION DETAIL (NTS)

NOTE: THE IDOT TRAFFIC SIGNAL SECTION SHALL BE CONTACTED AT 815-434-8506 BEFORE THE EQUIPMENT IS MOUNTED TO VERIFY AN ACCEPTABLE PLACEMENT AND ORIENTATION ON THE POLE



CABLE PLAN

TRAFFIC SIGNALS LEGEND

-  PROPOSED SERVICE INSTALLATION
-  PROPOSED FLASHER CONTROLLER
-  PROPOSED STEEL STRAIN POLE
-  PROPOSED FLASHING BEACON
-  PROPOSED HANDHOLE
-  PROPOSED CONDUIT

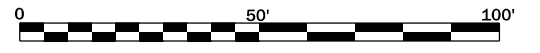

FILE NAME =	USER NAME = budzynsklm	DESIGNED -	REVISED -	STATE OF ILLINOIS DEPARTMENT OF TRANSPORTATION	FLASHING BEACON LAYOUT PLAN	F.A.P. RTE.	SECTION	COUNTY	TOTAL SHEETS	SHEET NO.	
Default		DRAWN -	REVISED -			VAR	(25) SFY	DEKALB	7	5	
	PLOT SCALE = 40,0000' / in.	CHECKED -	REVISED -			CONTRACT NO. 66J13					
	PLOT DATE = 10/25/2018	DATE -	REVISED -			ILLINOIS FED. AID PROJECT					



NOTE: PROVIDE 12' OF 1 1/2" GALV. STEEL CONDUIT TO BE ATTACHED TO EACH SIGN POST. ADAPTERS FROM THE PVC TO THE GALV. STEEL CONDUIT SHALL BE INCIDENTAL

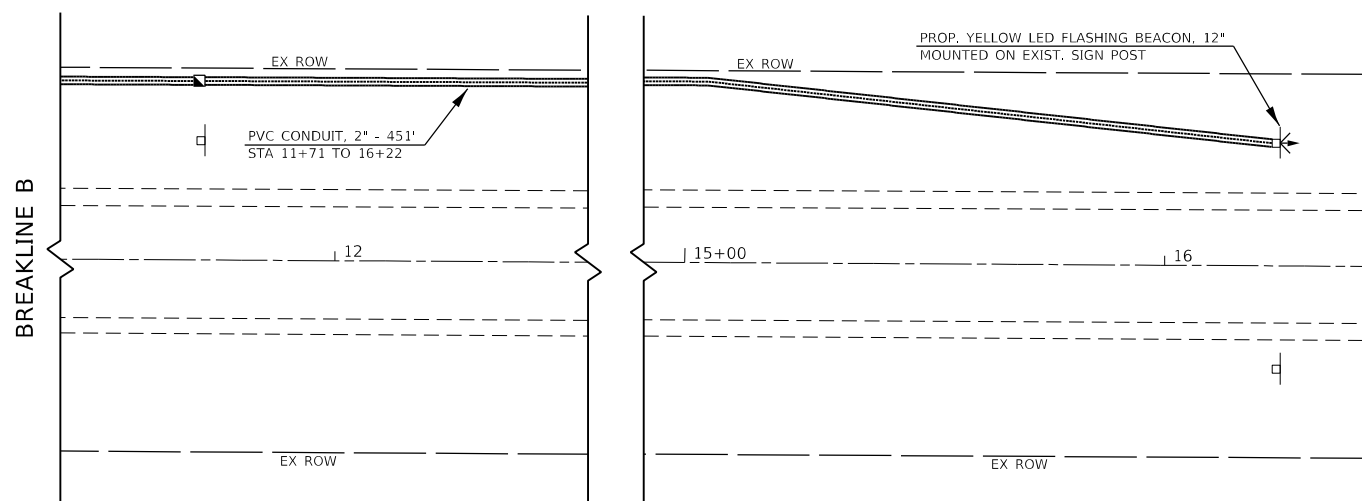
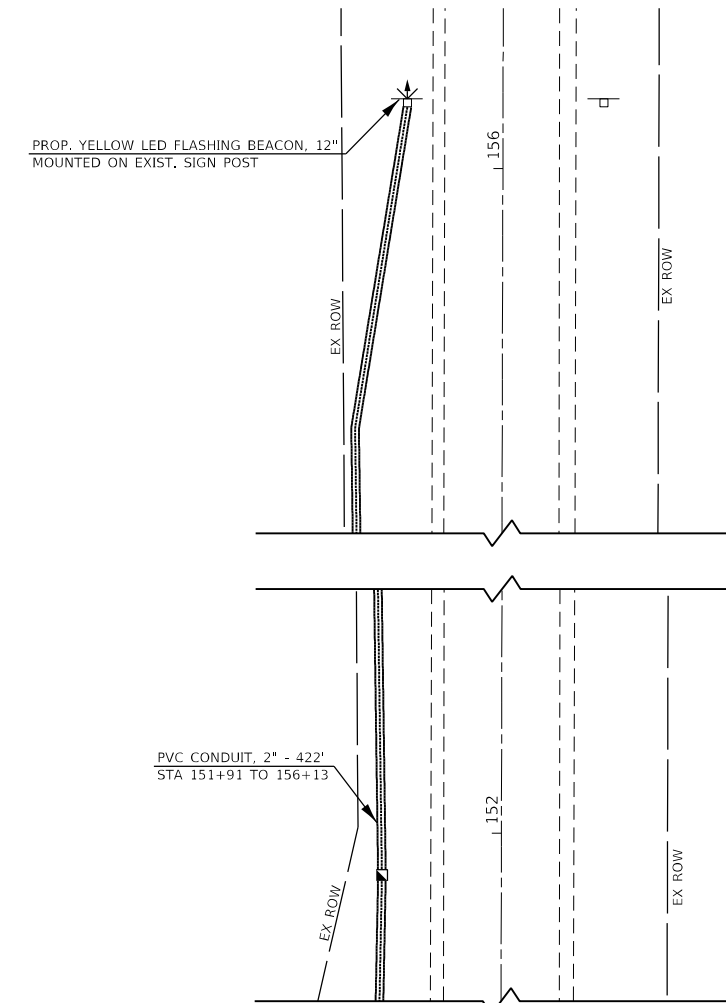
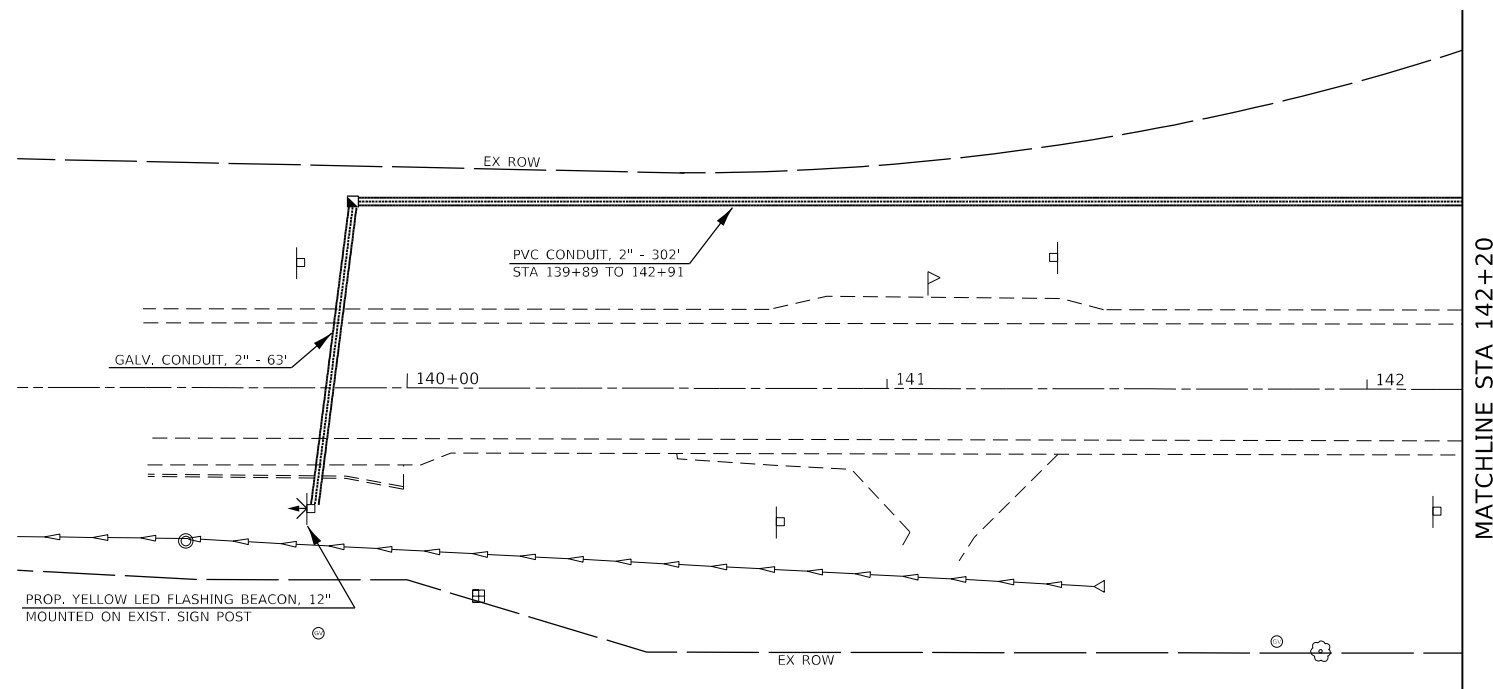

FILE NAME =	USER NAME = budzynsklm	DESIGNED -	REVISED -
pw:\il084EBID\INTEG\ilnotes\gov\PWIDOT\Documents\DOT Office\District 3\Projects\D366J13\CADDData\D366J13-shd-cov		DRAWN -	REVISED -
Default	PLOT SCALE = 40,0000' / in.	CHECKED -	REVISED -
	PLOT DATE = 10/25/2018	DATE -	REVISED -

**STATE OF ILLINOIS
DEPARTMENT OF TRANSPORTATION**

FLASHING BEACON LAYOUT PLAN			
SCALE: _____	SHEET _____ OF _____ SHEETS	STA. _____	TO STA. _____

F.A.P. RTE.	SECTION	COUNTY	TOTAL SHEETS	SHEET NO.
VAR	(25) SFY	DEKALB	7	6
CONTRACT NO. 66J13				
ILLINOIS FED. AID PROJECT				

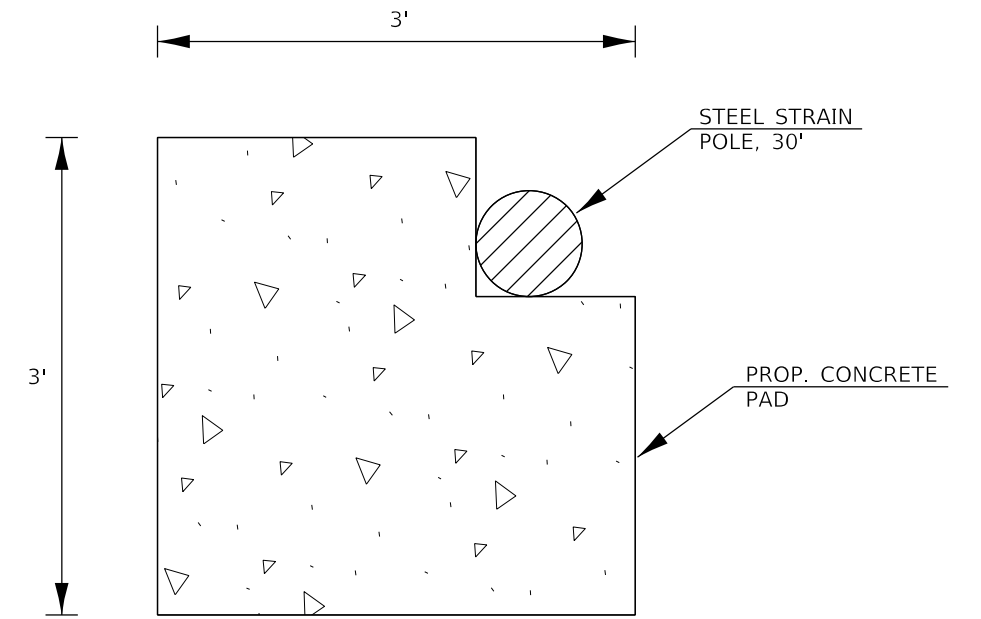

TOP VIEW

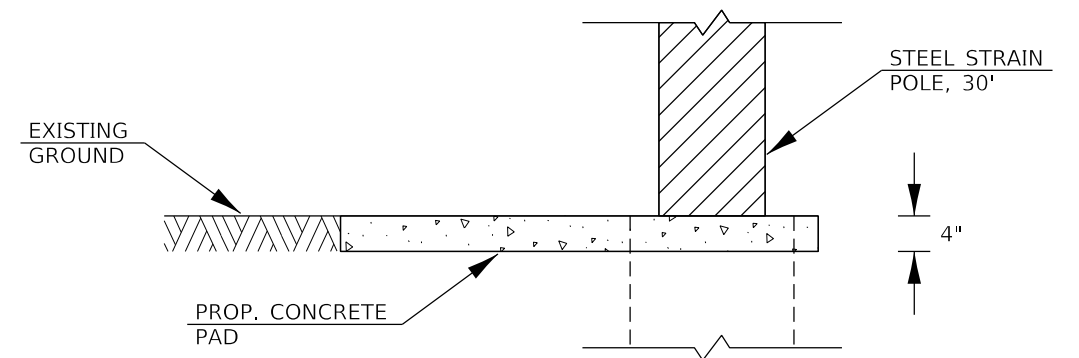

FRONT VIEW

WOOD POLE AND CONCRETE PAD LAYOUT

FILE NAME =	USER NAME = budzynsklm	DESIGNED - _____	REVISED - _____
pw:\il084EBID\INTEG\ilnotes\gov\PWIDOT\Documents\DOT\Office\District 3\Projects\D366J13\CADDData\D366J13-sht-cov	DRAWN - _____	CHECKED - _____	REVISED - _____
Default	PLOT SCALE = 100.0000' / in.	DATE - _____	REVISED - _____
	PLOT DATE = 10/25/2018		

**STATE OF ILLINOIS
DEPARTMENT OF TRANSPORTATION**

SUMMARY OF QUANTITIES

SCALE: _____ SHEET _____ OF _____ SHEETS STA. _____ TO STA. _____

F.A.P. RTE.	SECTION	COUNTY	TOTAL SHEETS	SHEET NO.
VAR	(25) SFY	DEKALB	7	7
CONTRACT NO. 66J13				
		ILLINOIS	FED. AID PROJECT	