

070

F.A.S. DATE	SECTION	COUNTY	TOTAL SHEETS	SHEET NO.
	(4,5,6,7) PVMT PRSV	COLES	12	1
		ILLINOIS	CONTRACT NO. 74868	

• FAU 7705, FAS 1669, FAU 7619
D-97-055-18

STATE OF ILLINOIS
DEPARTMENT OF TRANSPORTATION
DIVISION OF HIGHWAYS

**PROPOSED
HIGHWAY PLANS**

FAU 7705, FAS 1669, FAU 7619 (OLD ILL 316)
SECTION (4,5,6,7) PVMT PRSV
PROJECT STP GJ4D (939)
MICROSURFACING
COLES COUNTY
C-97-102-18

FOR INDEX OF SHEETS, SEE SHEET NO. 2

ADT = 3200 (2014)

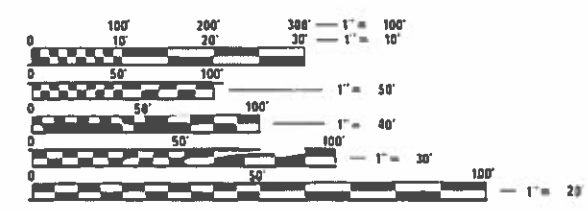
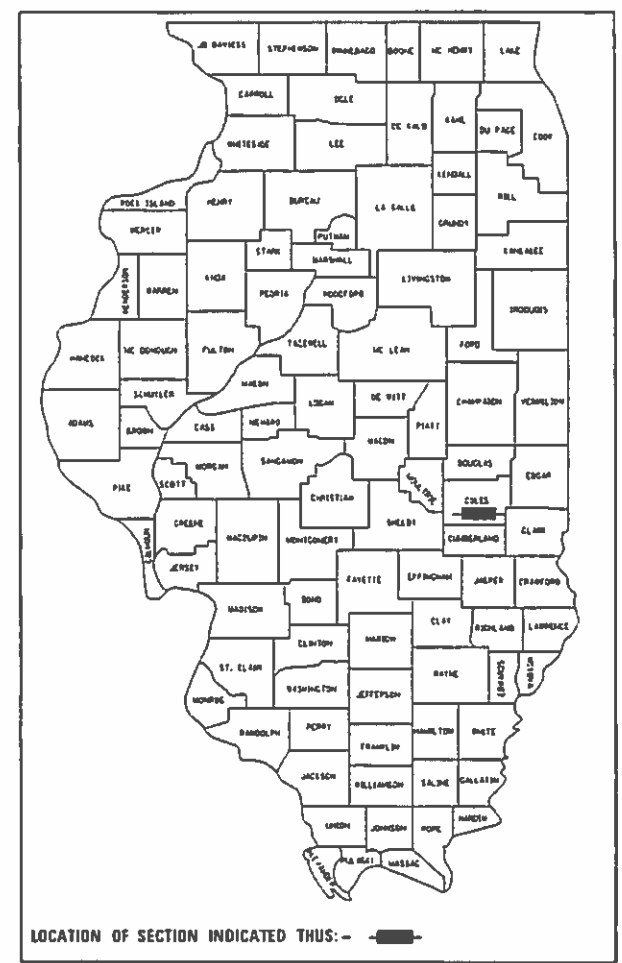

FULL SIZE PLANS HAVE BEEN PREPARED USING STANDARD ENGINEERING SCALES. REDUCED SIZED PLANS WILL NOT CONFORM TO STANDARD SCALES. IN MAKING MEASUREMENTS ON REDUCED PLANS, THE ABOVE SCALES MAY BE USED.

J.U.L.I.E.
JOINT UTILITY LOCATION INFORMATION FOR EXCAVATION
1-800-892-0123
OR 811

SECTION BEGINS:
STATION 9+12.00

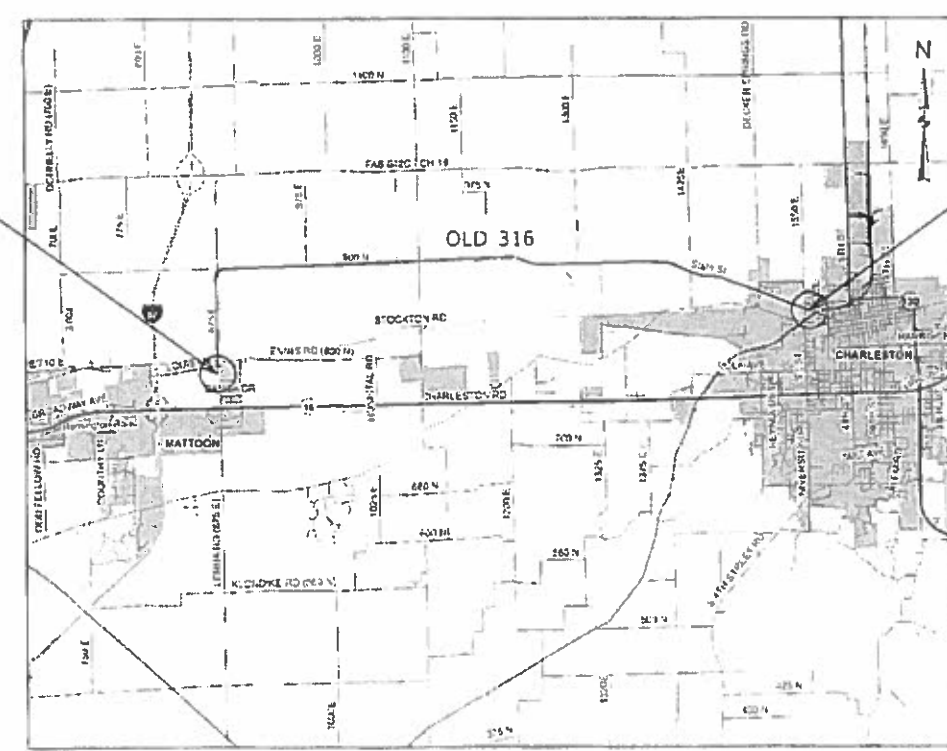

SECTION ENDS:
STATION 548+39.00

STATE OF ILLINOIS
DEPARTMENT OF TRANSPORTATION
DIVISION OF HIGHWAYS
SUBMITTED October 12 2018
Jeffrey M. Sadtler
DEPUTY DIRECTOR OF HIGHWAYS, REGION ENGINEER
Dec 7 2018
cc E.A. etc
ENGINEER OF DESIGN AND ENVIRONMENT
Dec 7 2018
David P. [Signature]
DIRECTOR OF HIGHWAYS PROJECT IMPLEMENTATION

PRINTED BY THE AUTHORITY
OF THE STATE OF ILLINOIS

PROJECT ENGINEER: DEBRA BARRETT
PROJECT MANAGER: AARON METTE
PHONE: 217-342-8253
CONTRACT NO. 74868

GROSS LENGTH = 42,279.00 FT. = 8.01 MILE
NET LENGTH = 41,679.00 FT. = 7.89 MILE

INDEX OF SHEETS

SHEET NO.	DESCRIPTION
1	COVER SHEET
2	INDEX OF SHEETS & GENERAL NOTES
3	SUMMARY OF QUANTITIES
4-5	TYPICAL SECTIONS
6	LOCATION MAP OLD 316
7-8	SCHEDULE OF QUANTITIES
9-12	DISTRICT 7 DETAIL PAVEMENT MARKING

THE FOLLOWING STANDARDS ARE A PART OF THESE PLANS AND ARE INCLUDED FOLLOWING SHEET NUMBER 12

- 701001-02 OFF-ROAD OPERATIONS, 2L, 2W, MORE THAN 15' AWAY
- 701006-05 OFF-ROAD OPERATIONS, 2L, 2W, 15' TO 24" FROM PAVEMENT EDGE
- 701301-04 LANE CLOSURE, 2L, 2W, SHORT TIME OPERATIONS
- 701306-04 LANE CLOSURE, 2L, 2W, SLOW MOVING OPERATIONS DAY ONLY, FOR SPEEDS >= 45 MPH
- 701311-03 LANE CLOSURE, 2L, 2W, MOVING OPERATIONS - DAY ONLY
- 701901-08 TRAFFIC CONTROL DEVICES

GENERAL NOTES

THE WORK IN THIS SECTION CONSISTS OF HOT-MIX ASPHALT SURFACE CORRECTION, HOT-MIX ASPHALT FOR PATCHING POTHOLES (COLD MIX), MICRO-SURFACING, PAVEMENT MARKING, RAISED REFLECTIVE PAVEMENT MARKERS, TRAFFIC CONTROL, AND ANY OTHER WORK NECESSARY TO COMPLETE THIS SECTION PER THE STANDARD SPECIFICATIONS.

SHORT-TERM PAVEMENT MARKING ON MILLED SURFACE SHALL BE PAINT AND TAPE ON FINAL SURFACE. APPLICATION OF SHORT-TERM PAVEMENT MARKING ON MILLED SURFACE WILL NOT HAVE TO BE REMOVED PRIOR TO PLACING THE MICRO-SURFACING.

THE REMOVAL OF EXISTING RAISED REFLECTIVE PAVEMENT MARKERS SHALL BE INCLUDED IN THE COST OF HOT-MIX ASPHALT SURFACE CORRECTION.

FILE NAME =	USER NAME = steffenmk	DESIGNED -	REVISED -	STATE OF ILLINOIS DEPARTMENT OF TRANSPORTATION	INDEX OF SHEETS & GENERAL NOTES	F.A. RTE.	SECTION	COUNTY	TOTAL SHEETS	SHEET NO.	
p:\11\084EBIDINTEG.illinois.gov\PIWIDOT\Documents\DOT Offices\District 7\Projects\74868\Drawings\CAD\sheets\074868-shr-gennotes.dwg	DRAWN -	REVISOR -	REVISIONS -			•	(4,5,6,7)PVMT PRSV	COLES	12	2	
Default	PLOT SCALE = 100.0000' / 1in.	CHECKED -	REVISOR -			CONTRACT NO. 74868					
	PLOT DATE = 10/15/2018	DATE -	REVISIONS -			SCALE:	SHEET	OF	SHEETS	STA.	TO

MODEL: Default
 FILE NAME: p:\1110848E\BID\NTEC Illinois.gov\PIV\DOT\Documents\DOT Office\District 7\Projects\1669\CADDData\CAD\Sheet\1669-sh-500.dgn

CODE NO.	ITEM	UNIT	TOTAL QUANTITY	CONSTRUCTION CODE					
				80% FED 20% STATE					
				RURAL 0005 COLES	URBAN 0005 COLES				
40400120	MICRO-SURFACING, SINGLE PASS, MIXTURE C	SQ YD	109353	68539	40814				
40600290	BITUMINOUS MATERIALS (TACK COAT)	POUND	24604	15421	9183				
44000690	HOT-MIX ASPHALT SURFACE CORRECTION	SQ YD	109353	68539	40814				
67100100	MOBILIZATION	L SUM	1	0.6	0.4				
70100460	TRAFFIC CONTROL AND PROTECTION, STANDARD 701306	L SUM	1	0.6	0.4				
70300100	SHORT TERM PAVEMENT MARKING	FOOT	8336	5350	2986				
70300150	SHORT TERM PAVEMENT MARKING REMOVAL	SQ FT	1390	892	498				
* 78000100	THERMOPLASTIC PAVEMENT MARKING - LETTERS AND SYMBOLS	SQ FT	249.6	0.0	249.6				
* 78000400	THERMOPLASTIC PAVEMENT MARKING - LINE 6"	FOOT	200	0.0	200				
* 78000600	THERMOPLASTIC PAVEMENT MARKING - LINE 12"	FOOT	100	0.0	100				
* 78001110	PAINT PAVEMENT MARKING - LINE 4"	FOOT	128699	79124	49575				
* 78100100	RAISED REFLECTIVE PAVEMENT MARKER	EACH	568	342	226				
70107025	CHANGEABLE MESSAGE SIGN	CAL DA	28	15	13				
Z0005010	HOT-MIX ASPHALT FOR PATCHING POTHOLES (COLD MIX)	TON	3	1.8	1.2				

* SPECIALTY ITEM

REV. - MS

USER NAME = steffennk	DESIGNED -	REVISED -
	DRAWN -	REVISED -
PLOT SCALE = 100.0000' / in.	CHECKED -	REVISED -
PLOT DATE = 10/15/2018	DATE -	REVISED -

**STATE OF ILLINOIS
DEPARTMENT OF TRANSPORTATION**

SUMMARY OF QUANTITIES

SCALE: SHEET OF SHEETS STA. TO STA.

F.A. RTE.	SECTION	COUNTY	TOTAL SHEETS	SHEET NO.
*	(4,5,6,7) PVMT PRSV	COLES	12	3
CONTRACT NO. 74868				
ILLINOIS FED. AID PROJECT				

FAU 7705, FAS 1669, FAU 7619

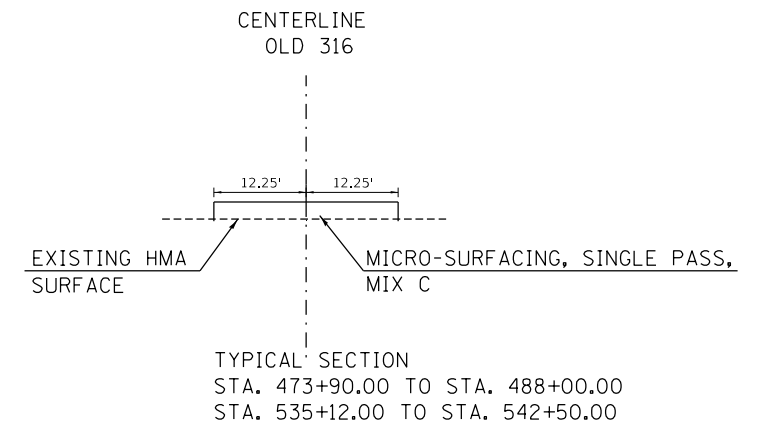
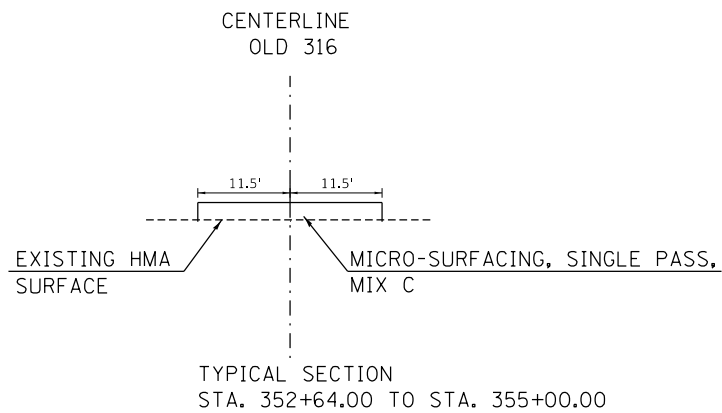
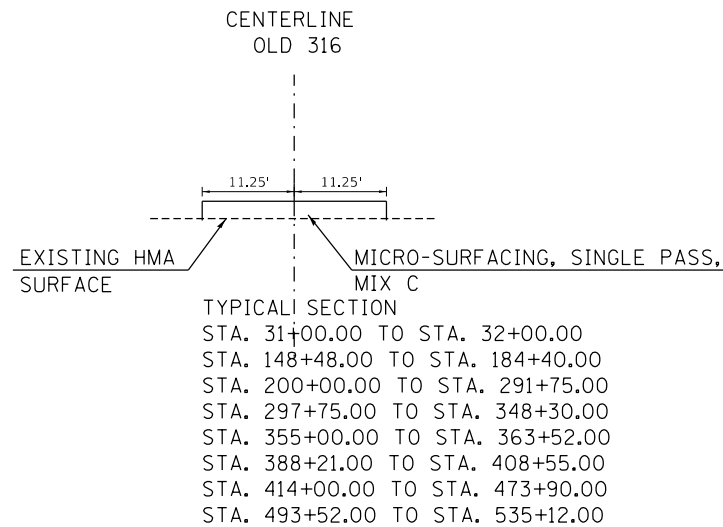
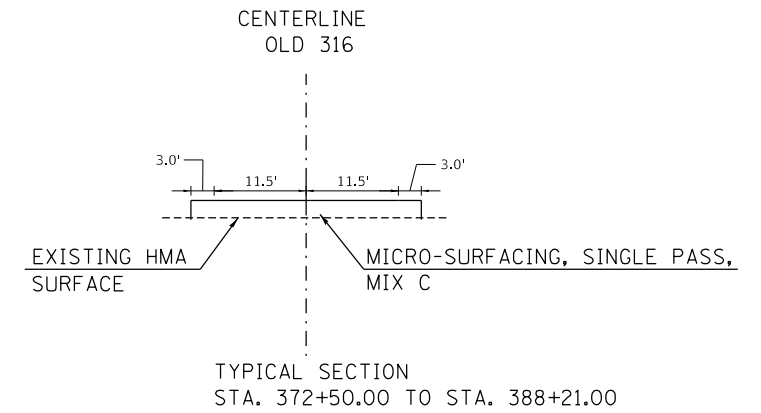
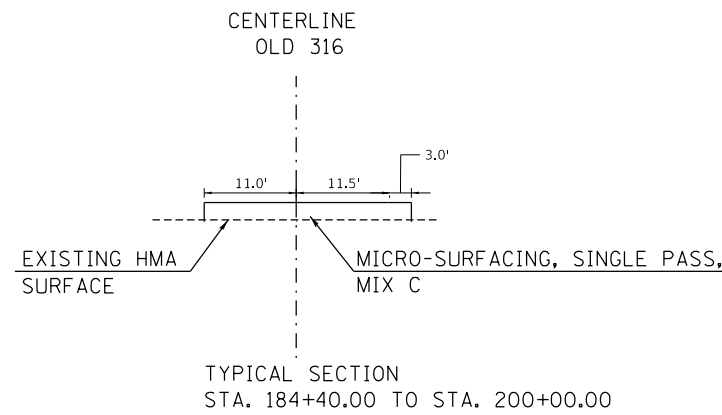
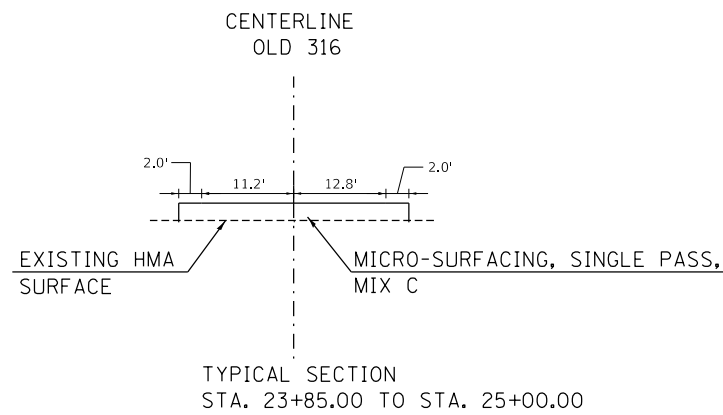
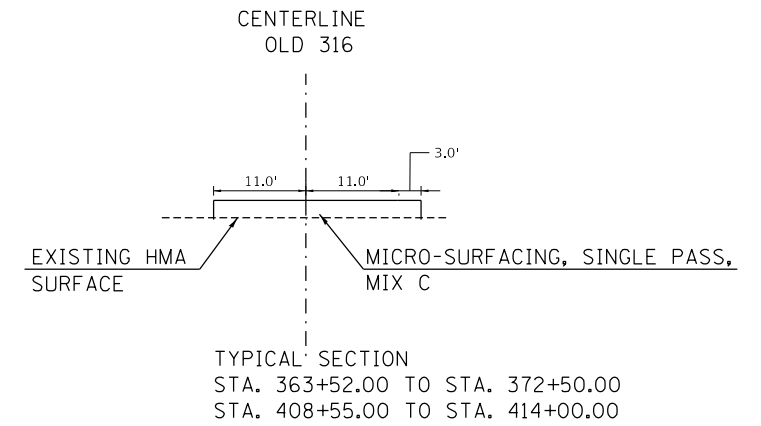
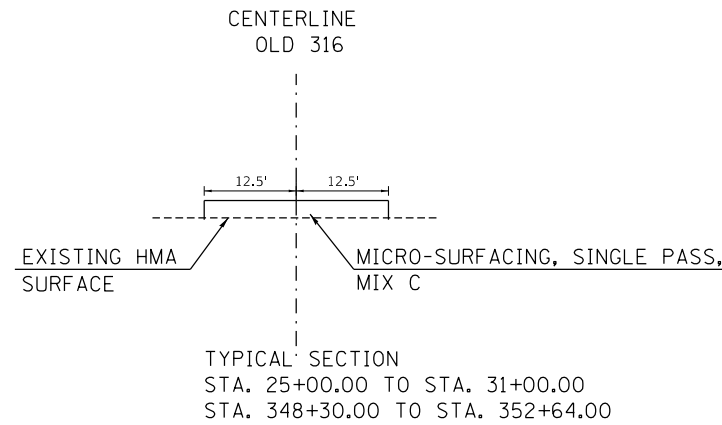
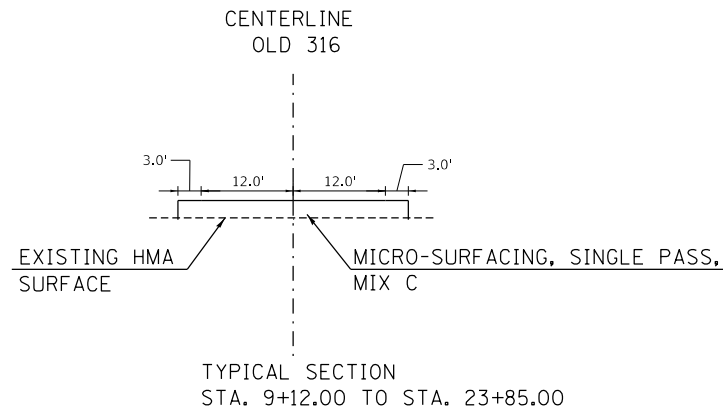

MODEL: Default
 FILE NAME: p:\u0008\B&E\BIDD\ITEC\Illinois\pvt\RW\DOT\Documents\18081\DOT\Office\18081\DOT\18081-ehb-hydr\18081.dgn

USER NAME = steffemk	DESIGNED -	REVISED -
	DRAWN -	REVISED -
PLOT SCALE = 100.0000' / in.	CHECKED -	REVISED -
PLOT DATE = 10/15/2018	DATE -	REVISED -

**STATE OF ILLINOIS
DEPARTMENT OF TRANSPORTATION**

SCALE:		SHEET OF SHEETS		STA. TO STA.	
		TYPICAL SECTION			

F.A. RTE.	SECTION	COUNTY	TOTAL SHEETS	SHEET NO.
*	(4,5,6,7)PVT PRSV	COLES	12	4
CONTRACT NO. 74868			ILLINOIS FED. AID PROJECT	

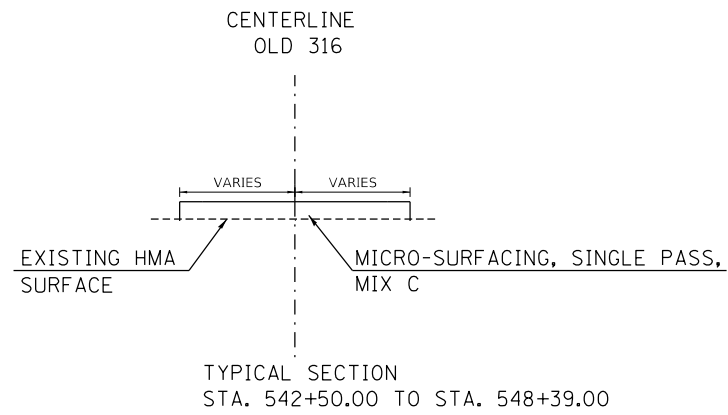
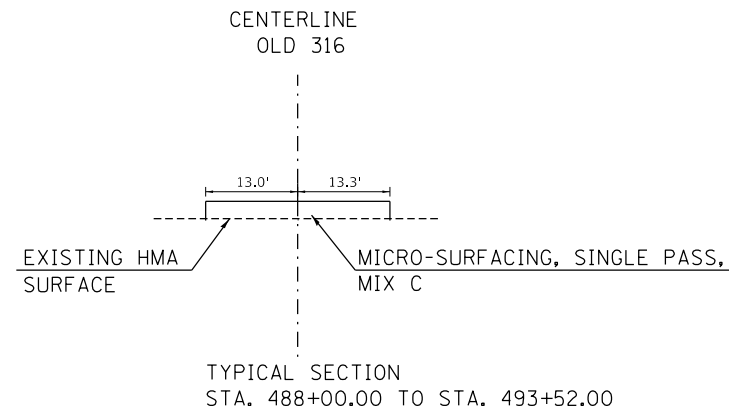

MODEL: Default
FILE NAME: P:\IL08\B&E\BIDD\ITEC\Illinois.gov\FWIDOT\Documents\DOT_Offices\Director_7\Projects\174869\CADD\data\CAD\sheet\174869-shr-typlc.dgn

USER NAME = steffemk	DESIGNED -	REVISED -
	DRAWN -	REVISED -
PLOT SCALE = 100.0000' / in.	CHECKED -	REVISED -
PLOT DATE = 10/15/2018	DATE -	REVISED -

**STATE OF ILLINOIS
DEPARTMENT OF TRANSPORTATION**

TYPICAL SECTION

SCALE: SHEET OF SHEETS STA. TO STA.

F.A. RTE.	SECTION	COUNTY	TOTAL SHEETS	SHEET NO.
*	(4,5,6,7)PVMT PRSV	COLES	12	5
CONTRACT NO. 74868				
ILLINOIS FED. AID PROJECT				

MODEL: Default
 FILE NAME: p:\u0008\B&E\BIDD\ITEC\Illinois\gov\PIV\DOT\Documents\DOT_Offices\Director_7\Projects\74868\CADD\Drawings\CAD\Drawings\74868-ehp-plan.dgn

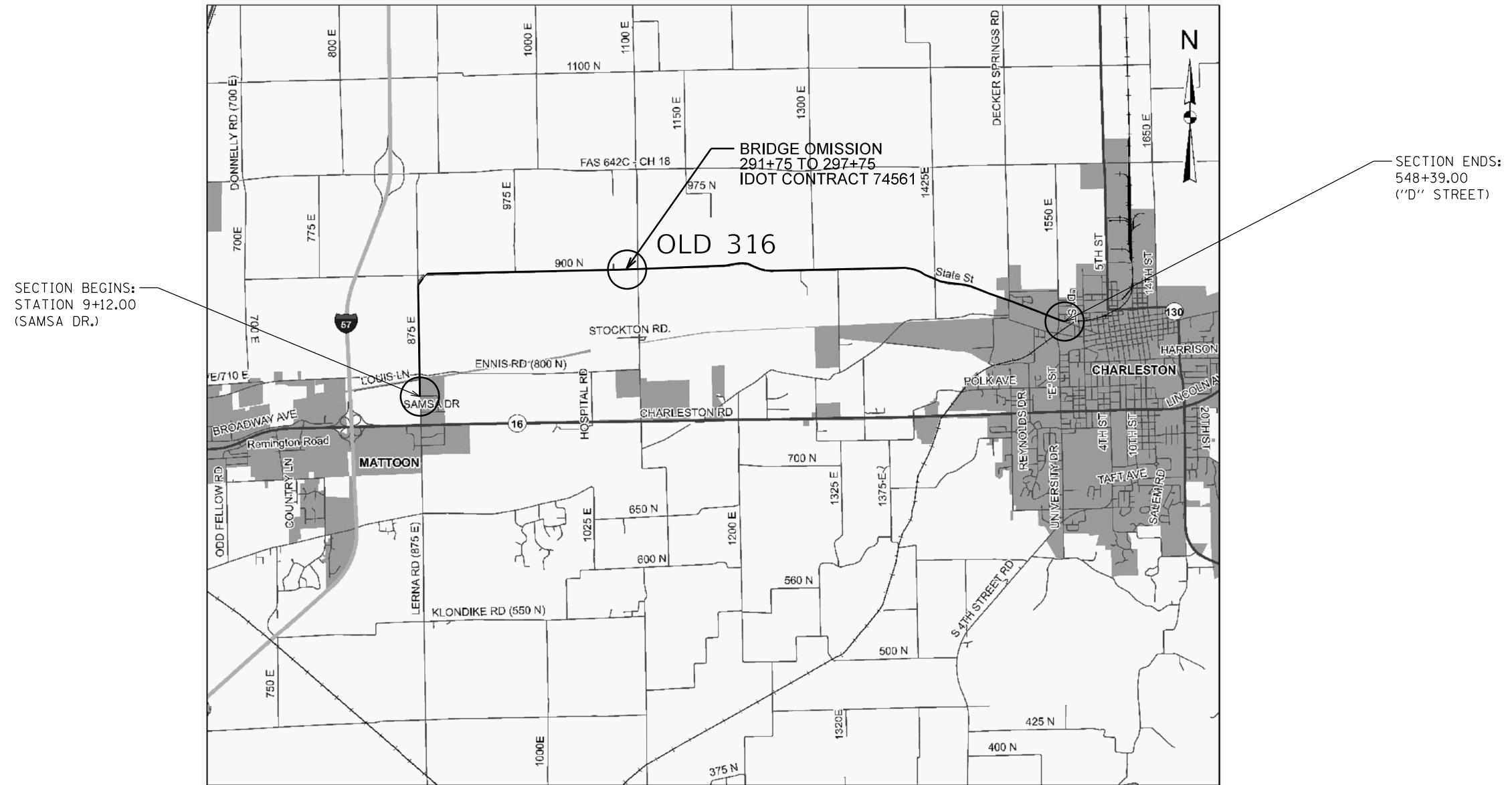

USER NAME = steffemk	DESIGNED -	REVISED -
	DRAWN -	REVISED -
PLOT SCALE = 100,0000' / in.	CHECKED -	REVISED -
PLOT DATE = 10/15/2018	DATE -	REVISED -

**STATE OF ILLINOIS
 DEPARTMENT OF TRANSPORTATION**

MAP OF OLD 316

SCALE: SHEET OF SHEETS STA. TO STA.

F.A. RTE.	SECTION	COUNTY	TOTAL SHEETS	SHEET NO.
-	(4,5,6,7)P/MT PRSV	COLES	12	6
CONTRACT NO. 74868				
ILLINOIS FED. AID PROJECT				

• FAU 7705, FAS 1669, FAU 7619

LOCATION	STATION	TO	STATION	LENGTH	MICRO-SURFACING, SINGLE PASS, MIXC	BITUMINOUS MATERIALS (TACK COAT)	HMA SURFACE CORRECTION	SHORT TERM PAVEMENT MARKING	SHORT TERM PAVEMENT MARKING REMOVAL
OLD 316				FEET	SQ. YD.	POUND	SQ. YD.	FOOT	SQ. FT.
	9+12.00	TO	23+85.00	1473.0	4991.8	1123	4991.8	295	49
	23+85.00	TO	25+00.00	115.0	357.8	81	357.8	23	4
	25+00.00	TO	31+00.00	600.0	1666.7	375	1666.7	120	20
	31+00.00	TO	32+00.00	100.0	250.0	56	250.0	20	3
	32+00.00	BK=	148+48.00						
	148+48.00	TO	184+40.00	3592.0	8980.0	2021	8980.0	718	120
	184+40.00	TO	200+00.00	1560.0	4420.0	995	4420.0	312	52
	200+00.00	TO	232+50.00	3250.0	8125.0	1828	8125.0	650	108
	232+50.00	TO	282+50.00	5000.0	12500.0	2813	12500.0	1000	167
	282+50.00	TO	291+75.00	925.0	2312.5	520	2312.5	185	31
BRIDGE OMISSION	291+75.00	TO	297+75.00	600.0					
	297+75.00	TO	324+75.00	2700.0	6750.0	1519	6750.0	540	90
	324+75.00	TO	340+00.00	1525.0	3812.5	858	3812.5	305	51
	340+00.00	TO	341+50.00	150.0	375.0	84	375.0	30	5
	341+50.00	TO	348+30.00	680.0	1700.0	383	1700.0	136	23
	348+30.00	TO	352+64.00	434.0	1205.6	271	1205.6	87	14
	352+64.00	TO	355+00.00	236.0	603.1	136	603.1	47	8
	355+00.00	TO	363+52.00	852.0	2130.0	479	2130.0	170	28
	363+52.00	TO	372+50.00	898.0	2494.4	561	2494.4	180	30
	372+50.00	TO	388+21.00	1571.0	5062.1	1139	5062.1	314	52
	388+21.00	TO	408+55.00	2034.0	5085.0	1144	5085.0	407	68
	408+55.00	TO	414+00.00	545.0	1513.9	341	1513.9	109	18
	414+00.00	TO	473+48.00	5948.0	14870.0	3346	14870.0	1190	198
	473+48.00	TO	473+90.00	42.0	105.0	24	105.0	8	1
	473+90.00	TO	488+00.00	1410.0	3838.3	864	3838.3	282	47
	488+00.00	TO	493+52.00	552.0	1613.1	363	1613.1	110	18
	493+52.00	TO	520+60.00	2708.0	6770.0	1523	6770.0	542	90
	520+60.00	TO	535+12.00	1452.0	3630.0	817	3630.0	290	48
	535+12.00	TO	542+50.00	738.0	2009.0	452	2009.0	148	25
	542+50.00	TO	545+00.00	250.0	984.7	222	984.7	50	8
	545+00.00	TO	547+75.00	275.0	1002.2	226	1002.2	55	9
	547+75.00	TO	548+39.00	64.0	195.6	44	195.6	13	2
TOTALS				42279.0	109353	24604	109353	8336	1390

MODEL: Default
 FILE: \\u0219\B&E\BID\NTEC\Illinois\pwr\pwr\DOT\Documents\DOT_Offices\Illinois\DOT\CADDData\CADD\pwr\DOT_74868\sh-schedu.dgn

USER NAME = steffenmk	DESIGNED -	REVISED -
	DRAWN -	REVISED -
PLOT SCALE = 2.0000 ' / in.	CHECKED -	REVISED -
PLOT DATE = 10/15/2018	DATE -	REVISED -

**STATE OF ILLINOIS
DEPARTMENT OF TRANSPORTATION**

SCALE: SHEET OF SHEETS STA. TO STA.

F.A. RTE.	SECTION	COUNTY	TOTAL SHEETS	SHEET NO.
*	(4,5,6,7)PVMT PRSV	COLES	12	7
CONTRACT NO. 74868				
ILLINOIS FED. AID PROJECT				

LOCATION	STATION	TO	STATION	LENGTH	THERMOPLASTIC PAVEMENT MARKING - LETTERS AND SYMBOLS	PAINT PAVEMENT MARKING - LINE 4"	THERMOPLASTIC PAVEMENT MARKING - LINE 6"	THERMOPLASTIC PAVEMENT MARKING - LINE 12"	RAISED REFLECTIVE PAVEMENT MARKER	
OLD 316				FEET	SQ. FT.	FOOT	FOOT	FOOT	EACH	
	9+12.00	TO	32+00.00	2288		8,840			30	
	32+00.00	BK=	148+48.00							
	148+48.00	TO	163+53.00	1505		6,020			19	
	163+53.00	TO	172+85.00	932		3,029			12	
	172+85.00	TO	186+80.00	1395		4,534			18	
	186+80.00	TO	197+80.00	1100		4,200			14	
	197+80.00	TO	200+00.00	220		615			3	
	200+00.00	TO	208+00.00	800		2,600			10	
	208+00.00	TO	222+46.00	1446		3,254			18	
	222+46.00	TO	229+90.00	744		2,418			9	
	229+90.00	TO	232+15.00	225		506			3	
	232+15.00	TO	240+58.00	843		2,740			11	
	240+58.00	TO	291+75.00	5117		11,513			65	
Bridge Omission	291+75.00	TO	297+75.00	600						
	297+75.00	TO	301+15.00	340		715			5	
	301+15.00	TO	310+99.00	984		3,198			12	
	310+99.00	TO	312+55.00	156		624			2	
	312+55.00	TO	320+76.00	821		2,668			10	
	320+76.00	TO	329+89.00	913		1,881			11	
	329+89.00	TO	336+05.00	616		2,002			8	
	336+05.00	TO	341+00.00	495		1,114			6	
	341+00.00	TO	348+00.00	700		2,275			9	
	348+00.00	TO	361+59.00	1359		3,058			17	
	361+59.00	TO	383+00.00	2141		8,564			28	
	383+00.00	TO	391+39.00	839		2,727			10	
	391+39.00	TO	393+14.00	175		700			2	
	393+14.00	TO	399+29.00	615		1,929			8	
	399+29.00	TO	401+59.00	230		518			3	
	401+59.00	TO	408+55.00	696		2,262			9	
	408+55.00	TO	412+00.00	345		1,380			4	
	412+00.00	TO	418+90.00	690		2,203			9	
	418+90.00	TO	420+57.00	167		376			2	
	420+57.00	TO	428+03.00	746		2,425			10	
	428+03.00	TO	435+60.00	757		1,703			9	
	435+60.00	TO	442+48.00	688		2,236			9	
	442+48.00	TO	445+75.00	327		736			4	
	445+75.00	TO	447+96.00	221		593			3	
	447+96.00	TO	473+48.00	2552		10,208			33	
	473+48.00	TO	488+00.00	1452		5,808			18	
	488+00.00	TO	499+60.00	1160		3,730			15	
	499+60.00	TO	534+00.00	3440		7,408			44	
	534+00.00	TO	537+50.00	350		1,138			5	
	537+50.00	TO	539+37.00	187		748		56	18	
	539+37.00	TO	545+33.00	596	249.6	1,876	200		18	
	545+33.00	TO	548+39.00	306		1,630		44	16	
					WHITE TOTAL	82,055	200			
					YELLOW TOTAL	46,644		100		
					TOTALS	249.6	128,699	200	100	568

MODEL: Default
 FILE: \\nas0101\B&E\BID\NTEC\Illinois\gov\FWID\DOT\Documents\1\DOT_Offices\DI\erfct 7\Project\71868\CADD\Drawings\CAD\Sheet\71868-eh-schedule.dgn

USER NAME = steffenmk	DESIGNED -	REVISED -
	DRAWN -	REVISED -
PLOT SCALE = 2,000' / in.	CHECKED -	REVISED -
PLOT DATE = 10/15/2018	DATE -	REVISED -

**STATE OF ILLINOIS
DEPARTMENT OF TRANSPORTATION**

SCALE:	SHEET	OF	SHEETS	STA.	TO STA.
--------	-------	----	--------	------	---------

F.A. FAU 7705, FAS 1669, FAU 7619	COUNTY	TOTAL SHEETS	SHEET NO.
SECTION (4,5,6,7)P/MT PRSV	COLES	12	8
CONTRACT NO. 74868			
ILLINOIS FED. AID PROJECT			

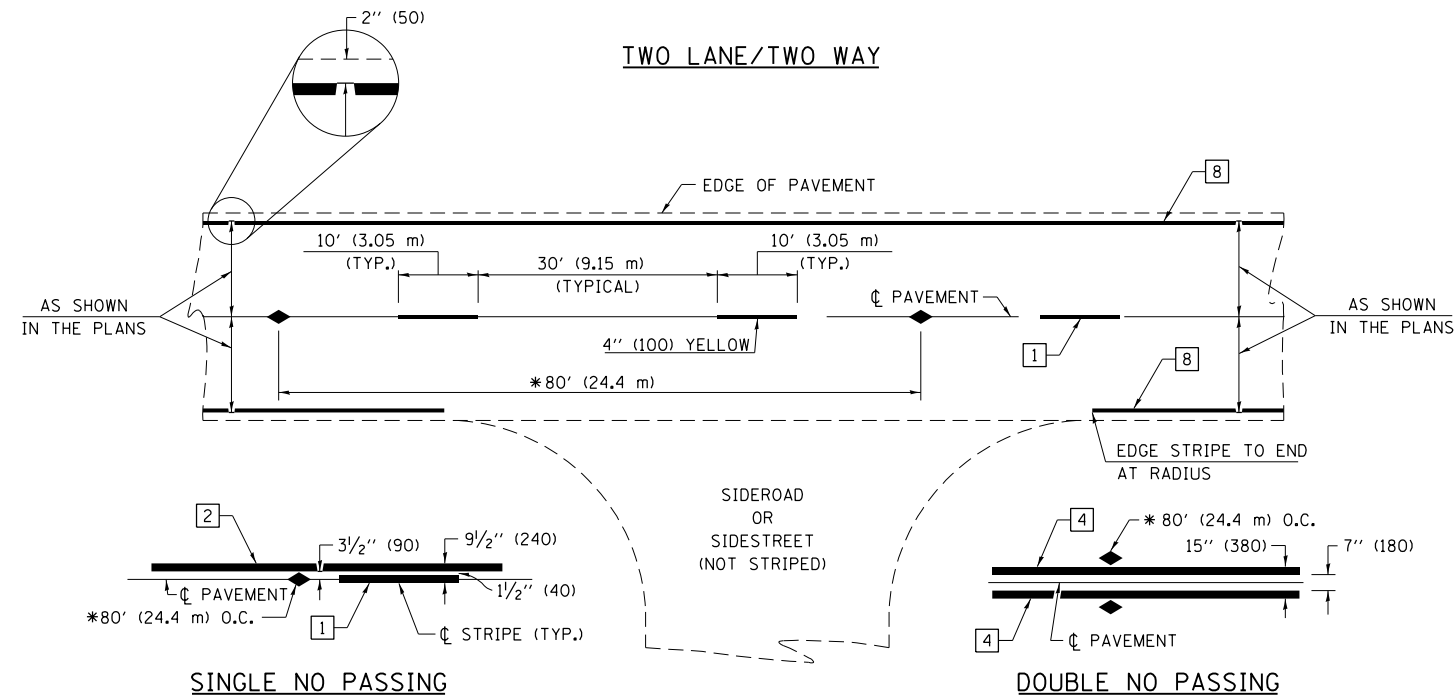

PAVEMENT MARKING LEGEND

- 1 4" (100) SKIP-DASH (YELLOW)
- 2 4" (100) SOLID (YELLOW)
- 3 12" (300) DIAGONAL (YELLOW)
- 4 4" (100) DOUBLE YELLOW (NARROW)
- 5 12" (300) SOLID WHITE
- 6 RESERVED
- 7 6" (150) SKIP-DASH (WHITE)
- 8 4" (100) SOLID (WHITE)
- 9 12" (300) DIAGONAL (WHITE)
- 10 6" (150) SOLID (WHITE)
- 11 24" (600) STOP BAR (WHITE)
- 12 8" (200) SOLID (WHITE)
- 13 4" (100) PARKING WHITE

* REDUCE TO 40' (12.2 m) O.C. ON CURVES WITH POSTED OR ADVISORY SPEEDS OF 45 mph (70 km/h) OR LESS.

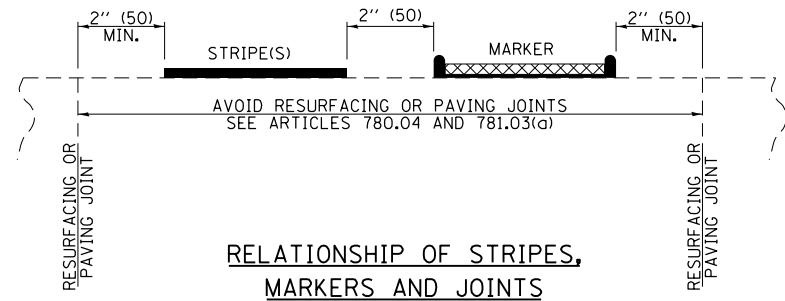

TYPICAL PAVEMENT MARKERS LEGEND

- ◆ TWO-WAY AMBER MARKER
- ▶ ONE-WAY AMBER MARKER
- ▷ ONE-WAY CRYSTAL MARKER

RAISED REFLECTIVE PAVEMENT MARKERS

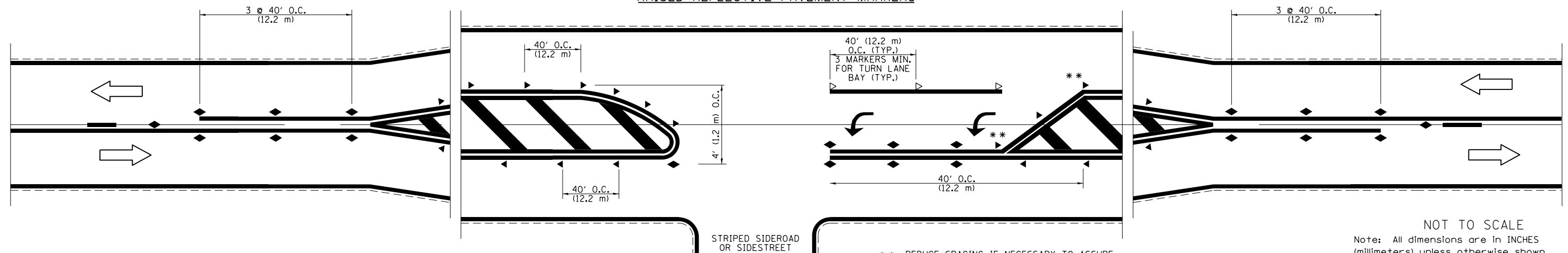

** REDUCE SPACING IF NECESSARY TO ASSURE MARKERS AT CORNER POINTS.

NOT TO SCALE
Note: All dimensions are in INCHES (millimeters) unless otherwise shown.

DISTRICT 7 DETAIL NO. 7800001

FILE NAME =	USER NAME = steffenmk	DESIGNED -	REVISED -	STATE OF ILLINOIS DEPARTMENT OF TRANSPORTATION	PAVEMENT MARKING AND RAISED REFLECTIVE PAVEMENT MARKERS (RURAL & URBAN APPLICATIONS)	F.A. RTE.	SECTION	COUNTY	TOTAL SHEETS	SHEET NO.	
pw:\1L084EBIDINTEG.illinois.gov\PIWIDOT\Documents\IDOT Offices\District 7\Projects\74868\Drawings\CAD\Drawings\74868-shd-details.dwg	PLOT SCALE = 2.0000' / in.	CHECKED -	REVISED -			•	(4,5,6,7)PVT PRSV	COLES	12	9	
	PLOT DATE = 10/15/2018	DATE -	REVISED -			CONTRACT NO. 74868					
						ILLINOIS FED. AID PROJECT					

* FAU 7705, FAS 1669, FAU 7619

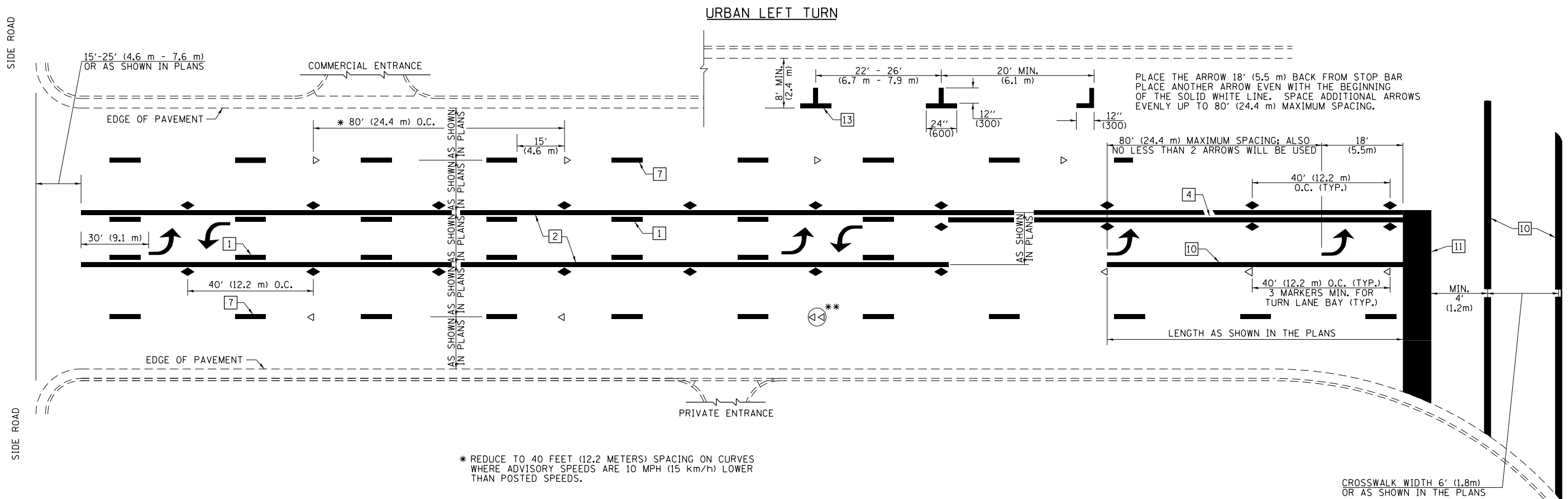

* REDUCE TO 40 FEET (12.2 METERS) SPACING ON CURVES WHERE ADVISORY SPEEDS ARE 10 MPH (15 km/h) LOWER THAN POSTED SPEEDS.

** DOUBLE LANE LINE MARKERS SHALL BE SPECIFIED AND SPACED AS SHOWN IN HIGHWAY STANDARD 781001 FOR MULTI-LANE DIVIDED AND UNDIVIDED HIGHWAYS.

PAVEMENT MARKING LEGEND

- 1 4" (100) SKIP-DASH (YELLOW)
 - 2 4" (100) SOLID (YELLOW)
 - 3 12" (300) DIAGONAL (YELLOW)
 - 4 4" (100) DOUBLE YELLOW (NARROW)
 - 5 12" (300) SOLID WHITE
 - 6 RESERVED
 - 7 6" (150) SKIP-DASH (WHITE)
 - 8 4" (100) SOLID (WHITE)
 - 9 12" (300) DIAGONAL (WHITE)
 - 10 6" (150) SOLID (WHITE)
 - 11 24" (600) STOP BAR (WHITE)
 - 12 8" (200) SOLID (WHITE)
 - 13 4" (100) PARKING WHITE
-

GENERAL NOTES

1. TURN ARROW PAIRS SHALL BE PLACED AT 250' (75 m) INTERVALS AND SHALL BE EVENLY SPACED BETWEEN BOTH ENDS OF THE BIDIRECTIONAL LEFT TURN LANE. USE A MINIMUM OF TWO PAIRS PER BLOCK.
2. THE SOLID YELLOW PAVEMENT MARKINGS [2] SHOULD GENERALLY START OR END NEAR THE RADIUS POINT OF EACH STREET RETURN EXCEPT WHERE ONE OR BOTH ENDS WOULD INCLUDE STOP BARS.
3. THE SKIP-DASH PAVEMENT MARKINGS [1] OR [7] SHOULD BE CENTERED BETWEEN BOTH ENDS OF EACH CITY BLOCK AND SHALL BE PLACED SO THEY LINE UP ACROSS FROM EACH OTHER.
4. USE LARGE ARROW SIZE FOR BOTH RURAL AND URBAN LOCATIONS. (SEE LAST PAGE OF SECTION 780x FOR SYMBOLS TABLE)
5. LANE LINE EXTENSIONS SHALL BE THE SAME COLOR AND WIDTH AS THE LANE LINE BEING EXTENDED.

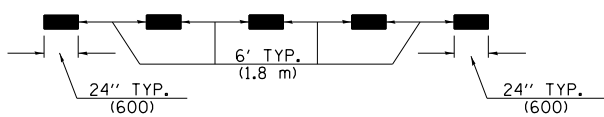

LANE LINE EXTENSIONS

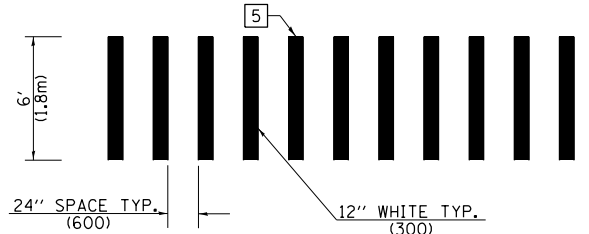

CROSSWALK DETAIL (DECATUR CITY LIMITS ONLY)

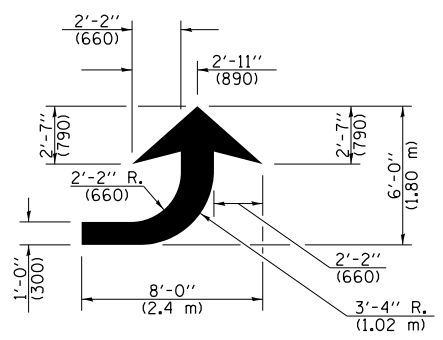

LEFT ARROW

REVERSE FOR RIGHT ARROW
AREA = 15.6 SQ. FT. (1.47 m²)
(WHITE)

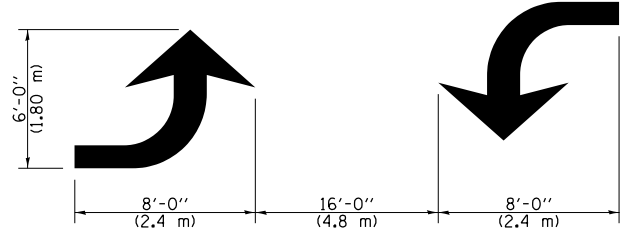

TYPICAL DOUBLE TURN ARROWS (WHITE)

NOT TO SCALE

Note: All dimensions are in INCHES (millimeters) unless otherwise shown.

DISTRICT 7 DETAIL NO. 7800001

FILE NAME =	USER NAME = steffenmk	DESIGNED -	REVISED -	STATE OF ILLINOIS DEPARTMENT OF TRANSPORTATION	PAVEMENT MARKING AND RAISED REFLECTIVE PAVEMENT MARKERS (RURAL & URBAN APPLICATIONS)	F.A. RTÉ.	SECTION	COUNTY	TOTAL SHEETS	SHEET NO.	
pw\11084EBIDINTEG.illinois.gov\PIWIDOT\Documents\IDOT Offices\District 7\Projects\74868\Drawings\CABsheets\074868-shd-details.dwg	PLOT SCALE = 2.0000' / in.	CHECKED -	REVISED -			*	(4,5,6,7)PVTM PRSV	COLES	12	10	
	PLOT DATE = 10/15/2018	DATE -	REVISED -			CONTRACT NO. 74868					
						ILLINOIS FED. AID PROJECT					

* FAU 7705, FAS 1669, FAU 7619

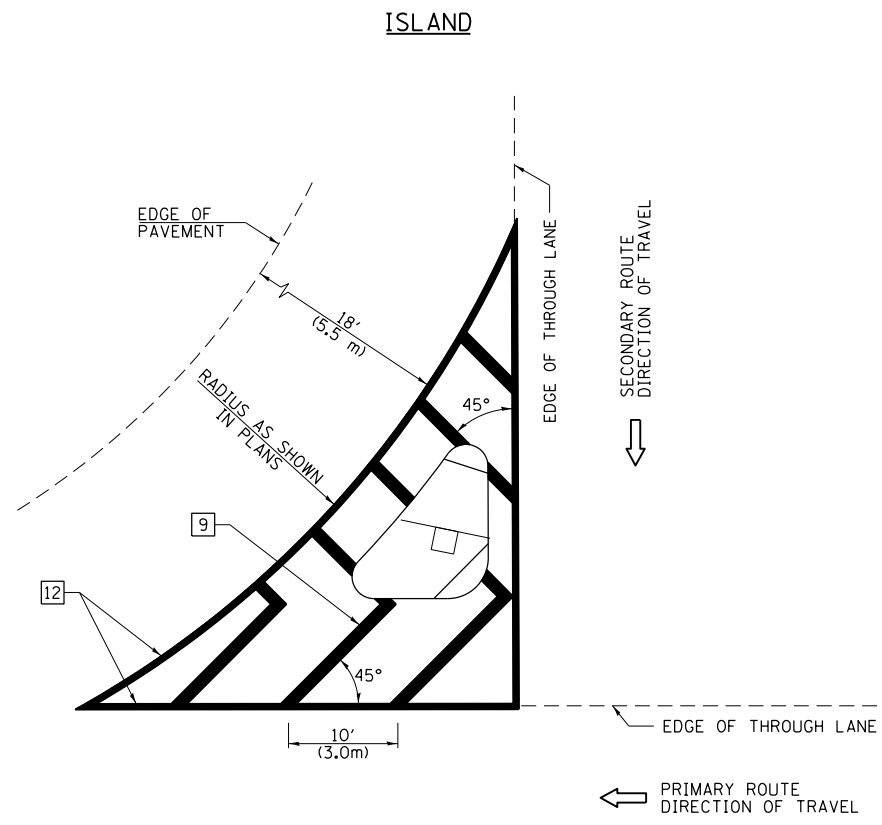

GENERAL NOTES

1. RAISED AND CORRUGATED MEDIANS SHALL BE OUTLINED WITH [2] IF PRESENT.
2. SOME OF THE INFORMATION INCLUDED WITH THIS DETAIL MAY NOT BE APPLICABLE TO THIS IMPROVEMENT.
3. PAVEMENT MARKINGS ARE TO BE EXTENDED THROUGH OMISSIONS WHEN APPLICABLE.
4. FINAL PAVEMENT MARKINGS SHALL BE IN PLACE PRIOR TO PLACING ANY RAISED REFLECTIVE PAVEMENT MARKERS.
5. THE FOLLOWING CRITERIA SHALL BE USED FOR SELECTING THE DIAGONAL PAVEMENT MARKING SPACING:

< 30 MPH (< 50 km/h)	15' (4.5 m)
30-45 MPH (50-75 km/h)	20' (6.0 m)
> 45 MPH (> 75 km/h)	30' (9.0 m)

PAVEMENT MARKING LEGEND

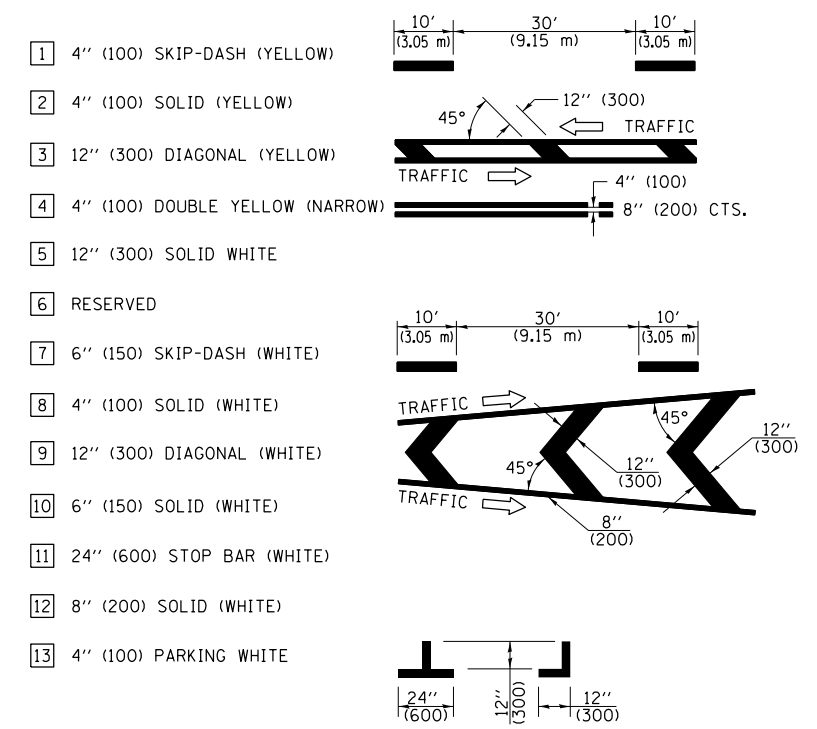

RURAL LEFT TURN STRIPING

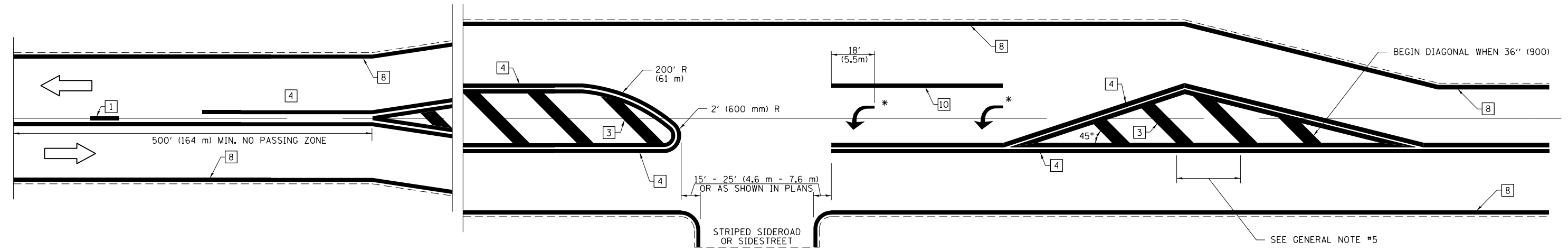

* PLACE AN ARROW 18' (5.5 m) BACK FROM STOP BAR. PLACE ANOTHER ARROW EVEN WITH THE BEGINNING OF THE SOLID WHITE LINE. SPACE ADDITIONAL ARROWS EVENLY UP TO 80' (24.4 m) MAXIMUM SPACING. USE MINIMUM OF 2 ARROWS.

NOT TO SCALE
 Note: All dimensions are in INCHES (millimeters) unless otherwise shown.

DISTRICT 7 DETAIL NO. 7800001

FILE NAME =	USER NAME = steffenmk	DESIGNED -	REVISED -
pw:\IL\084EBIDINTEG\illinois.gov\PWIDOT\Documents\IDOT Offices\District 7\Projects\74868\Drawings\CABsheets\074868-shd-details.dwg		DRAWN -	REVISED -
	PLOT SCALE = 2.0000' / in.	CHECKED -	REVISED -
	PLOT DATE = 10/15/2018	DATE -	REVISED -

**STATE OF ILLINOIS
 DEPARTMENT OF TRANSPORTATION**

PAVEMENT MARKING AND RAISED REFLECTIVE PAVEMENT MARKERS (RURAL & URBAN APPLICATIONS)			
SCALE:	SHEET NO. 3 OF 4 SHEETS	STA.	TO STA.

F.A. RTÉ.	SECTION	COUNTY	TOTAL SHEETS	SHEET NO.
*	(4,5,6,7)PVT PRSV	COLES	12	11
CONTRACT NO. 74868				
ILLINOIS FED. AID PROJECT				

* FAU 7705, FAS 1669, FAU 7619

PAVEMENT MARKINGS AT RAILROAD-HIGHWAY GRADE CROSSING

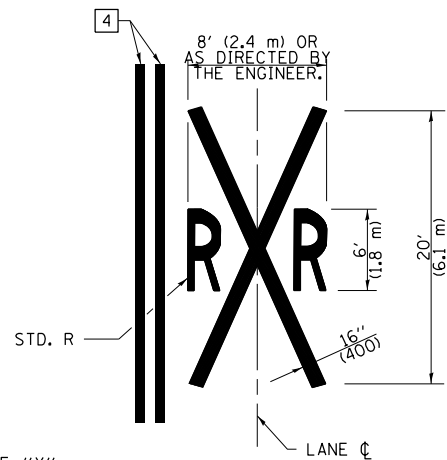
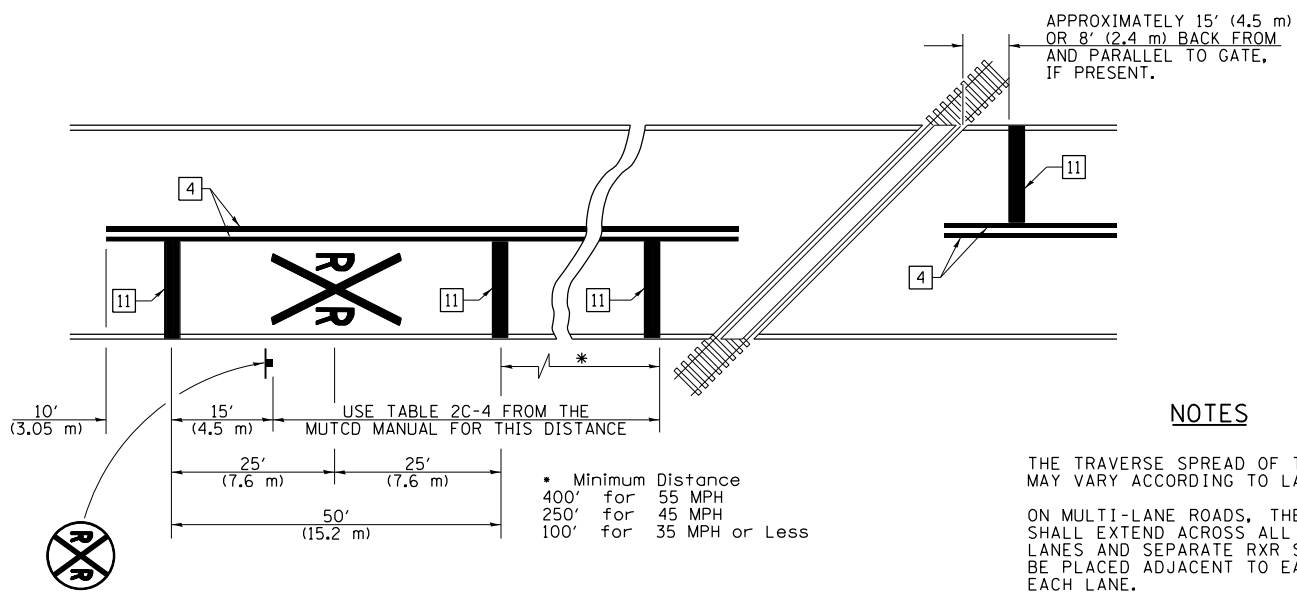

NOTES

THE TRAVERSE SPREAD OF THE "X" MAY VARY ACCORDING TO LANE WIDTH.

ON MULTI-LANE ROADS, THE STOP LINES SHALL EXTEND ACROSS ALL APPROACH LANES AND SEPARATE RXR SYMBOLS SHALL BE PLACED ADJACENT TO EACH OTHER IN EACH LANE.

WHEN THE PAVEMENT MARKING SYMBOL IS USED, A PORTION OF THE SYMBOL SHOULD BE LOCATED DIRECTLY ADJACENT TO THE ADVANCE WARNING SIGN (W10-1) AS PLACED BY TABLE II-1, CONDITION B OF THE MUTCD.

PAVEMENT MARKING LEGEND

- 1 4" (100) SKIP-DASH (YELLOW)
- 2 4" (100) SOLID (YELLOW)
- 3 12" (300) DIAGONAL (YELLOW)
- 4 4" (100) DOUBLE YELLOW (NARROW)
- 5 12" (300) SOLID WHITE
- 6 RESERVED
- 7 6" (150) SKIP-DASH (WHITE)
- 8 4" (100) SOLID (WHITE)
- 9 12" (300) DIAGONAL (WHITE)
- 10 6" (150) SOLID (WHITE)
- 11 24" (600) STOP BAR (WHITE)
- 12 8" (200) SOLID (WHITE)
- 13 4" (100) PARKING WHITE

RAILROAD CROSSING WITH INTERCONNECT ONLY

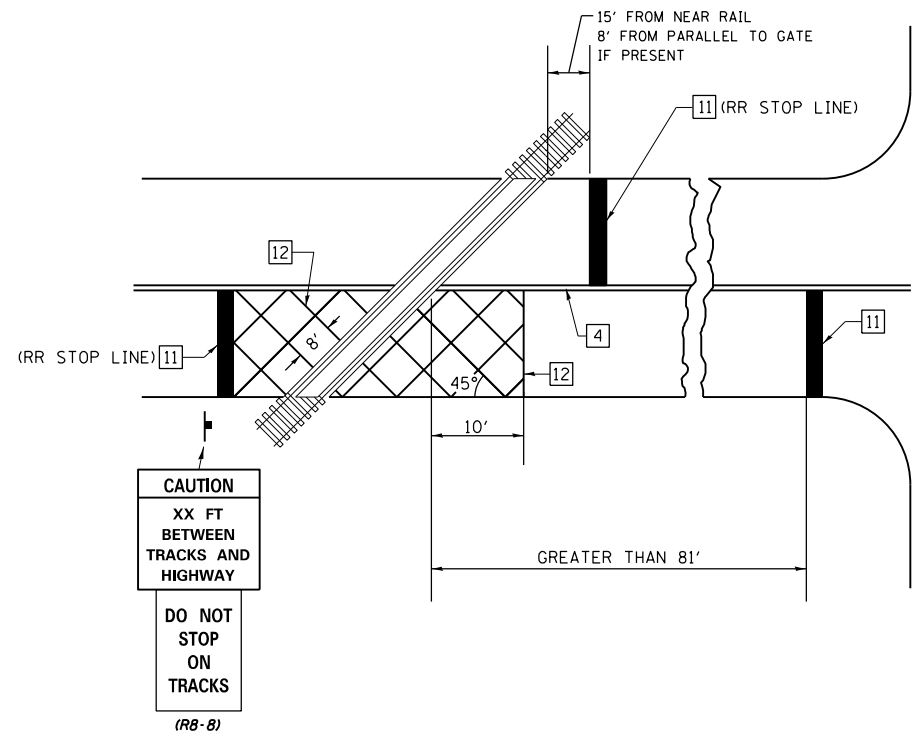

RAILROAD CROSSING WITH INTERCONNECT AND PRE-SIGNALS

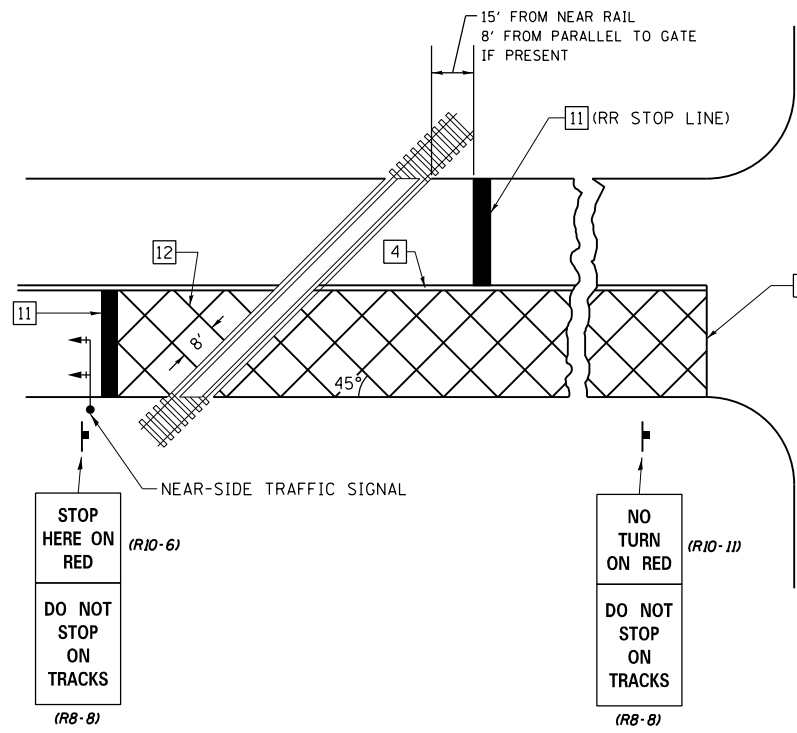

SUPPLEMENTAL PAVEMENT MARKING TREATMENT FOR RAILROAD-HIGHWAY GRADE CROSSING

GENERAL NOTES

- SUPPLEMENTAL PAVEMENT MARKINGS TO BE INSTALLED ONLY ON APPROACHES TO INTERSECTIONS CONTROLLED BY TRAFFIC SIGNALS WHICH ARE INTERCONNECTED WITH THE RAILROAD WARNING SIGNALS.
- EXTEND PAVEMENT MARKINGS TO THE INTERSECTION ONLY WHERE NEAR-SIDE TRAFFIC SIGNALS ARE USED.

NOT TO SCALE

Note: All dimensions are in INCHES (millimeters) unless otherwise shown.

DISTRICT 7 DETAIL NO. 7800001

FILE NAME =	USER NAME = steffenmk	DESIGNED -	REVISED -	STATE OF ILLINOIS DEPARTMENT OF TRANSPORTATION	PAVEMENT MARKING AND RAISED REFLECTIVE PAVEMENT MARKERS (RURAL & URBAN APPLICATIONS)
pw:\IL\084EBIDINTEG.illinois.gov\PIWIDOT\Documents\IDOT Offices\District 7\Projects\74868\Drawings\CAD\Drawings\74868-shd-details.dwg	DATE = 10/15/2018	CHECKED -	REVISED -		
		DATE -	REVISED -		
PLOT SCALE = 2.0000' / in.		SCALE: SHEET NO. 4 OF 4 SHEETS STA. TO STA.		SECTION COUNTY TOTAL SHEETS SHEET NO. 4,5,6,7 PVMT PRSV COLES 12 12 CONTRACT NO. 74868	
ILLINOIS FED. AID PROJECT * FAU 7705, FAS 1669, FAU 7619					