

STATE OF ILLINOIS  
DEPARTMENT OF TRANSPORTATION

F.A.I. RTE.	SECTION	COUNTY	TOTAL SHEETS	SHEET NO.
74	137-2HB-1BP	FERRY	24	1
ILLINOIS			CONTRACT NO. 64N08	

D-92-053-18

FOR INDEX OF SHEETS, SEE SHEET NO. 2  
FOR STATE STANDARDS, SEE SHEET NO. 2

# PROPOSED HIGHWAY PLANS

FAI ROUTE 74 (I-74)  
SECTION: (37-2HB-1)BP  
PROJECT: NHPP-6XIJ(485)  
TYPE of IMPROVEMENT: BRIDGE PAINTING  
HENRY COUNTY



HENRY COUNTY  
WESTERN TOWNSHIP — SECTIONS 1 & 12

SN 037-0103

C-92-082-18

R.1E.

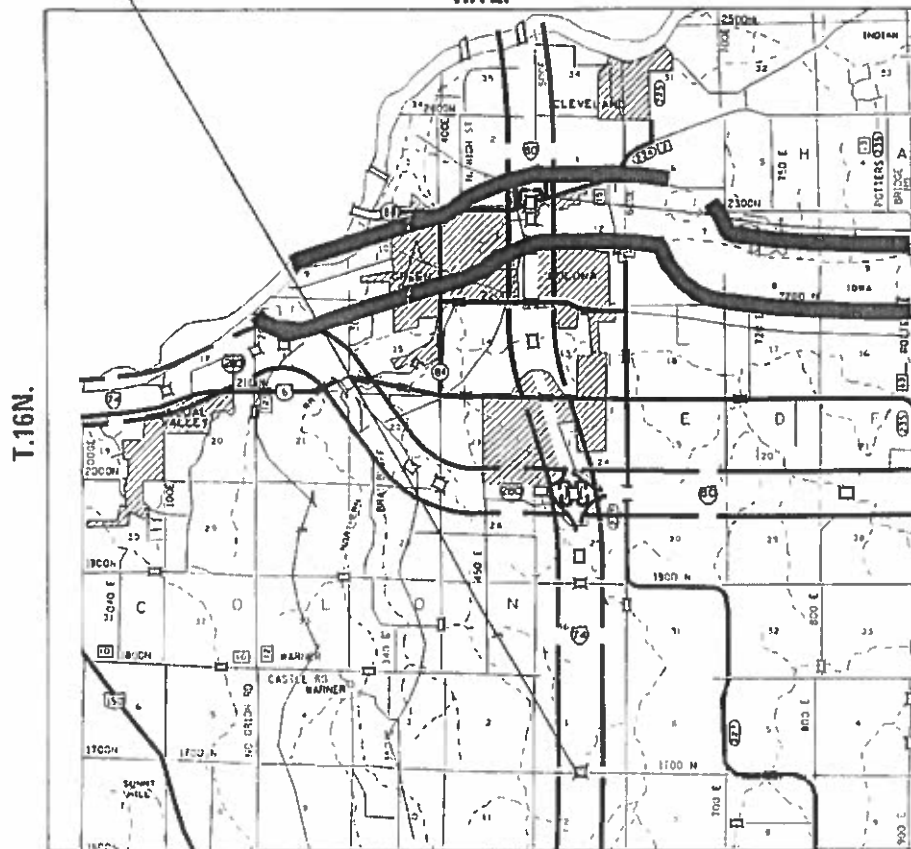

T.16N.

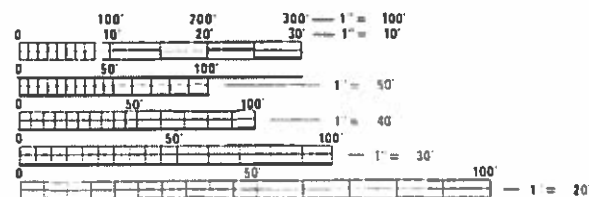

FULL SIZE PLANS HAVE BEEN PREPARED USING STANDARD  
ENGINEERING SCALES. REDUCED SIZED PLANS WILL NOT  
CONFORM TO STANDARD SCALES. IN MAKING MEASUREMENTS  
ON REDUCED PLANS, THE ABOVE SCALES MAY BE USED.

J.U.L.I.E.  
JOINT UTILITY LOCATION INFORMATION FOR EXCAVATION  
1-800-892-0123  
OR 811

PROJECT ENGINEER: DAVID DOSS (815) 284-5416  
PROJECT MANAGER: MAHMOUD ETEMADI (815) 284-5393

CONTRACT NO. 64N08

STATE OF ILLINOIS  
DEPARTMENT OF TRANSPORTATION

SUBMITTED 10-5-18  
Maahub  
REGIONAL ENGINEER

Dec 7 2018  
ENGINEER OF DESIGN AND ENVIRONMENT

Dec 7 2018  
DIRECTOR OF PROJECT IMPLEMENTATION

PRINTED BY THE AUTHORITY  
OF THE STATE OF ILLINOIS

# INDEX OF SHEETS

- 1 COVER SHEET
- 2 INDEX OF SHEETS / STATE STANDARDS / GENERAL NOTES
- 3 SUMMARY OF QUANTITIES
- 4 SCHEDULE OF QUANTITIES
- 5 STAGING TYPICAL
- 6-9 TRAFFIC CONTROL PLAN - STAGE I FOR SN 037-0103
- 10-13 TRAFFIC CONTROL PLAN - STAGE II FOR SN 037-0103
- 14-17 TRAFFIC CONTROL PLAN - STAGE III FOR SN 037-0103
- 18-21 TRAFFIC CONTROL PLAN - STAGE IV FOR SN 037-0103
- 22-24 EXISTING PLAN SHEETS (FOR INFORMATION ONLY)

# STATE STANDARDS

- 701101-05 OFF-ROAD OPERATIONS, MULTILANE, 15' (4.5m) TO 24" (600mm) FROM PAVEMENT EDGE
- 701301-04 LANE CLOSURE, 2L, 2W, SHORT TIME OPERATIONS
- 701400-09 APPROACH TO LANE CLOSURE, FREEWAY/EXPRESSWAY
- 701401-12 LANE CLOSURE, FREEWAY/EXPRESSWAY
- 701402-12 LANE CLOSURE, FREEWAY/EXPRESSWAY WITH BARRIER
- 701426-09 LANE CLOSURE, MULTILANE, INTERMITTENT OR MOVING OPERATIONS, FOR SPEEDS  $\geq$  45 MPH
- 701901-08 TRAFFIC CONTROL DEVICES
- 704001-08 TEMPORARY CONCRETE BARRIER
- 720011-01 METAL POSTS FOR SIGNS, MARKERS & DELINEATORS
- 728001-01 TELESCOPING STEEL SIGN SUPPORT
- 729001-01 APPLICATIONS OF TYPES A & B METAL POSTS (FOR SIGNS & MARKERS)

# GENERAL NOTES

A MINIMUM OF 2 AIR MONITORS WILL BE REQUIRED TO MONITOR ABRASIVE BLASTING OPERATIONS, SEE SPECIAL PROVISION FOR "CONTAINMENT AND DISPOSAL OF LEAD PAINT CLEANING RESIDUES".

THE CONTRACTOR SHALL SEED ALL DISTURBED AREAS WITHIN THE PROJECT LIMITS. SEEDING CLASS 2A SHALL BE USED. THIS WORK WILL BE INCLUDED IN THE CONTRACT UNIT PRICE PER LUMP SUM FOR CLEANING AND PAINTING STEEL BRIDGE NO. 1.

FERTILIZER SHALL BE APPLIED TO ALL DISTURBED AREAS AND INCORPORATED INTO THE SEEDBED PRIOR TO SEEDING OR PLACEMENT OF SOD AT THE RATE SPECIFIED IN SECTIONS 250 AND 252 OF THE STANDARD SPECIFICATIONS. THIS WORK SHALL BE INCLUDED IN THE COST OF CLEANING AND PAINTING STEEL BRIDGE NO. 1.

MULCH METHOD II SHALL BE APPLIED OVER ALL SEEDED AREAS. THIS SHALL BE INCLUDED IN THE COST OF THE CLEANING AND PAINTING STEEL BRIDGE NO. 1.

ALL BORROW/WASTE/USE SITES MUST BE APPROVED BY THE DEPARTMENT PRIOR TO REMOVING ANY MATERIAL FROM THE PROJECT OR INITIATING ANY EARTHMOVING ACTIVITIES, INCLUDING TEMPORARY STOCKPILING OUTSIDE THE LIMITS OF CONSTRUCTION.

TEMPORARY IMPACT ATTENUATORS WILL BE MEASURED AS EACH FOR EACH ATTENUATOR SUPPLIED ON THE JOB AS SPECIFIED IN THE PLANS, AND SHALL INCLUDE THE COST OF RENTING/OWNING THE ATTENUATOR FOR THE TIME REQUIRED ON THE JOB PLUS HAULING TO AND FROM THE PROJECT SITE, AS WELL AS ONE PLACEMENT AND REMOVAL FROM THE ROADWAY. THIS SHALL BE PAID FOR AT THE CONTRACT UNIT PRICE PER EACH FOR IMPACT ATTENUATORS, TEMPORARY OF THE TYPE SPECIFIED.

RELOCATE TEMPORARY IMPACT ATTENUATOR WILL BE PAID FOR AS EACH AND WILL BE PAID FOR EACH TIME THE ATTENUATOR IS REQUIRED BY STAGING TO BE PICKED UP AND MOVED TO A DIFFERENT LOCATION ON THE PROJECT, WHETHER IT IS TO ANOTHER LOCATION ON THE ROADWAY OR TO A STORAGE/STAGING LOCATION FOR THE PROJECT. THIS SHALL BE PAID FOR AT THE CONTRACT UNIT PRICE PER EACH FOR IMPACT ATTENUATORS, RELOCATE OF THE TYPE SPECIFIED.

THIS WORK SHALL BE DONE IN ACCORDANCE WITH SECTION 704 OF THE STANDARD SPECIFICATIONS. TEMPORARY CONCRETE BARRIER WILL BE MEASURED IN FEET ALONG THE CENTERLINE OF THE BARRIER AND SHALL INCLUDE THE COST OF RENTING/OWNING THE BARRIER FOR THE TIME REQUIRED ON THE JOB PLUS HAULING TO AND FROM THE PROJECT SITE, AS WELL AS ONE PLACEMENT AND REMOVAL FROM THE ROADWAY IN ACCORDANCE WITH SECTION 704 OF THE STANDARD AND SPECIFICATION. THIS SHALL BE PAID FOR AT THE CONTRACT UNIT PRICE PER FOOT FOR TEMPORARY CONCRETE BARRIER.

RELOCATE TEMPORARY CONCRETE BARRIER WILL BE PAID FOR IN FEET ALONG THE CENTERLINE OF THE BARRIER, AND WILL BE PAID FOR EACH TIME THE BARRIER IS REQUIRED BY STAGING TO BE PICKED UP AND MOVED TO A DIFFERENT LOCATION ON THE PROJECT, WHETHER IT IS TO ANOTHER LOCATION ON THE ROADWAY OR TO A STORAGE/STAGING LOCATION FOR THE PROJECT. THIS SHALL BE PAID FOR AT THE CONTRACT UNIT PRICE PER FOOT FOR RELOCATE TEMPORARY CONCRETE BARRIER.

THE CONTRACTOR SHALL BE RESPONSIBLE FOR PROTECTING UTILITY PROPERTY DURING CONSTRUCTION OPERATIONS AS OUTLINED IN ARTICLE 107.31 OF THE STANDARD SPECIFICATIONS. A MINIMUM OF 48 HOURS ADVANCE NOTICE IS REQUIRED FOR NON-EMERGENCY WORK. THE JULIE NUMBER IS 800-892-0123.

THE SSPC QP1 & QP2 CONTRACT CERTIFICATIONS WILL BE REQUIRED FOR THIS CONTRACT.

MODEL: Default  
FILE: \\nas0101\B&E\BID\NTEC\Illinois\gov\PI\DOT\Documents\1\DOT\_Offices\Director\Projects\Operations\Bldg\_Section\Henry\037-0103\64N08\CADD\02-shr-cover.dgn

USER NAME = drossdd	DESIGNED - _____	REVISED - _____	<b>STATE OF ILLINOIS DEPARTMENT OF TRANSPORTATION</b>	<b>INDEX OF SHEETS, STATE STANDARDS &amp; GENERAL NOTES</b>		F.A.I. RTE.	SECTION	COUNTY	TOTAL SHEETS	SHEET NO.
	DRAWN - _____	REVISED - _____		74	(37-2HB-1)BP	HENRY	24	2		
PLOT SCALE = 40.0000 ' / in.	CHECKED - _____	REVISED - _____		CONTRACT NO. 64N08						
PLOT DATE = Oct-01-2018 03:06:01 PM	DATE - _____	REVISED - _____		SCALE: _____	SHEET _____ OF _____ SHEETS	STA. _____ TO STA. _____	ILLINOIS FED. AID PROJECT			

# SUMMARY OF QUANTITIES

CODE NUMBER	ITEM	UNIT	HENRY COUNTY	TOTAL QUANTITY
			0047 90% NHPP 10% STATE	
67100100	MOBILIZATION	L SUM	1	1
70100207	TRAFFIC CONTROL AND PROTECTION, STANDARD 701402	EACH	2	2
70100800	TRAFFIC CONTROL AND PROTECTION, STANDARD 701401	L SUM	1	1
70107004	PAVEMENT MARKING BLACKOUT TAPE, 4"	FOOT	1325	1325
70300150	SHORT TERM PAVEMENT MARKING REMOVAL	SQ FT	442	442
70300904	PAVEMENT MARKING TAPE, TYPE IV 4"	FOOT	9045	9045
70400100	TEMPORARY CONCRETE BARRIER	FOOT	462.5	462.5
70400200	RELOCATE TEMPORARY CONCRETE BARRIER	FOOT	712.5	712.5
70600250	IMPACT ATTENUATORS, TEMPORARY (NON-REDIRECTIVE), TEST LEVEL 3	EACH	1	1
70600350	IMPACT ATTENUATORS, RELOCATE ( NON-REDIRECTIVE), TEST LEVEL 3	EACH	3	3
X5067501	BRIDGE CLEANING AND PAINTING WARRANTY NUMBER 1	L SUM	1	1
X7030005	TEMPORARY PAVEMENT MARKING REMOVAL	SQ FT	3016	3016
Z0007101	CONTAINMENT AND DISPOSAL OF LEAD PAINT CLEANING RESIDUES NO. 1	L SUM	1	1
Z0010501	CLEANING AND PAINTING STEEL BRIDGE NO. 1	L SUM	1	1

MODEL: Default  
 FILE NAME: P:\1108\B&E\BID\NTEC\Illinois.gov\PWIDOT\Documents\DOT\_Offices\District 2\Projects\Operations\Bridges\_Section\Henry0317\_010316\4108\CADD\02-shit-cover.dgn

USER NAME = dossdd PLOT SCALE = 40.0000' / in. PLOT DATE = Oct-01-2018 03:06:08 PM	DESIGNED - _____ DRAWN - _____ CHECKED - _____ DATE - _____	REVISED - _____ REVISED - _____ REVISED - _____ REVISED - _____	<b>STATE OF ILLINOIS DEPARTMENT OF TRANSPORTATION</b>	<b>SUMMARY OF QUANTITIES</b>	SCALE: _____ SHEET _____ OF _____ SHEETS STA. _____ TO STA. _____	F.A.I. RTE. 74 SECTION (37-2HB-1)BP COUNTY HENRY TOTAL SHEETS 24 SHEET NO. 3 CONTRACT NO. 64N08 ILLINOIS FED. AID PROJECT
--	--	--	---	------------------------------	---	---

# SCHEDULE OF QUANTITIES

70400100	TEMPROARY CONCRETE BARRIER		
	<u>LOCATION</u>	<u>COMMENTS</u>	<u>FOOT</u>
	STAGE I		
	STA 891+50-894+75	TANGENT	325
	STA 894+75-895+87.5	TAPER	112.5
	STAGE II		
	STA 895+87.5-896+12.5	TAPER	25
	TOTAL		<u>462.5</u>

70300150	SHORT TERM PAVEMENT MARKING REMOVAL		
	<u>LOCATION</u>	<u>COMMENTS</u>	<u>SQ FT</u>
	STAGE II		
	660'	BLACKOUT TAPE, 4"	220
	STAGE III		
	665'	BLACKOUT TAPE, 4"	222
	TOTAL		<u>442</u>

70400200	RELOCATE TEMPROARY CONCRETE BARRIER		
	<u>LOCATION</u>	<u>COMMENTS</u>	<u>FOOT</u>
	STAGE II		
	STA 894+75-896+12.5	TAPER	137.5
	STAGE III		
	STA 899+87.5-891+25	TAPER	137.5
	STA 891+25-894+50	TANGENT	325
	STAGE IV		
	STA 890+12.5-891+25	TAPER	112.5
	TOTAL		<u>712.5</u>

70300904	PAVEMENT MARKING TAPE, TYPE IV 4"		
	<u>LOCATION</u>	<u>COMMENTS</u>	<u>FOOT</u>
	STAGE I		
	STA 891+50-900+25	∅TANGENT	875
	STA 900+25-910+25	TAPER	1000
	STAGE II		
	STA 890+05-891+45	TAPER x2	280
	STA 891+45-895+25	TANGENT x2	760
	STA 895+25-896+65	TAPER x2	280
	STA 900+25-901+65	∅TANGENT	140
	STA 901+65-911+65	TAPER	1000
	STAGE III		
	STA 874+35-884+35	TAPER	1000
	STA 884+35-889+35	∅TANGENT	500
	STA 889+35-890+75	TAPER x2	280
	STA 890+75-894+60	TANGENT x2	770
	STA 894+60-896+00	TAPER x2	280
	STAGE IV		
	STA 875+75-885+75	TAPER	1000
	STA 885+75-894+55	∅TANGENT	880
	TOTAL		<u>9045</u>

70107004	PAVEMENT MARKING BLACKOUT TAPE, 4"		
	<u>LOCATION</u>	<u>COMMENTS</u>	<u>FOOT</u>
	STAGE I		
		NONE REQUIRED	
	STAGE II		
	STA 890+05-891+45	TAPER (LEFT SHOULDER)	140
	STA 891+45-895+25	TANGENT (LEFT SHOULDER)	380
	STA 895+25-896+65	TAPER (LEFT SHOULDER)	140
	STAGE III		
	STA 899+35-890+75	TAPER (RIGHT SHOULDER)	140
	STA 890+75-894+60	TANGENT (RIGHT SHOULDER)	385
	STA 894+60-896+00	TAPER (RIGHT SHOULDER)	140
	STAGE IV		
		NONE REQUIRED	
	TOTAL		<u>1325</u>

X7030005	TEMPORARY PAVEMENT MARKING REMOVAL		
	<u>LOCATION</u>	<u>COMMENTS</u>	<u>SQ FT</u>
	STAGE I		
	1875'	MARKING TAPE, TYPE IV, 4"	625
	STAGE II		
	2460'	MARKING TAPE, TYPE IV, 4"	820
	STAGE III		
	2830'	MARKING TAPE, TYPE IV, 4"	944
	STAGE IV		
	1880'	MARKING TAPE, TYPE IV, 4"	627
	TOTAL		<u>3016</u>

MODEL: Default  
 FILE: \\nas01.pva.illinois.gov\pva\DOT\Documents\1007\103616108\CADD\02-shc-cover.dgn  
 PROJECT: 02\pva\DOT\Documents\1007\103616108\CADD\02-shc-cover.dgn

USER NAME = drossdd	DESIGNED - _____	REVISED - _____
DRAWN - _____	REVISIONS - _____	
PLOT SCALE = 40,0000 ' / in.	CHECKED - _____	REVISED - _____
PLOT DATE = Oct-01-2018 03:06:16 PM	DATE - _____	REVISED - _____

**STATE OF ILLINOIS  
DEPARTMENT OF TRANSPORTATION**

<b>SCHEDULE OF QUANTITIES</b>	
SCALE: _____	SHEET ____ OF ____ SHEETS
STA. _____	TO STA. _____

F.A.I. RTE.	SECTION	COUNTY	TOTAL SHEETS	SHEET NO.
74	(37-2HB-1)BP	HENRY	24	4
CONTRACT NO. 64N08				
ILLINOIS FED. AID PROJECT				

# STAGING TYPICAL

STAGES I & IV SN 037-0103 N 1700th AVE OVER I-74

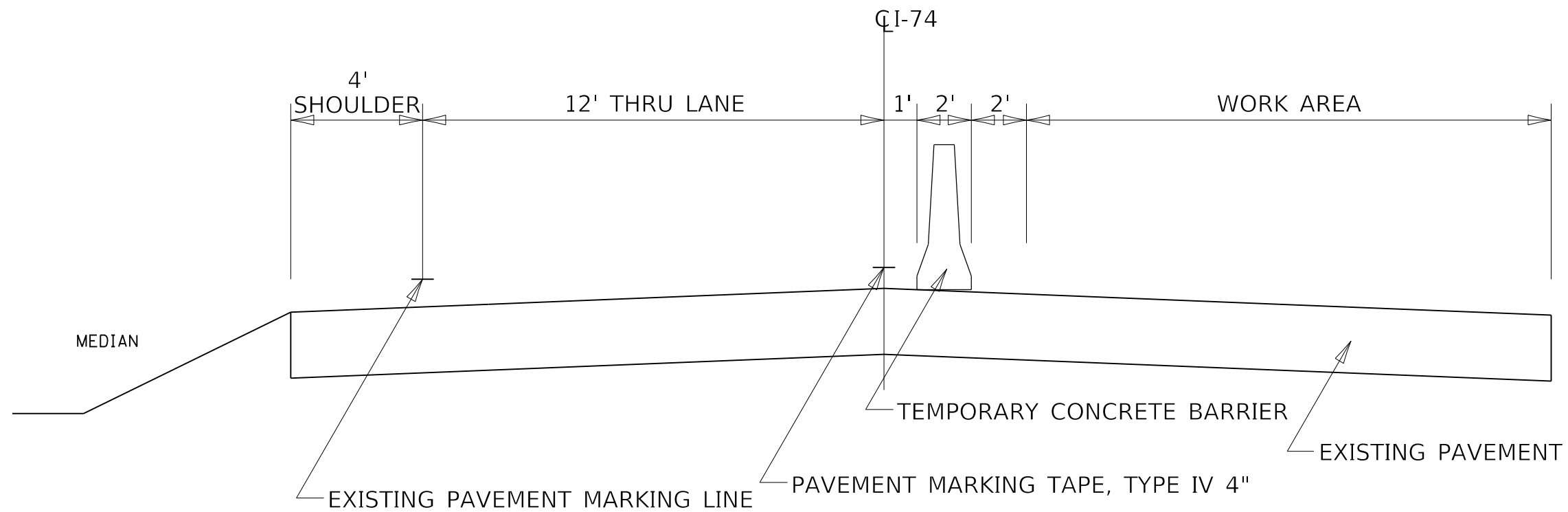

STAGES II & III SN 037-0103 N 1700th AVE OVER I-74

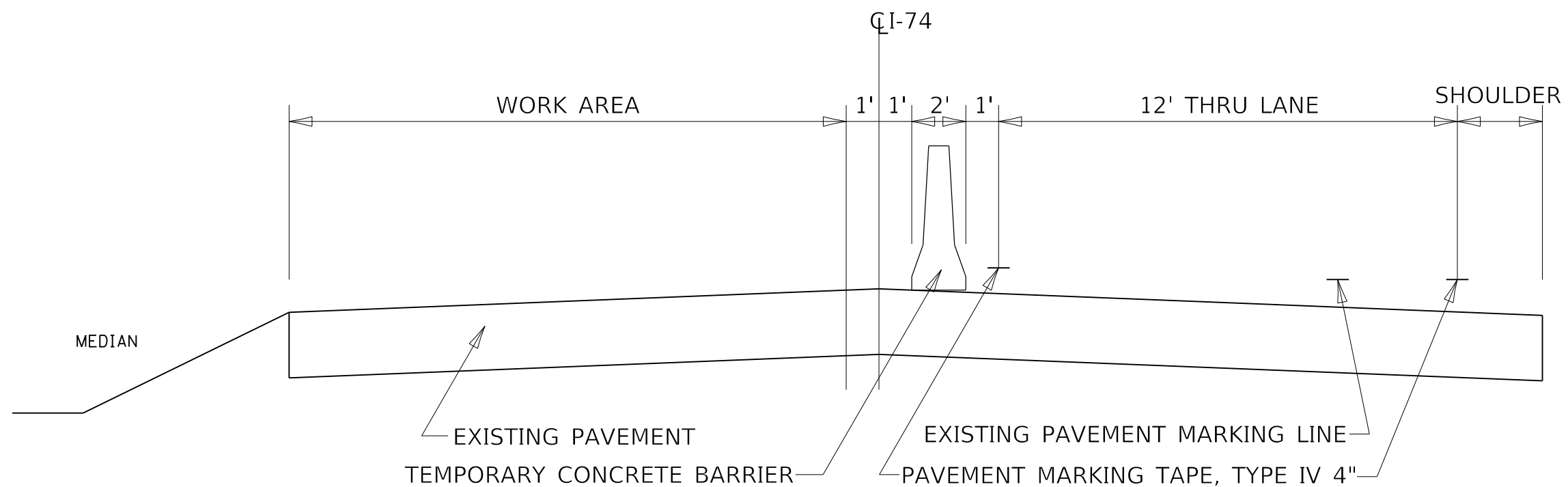

MODEL: Default  
 FILE: \\nas01c.psu.edu\B&E\BID\NTEC\Illinois.gov\PIVDOT\Documents\BID\Office\BID\refct\_2\Projects\Operations\Bldg - Section\Henry\037-0103\64N08\CADD\02-shc-cover.dgn

USER NAME = drossdd	DESIGNED - _____	REVISED - _____
	DRAWN - _____	REVISED - _____
PLOT SCALE = 40,0000 ' / in.	CHECKED - _____	REVISED - _____
PLOT DATE = Oct-01-2018 03:06:24 PM	DATE - _____	REVISED - _____

**STATE OF ILLINOIS  
DEPARTMENT OF TRANSPORTATION**

**STAGING TYPICAL**

SCALE: \_\_\_\_\_ SHEET \_\_\_\_ OF \_\_\_\_ SHEETS STA. \_\_\_\_\_ TO STA. \_\_\_\_\_

F.A.I. RTE.	SECTION	COUNTY	TOTAL SHEETS	SHEET NO.
74	(37-2HB-1)BP	HENRY	24	5
CONTRACT NO. 64N08				
ILLINOIS FED. AID PROJECT				

# TRAFFIC CONTROL PLAN – STAGE I FOR SN 037-0103

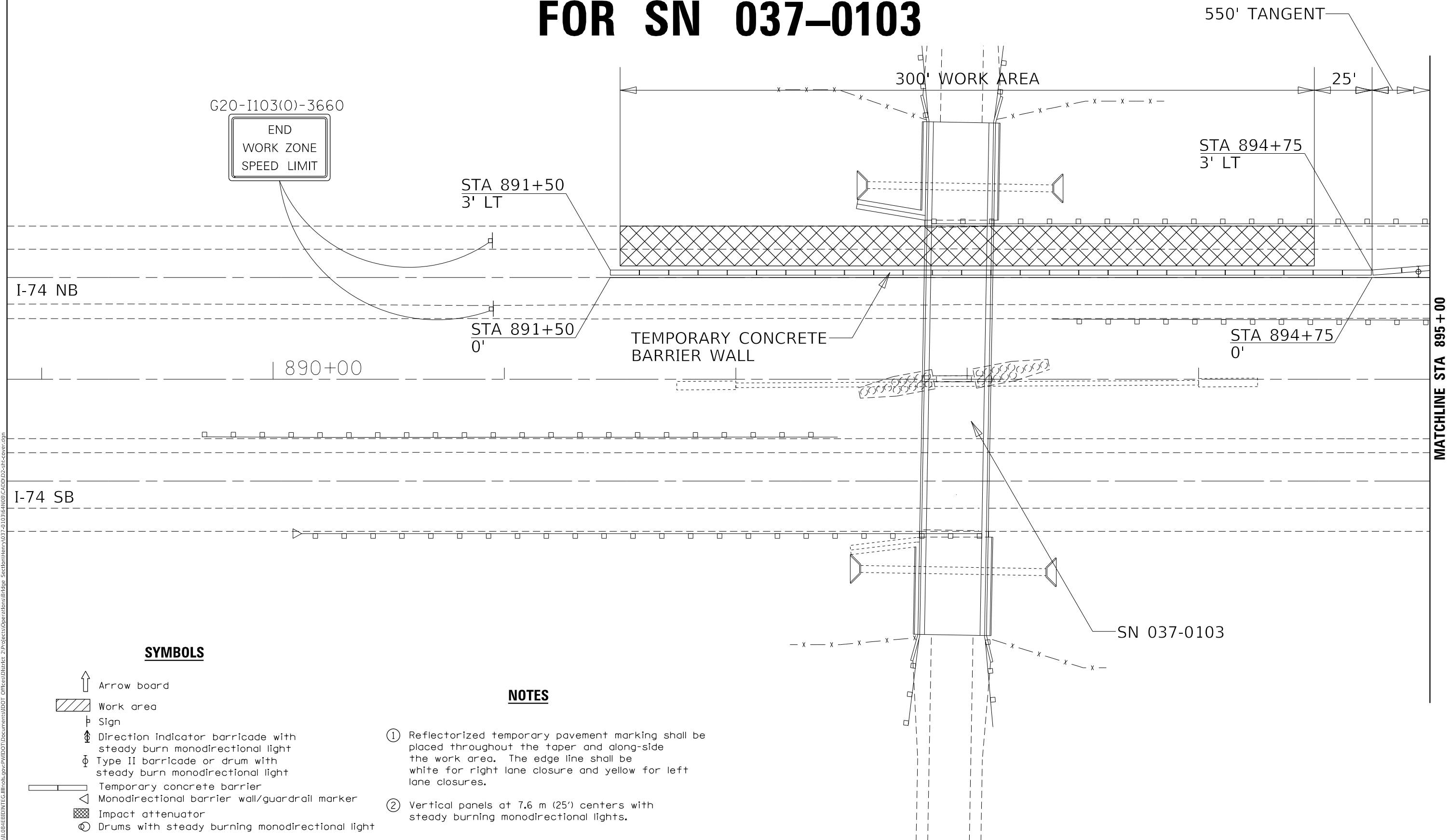
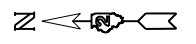

### SYMBOLS

- Arrow board
- Work area
- Sign
- Direction indicator barricade with steady burn monodirectional light
- Type II barricade or drum with steady burn monodirectional light
- Temporary concrete barrier
- Monodirectional barrier wall/guardrail marker
- Impact attenuator
- Drums with steady burning monodirectional light

### NOTES

- ① Reflectorized temporary pavement marking shall be placed throughout the taper and along-side the work area. The edge line shall be white for right lane closure and yellow for left lane closures.
- ② Vertical panels at 7.6 m (25') centers with steady burning monodirectional lights.

MODEL: Default  
 FILE: \\nas01.cba.illinois.gov\pww\DOT\Documents\180121\Projects\Operations\Bldg\_Section\Henry\037-0103\64N08\CADD\02-traffic-control.dgn

USER NAME = drossdd	DESIGNED - _____	REVISED - _____
PLOT SCALE = 40.0000 ' / in.	DRAWN - _____	REVISED - _____
PLOT DATE = Oct-01-2018 03:06:30 PM	CHECKED - _____	REVISED - _____
	DATE - _____	REVISED - _____

**STATE OF ILLINOIS  
DEPARTMENT OF TRANSPORTATION**

<b>TRAFFIC CONTROL PLAN – STAGE I FOR SN 037-0103</b>			
SCALE: _____	SHEET _____	OF _____	SHEETS
STA. _____	TO STA. _____		

F.A.I. RTE.	SECTION	COUNTY	TOTAL SHEETS	SHEET NO.
74	(37-2HB-1)BP	HENRY	24	6
CONTRACT NO. 64N08				
ILLINOIS FED. AID PROJECT				

MATCHLINE STA 895 + 00

# TRAFFIC CONTROL PLAN – STAGE I FOR SN 037-0103

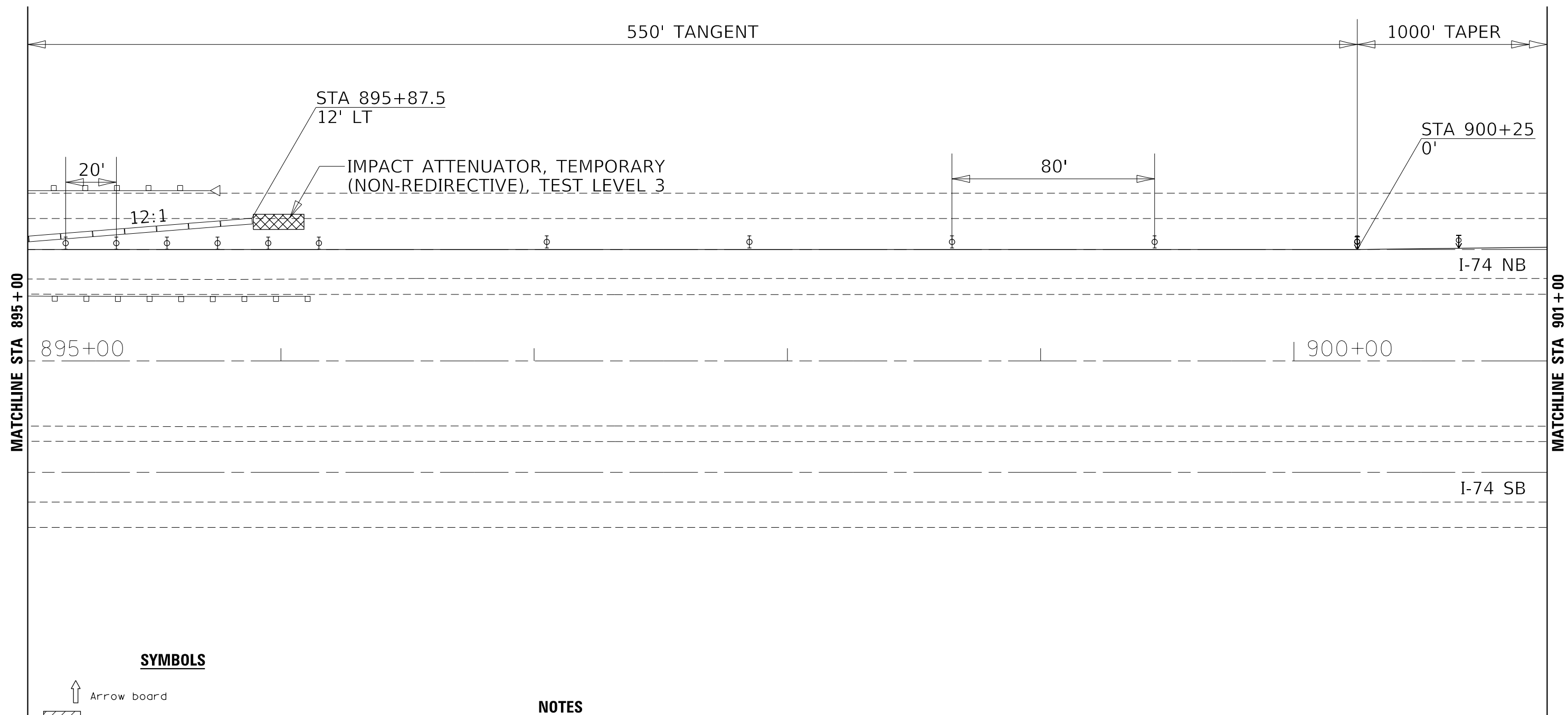
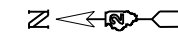

### SYMBOLS

- Arrow board
- Work area
- Sign
- Direction indicator barricade with steady burn monodirectional light
- Type II barricade or drum with steady burn monodirectional light
- Temporary concrete barrier
- Monodirectional barrier wall/guardrail marker
- Impact attenuator
- Drums with steady burning monodirectional light

### NOTES

- ① ReflectORIZED temporary pavement marking shall be placed throughout the taper and along-side the work area. The edge line shall be white for right lane closure and yellow for left lane closures.
- ② Vertical panels at 7.6 m (25') centers with steady burning monodirectional lights.

MODEL: Default  
 FILE: \\nas101\BIBED\BIBED\TEC\Illinois\pov\RWIDOT\Documents\18DOT\_Offices\Director\Projects\Operations\Bldg - Section\Henry\037-0103\64N08\CADD\02-htc-cover.dgn

USER NAME = drossdd	DESIGNED - _____	REVISED - _____
DRAWN - _____	REVISIONS - _____	
PLOT SCALE = 40,0000 ' / in.	CHECKED - _____	REVISED - _____
PLOT DATE = Oct-01-2018 03:06:37 PM	DATE - _____	REVISED - _____

**STATE OF ILLINOIS  
DEPARTMENT OF TRANSPORTATION**

**TTRAFFIC CONTROL PLAN – STAGE I  
FOR SN 037-0103**

SCALE: \_\_\_\_\_ SHEET \_\_\_\_ OF \_\_\_\_ SHEETS STA. \_\_\_\_\_ TO STA. \_\_\_\_\_

F.A.I. RTE.	SECTION	COUNTY	TOTAL SHEETS	SHEET NO.
74	(37-2HB-1)BP	HENRY	24	7
CONTRACT NO. 64N08				
ILLINOIS FED. AID PROJECT				

# TRAFFIC CONTROL PLAN – STAGE I FOR SN 037–0103

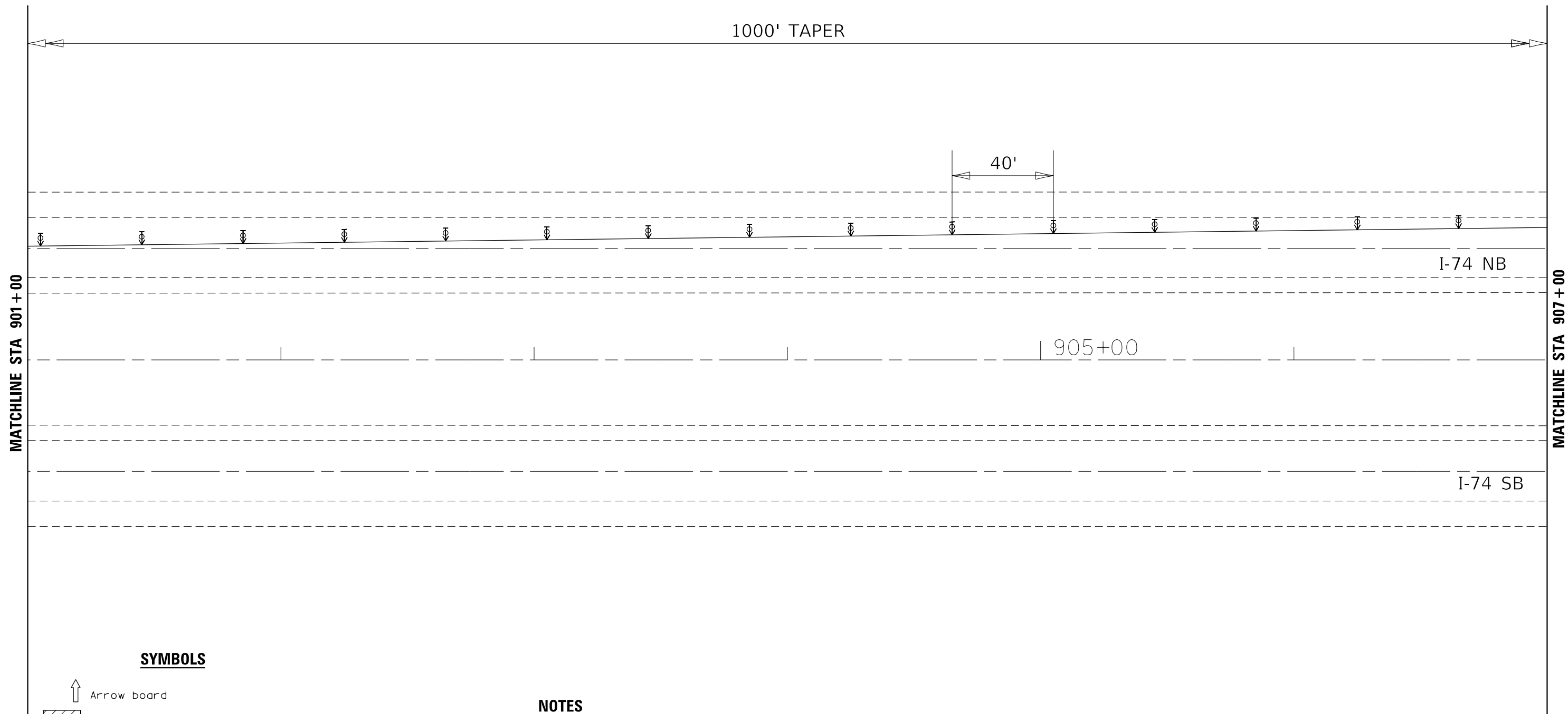

### SYMBOLS

- Arrow board
- Work area
- Sign
- Direction indicator barricade with steady burn monodirectional light
- Type II barricade or drum with steady burn monodirectional light
- Temporary concrete barrier
- Monodirectional barrier wall/guardrail marker
- Impact attenuator
- Drums with steady burning monodirectional light

### NOTES

- ① ReflectORIZED temporary pavement marking shall be placed throughout the taper and along-side the work area. The edge line shall be white for right lane closure and yellow for left lane closures.
- ② Vertical panels at 7.6 m (25') centers with steady burning monodirectional lights.

MODEL: Default  
FILE: \\nas0101\BIBED\BIBED\ITC\Illinois\pwr\pwr\DOT\Documents\18DOT\_Offices\Director\2\Projects\Operations\B4\Ips\_Section\Henry\037-0103\64N08\CADD\02-htc-cover.dgn

USER NAME = drossdd	DESIGNED - _____	REVISED - _____
	DRAWN - _____	REVISED - _____
PLOT SCALE = 40,0000 ' / in.	CHECKED - _____	REVISED - _____
PLOT DATE = Oct-01-2018 03:06:47 PM	DATE - _____	REVISED - _____

**STATE OF ILLINOIS  
DEPARTMENT OF TRANSPORTATION**

**TRAFFIC CONTROL PLAN – STAGE I  
FOR SN 037–0103**

SCALE: \_\_\_\_\_ SHEET \_\_\_\_ OF \_\_\_\_ SHEETS STA. \_\_\_\_\_ TO STA. \_\_\_\_\_

F.A.I. RTE.	SECTION	COUNTY	TOTAL SHEETS	SHEET NO.
74	(37-2HB-1)BP	HENRY	24	8
CONTRACT NO. 64N08				
ILLINOIS FED. AID PROJECT				



# TRAFFIC CONTROL PLAN – STAGE I FOR SN 037-0103

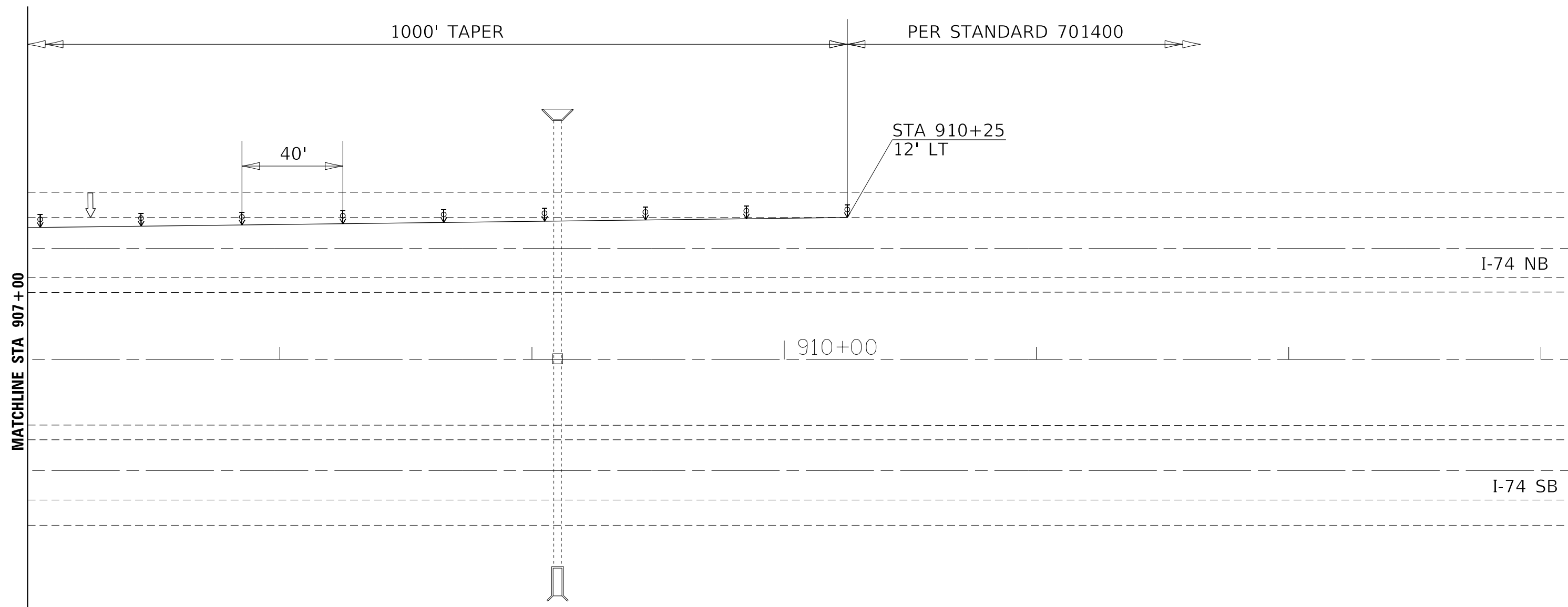
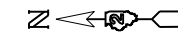

### SYMBOLS

- Arrow board
- Work area
- Sign
- Direction indicator barricade with steady burn monodirectional light
- Type II barricade or drum with steady burn monodirectional light
- Temporary concrete barrier
- Monodirectional barrier wall/guardrail marker
- Impact attenuator
- Drums with steady burning monodirectional light

### NOTES

- ① Reflectorized temporary pavement marking shall be placed throughout the taper and along-side the work area. The edge line shall be white for right lane closure and yellow for left lane closures.
- ② Vertical panels at 7.6 m (25') centers with steady burning monodirectional lights.

MODEL: Default  
 FILE: \\nas0101\BIBID\ITC\Illinois\pwr\pwr\DOT\Documents\DOT\_Offices\District 2\Projects\Operations\Bldg - Section\Henry\037-0103\64N08\CADD\02-htc-cover.dgn

USER NAME = drossdd	DESIGNED - _____	REVISED - _____
PLOT SCALE = 40,0000 ' / in.	DRAWN - _____	REVISED - _____
PLOT DATE = Oct-01-2018 03:06:55 PM	CHECKED - _____	REVISED - _____
	DATE - _____	REVISED - _____

**STATE OF ILLINOIS  
DEPARTMENT OF TRANSPORTATION**

**TTRAFFIC CONTROL PLAN – STAGE I  
FOR SN 037-0103**

SCALE: \_\_\_\_\_ SHEET \_\_\_\_ OF \_\_\_\_ SHEETS STA. \_\_\_\_\_ TO STA. \_\_\_\_\_

F.A.I. RTE.	SECTION	COUNTY	TOTAL SHEETS	SHEET NO.
74	(37-2HB-1)BP	HENRY	24	9
CONTRACT NO. 64N08			ILLINOIS FED. AID PROJECT	



# TRAFFIC CONTROL PLAN – STAGE II FOR SN 037-0103

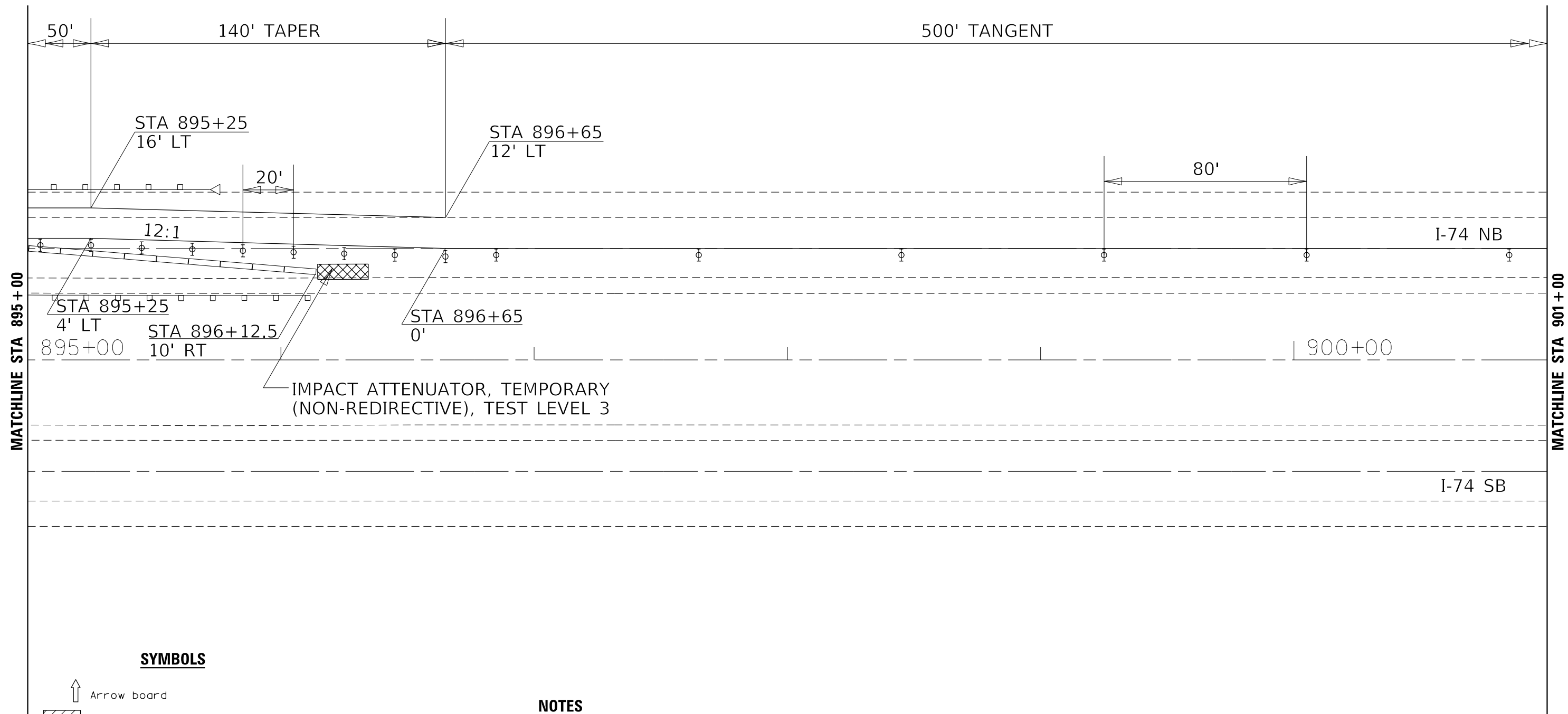

### SYMBOLS

- Arrow board
- Work area
- Sign
- Direction indicator barricade with steady burn monodirectional light
- Type II barricade or drum with steady burn monodirectional light
- Temporary concrete barrier
- Monodirectional barrier wall/guardrail marker
- Impact attenuator
- Drums with steady burning monodirectional light

### NOTES

- ① Reflectorized temporary pavement marking shall be placed throughout the taper and along-side the work area. The edge line shall be white for right lane closure and yellow for left lane closures.
- ② Vertical panels at 7.6 m (25') centers with steady burning monodirectional lights.

MODEL: Default  
 FILE: \\nas01.cba.illinois.gov\pww\DOT\Documents\1801\DOT\_Offices\Director\Projects\Operations\Bldg - Section\Henry\037-0103\64N08\CADD\02-plt-cover.dgn

USER NAME = drossdd	DESIGNED - _____	REVISED - _____
	DRAWN - _____	REVISED - _____
PLOT SCALE = 40,0000 ' / in.	CHECKED - _____	REVISED - _____
PLOT DATE = Oct-01-2018 03:07:14 PM	DATE - _____	REVISED - _____

**STATE OF ILLINOIS  
DEPARTMENT OF TRANSPORTATION**

**TTRAFFIC CONTROL PLAN – STAGE II  
FOR SN 037-0103**

SCALE: \_\_\_\_\_ SHEET \_\_\_\_ OF \_\_\_\_ SHEETS STA. \_\_\_\_\_ TO STA. \_\_\_\_\_

F.A.I. RTE.	SECTION	COUNTY	TOTAL SHEETS	SHEET NO.
74	(37-2HB-1)BP	HENRY	24	11
CONTRACT NO. 64N08				
ILLINOIS FED. AID PROJECT				

# TRAFFIC CONTROL PLAN – STAGE II FOR SN 037-0103

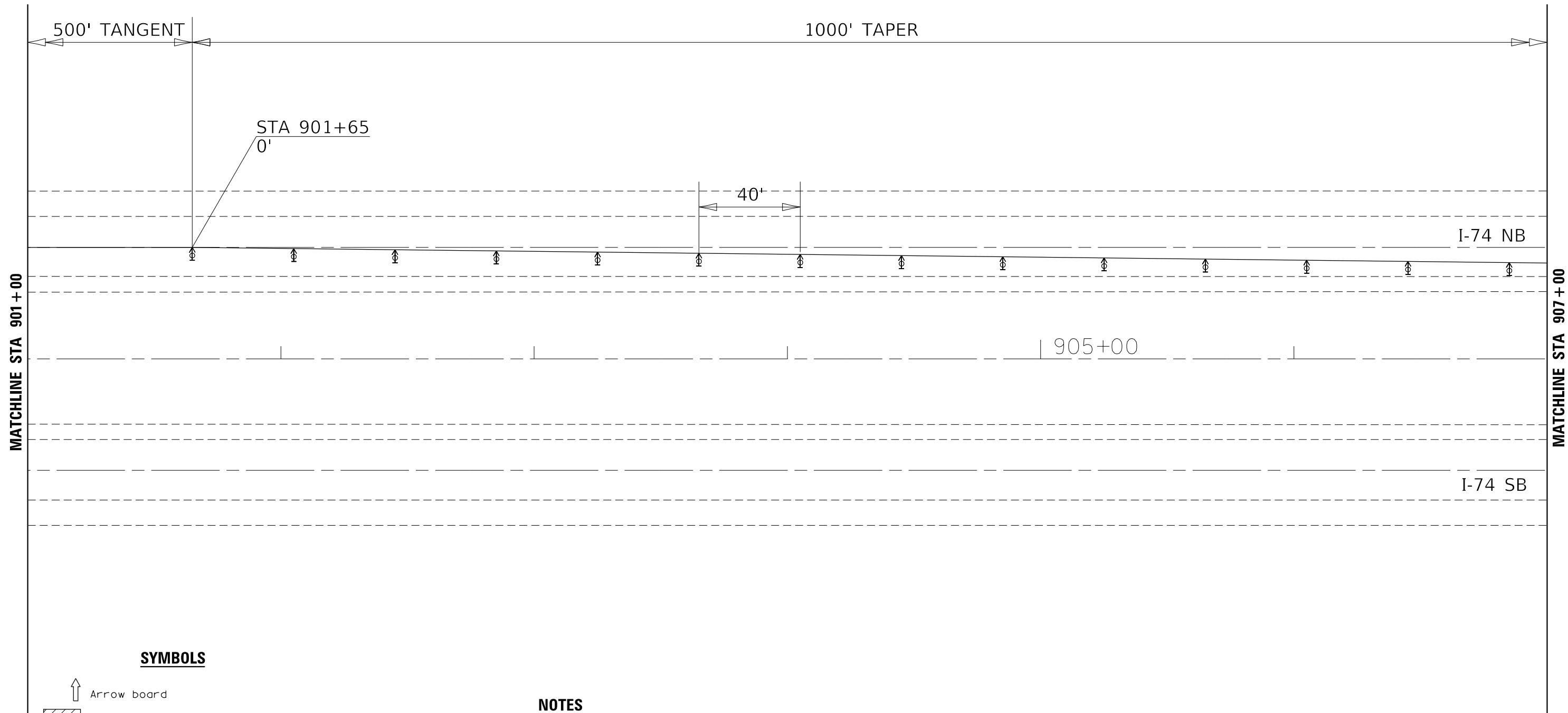

### SYMBOLS

- Arrow board
- Work area
- Sign
- Direction indicator barricade with steady burn monodirectional light
- Type II barricade or drum with steady burn monodirectional light
- Temporary concrete barrier
- Monodirectional barrier wall/guardrail marker
- Impact attenuator
- Drums with steady burning monodirectional light

### NOTES

- ① Reflectorized temporary pavement marking shall be placed throughout the taper and along-side the work area. The edge line shall be white for right lane closure and yellow for left lane closures.
- ② Vertical panels at 7.6 m (25') centers with steady burning monodirectional lights.

MODEL: Default  
 FILE: \\nas01.cba.illinois.gov\pww\DOT\Documents\1\DOT\_Offices\District 2\Projects\Operations\Bldg - Section\Henry037-0103\64N08\CADD\02-traffic-control.dgn

USER NAME = drossdd	DESIGNED - _____	REVISED - _____
PLOT SCALE = 40,0000 ' / in.	DRAWN - _____	REVISED - _____
PLOT DATE = Oct-01-2018 03:07:22 PM	CHECKED - _____	REVISED - _____
	DATE - _____	REVISED - _____

**STATE OF ILLINOIS  
DEPARTMENT OF TRANSPORTATION**

**TTRAFFIC CONTROL PLAN – STAGE II  
FOR SN 037-0103**

SCALE: \_\_\_\_\_ SHEET \_\_\_\_ OF \_\_\_\_ SHEETS STA. \_\_\_\_\_ TO STA. \_\_\_\_\_

F.A.I. RTE.	SECTION	COUNTY	TOTAL SHEETS	SHEET NO.
74	(37-2HB-1)BP	HENRY	24	12
CONTRACT NO. 64N08				
ILLINOIS FED. AID PROJECT				



# TRAFFIC CONTROL PLAN – STAGE III FOR SN 037–0103

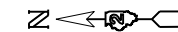

I-74 NB

I-74 SB









875+00

STA 874+35  
12' LT

40'

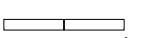
MATCHLINE STA 879+00

PER STANDARD 701400  
**SYMBOLS**

-  Arrow board
-  Work area
-  Sign
-  Direction indicator barricade with steady burn monodirectional light
-  Type II barricade or drum with steady burn monodirectional light
-  Temporary concrete barrier
-  Monodirectional barrier wall/guardrail marker
-  Impact attenuator
-  Drums with steady burning monodirectional light

**NOTES**

- ① Reflectorized temporary pavement marking shall be placed throughout the taper and along-side the work area. The edge line shall be white for right lane closure and yellow for left lane closures.
- ② Vertical panels at 7.6 m (25') centers with steady burning monodirectional lights.

1000' TAPER

MODEL: Default  
FILE: \\nas0101\BIBED\BIBED\ITC\Illinois\pwr\pwr\DOT\Documents\11001 - Office\11001\DOT - Project\Operations\Bldg - Section\Henry\037-0103\64N08\CADD\02-ht-ct-control.dgn

USER NAME = drossdd	DESIGNED - _____	REVISED - _____
	DRAWN - _____	REVISED - _____
PLOT SCALE = 40,0000 ' / in.	CHECKED - _____	REVISED - _____
PLOT DATE = Oct-01-2018 03:07:38 PM	DATE - _____	REVISED - _____

**STATE OF ILLINOIS  
DEPARTMENT OF TRANSPORTATION**

**TTRAFFIC CONTROL PLAN – STAGE III  
FOR SN 037–0103**

SCALE: \_\_\_\_\_ SHEET \_\_\_\_\_ OF \_\_\_\_\_ SHEETS STA. \_\_\_\_\_ TO STA. \_\_\_\_\_

F.A.I. RTE.	SECTION	COUNTY	TOTAL SHEETS	SHEET NO.
74	(37-2HB-1)BP	HENRY	24	14
CONTRACT NO. 64N08				
ILLINOIS FED. AID PROJECT				



# TRAFFIC CONTROL PLAN - STAGE III FOR SN 037-0103

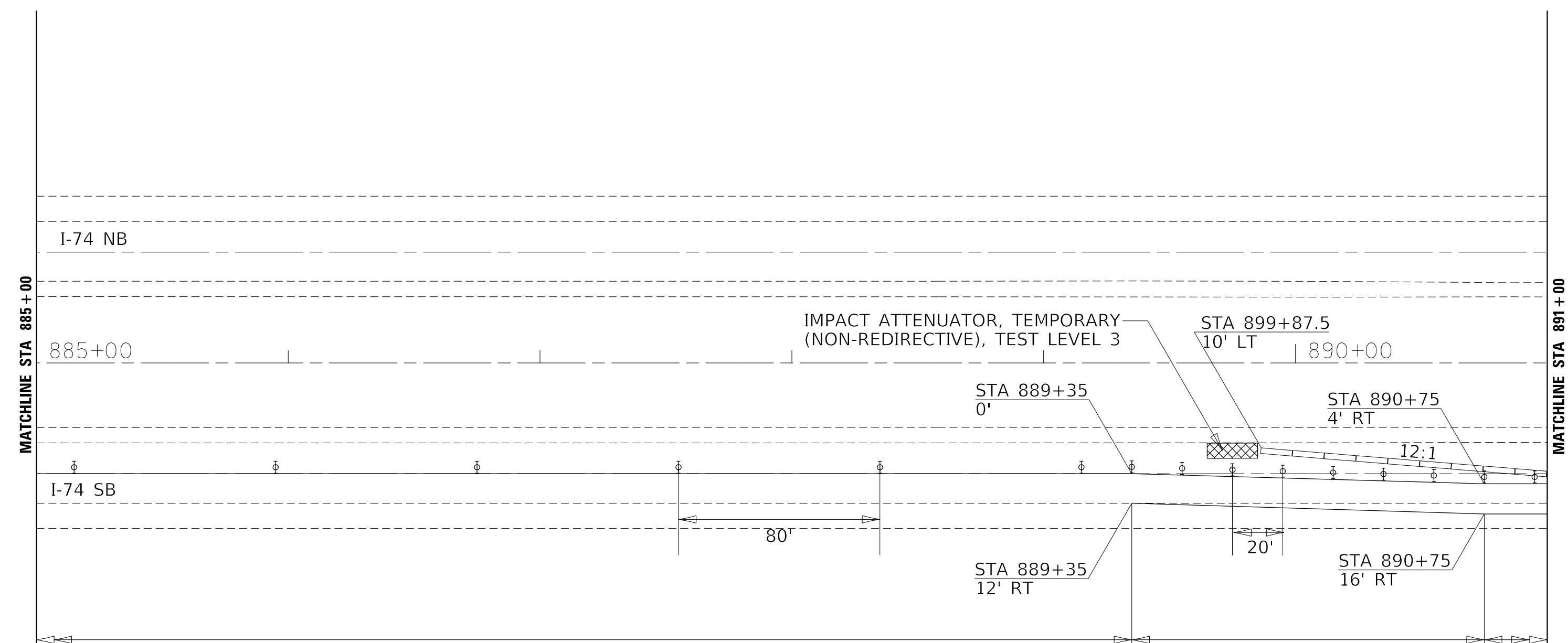
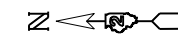

### SYMBOLS

- Arrow board
- Work area
- Sign
- Direction indicator barricade with steady burn monodirectional light
- Type II barricade or drum with steady burn monodirectional light
- Temporary concrete barrier
- Monodirectional barrier wall/guardrail marker
- Impact attenuator
- Drums with steady burning monodirectional light

### NOTES

- ① Reflectorized temporary pavement marking shall be placed throughout the taper and along-side the work area. The edge line shall be white for right lane closure and yellow for left lane closures.
- ② Vertical panels at 7.6 m (25') centers with steady burning monodirectional lights.

MODEL: Default  
 FILE: Name: P:\LULIU\BIBID\NTEC\Illinois\gov\PIVIDOT\Documents\I80\Office\DI\dirct\_2\Projects\Operations\B4\dirge\_Section\Henry\037-0103\64N08\CADD\02-shc-cover.dgn

USER NAME = dossed	DESIGNED -	REVISED -
PLOT SCALE = 40,0000 ' / in.	DRAWN -	REVISIONS -
PLOT DATE = Oct-01-2018 03:07:51 PM	CHECKED -	DATE -
	DATE -	REVISED -

**STATE OF ILLINOIS  
DEPARTMENT OF TRANSPORTATION**

**TTRAFFIC CONTROL PLAN - STAGE III  
FOR SN 037-0103**

SCALE: \_\_\_\_\_ SHEET \_\_\_\_\_ OF \_\_\_\_\_ SHEETS STA. \_\_\_\_\_ TO STA. \_\_\_\_\_

F.A.I. RTE.	SECTION	COUNTY	TOTAL SHEETS	SHEET NO.
74	(37-2HB-1)BP	HENRY	24	16
				CONTRACT NO. 64N08
		ILLINOIS FED. AID PROJECT		



# TRAFFIC CONTROL PLAN – STAGE III FOR SN 037-0103

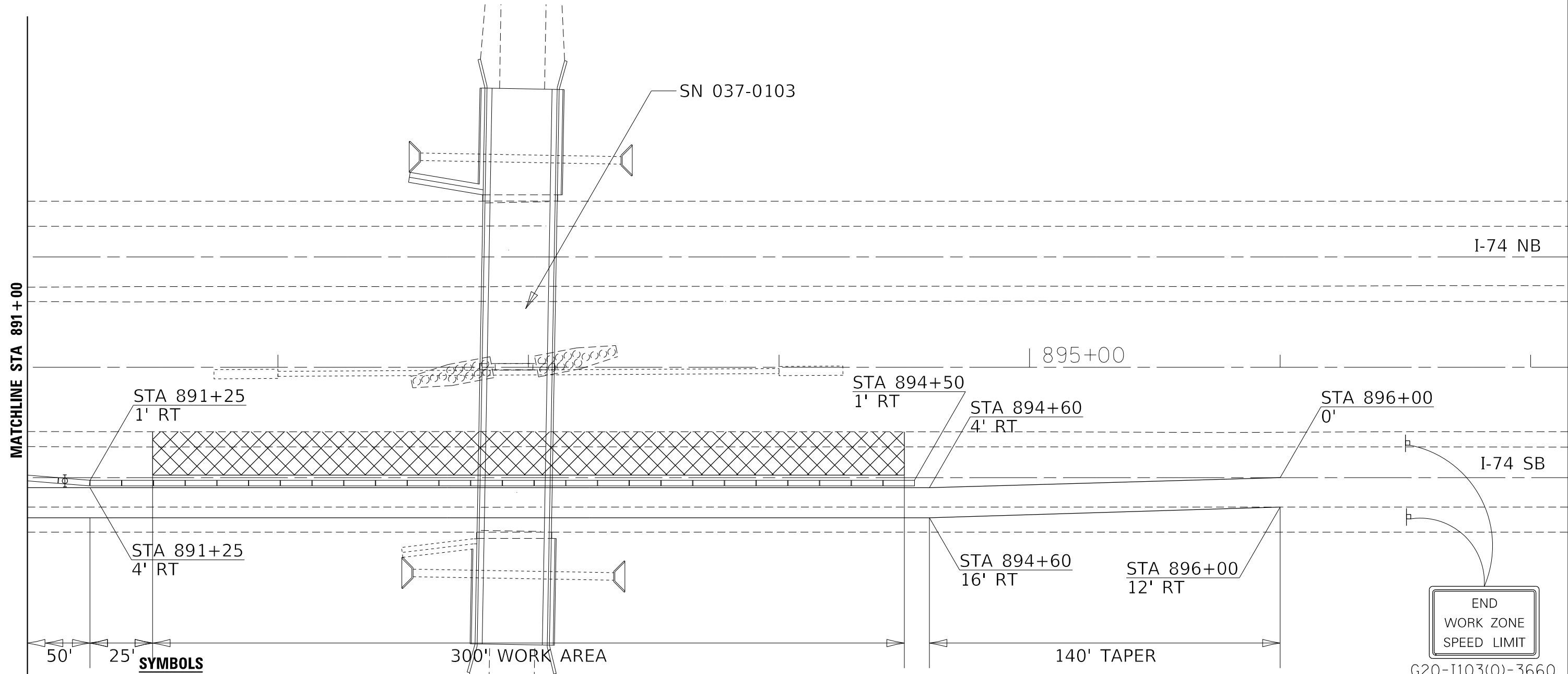
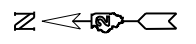

- SYMBOLS**
- Arrow board
  - Work area
  - Sign
  - Direction indicator barricade with steady burn monodirectional light
  - Type II barricade or drum with steady burn monodirectional light
  - Temporary concrete barrier
  - Monodirectional barrier wall/guardrail marker
  - Impact attenuator
  - Drums with steady burning monodirectional light

- NOTES**
- ① Reflectorized temporary pavement marking shall be placed throughout the taper and along-side the work area. The edge line shall be white for right lane closure and yellow for left lane closures.
  - ② Vertical panels at 7.6 m (25') centers with steady burning monodirectional lights.

MODEL: Default  
 FILE: \\nas0101\BIBED\BIBED\ITC\Illinois\pov\RW\DOT\Documents\1801\Office\1801\1801\037-0103\037-0103-037-0103-CADD\02-traffic-control.dgn

USER NAME = drossdd	DESIGNED - _____	REVISED - _____
	DRAWN - _____	REVISED - _____
PLOT SCALE = 40,0000 ' / in.	CHECKED - _____	REVISED - _____
PLOT DATE = Oct-01-2018 03:07:58 PM	DATE - _____	REVISED - _____

**STATE OF ILLINOIS  
DEPARTMENT OF TRANSPORTATION**

<b>TTRAFFIC CONTROL PLAN – STAGE III FOR SN 037-0103</b>			
SCALE: _____	SHEET _____	OF _____ SHEETS	STA. _____ TO STA. _____

F.A.I. RTE.	SECTION	COUNTY	TOTAL SHEETS	SHEET NO.
74	(37-2HB-1)BP	HENRY	24	17
CONTRACT NO. 64N08				
ILLINOIS FED. AID PROJECT				

# TRAFFIC CONTROL PLAN – STAGE IV FOR SN 037–0103



I-74 NB

875+00

I-74 SB

MATCHLINE STA 879+00

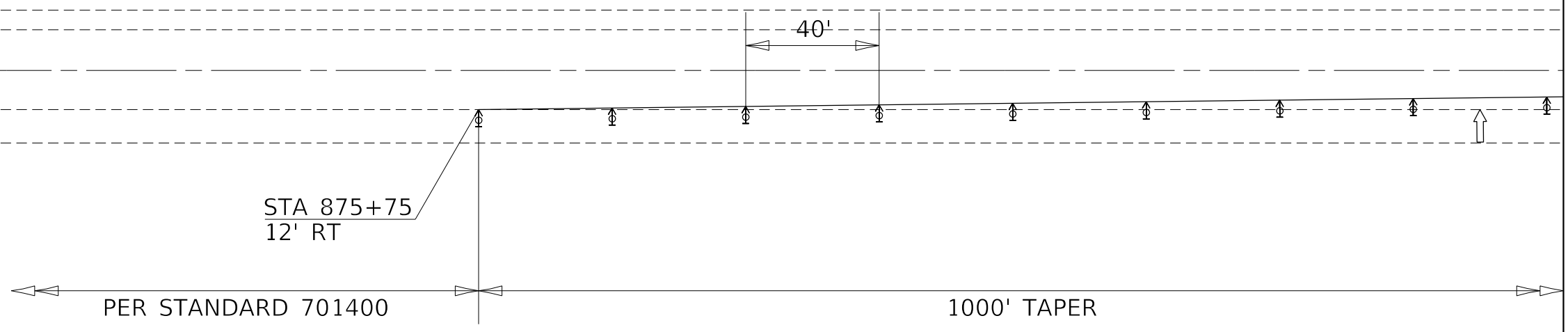

**SYMBOLS**

- Arrow board
- Work area
- Sign
- Direction indicator barricade with steady burn monodirectional light
- Type II barricade or drum with steady burn monodirectional light
- Temporary concrete barrier
- Monodirectional barrier wall/guardrail marker
- Impact attenuator
- Drums with steady burning monodirectional light

**NOTES**

- ① Reflectorized temporary pavement marking shall be placed throughout the taper and along-side the work area. The edge line shall be white for right lane closure and yellow for left lane closures.
- ② Vertical panels at 7.6 m (25') centers with steady burning monodirectional lights.

MODEL: Default  
FILE: \\nas011\BIBED\DOT\Illinois\proj\HWYDOT\Documents\18DOT\_Offices\Director\2\Projects\Operations\Bldg - Section\Henry\037-0103\64N08\CADD\02-traffic\stage4.dgn

USER NAME = drossdd	DESIGNED - _____	REVISED - _____
	DRAWN - _____	REVISED - _____
PLOT SCALE = 40,0000 ' / in.	CHECKED - _____	REVISED - _____
PLOT DATE = Oct-01-2018 03:08:06 PM	DATE - _____	REVISED - _____

**STATE OF ILLINOIS  
DEPARTMENT OF TRANSPORTATION**

**TTRAFFIC CONTROL PLAN – STAGE IV  
FOR SN 037–0103**

SCALE: \_\_\_\_\_ SHEET \_\_\_\_ OF \_\_\_\_ SHEETS STA. \_\_\_\_\_ TO STA. \_\_\_\_\_

F.A.I. RTE.	SECTION	COUNTY	TOTAL SHEETS	SHEET NO.
74	(37-2HB-1)BP	HENRY	24	18
CONTRACT NO. 64N08				
ILLINOIS FED. AID PROJECT				

# TRAFFIC CONTROL PLAN – STAGE IV FOR SN 037–0103

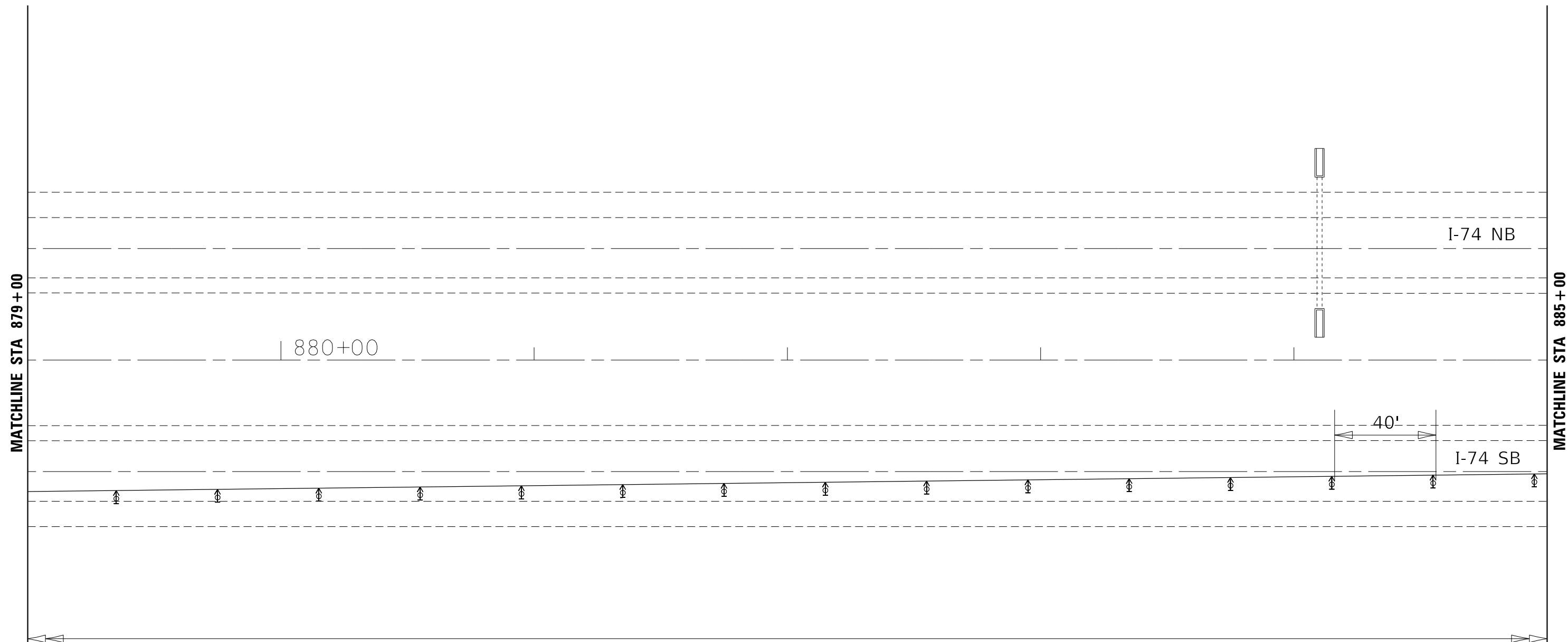

**SYMBOLS**

- Arrow board
- Work area
- Sign
- Direction indicator barricade with steady burn monodirectional light
- Type II barricade or drum with steady burn monodirectional light
- Temporary concrete barrier
- Monodirectional barrier wall/guardrail marker
- Impact attenuator
- Drums with steady burning monodirectional light

**NOTES**

- ① Reflectorized temporary pavement marking shall be placed throughout the taper and along-side the work area. The edge line shall be white for right lane closure and yellow for left lane closures.
- ② Vertical panels at 7.6 m (25') centers with steady burning monodirectional lights.

MODEL: Default  
 FILE: Mainfile\_PlanView\BIBED\BIBED\ITC\Illinois\gpo\p\W\DOT\Documents\1\DOT\_Offices\District 2\Projects\Operations\B4\figs\_Section\Henry037-0103\64N08\CADD\02-plt-cover.dgn

USER NAME = dossed DESIGNED - _____ DRAWN - _____ PLOT SCALE = 40,0000 "/>				DESIGNED - _____ REVISED - _____ CHECKED - _____ DATE - _____ REVISED - _____				<b>STATE OF ILLINOIS DEPARTMENT OF TRANSPORTATION</b>				<b>TTRAFFIC CONTROL PLAN – STAGE IV FOR SN 037–0103</b>				F.A.I. RTE. 74 SECTION (37-2HB-1)BP COUNTY HENRY TOTAL SHEETS 24 SHEET NO. 19		CONTRACT NO. 64N08 ILLINOIS FED. AID PROJECT	
PLOT DATE = Oct-01-2018 03:08:13 PM				DATE - _____				SCALE: _____				SHEET ___ OF ___ SHEETS STA. _____ TO STA. _____							

# TRAFFIC CONTROL PLAN – STAGE IV FOR SN 037-0103

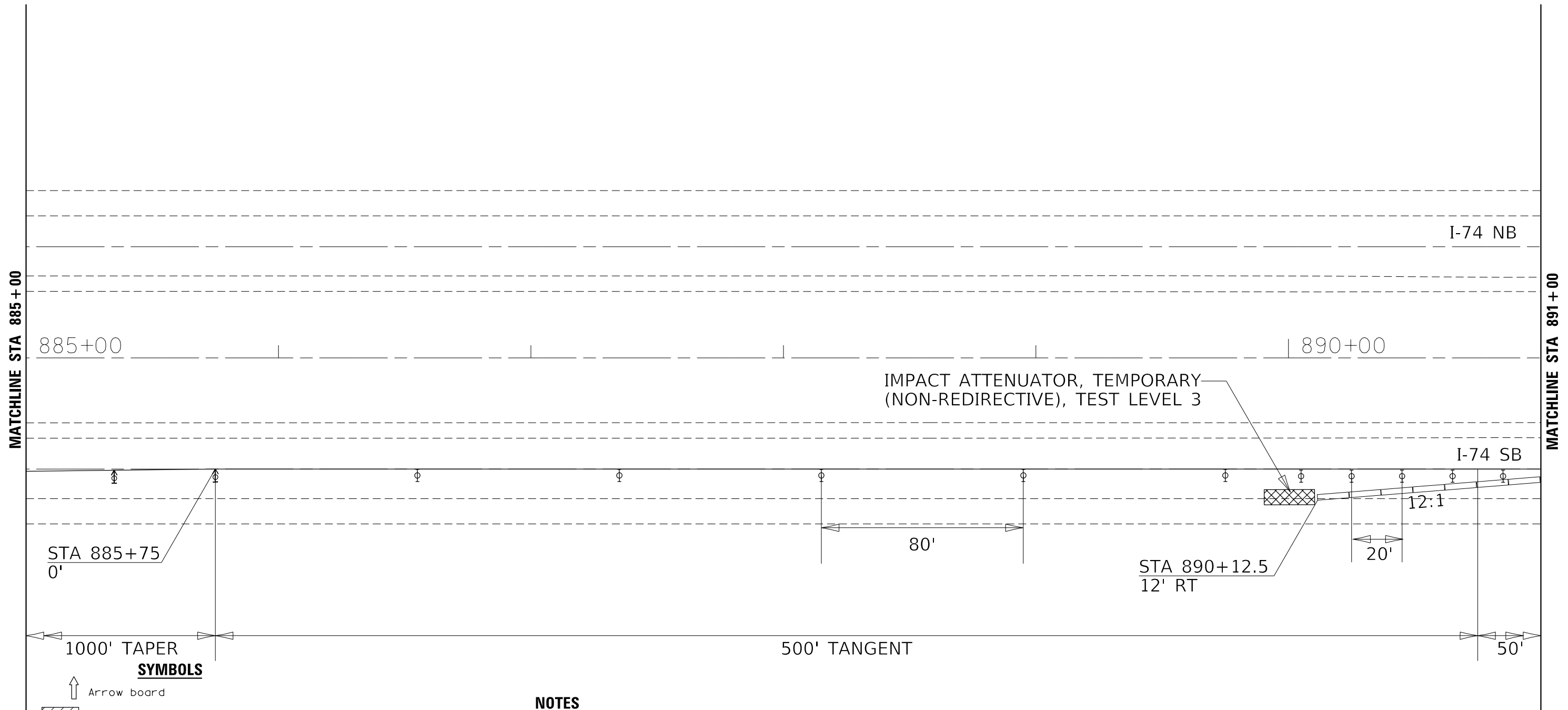

**SYMBOLS**

- Arrow board
- Work area
- Sign
- Direction indicator barricade with steady burn monodirectional light
- Type II barricade or drum with steady burn monodirectional light
- Temporary concrete barrier
- Monodirectional barrier wall/guardrail marker
- Impact attenuator
- Drums with steady burning monodirectional light

**NOTES**

- ① Reflectorized temporary pavement marking shall be placed throughout the taper and along-side the work area. The edge line shall be white for right lane closure and yellow for left lane closures.
- ② Vertical panels at 7.6 m (25') centers with steady burning monodirectional lights.

MODEL: Default  
FILE: \\nas01c:\proj\1108\BID\BID\TEC\Illinois\proj\WID\DOT\Documents\1108\DOT\Office\1108\1108\CADD\02-1108-01-037-0103\1108\CADD\02-1108-01-037-0103.dgn

USER NAME = dssdd	DESIGNED - _____	REVISED - _____
	DRAWN - _____	REVISED - _____
PLOT SCALE = 40,0000' / in.	CHECKED - _____	REVISED - _____
PLOT DATE = Oct-01-2018 03:08:26 PM	DATE - _____	REVISED - _____

**STATE OF ILLINOIS  
DEPARTMENT OF TRANSPORTATION**

**TTRAFFIC CONTROL PLAN – STAGE IV  
FOR SN 037-0103**

SCALE: \_\_\_\_\_ SHEET \_\_\_\_\_ OF \_\_\_\_\_ SHEETS STA. \_\_\_\_\_ TO STA. \_\_\_\_\_

F.A.I. RTE.	SECTION	COUNTY	TOTAL SHEETS	SHEET NO.
74	(37-2HB-1)BP	HENRY	24	20
CONTRACT NO. 64N08				
ILLINOIS FED. AID PROJECT				

# TRAFFIC CONTROL PLAN – STAGE IV FOR SN 037-0103

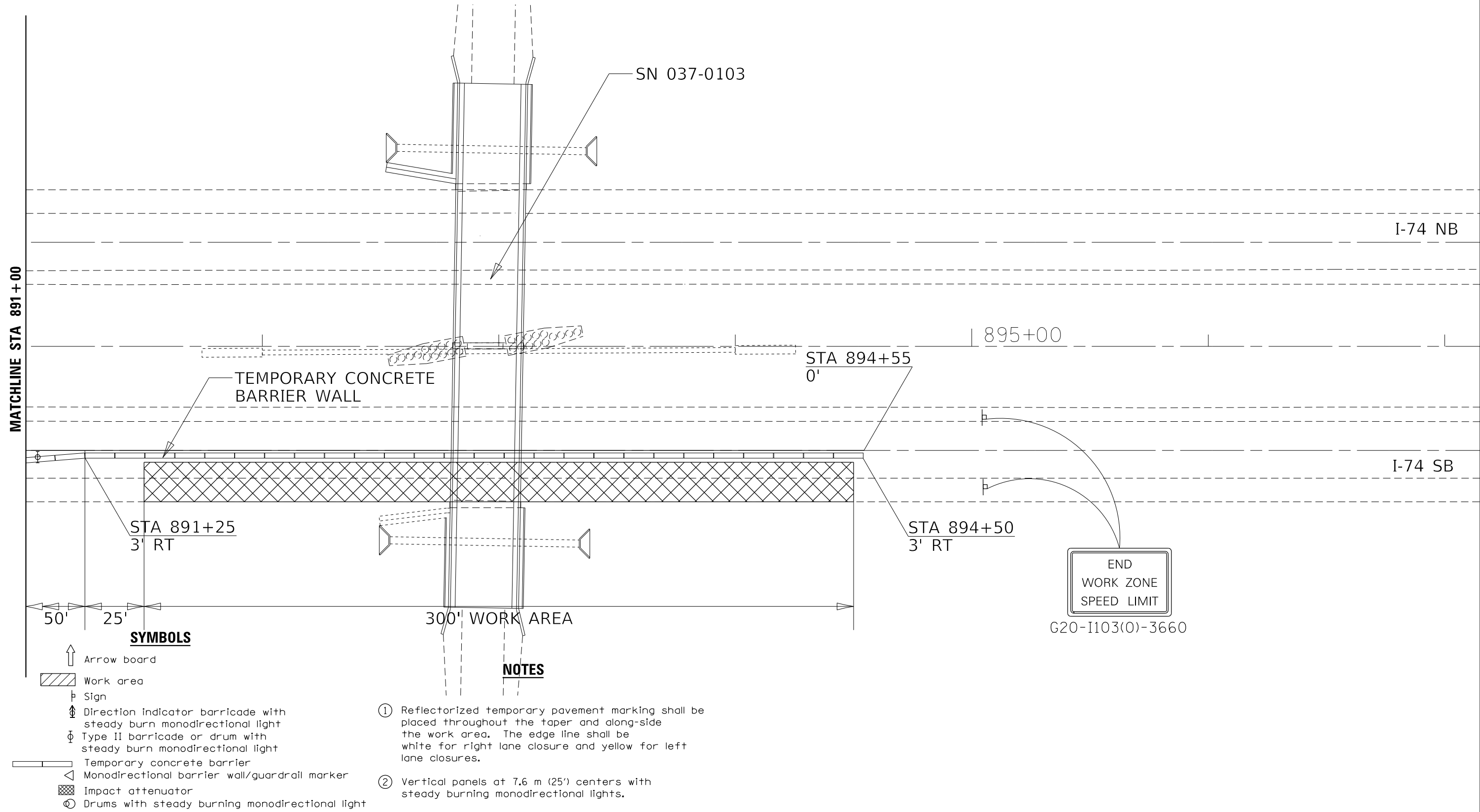

MATCHLINE STA 891 + 00

SN 037-0103

I-74 NB

895+00

STA 894+55  
0'

TEMPORARY CONCRETE  
BARRIER WALL

I-74 SB

STA 891+25  
3' RT

STA 894+50  
3' RT

END  
WORK ZONE  
SPEED LIMIT

G20-I103(0)-3660

300' WORK AREA

50' 25'

**SYMBOLS**

- ↑ Arrow board
- ▨ Work area
- ⊥ Sign
- ⊕ Direction indicator barricade with steady burn monodirectional light
- ⊖ Type II barricade or drum with steady burn monodirectional light
- ▭ Temporary concrete barrier
- ◁ Monodirectional barrier wall/guardrail marker
- ⊗ Impact attenuator
- ⊙ Drums with steady burning monodirectional light

**NOTES**

- ① Reflectorized temporary pavement marking shall be placed throughout the taper and along-side the work area. The edge line shall be white for right lane closure and yellow for left lane closures.
- ② Vertical panels at 7.6 m (25') centers with steady burning monodirectional lights.

MODEL: Default  
FILE: \\nas01\proj\1108\BID\ITEC\Illinois\proj\1108\BID\Documents\BID\ITEC\_Section\Henry037-0103\64N08\CADD\02-htc-coner.dgn

USER NAME = drossdd	DESIGNED - _____	REVISED - _____
	DRAWN - _____	REVISED - _____
PLOT SCALE = 40,0000 ' / in.	CHECKED - _____	REVISED - _____
PLOT DATE = Oct-01-2018 03:08:43 PM	DATE - _____	REVISED - _____

STATE OF ILLINOIS  
DEPARTMENT OF TRANSPORTATION

<b>TTRAFFIC CONTROL PLAN – STAGE IV FOR SN 037-0103</b>			
SCALE: _____	SHEET _____	OF _____ SHEETS	STA. _____ TO STA. _____

F.A.I. RTE.	SECTION	COUNTY	TOTAL SHEETS	SHEET NO.
74	(37-2HB-1)BP	HENRY	24	21
CONTRACT NO. 64N08				
ILLINOIS		FED. AID PROJECT		

B.M. #9 Bolt spike E. side 2nd power pole, 200' ± R. of Sta. 730+10, El. 740.11

STATE OF ILLINOIS  
DEPARTMENT OF PUBLIC WORKS & BUILDINGS  
DIVISION OF HIGHWAYS

ROUTE NO.	SECTION	COUNTY	TOTAL SHEETS	SHEET NO.
1-74	37-2HB-1	HENRY	26	6
FED. ROAD DIST. NO. 1		ILLINOIS	FED. AID PROJECT: I-74-2(47)16	11 SHEETS

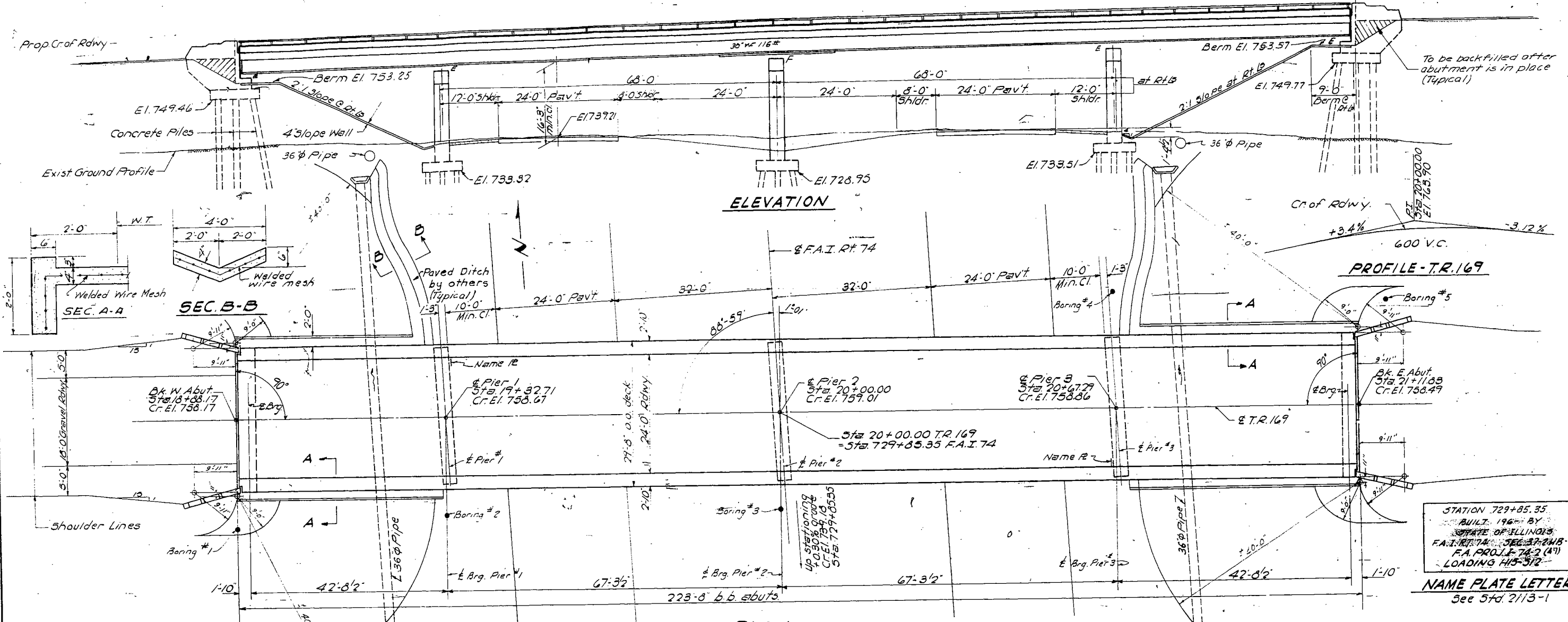

ELEVATION

PLAN

STATION 729+85.35  
BUILT 1964 BY  
STATE OF ILLINOIS  
F.A.I. RT. 74, SEC. 37-2HB-1  
F.A. PROFILE 74-2 (47)  
LOADING H15-S12  
NAME PLATE LETTERING  
See Std. 2113-1

GENERAL NOTES

Class X concrete shall be used throughout. The concrete floor slab shall be finished in accordance with Article 51.19 of the Standard Specifications. Slope wall shall be reinforced with welded wire fabric 6 x 6 mesh, #4 wires, weighing 56# per 100 sq. ft. Rivets 3/8", Open holes 1 1/2", unless noted. Coarse aggregate to be used in parapet handrails and wing wall must be free of chert, flint, limonite, lignite and soft sandstone. All bolts, nuts, washers, bearing plates, lead plates, pintles and anchor bolts shall be fabricated and set in accordance with Article 51.15 of the Standard Specifications and are included in quantity of Structural Steel. Anchor bolts shall be set before riveting diaphragms over supports.

The following surfaces of expansion guards shall be given two shop coats of red lead paint: 4 x 4 x 1/2" except backs of vertical and horizontal legs and 3/4" studs. Expansion guards are included in quantity of Structural Steel. Est. wt.: 690#.

Except as otherwise provided, all Structural Steel shall receive one shop coat of red lead paint and two field coats of aluminum paint. See Articles 56.1 to 56.5 of the Standard Specifications. All paint shall be furnished and applied by the Contractor.

The Contractor shall drive one concrete test pile in a permanent location, at W. abut. and one timber test pile in the vicinity of pier 2, as directed by the Engineer before ordering remainder of piles. All timber piles shall be creosoted. Holes shall be precored to natural ground for piles driven in embankment in accordance with Article 60.9 (c) of the Standard Specifications. All Structural Steel shall conform to the ASTM Specifications A-36.

TOTAL BILL OF MATERIAL

ITEM	SUPERSTR	SUBSTR	TOTAL
* Class A Excavation for Structures (Cu Yds)		191	191
Class X Concrete (Cu Yds)	187.0	207.0	388.0
Structural Steel (Lbs)	157,390		157,390
Aluminum Handrail (Lin. Ft)	444		444
Reinforcement Bars (Lbs)	35,080	15,790	51,000
Creosoted Piles (Lin. Ft)		900	900
Test Piles (Timber) (Ea)		1	1
Concrete Piles (Lin. Ft)		735	735
Test Piles (Concrete) (Ea)		1	1
Name Plates (Ea)		2	2
* 5/16" Open Wall (Sq. Yds)		367	367
Protective Coat (Sq. Yds)	867		867

\* Includes excavation for slope wall.  
GENERAL PLAN & ELEVATION  
T.R. 169 OVER F.A.I. RT. 74  
PROJ. I-74-2 (47) 16  
F.A.I. RT. 74, SEC. 37-2HB-1  
HENRY COUNTY  
STA. 729+85.35 (F.A.I. RT. 74)

FOR INFORMATION ONLY

DESIGN STRESSES  
fc = 1400 psi. Super.  
vc = 75 psi. Footings  
fs = 20,000 psi. Reinf.  
fs = 18,000 psi. Struct.  
n = 10  
LOADING H15-S12-44

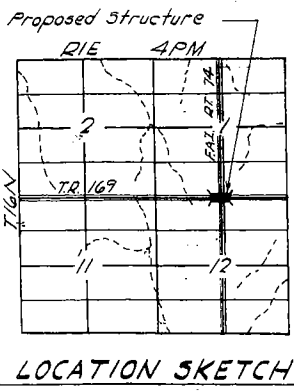

LOCATION SKETCH

DESIGNED	<i>E. J. S. Sandoval</i>	EXAMINED	<i>A. E. Baumann</i>
CHECKED	<i>T. Tamba</i>	PASSED	<i>[Signature]</i>
DRAWN	<i>of S. Sandoval</i>	APPROVED	<i>[Signature]</i>
CHECKED	<i>T. Tamba</i>		

JULY 14 1964  
CHIEF HIGHWAY ENGINEER

Revised 10/6/64: Changed Class X Conc. Cu Yds. 300.0 to 388.0, Borrows Excav. Cu Yds. 170.0 to 191.0, Reinf. Bars Lbs. 46,100 to 51,080 & Metal Handrail to Alum. Handrail. 2-24-64 Deleted Borrow Excav. Quantities from this sheet, see sheet 4 of 26

STATE OF ILLINOIS  
DEPARTMENT OF PUBLIC WORKS & BUILDINGS  
DIVISION OF HIGHWAYS

ROUTE NO.	SECTION	COUNTY	TOTAL SHEETS	SHEET NO.
74	37-LRB-1	HENRY	26	14
FED. ROAD DIST. NO.	ILLINOIS	FED. AID PROJECT		

SHEET NO. 3  
11 SHEETS

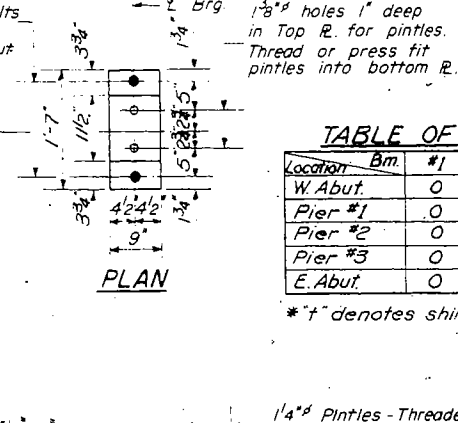
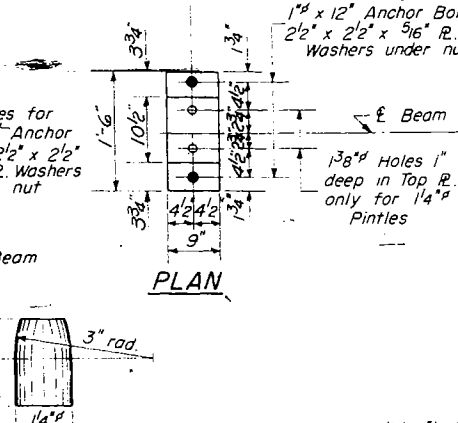
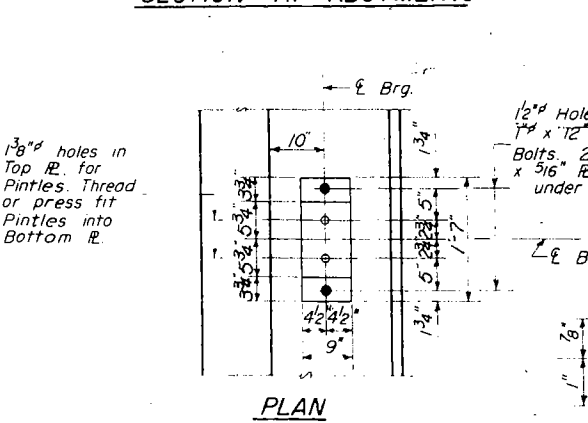
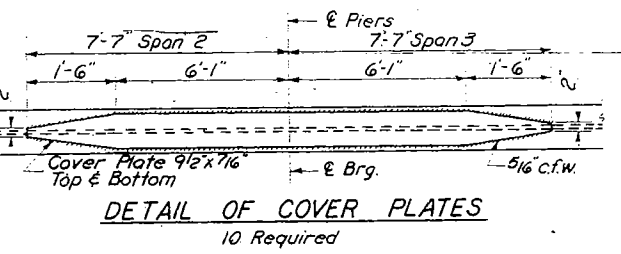
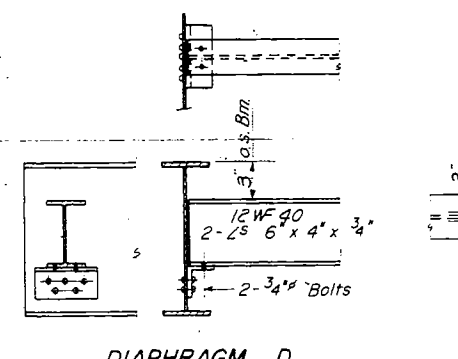
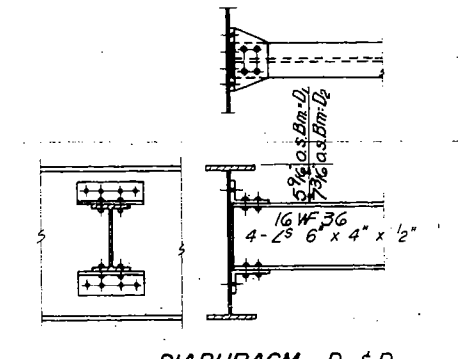
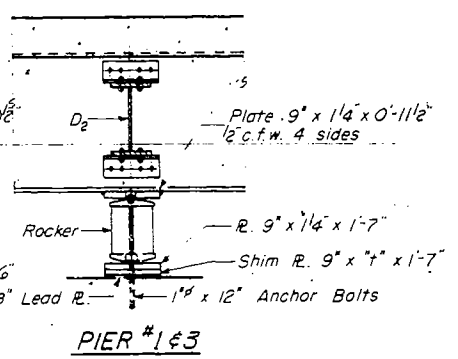
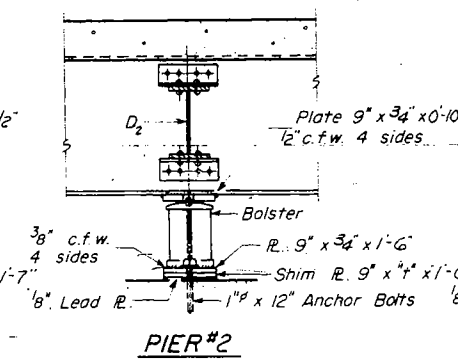
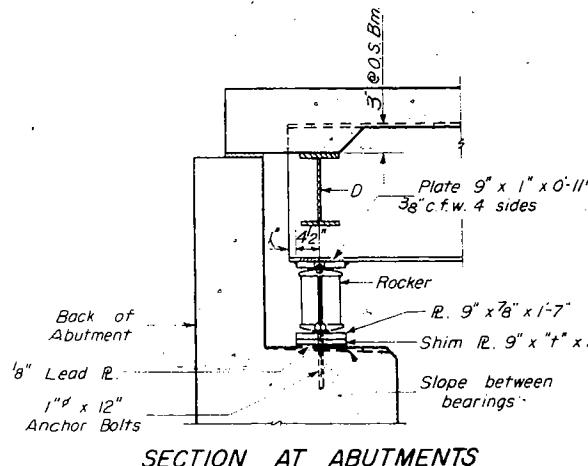
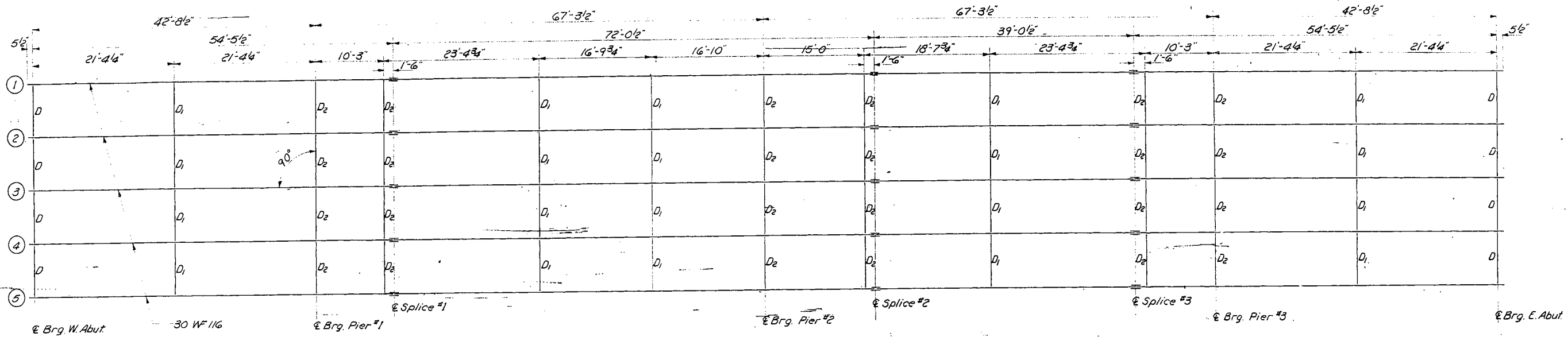

TABLE OF "t" DIMENSIONS

Location	Bm.	#1	#2	#3	#4	#5
W. Abut.	0	0	3/8"	0	0	0
Pier #1	0	0	3/8"	0	0	0
Pier #2	0	0	3/8"	0	0	0
Pier #3	0	0	3/8"	0	0	0
E. Abut.	0	0	3/8"	0	0	0

\*"t" denotes shim plate thickness

DIAPHRAGM D1 & D2  
D1 Required = 20  
D2 Required = 24  
Note: Diaphragms D1 & D2 are identical except for high & low connections to 30" WF 116"

DIAPHRAGM D  
8 Required

ELEVATIONS @ TOP OF BEAMS

Location	Beam	1 or 5	2 or 4	3
W. Abut.	75754	75763	75766	
Splice #1	75807	75815	75818	
Splice #2	75832	75841	75844	
Splice #3	75822	75831	75834	
E. Abut.	75785	75794	75797	

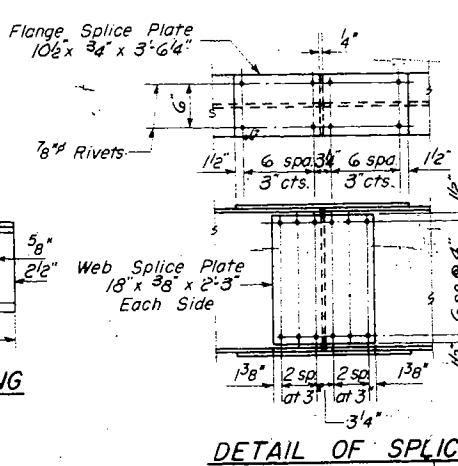
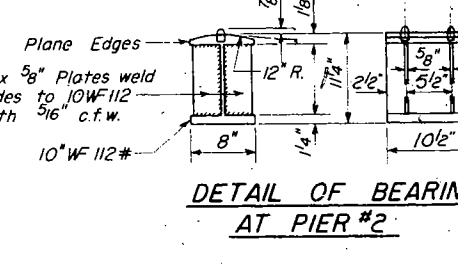
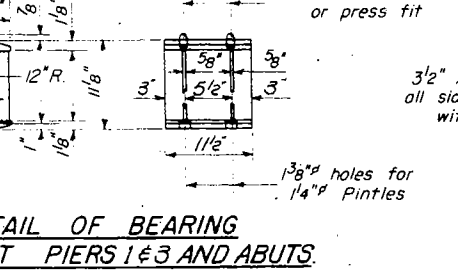
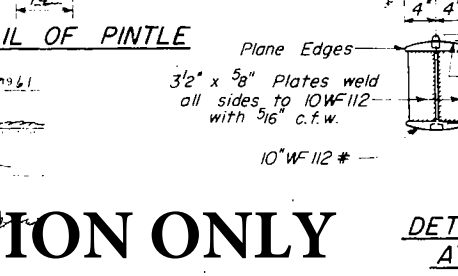
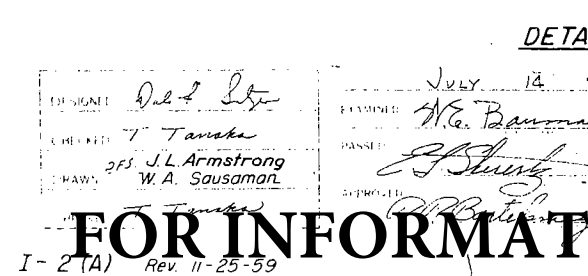

FOR INFORMATION ONLY

DETAIL OF BEARING AT PIERS 1 & 3 AND ABUTS

DETAIL OF BEARING AT PIER #2

DETAIL OF SPLICE

STRUCTURAL STEEL  
I.R. 169 OVER FAI. RT. 74  
FAI. RT. 74 SEC. 37-2HB-1  
HENRY COUNTY  
STA. 729+85.35

DESIGNED: J.L. Armstrong  
CHECKED: W.A. Sausman  
APPROVED: W.A. Sausman  
DATE: JULY 14, 1961

STATE OF ILLINOIS  
DEPARTMENT OF PUBLIC WORKS & BUILDINGS  
DIVISION OF HIGHWAYS

DESIGNED BY HENRY 26 16 SHEET NO 2  
// SHEETS

223' 8" Bk to Bk of Abuts.

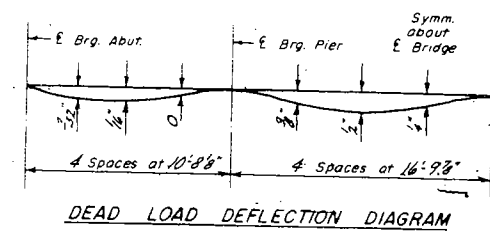
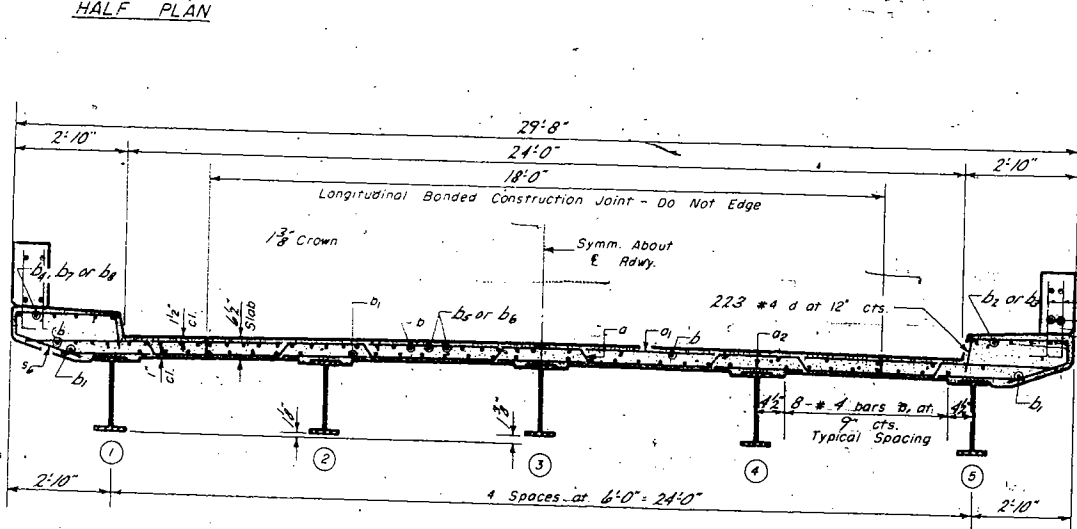
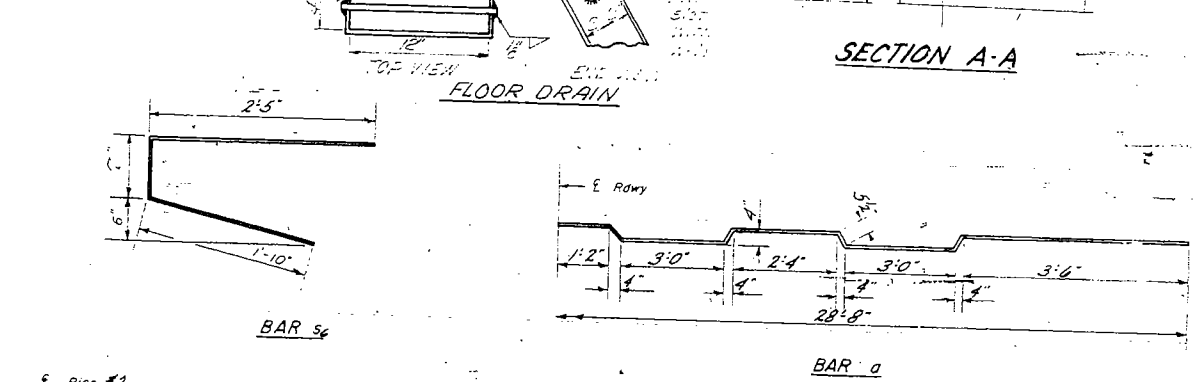
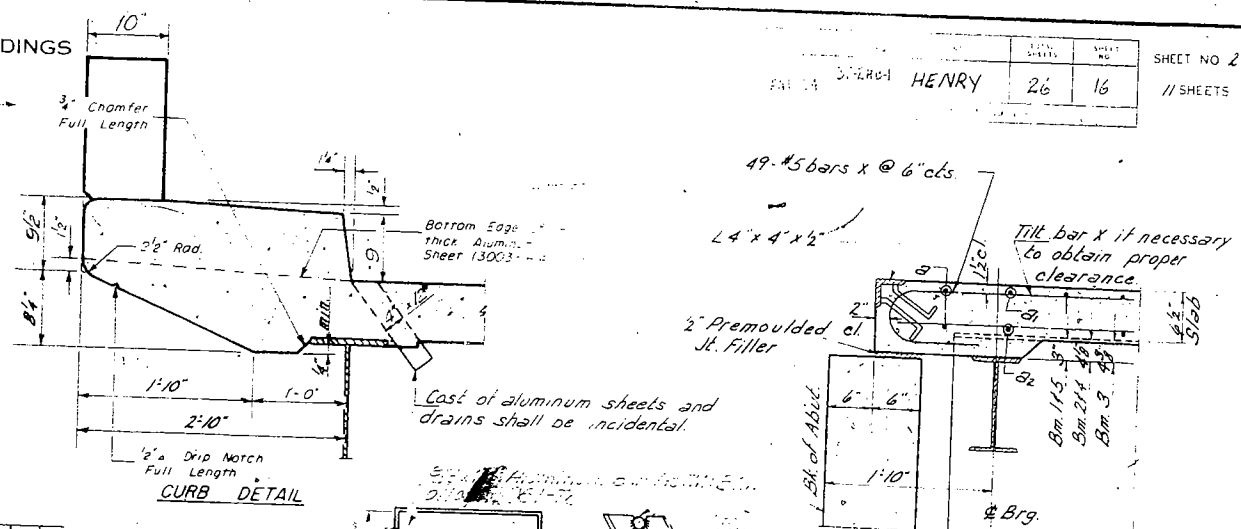
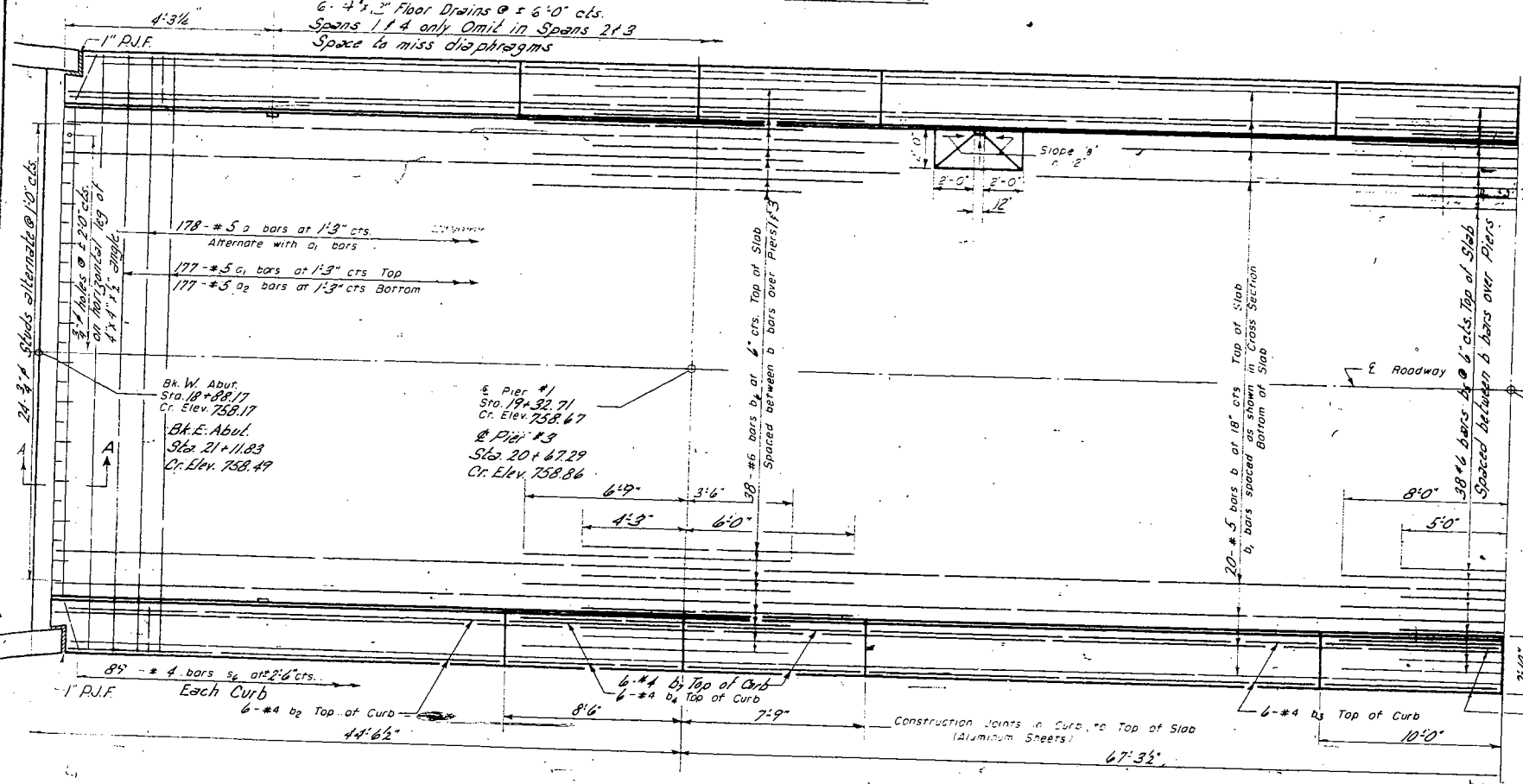
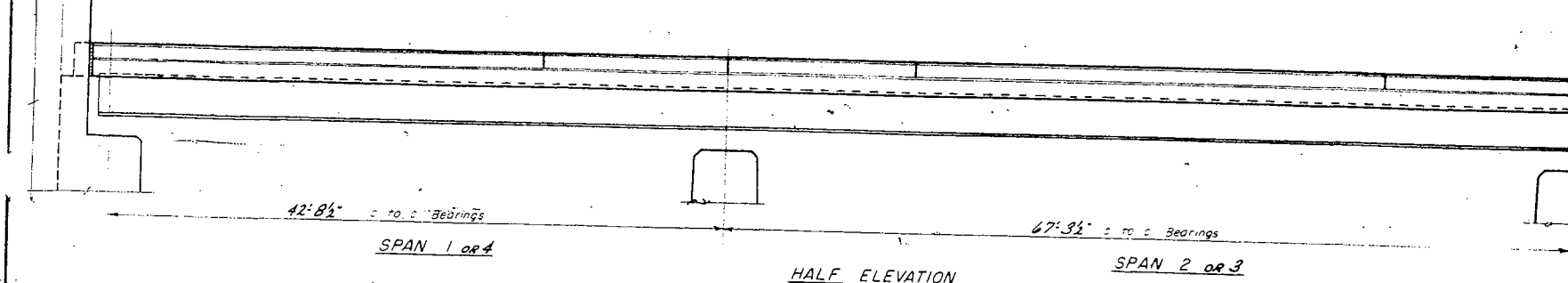

BILL OF MATERIAL

Bar	No.	Size	Length	Shape
x	98	#5	4' 7"	C
a	178	#5	29' 8"	~
a <sub>1</sub>	177	#5	28' 6"	~
a <sub>2</sub>	177	#5	26' 0"	~
b	200	#5	29' 3"	~
b <sub>1</sub>	340	#4	23' 0"	~
b <sub>2</sub>	48	#4	18' 0"	~
b <sub>3</sub>	48	#4	25' 3"	~
b <sub>4</sub>	24	#4	8' 3"	~
b <sub>5</sub>	38	#4	13' 0"	~
b <sub>6</sub>	76	#4	10' 3"	~
b <sub>7</sub>	24	#4	2' 6"	~
b <sub>8</sub>	24	#4	9' 9"	~
s <sub>1</sub>	178	#4	4' 10"	~
d	444	#4	7' 1"	~

\*\* Class X Concrete Cu. Yds. 162.0  
\* Structural Steel Lbs. 157,390  
\*\* Reinforcement Bars Lbs. 35,000  
\* Weight of bolsters, Rockers, Bearing Plates, Lead Plates and Anchor Bolts included as Structural Steel. Est. Weight = 5,970 #  
\*\* Includes Quantities of Class X Concrete and Reinforcement Bars as shown on the Concrete Detail of Street #4.

METHOD OF DETERMINING FILLET HEIGHT "t"  
After all Structural Steel has been erected, elevations of the top flanges of the beams shall be taken at intervals shown on sheet. These elevations subtracted from the "Grade Elevations adjusted for D.L. Deflections" shown on sheet = t minus floor thickness equals the fillet heights above top of beams.

DESIGNED *Dub. J. Lutz*  
CHECKED *T. Tanaka*  
DRAWN *D. S. Plawler*  
W. A. Solvason  
EXAMINED *W. G. Baumann*  
PASSED *E. J. Stevens*  
APPROVED *D. P. Bartelme*  
JULY 14 1961

FOR INFORMATION ONLY

SUPERSTRUCTURE  
T.R. 169 OVER F.A.I. RT. 74  
F.A.I. RT. 74 SEC. 37-2HS-1  
HENRY COUNTY  
STA. 729+85.35