

SN 041-0087/0088
1994 JOINT REPAIR

INDEX OF SHEETS

SHEET NO.	ITEM
1	TITLE SHEET, INDEX OF SHEETS
2	GENERAL NOTES, SUMMARY OF QUANTITIES, PLAN VIEW
3	STAGE CONSTRUCTION DETAIL
4	TRAFFIC CONTROL DETAIL
5-6	JOINT DETAIL
7	ABUTMENT, WING AND PARAPET REPAIR DETAIL
8	PREFORMED JOINT SEAL DETAIL

THE FOLLOWING STANDARDS ARE A PART OF THESE PLANS AND ARE INCLUDED AFTER SHEET NO. 8:

1686-4	STANDARD SYMBOLS AND ABBREVIATIONS
2298-10	TYPICAL APPLICATION OF TRAFFIC CONTROL DEVICE
2299-14	DESIGN OF TRAFFIC CONTROL DEVICES
2300-4	TYPICAL APPLICATION OF TRAFFIC CONTROL DEVICE
2316-14	TYPICAL APPLICATION OF TRAFFIC CONTROL DEVICE
2383-4	TEMPORARY CONCRETE BARRIER

STATE OF ILLINOIS
DEPARTMENT OF TRANSPORTATION
DIVISION OF HIGHWAY
**PLANS FOR PROPOSED
FEDERAL AID HIGHWAY**

FAI ROUTE 64
SECTION JOINT REPAIR 1994-1
JEFFERSON COUNTY

C-97-046-93

FAI NO.	SECTION	COUNTY	W.B.L.	E.B.L.
64	JOINT REPAIR 1994-1	JEFFERSON	B	1

SL T-97-001-93

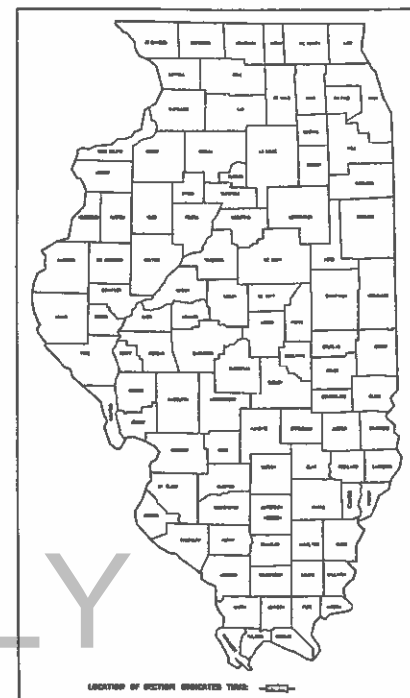

FOR INFORMATION ONLY

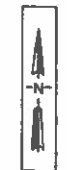
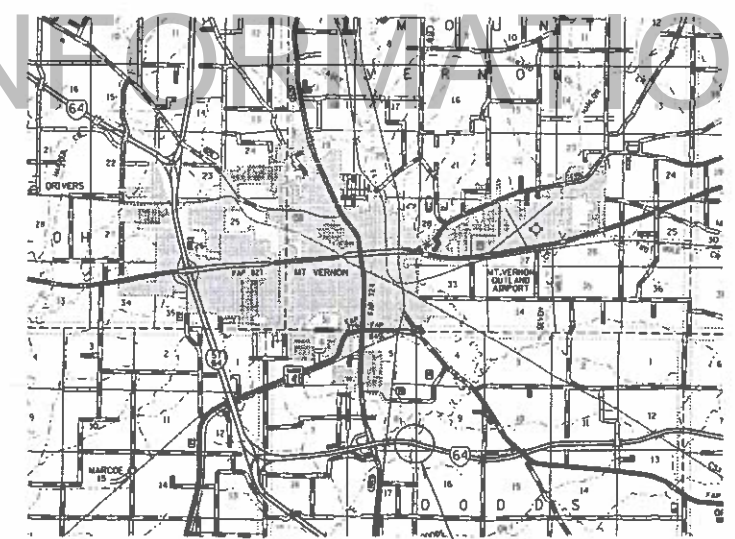

SECTION JOINT REPAIR 1994-1
STA 2765+00 (S.N. 041-0087) W.B.L.
(S.N. 041-0088) E.B.L.

GROSS LENGTH OF PROJECT= 217.5 LIN. FT. = 0.040 MILES
NET LENGTH OF PROJECT= 217.5 LIN. FT. = 0.040 MILES

SUBMITTED Nov 2 1994
M. G. Jagan
EXAMINED _____
PASSED December 16 1994 Handel
APPROVED December 16 1994 James P. Stipan

PROJECT ENGINEER: L. WEBER
SQUAD LEADER: J. ROBINSON
TELEPHONE: 217-542-3951 EX 314

JUL.I.E. 1-800-892-0123
TOWNSHIP: DODDS CREEK

CONTRACT NO. 94345

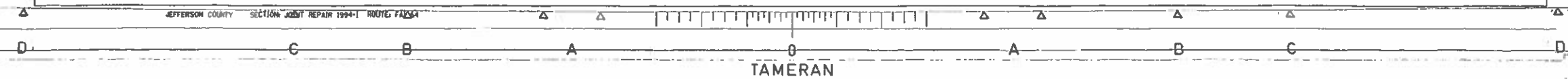

FBI NO.	SECTION	COUNTY	SP. DIST.	POST NO.
54	JOINT REPAIR 1994-1	JEFFERSON	8	2
JOB NO. AND DATE		DATE	JOB NO. AND DATE	

SUMMARY OF QUANTITIES				
CODE NO	ITEM	UNIT	QUANTITIES	SFTY-2A
* T5020200	PAINT PAVEMENT MARKING - LINE 4"	FOOT	3550	3550
35400300	PORTLAND CEMENT CONCRETE BASE COURSE WIDENING 8"	SO YD	1006	1006
42001675	REINFORCEMENT BARS, EPOXY COATED	POUND	3702	3702
44001430	BITUMINOUS SHOULDER REMOVAL	SO YD	1006	1006
50102400	CONCRETE REMOVAL	CU YD	23.5	23.5
50300130	PREFORMED JOINT SEAL 4"	FOOT	180	180
50300255	CONCRETE SUPER STRUCTURES	CU YD	23.5	23.5
50301245	FORMED CONCRETE REPAIR (DEPTH EQUAL TO OR LESS THAN 5")	SO FT	5.6	5.6
50301250	FORMED CONCRETE REPAIR (DEPTH GREATER THAN 5")	SO FT	2.8	2.8
50500405	FURNISHING AND ERECTING STRUCTURAL STEEL	POUND	6637	6637
58500100	EPOXY MORTAR REPAIR	CU FT	2	2
59000100	EPOXY CRACK SEALING	FOOT	13	13
90101005	TRAFFIC CONTROL AND PROTECTION, STANDARD 231G (SPECIAL)	EACH	2	2
90300090	TEMPORARY PAVEMENT MARKING	FOOT	3550	3550
90400500	INSTALL TEMPORARY CONCRETE BARRIER	FOOT	780	780
90400200	RELOCATE TEMPORARY CONCRETE BARRIER	FOOT	794	794
90401100	TEMPORARY CONCRETE BARRIER TERMINAL SECTION (CONTRACTOR FURNISHED)	EACH	2	2

* SPECIALTY ITEM

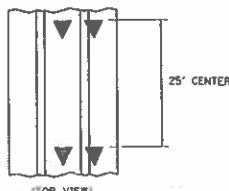

▼ MONODIRECTIONAL

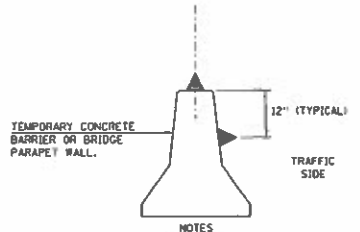

- ALL REFLECTORS ARE TO BE WHITE IN COLOR AND MEET THE SPECIFICATIONS OF ARTICLE T 609.01 OF THE STANDARD SPECIFICATIONS FOR TRAFFIC CONTROL ITEMS.
- ALL REFLECTORS ARE TO BE INSTALLED IN ACCORDANCE WITH SECTION 7 500 OF THE STANDARD SPECIFICATIONS FOR TRAFFIC CONTROL ITEMS.

PRISMATIC BARRIER REFLECTOR DETAIL

GENERAL NOTES

THIS SECTION SHALL BE CONSTRUCTED IN ACCORDANCE WITH THE PLANS, "THE STANDARD SPECIFICATIONS FOR ROAD AND BRIDGE CONSTRUCTION", ADOPTED JULY 1, 1984; "THE STANDARD SPECIFICATIONS FOR TRAFFIC CONTROL ITEMS", ADOPTED NOVEMBER 1, 1994; "THE SUPPLEMENTAL SPECIFICATIONS AND THE RECURRING SPECIAL PROVISIONS" ADOPTED JULY 1, 1994 AND THE SPECIAL PROVISIONS INCLUDED IN THE PROPOSAL.

THE WORK INCLUDED IN THIS SECTION IS LOCATED 0.6 MILES EAST OF THE INTERSTATE 64 AND ROUTE 37 INTERCHANGE, ON THE CASEY FORK OVERFLOW STRUCTURES (SN 041-0087 & SN 041-0088). THE WORK CONSIST OF REMOVAL AND REPLACEMENT OF THE EXISTING EXPANSION JOINTS, FORMED CONCRETE REPAIR, EPOXY CRACK SEALING AND OTHER WORK NECESSARY TO COMPLETE THIS SECTION.

PLAN DIMENSIONS AND DETAILS RELATIVE TO EXISTING STRUCTURES HAVE BEEN TAKEN FROM EXISTING PLANS AND ARE SUBJECT TO NOMINAL CONSTRUCTION VARIATIONS. IT SHALL BE THE CONTRACTOR'S RESPONSIBILITY TO VERIFY SUCH DIMENSIONS AND DETAILS IN THE FIELD AND MAKE NECESSARY APPROVED ADJUSTMENTS PRIOR TO CONSTRUCTION OR ORDERING OF MATERIAL. SUCH VARIATIONS SHALL NOT BE CAUSE FOR ADDITIONAL COMPENSATION FOR A CHANGE IN THE SCOPE OF THE WORK. HOWEVER, THE CONTRACTOR WILL BE PAID FOR THE QUANTITY ACTUALLY FURNISHED AT THE UNIT PRICE BID FOR THE WORK.

THE BITUMINOUS CONCRETE SURFACE THAT WILL BE REMOVED DURING THE JOINT REMOVAL HAS BEEN INCLUDED IN THE PAY ITEM CONCRETE REMOVAL.

PORTLAND CEMENT CONCRETE BASE COURSE WIDENING 8" WILL BE DONE IN ACCORDANCE WITH SECTION 354 OF THE STANDARD SPECIFICATIONS EXCEPT THE WIDENING MAY EXCEED 6 FEET.

BITUMINOUS SHOULDER REMOVAL SHALL CONSIST OF REMOVAL OF THE ASPHALT SHOULDER TO ITS FULL DEPTH OR A MINIMUM OF 8 INCHES TO OBTAIN THE REQUIRED DEPTH OF BASE COURSE WIDENING. ALL PAVEMENT MARKING REMOVAL SHALL BE DONE IN ACCORDANCE WITH SECTION 902 OF THE STANDARD SPECIFICATIONS EXCEPT PAYMENT WILL BE INCLUDED IN THE CONTRACT UNIT PRICE PER EACH FOR TRAFFIC CONTROL AND PROTECTION, STANDARD 231G (SPECIAL).

PAINT PAVEMENT MARKING LINE	
1770.0	FOOT (WHITE)
1780.0	FOOT (YELLOW)
TOTAL	3550.0

TEMPORARY CONCRETE BARRIERS TO BE INSTALLED AS SHOWN IN THE SUMMARY OF QUANTITIES ARE LOCATED AT THE I.D.O.T. MAINTENANCE YARD AT KNIGHTS PRAIRIE WHICH IS LOCATED APPROXIMATELY 7 MILES WEST OF MCLEANSBORD ON ILL. 14 IN HAMILTON COUNTY. A MINIMUM OF 48 HOURS NOTICE WILL BE REQUIRED TO ARRANGE FOR PICKUP AND/OR RETURN OF THE BARRIERS. STATE MAINTENANCE FORCES WILL NOT LOAD OR UNLOAD THE BARRIERS.

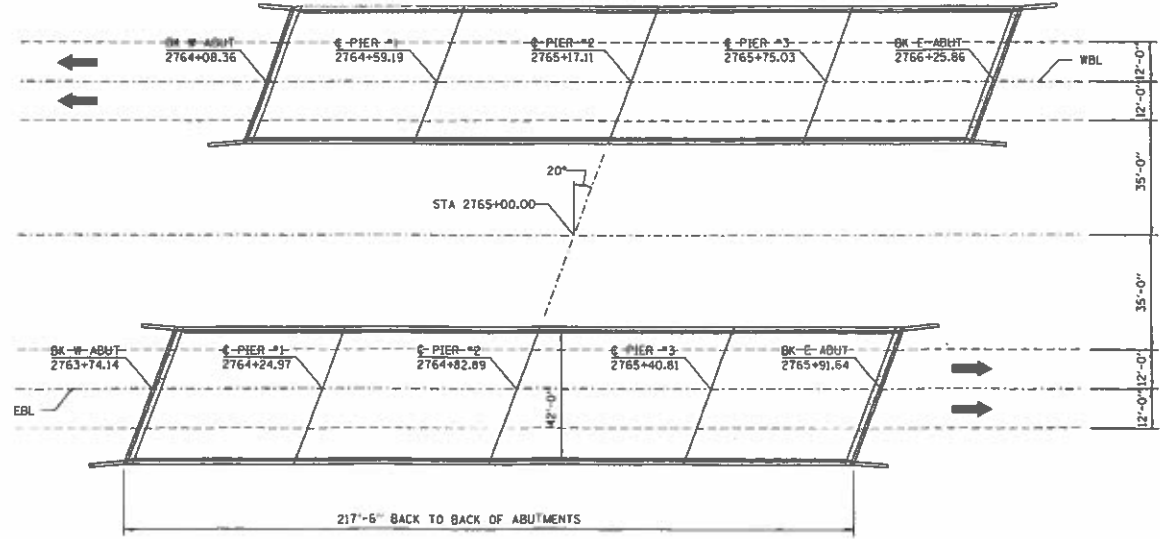

GENERAL PLAN VIEW
CASEY FORK OVERFLOW
SECTION BRIDGE JOINT REPAIR 1994-1
JEFFERSON COUNTY
STA. 2765+00.00
(SN. 041-0087)WB
(SN. 041-0088)EB

GENERAL NOTES, SUMMARY OF QUANTITIES

TAMERAN

FBI NO.	SECTION	COUNTY	WBL. STA.	WBL. NO.
64	JOINT REPAIR 1994-1	JEFFERSON	8	3

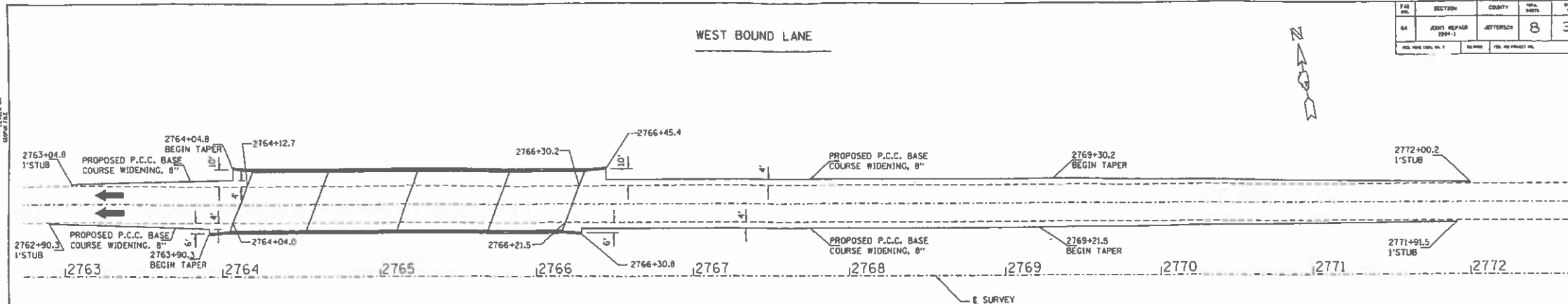

CONSTRUCT P.C.C. BASE COURSE WIDENING 8"

RT. 2757+99.8	TO	RT. 2763+69.8 (EBL)	216.4	SO YD
RT. 2765+87.3	TO	RT. 2766+95.4 (EBL)	38.6	SO YD
RT. 2758+08.5	TO	RT. 2763+78.5 (EBL)	211.7	SO YD
WT. 2765+96.0	TO	RT. 2767+09.7 (EBL)	36.3	SO YD
LT. 2763+04.8	TO	LT. 2764+12.7 (WBL)	38.6	SO YD
LT. 2766+30.2	TO	LT. 2772+00.2 (WBL)	216.4	SO YD
LT. 2762+90.3	TO	LT. 2764+04.0 (WBL)	36.3	SO YD
LT. 2766+21.5	TO	LT. 2771+91.5 (WBL)	211.7	SO YD

BITUMINOUS SHOULDER REMOVAL

RT. 2757+99.8	TO	RT. 2763+69.8 (EBL)	216.4	SO YD
RT. 2765+87.3	TO	RT. 2766+95.4 (EBL)	38.6	SO YD
RT. 2758+08.5	TO	RT. 2763+78.5 (EBL)	211.7	SO YD
RT. 2765+96.0	TO	RT. 2767+09.7 (EBL)	36.3	SO YD
LT. 2763+04.8	TO	LT. 2764+12.7 (WBL)	38.6	SO YD
LT. 2766+30.2	TO	LT. 2772+00.2 (WBL)	216.4	SO YD
LT. 2762+90.3	TO	LT. 2764+04.0 (WBL)	36.3	SO YD
LT. 2766+21.5	TO	LT. 2771+91.5 (WBL)	211.7	SO YD

NOTE: RT AND LT STATIONING ARE FROM @ SURVEY

PAYEMENT MARKING REMOVAL
 *COST INCIDENTAL TO TRAFFIC CONTROL AND PROTECTION STANDARD 2316 (SPECIAL)

RT. 2758+10	TO	RT. 2766+95 (EBL)	885	FT
RT. 2758+19	TO	RT. 2767+19 (EBL)	890	FT
LT. 2763+05	TO	LT. 2771+90 (WBL)	885	FT
LT. 2762+91	TO	LT. 2771+81 (WBL)	890	FT

CONSTRUCT TEMPORARY PAVEMENT MARKING

RT. 2758+10	TO	RT. 2766+95 (EBL)	885	FT
RT. 2758+19	TO	RT. 2767+09 (EBL)	890	FT
LT. 2763+05	TO	LT. 2771+90 (WBL)	885	FT
LT. 2762+91	TO	LT. 2771+81 (WBL)	890	FT

NOTE: RT AND LT STATIONING ARE FROM @ SURVEY

CONSTRUCT TEMPORARY CONCRETE BARRIER

RT. 2762+10	TO	RT. 2766+00 (STAGE II)	390	FT
LT. 2764+00	TO	LT. 2767+90 (STAGE II)	390	FT

CONSTRUCT TEMPORARY CONCRETE BARRIER TERMINAL SECTION

RT. 2762+10	1	EACH
LT. 2767+90	1	EACH

RELOCATE TEMPORARY CONCRETE BARRIER

RT. 2762+03	TO	RT. 2766+00 (STAGE II)	397	FT
LT. 2764+00	TO	LT. 2767+97 (STAGE II)	397	FT

- CONSTRUCTION SEQUENCE FOR EACH BRIDGE**
- ERECT TRAFFIC CONTROL STANDARD 2316 TO CONSTRUCT WIDENING FOR STAGE I TRAFFIC.
 - CONSTRUCT P.C.C. BASE COURSE WIDENING 8" FOR STAGE I TRAFFIC.
 - REMOVE PAVEMENT MARKING FOR STAGE I TRAFFIC IN ACCORDANCE WITH SECTION 902 OF THE STANDARD SPECIFICATIONS EXCEPT FOR THE CHANGE IN METHOD OF PAY.
 - CONSTRUCT TEMPORARY PAVEMENT MARKING EDGELINE FOR STAGE I TRAFFIC.
 - ERECT TRAFFIC CONTROL AS PER STAGE I CONSTRUCTION (SEE PAGE 4) AND SET TEMPORARY CONCRETE BARRIERS FOR STAGED CONSTRUCTION.
 - CONSTRUCT TEMPORARY PAVEMENT MARKING CENTERLINE FOR STAGE I TRAFFIC.
 - CONSTRUCT P.C.C. BASE COURSE WIDENING 8" FOR STAGE II TRAFFIC.
 - REFLECTORIZED TEMPORARY PAVEMENT MARKING TAPE REQUIRED IN TRAFFIC CONTROL & PROTECTION STANDARD 2316 ALONG CENTERLINE SHALL BE PLACED IMMEDIATELY AFTER COMPLETION OF THE DRUM TAPER.
 - CONSTRUCT TEMPORARY PAVEMENT MARKING EDGELINE FOR STAGE II TRAFFIC.
 - CONSTRUCT STAGE I (INCLUDING JOINT REMOVAL & REPLACEMENT, FORMED CONCRETE REPAIR AND EPOXY CRACK SEALING).
 - ERECT TRAFFIC CONTROL AS PER STAGE II CONSTRUCTION AND RELOCATE CONCRETE BARRIERS FOR STAGE II.
 - CONSTRUCT TEMPORARY PAVEMENT MARKING CENTERLINE FOR STAGE II TRAFFIC.
 - CONSTRUCT STAGE II (INCLUDING JOINT REMOVAL & REPLACEMENT, AND EPOXY CRACK SEALING).
- *COST INCIDENTAL TO STANDARD 2316 (SPECIAL)
SEE SPECIAL PROVISIONS

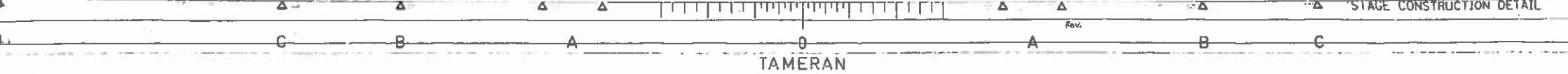
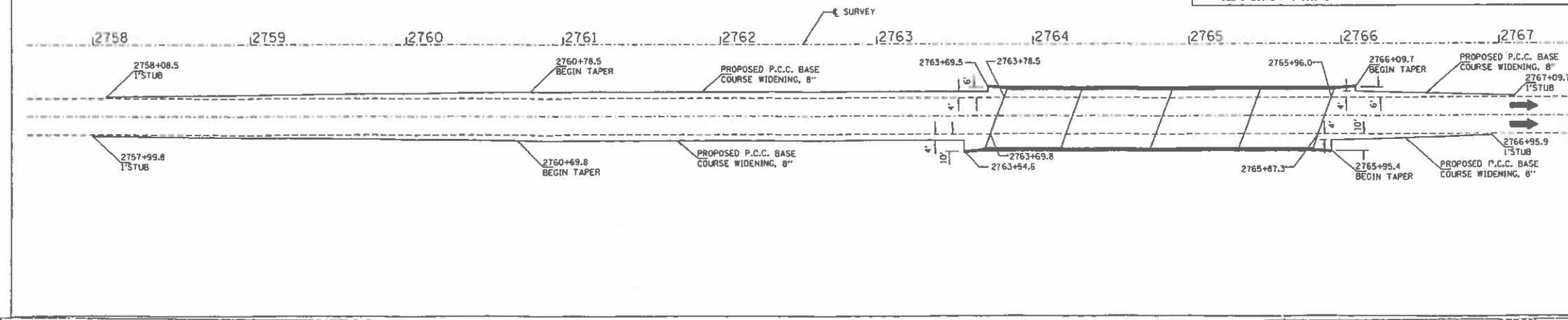

PAL NO.	SECTION	COUNTY	WHA	POST
64	JOINT REPAIR 2004-1	JEFFERSON	8	4
PAL PROJ. DESIG. NO. 1		DATE	PAL PROJ. PREPARED BY	

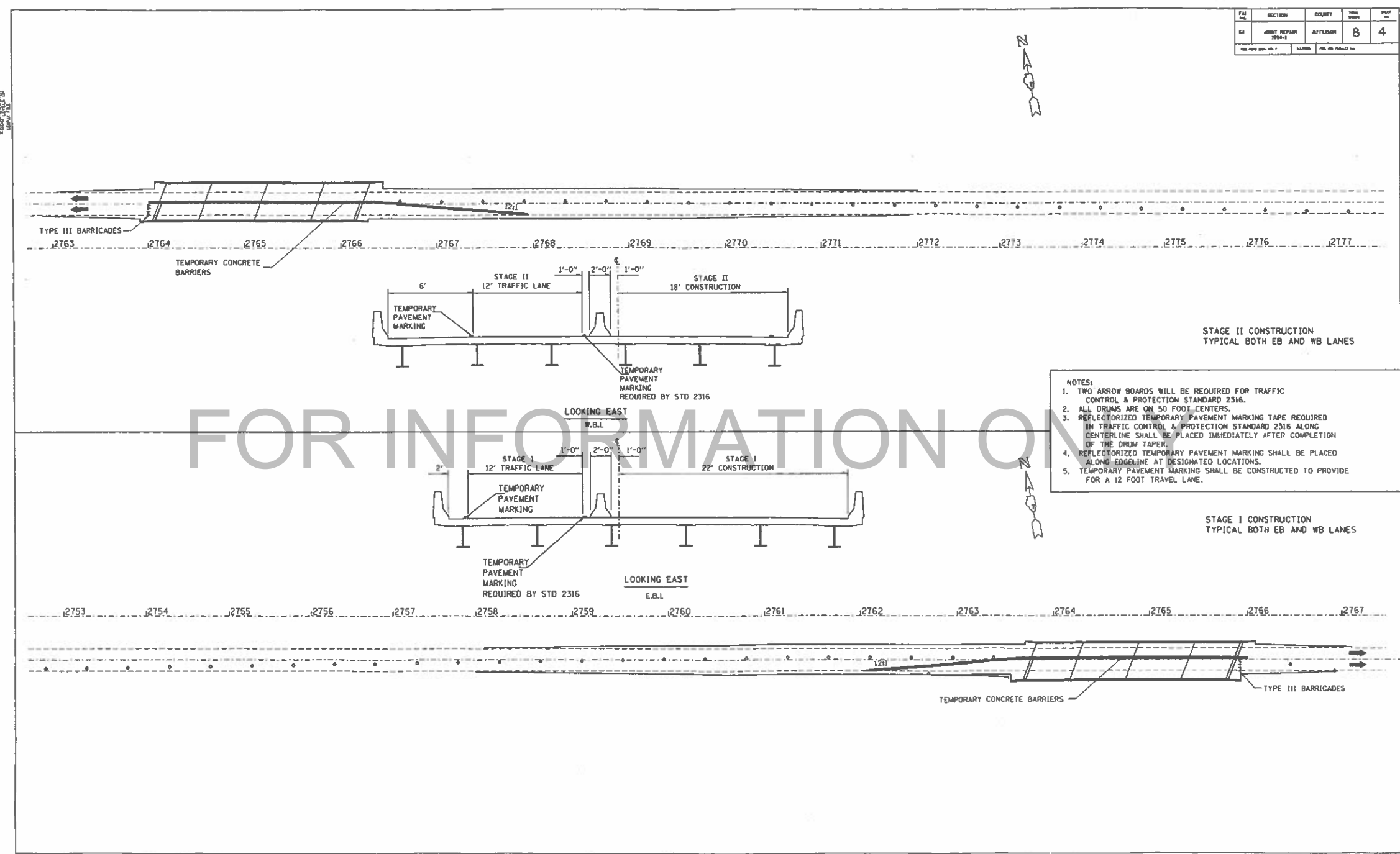

- NOTES:
1. TWO ARROW BOARDS WILL BE REQUIRED FOR TRAFFIC CONTROL & PROTECTION STANDARD 2316.
 2. ALL DRUMS ARE ON 50 FOOT CENTERS.
 3. REFLECTORIZED TEMPORARY PAVEMENT MARKING TAPE REQUIRED IN TRAFFIC CONTROL & PROTECTION STANDARD 2316 ALONG CENTERLINE SHALL BE PLACED IMMEDIATELY AFTER COMPLETION OF THE DRUM TAPER.
 4. REFLECTORIZED TEMPORARY PAVEMENT MARKING SHALL BE PLACED ALONG EDGELINE AT DESIGNATED LOCATIONS.
 5. TEMPORARY PAVEMENT MARKING SHALL BE CONSTRUCTED TO PROVIDE FOR A 12 FOOT TRAVEL LANE.



FILE NO.	SECTION	COUNTY	DATE	REV.
64	JOINT REPAIR 1994-1	JEFFERSON	8	5

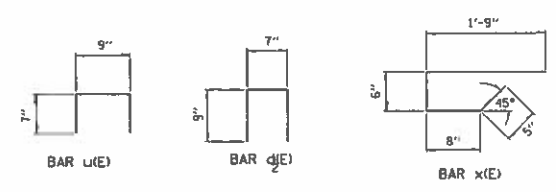
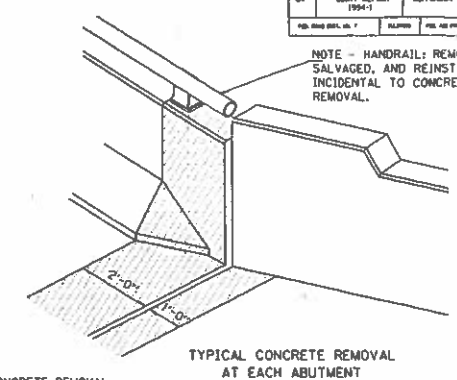
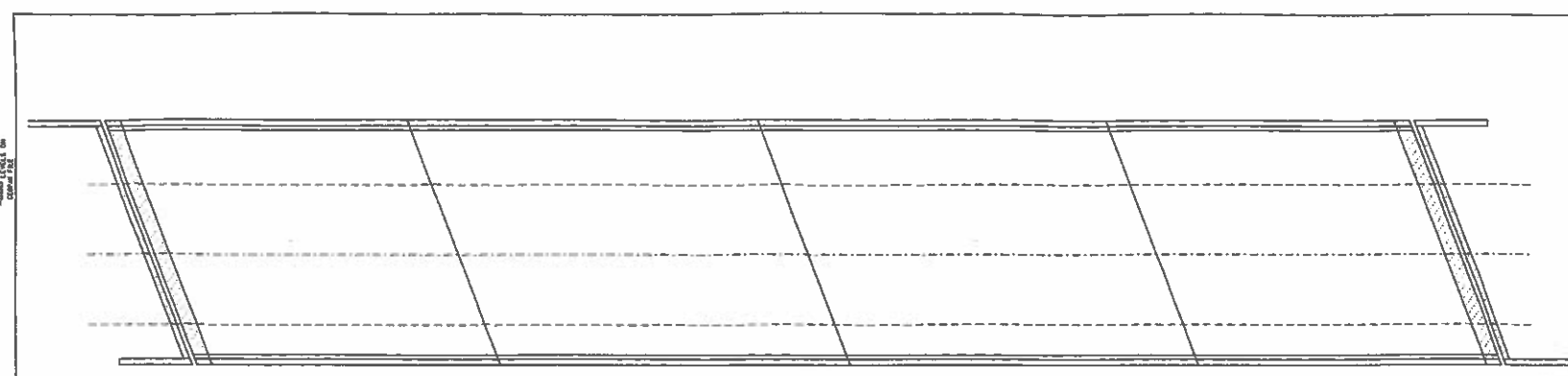

BILL OF MATERIALS (EBL CASEY FORK OVERFLOW SN 041-0088)

ITEM	UNIT	STAGE I	STAGE II	TOTAL
CONCRETE REMOVAL	CU YD	6.3	5.3	11.6
CONCRETE SUPERSTRUCTURE	CU YD	6.3	5.3	11.6
FURNISHING AND ERECTING STRUCTURAL STEEL REINFORCEMENT BARS (EPOXY COATED)	POUND	1832	1487	3319
PREFORMED JOINT SEAL 4"	FOOT	-	-	90
TEMPORARY PAVEMENT MARKING	FOOT	885	890	1775
PAINT PAVEMENT MARKING - LINE 4"	FOOT	885	890	1775
EPOXY CRACK SEALING	FOOT	6	7	13
EPOXY MORTAR REPAIR	CU FT	1.6	0.4	2
PORTLAND CEMENT CONCRETE BASE COURSE WIDENING 8"	SO YD	255	248	503
BITUMINOUS SHOULDER REMOVAL	SO YD	255	248	503

BILL OF MATERIALS (EBL CASEY FORK OVERFLOW SN 041-0088)

BAR	NO.	SIZE	LENGTH	SHAPE
u(E)-STAGE I	16	#5	24'-4"	————
u(E)-STAGE II	16	#5	20'-1"	————
d(E)-STAGE I	6	#5	4'-5"	
d(E)-STAGE II	6	#5	4'-5"	
d(E)-STAGE I	6	#5	3'-11"	
d(E)-STAGE II	6	#5	3'-11"	
d(E)-STAGE I	4	#4	2'-1"	
d(E)-STAGE II	4	#4	2'-1"	
h(E)-STAGE I	12	#5	23'-2"	
h(E)-STAGE II	12	#5	18'-11"	
u(E)-STAGE I	47	#5	1'-11"	
u(E)-STAGE II	39	#5	1'-11"	
x(E)-STAGE I	48	#5	3'-4"	
x(E)-STAGE II	40	#5	3'-4"	

(E) DENOTES EPOXY COATED

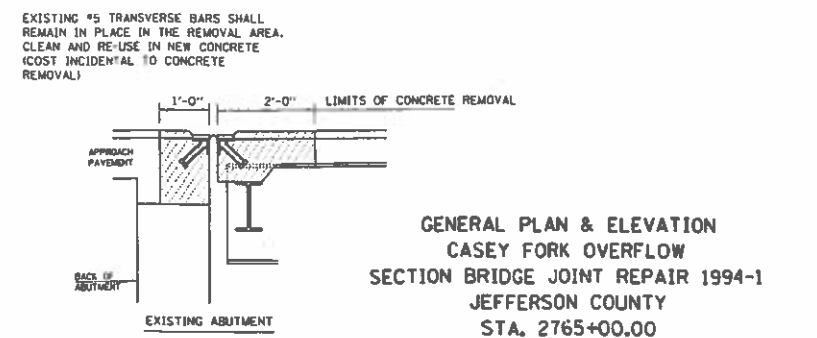
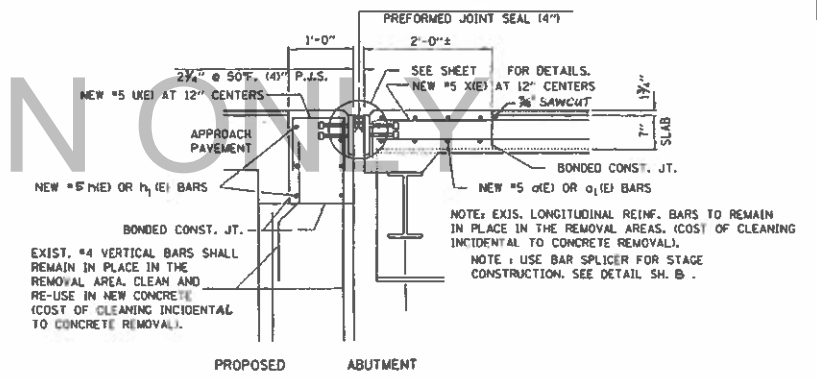
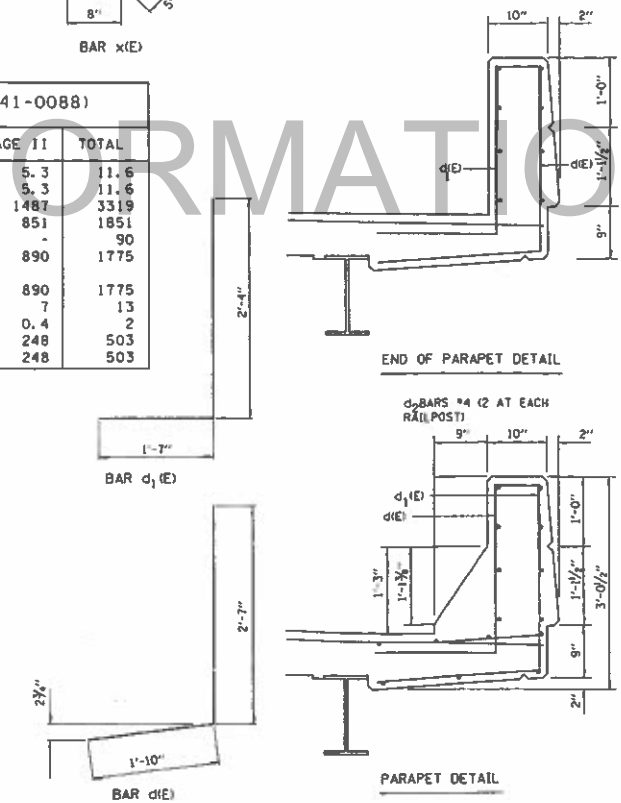

GENERAL PLAN & ELEVATION
CASEY FORK OVERFLOW
SECTION BRIDGE JOINT REPAIR 1994-1
JEFFERSON COUNTY
STA. 2765+00.00
(SN. 041-0088)EB

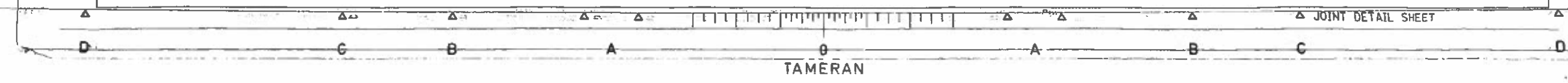

PAL NO.	SECTION	COUNTY	SCALE	SHEET NO.
LA	JOINT REPAIR 1994-1	JEFFERSON	8	6
TAMERAN BRIDGE		JEFFERSON COUNTY		STA. 2765+00.00

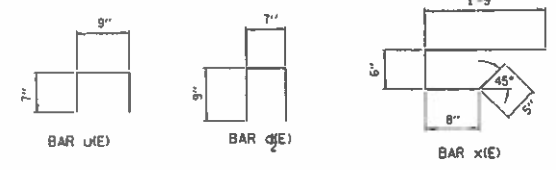
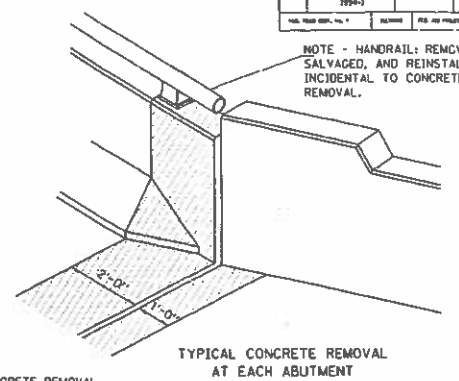
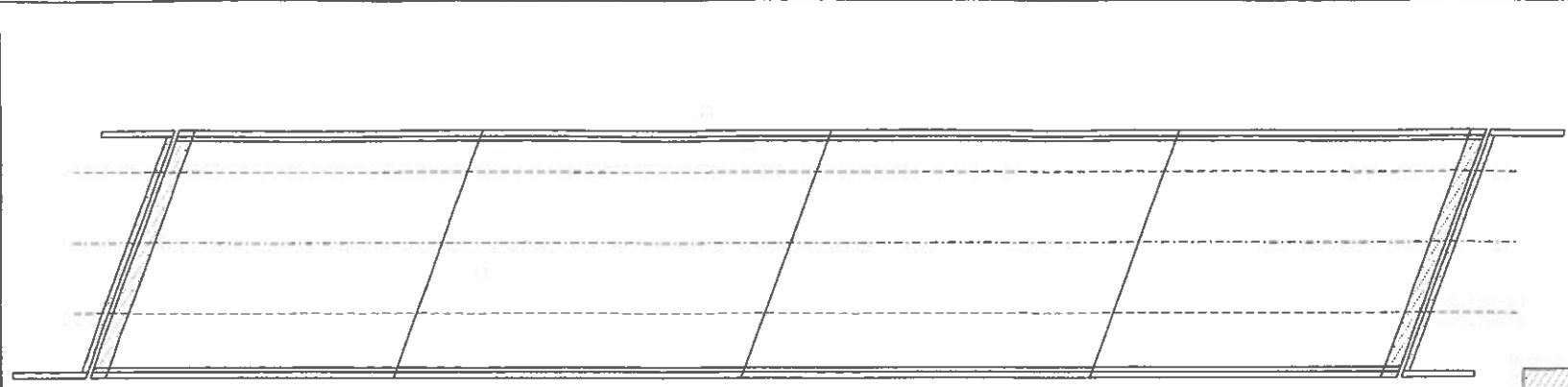

ITEM	UNIT	STAGE I	STAGE II	TOTAL
CONCRETE REMOVAL	CU YD	6.5	5.4	11.9
CONCRETE SUPERSTRUCTURE	CU YD	6.5	5.4	11.9
FURNISHING AND ERECTING STRUCTURAL STEEL	POUND	1832	1487	3319
REINFORCEMENT BARS (EPOXY COATED)	POUND	1010	841	1851
PREFORMED JOINT SEAL 4"	FOOT	-	-	90
TEMPORARY PAVEMENT MARKING	FOOT	885	890	1775
PAINT PAVEMENT MARKING - LINE 4"	FOOT	885	890	1775
FORMED CONCRETE REPAIR (FORMED <= 5")	SQ FT	5.6	-	5.6
FORMED CONCRETE REPAIR (FORMED > 5")	SQ FT	2.8	-	2.8
PORTLAND CEMENT CONCRETE BASE COURSE WIDENING 8"	SQ YD	255	248	503
BITUMINOUS SHOULDER REMOVAL	SQ YD	255	248	503

BAR	NO.	SIZE	LENGTH	SHAPE
u(E)-STAGE I	16	#5	24'-4"	U
u(E)-STAGE II	16	#5	20'-1"	U
d(E)-STAGE I	6	#5	4'-5"	D
d(E)-STAGE II	6	#5	4'-5"	D
x(E)-STAGE I	6	#5	3'-11"	X
x(E)-STAGE II	6	#5	3'-11"	X
d(E)-STAGE I	4	#4	2'-1"	D
d(E)-STAGE II	4	#4	2'-1"	D
u(E)-STAGE I	12	#5	23'-2"	U
u(E)-STAGE II	12	#5	18'-11"	U
u(E)-STAGE I	47	#5	1'-11"	U
u(E)-STAGE II	39	#5	1'-11"	U
x(E)-STAGE I	48	#5	3'-4"	X
x(E)-STAGE II	40	#5	3'-4"	X

(E) DENOTES EPOXY COATED

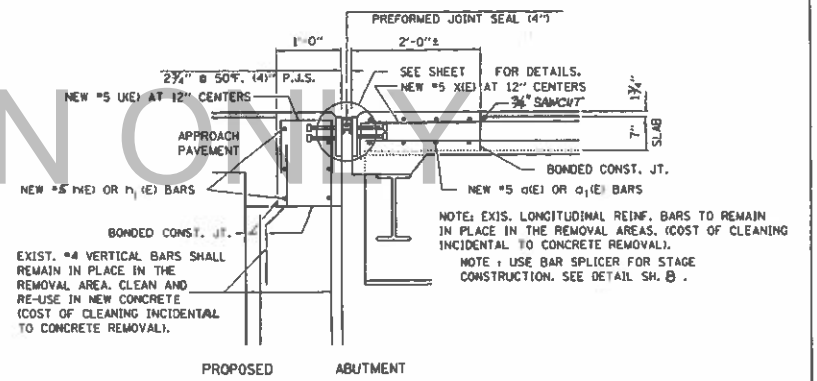
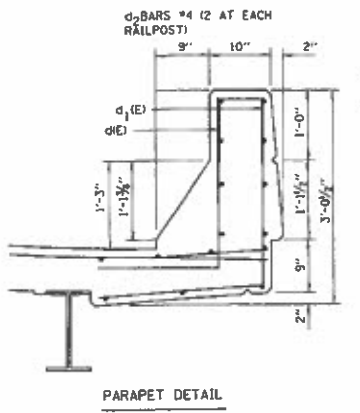
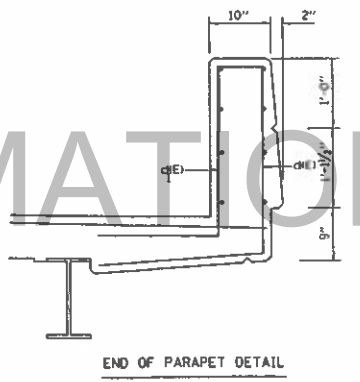

EXISTING #5 TRANSVERSE BARS SHALL REMAIN IN PLACE IN THE REMOVAL AREA. (CLEAN AND RE-USE IN NEW CONCRETE (COST INCIDENTAL TO CONCRETE REMOVAL))

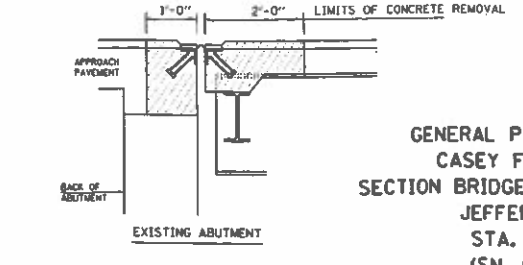

GENERAL PLAN & ELEVATION
CASEY FORK OVERFLOW
SECTION BRIDGE JOINT REPAIR 1994-1
JEFFERSON COUNTY
STA. 2765+00.00
(SN. 041-0087)WB

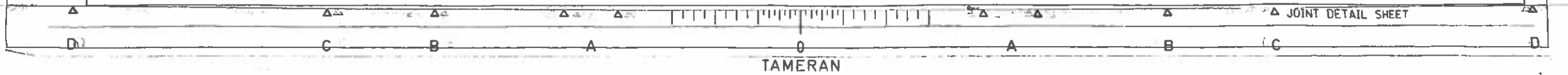

FAC. NO.	SECTOR	COUNTY	WAL. NO.	WAL. NO.
54	JOINT REPAIR	JEFFERSON	8	7
SHEET NO. 7		SHEET NO. 8		

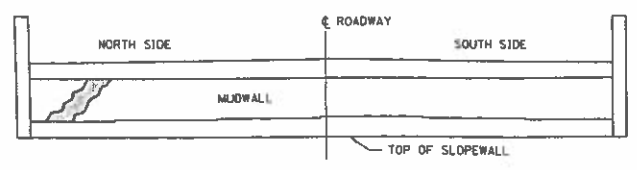

EAST ABUTMENT
SOUTH BRIDGE

CONSTRUCT EPOXY CRACK SEALING 13.0 LIN. FT.

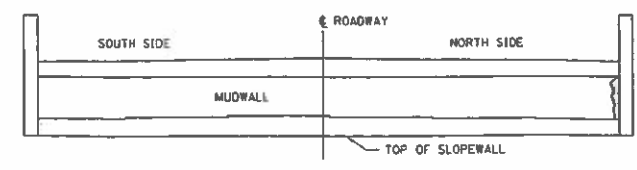

WEST ABUTMENT
SOUTH BRIDGE

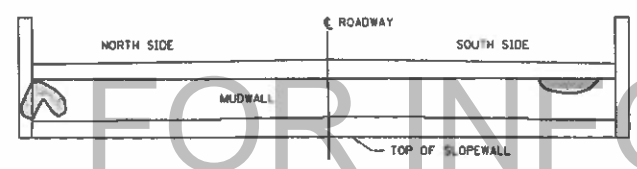

EAST ABUTMENT
SOUTH BRIDGE

CONSTRUCT EPOXY MORTAR REPAIR 2.0 CU. FT.

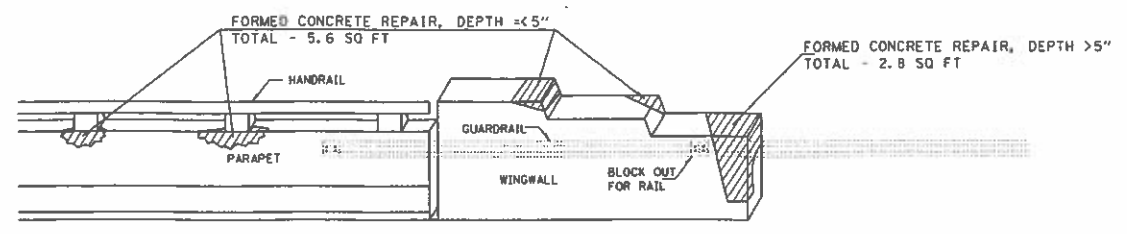

DETAIL OF WING AND PARAPET

EAST ABUTMENT
NORTH BRIDGE

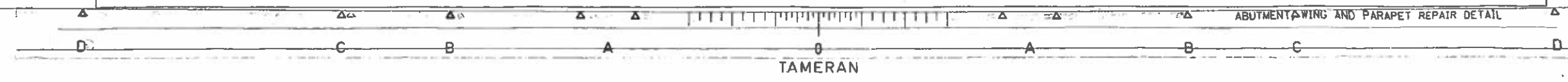

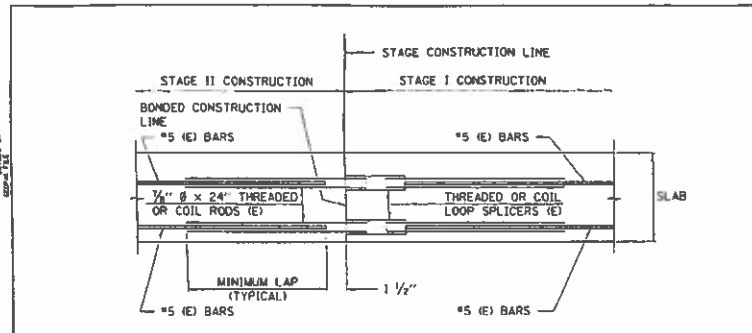

NOTE: BAR SPLICER ASSEMBLIES SHALL BE IN ACCORDANCE WITH SECTION 508 OF THE STANDARD SPECIFICATIONS EXCEPT AS NOTED. THE FINISHING AND INSTALLATION OF BAR SPLICER ASSEMBLIES ARE INCIDENTAL TO REINFORCEMENT BARS (EPOXY COATED).



SPLICER ALTERNATIVES
 ** HEAVY HEX NUTS CONFORMING TO ASTM A 563, GRADE C/D, OR DR MAY BE USED.

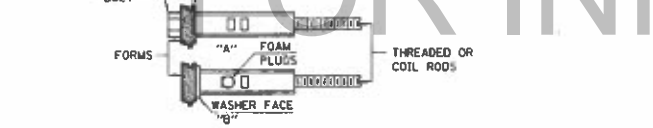

INSTALLATION AND SETTING METHODS
 "A": SET SPLICER BY MEANS OF A TEMPLATE BOLT.
 "B": SET SPLICER BY NAILING TO WOOD FORMS OR CEMENTING TO METAL FORMS.
 (EH) INDICATES EPOXY COATING.

NOTES
 56 STEEL SPLICES (COUPLER) ASSEMBLY WILL BE REQUIRED ON THIS JOB.
 STEEL SPLICER (COUPLER) ASSEMBLY SHALL BE OF AN APPROVED TYPE AND SHALL DEVELOP IN TENSION AT LEAST 125 PERCENT OF THE YIELD STRENGTH OF THE LAPPED REINFORCEMENT BARS.
 STEEL SPLICER RODS SHALL BE OF MINIMUM 60 KSI YIELD STRENGTH THREADED OR COILED FULL LENGTH AND HAVE EFFECTIVE TENSILE STRESS AREA EQUAL TO OR GREATER THAN THAT OF THE LAPPED REINFORCEMENT BARS.
 ALL REINFORCEMENT BARS SHALL BE LAPPED AND TIED TO THE SPLICER RODS.
 SPLICER (COUPLER) ASSEMBLY IN THE SLAB SHALL BE EPOXY COATED IN ACCORDANCE WITH THE REQUIREMENTS FOR REINFORCEMENT BARS.
 OTHER SYSTEMS OF SIMILAR DESIGN MAY BE SUBMITTED TO THE ENGINEER FOR APPROVAL. APPROVAL SHALL BE BASED ON CERTIFIED TEST RESULTS FROM AN APPROVED TESTING LABORATORY THAT THE PROPOSED SPLICER (COUPLER) ASSEMBLY SATISFIES THE FOLLOWING REQUIREMENTS:

1. MINIMUM CAPACITY
(TENSION IN KIPS) = $1.25 \times f_y \times A_t$
2. MINIMUM PULL-OUT STRENGTH
(TENSION IN KIPS) = $1.25 \times f_s \text{ ALLOW} \times A_t$

WHERE f_y = YIELD STRENGTH OF LAPPED REINFORCEMENT BARS IN KSI.
 $f_s \text{ ALLOW}$ = ALLOWABLE TENSILE STRESS IN LAPPED REINFORCED BARS IN KSI (SERVICE LOAD).
 A_t = TENSILE STRESS IN AREA OF LAPPED REINFORCEMENT BARS.
 * = 28 DAY CONCRETE

TYPICAL SPLICER (COUPLER) ASSEMBLY SIZES:
 IN SLABS: #5 BAR LAP WITH 3/4" Ø SPLICER (COUPLER) x 2'-0" SPLICER RODS. MINIMUM CAPACITY = 23.0 KIPS-TENSION. MINIMUM PULL-OUT STRENGTH = 9.2 KIPS-TENSION.

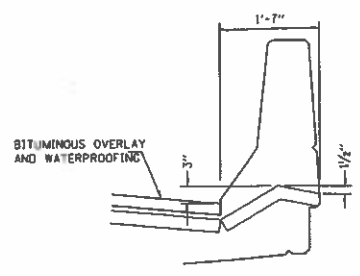

TYPICAL END OF SEAL TREATMENT

GENERAL NOTES FOR PREFORMED JOINT SEAL

AFTER FABRICATION ALL SURFACES OF THE STEEL PLATES SHALL BE PAINTED IN ACCORDANCE WITH THE APPLICABLE PORTIONS OF ARTICLE 506.04 OF THE STANDARD SPECIFICATIONS.
 JOINT OPENINGS SHALL BE ADJUSTED IN ACCORDANCE WITH ARTICLE 503.10 (c) OF THE STANDARD SPECIFICATIONS.

FALL	SECTION	COUNTY	DATE	REV.
84	JOINT REPAIR	JEFFERSON	8	8

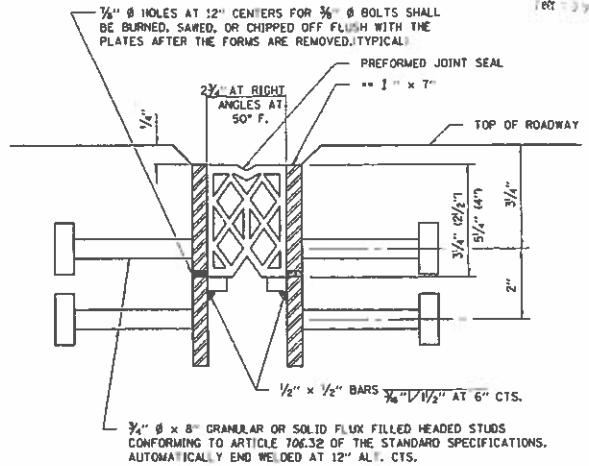

PREFORMED JOINT SEALS

** FURNISH IN SEGMENTS OF 20 FT. MAXIMUM LENGTH. MAXIMUM SPACE BETWEEN INSTALLED SEGMENTS SHALL BE 3/8". SEAL SPACE WITH SILICONE SEALANT SUITABLE FOR STRUCTURAL STEEL.

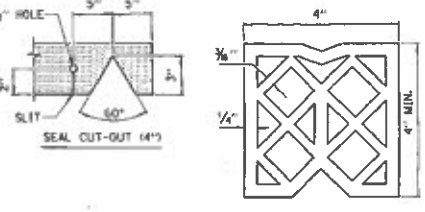

PREFORMED JOINT SEALS

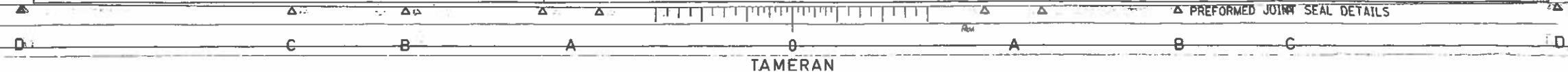

TAMERAN