

RTE.	SECTION	COUNTY	TOTAL SHEETS	SHEET NO.
*	2006-027 I	LAKE	31	19
FED. ROAD DIST. NO. 1		ILLINOIS	FED. AID PROJECT	

* PARK ROADS IDNR File No. 2-03-025 B
D91-401-06

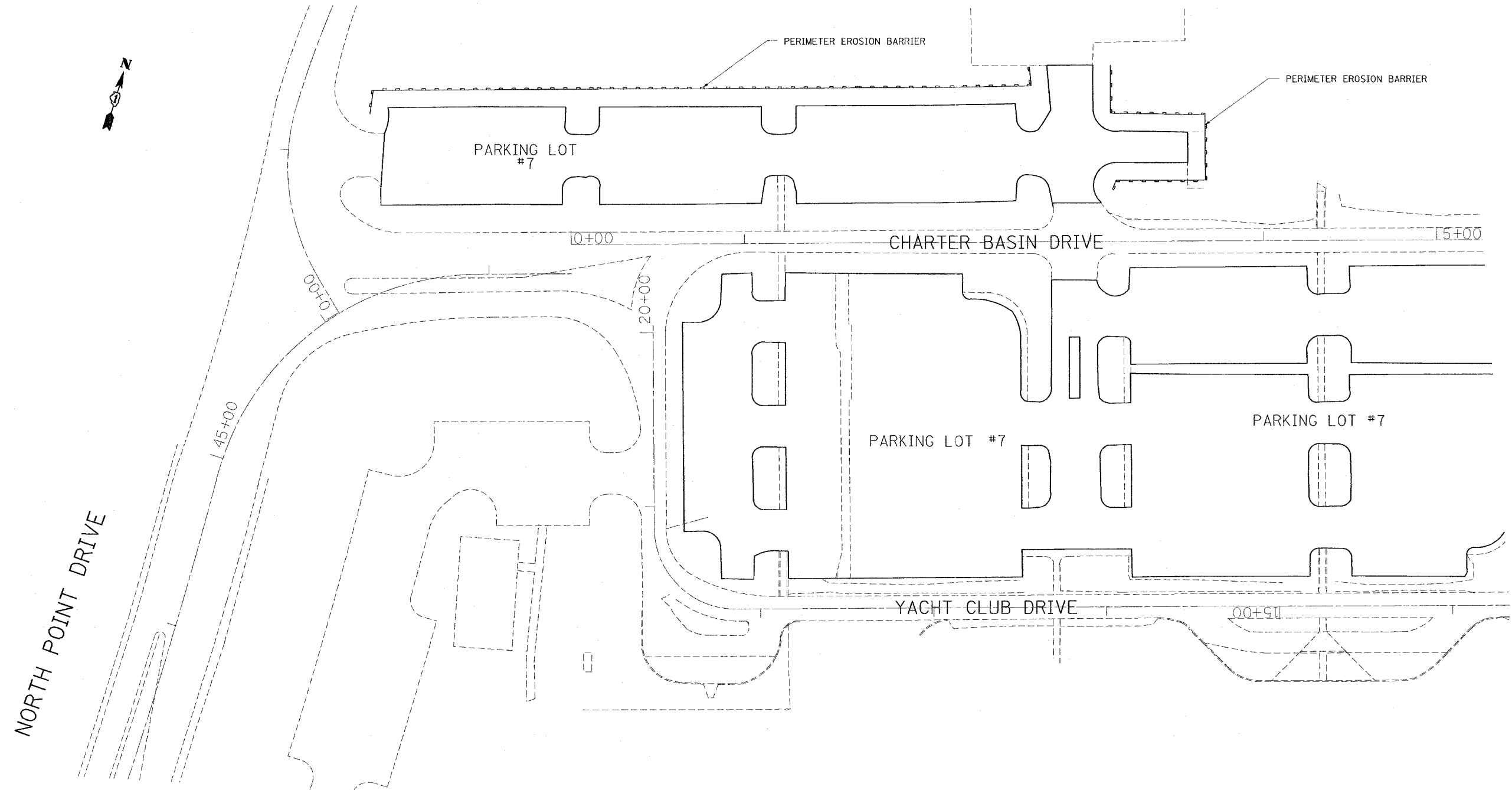

NOTE: PERIMETER EROSION BARRIER SHALL BE PLACED WHERE INDICATED AND/OR AS DIRECTED BY THE ENGINEER
PERIMETER BARRIER IS NOT REQUIRED FOR SOUTH SIDE PARKING LOT 7

REVISIONS	
NAME	DATE

ILLINOIS DEPARTMENT OF TRANSPORTATION
PARK ROADS
ILLINOIS BEACH STATE PARK
NORTH POINT MARINA
EROSION CONTROL PLAN

SCALE:
DATE

DRAWN BY: CDT
CHECKED BY:

11/3/2006
c:\projects\p134482\design\m32
50.0000' / IN.
#REF#