

F.A. RTE.	SECTION	COUNTY	TOTAL SHEETS	SHEET NO.
VAR.	2006-028 DM	VARIOUS	35	2
STA.		TO STA.		
FED. ROAD DIST. NO. 1		ILLINOIS FED. AID PROJECT		

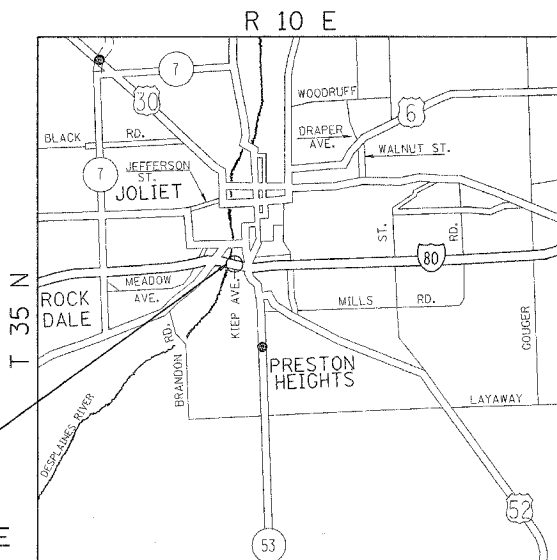

LOCATION 1
TRAFFIC DATA
ADT NOT AVAILABLE



CITY OF JOLIET
(WILL COUNTY)

LOCATION 2
TRAFFIC DATA
2004 ADT: 3400

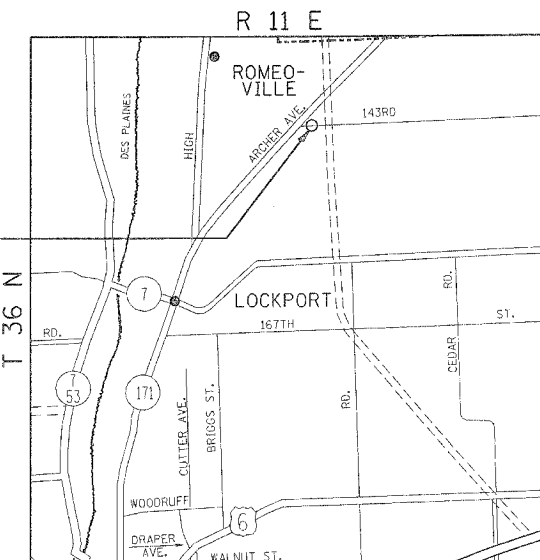

CITY OF LOCKPORT
(WILL COUNTY)

LOCATION 3
TRAFFIC DATA
ADT NOT AVAILABLE

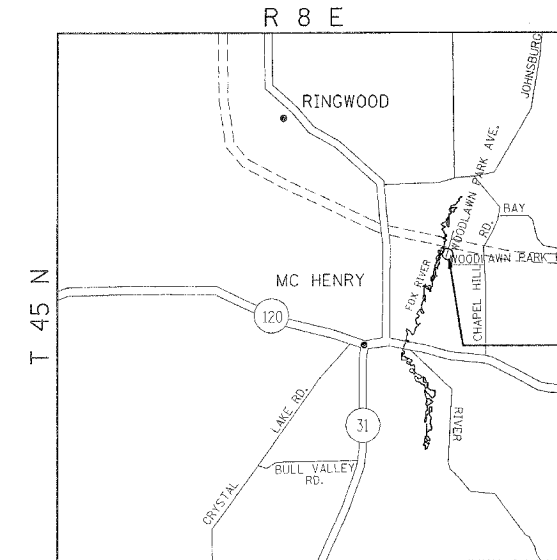

CITY OF MCHENRY
(MCHENRY COUNTY)

LOCATION 4
TRAFFIC DATA
ADT NOT AVAILABLE

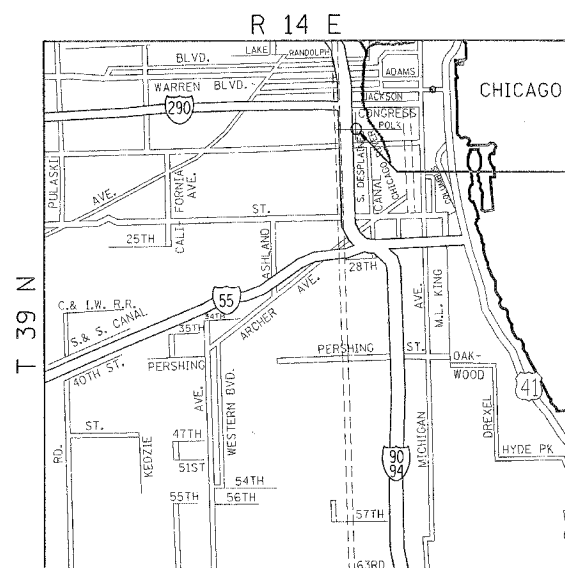

CITY OF CHICAGO
(COOK COUNTY)

LOCATION 5
TRAFFIC DATA
ADT NOT AVAILABLE

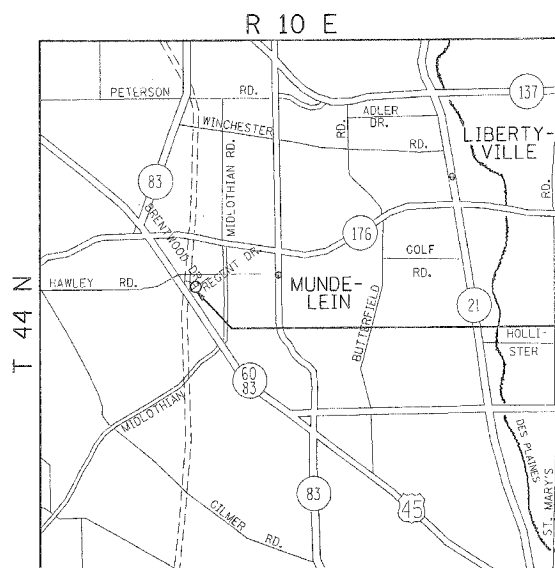

VILLAGE OF MUNDELEIN
(LAKE COUNTY)

LOCATION 6
TRAFFIC DATA
ADT NOT AVAILABLE

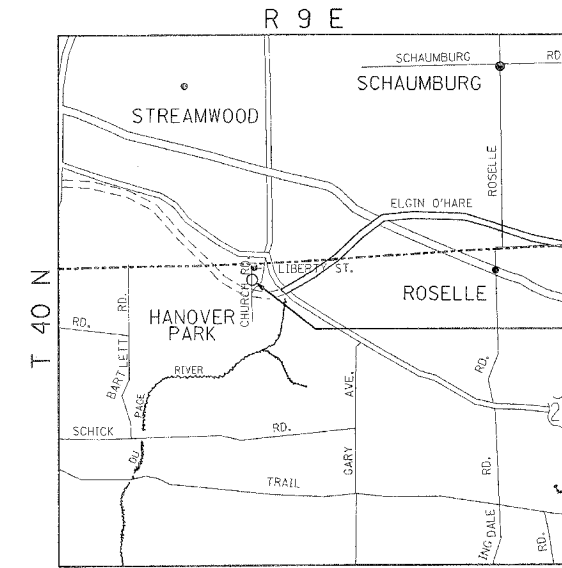

VILLAGE OF HANOVER PARK
(DUPAGE COUNTY)

PLOT DATE = 11/3/2006
FILE NAME = c:\p\projects\42306\design\loc.dgn
PLOT SCALE = 2500.0000 / IN.
USER NAME = abraham

REVISIONS	
NAME	DATE

ILLINOIS DEPARTMENT OF TRANSPORTATION

LOCATION MAPS
VARIOUS LOCATIONS

SCALE: VERT.
HORIZ.
DATE

DRAWN BY
CHECKED BY