

| | | | | |
|---------------------|------------|----------|------------------|-----------|
| F.A.P. RTE. | SECTION | COUNTY | TOTAL SHEETS | SHEET NO. |
| 372 | 2006-039TS | COOK | 36 | 32 |
| STA. | | TO STA. | | |
| FED. ROAD DIST. NO. | | ILLINOIS | FED. AID PROJECT | |
| CONTRACT NO. 60C01 | | | | |

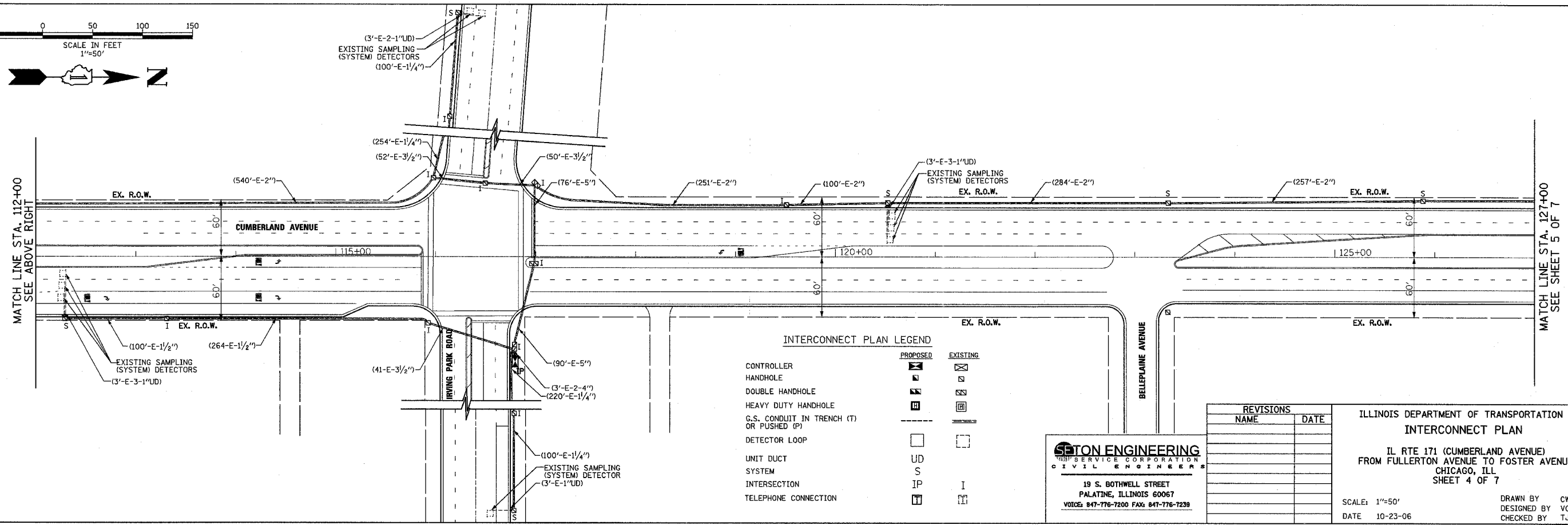
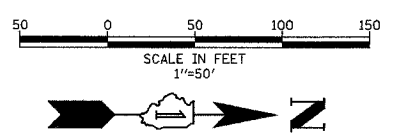
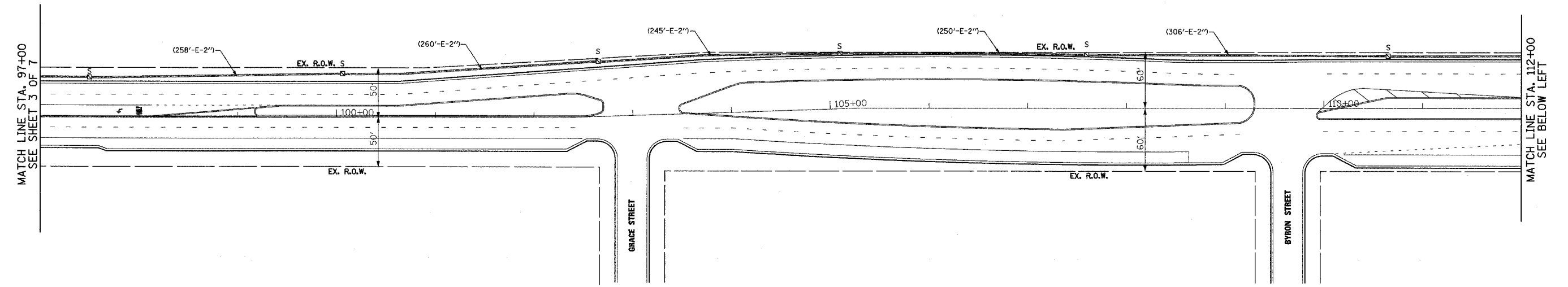

INTERCONNECT PLAN LEGEND

| | PROPOSED | EXISTING |
|--|----------|----------|
| CONTROLLER | [Symbol] | [Symbol] |
| HANDHOLE | [Symbol] | [Symbol] |
| DOUBLE HANDHOLE | [Symbol] | [Symbol] |
| HEAVY DUTY HANDHOLE | [Symbol] | [Symbol] |
| G.S. CONDUIT IN TRENCH (T) OR PUSHED (P) | [Symbol] | [Symbol] |
| DETECTOR LOOP | [Symbol] | [Symbol] |
| UNIT DUCT | UD | |
| SYSTEM | S | |
| INTERSECTION | IP | I |
| TELEPHONE CONNECTION | [Symbol] | [Symbol] |

SETON ENGINEERING
CONSULTING SERVICE CORPORATION
 CIVIL ENGINEERS
 19 S. BOTHWELL STREET
 PALATINE, ILLINOIS 60067
 VOICE: 847-776-7200 FAX: 847-776-7239

| REVISIONS | |
|-----------|------|
| NAME | DATE |
| | |
| | |
| | |
| | |
| | |
| | |

ILLINOIS DEPARTMENT OF TRANSPORTATION
INTERCONNECT PLAN
 IL RTE 171 (CUMBERLAND AVENUE)
 FROM FULLERTON AVENUE TO FOSTER AVENUE
 CHICAGO, ILL
 SHEET 4 OF 7
 SCALE: 1"=50'
 DATE: 10-23-06
 DRAWN BY: CWC, BR
 DESIGNED BY: VO
 CHECKED BY: TJM