

F.A.P. RTE.	SECTION	COUNTY	TOTAL SHEETS	SHEET NO.
372	2006-039TS	COOK	36	33
STA.		TO STA.		
FED. ROAD DIST. NO.		ILLINOIS FED. AID PROJECT		
CONTRACT NO. 60C01				

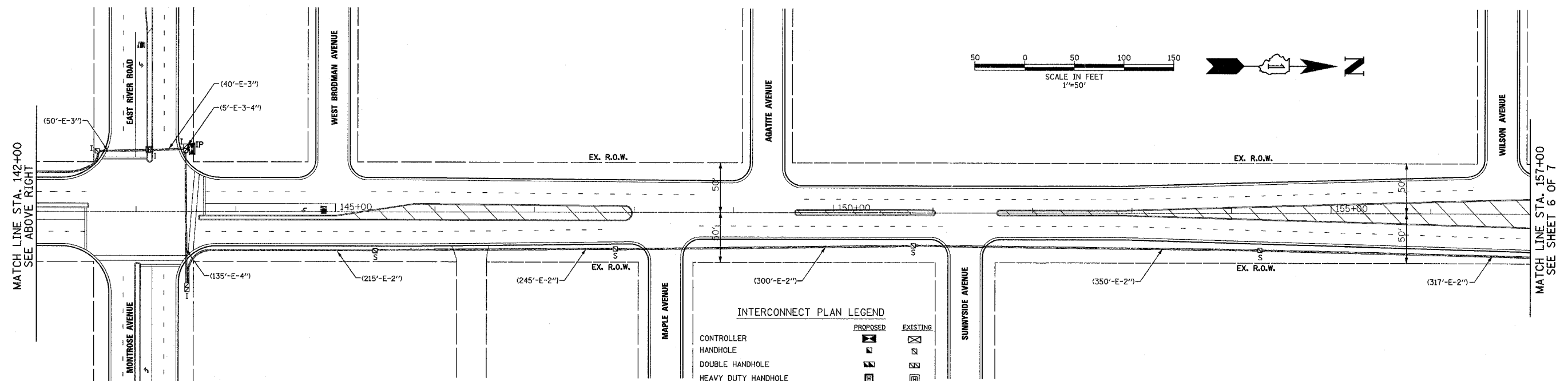
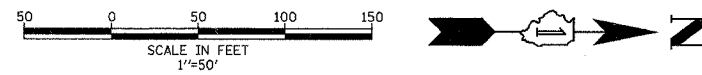
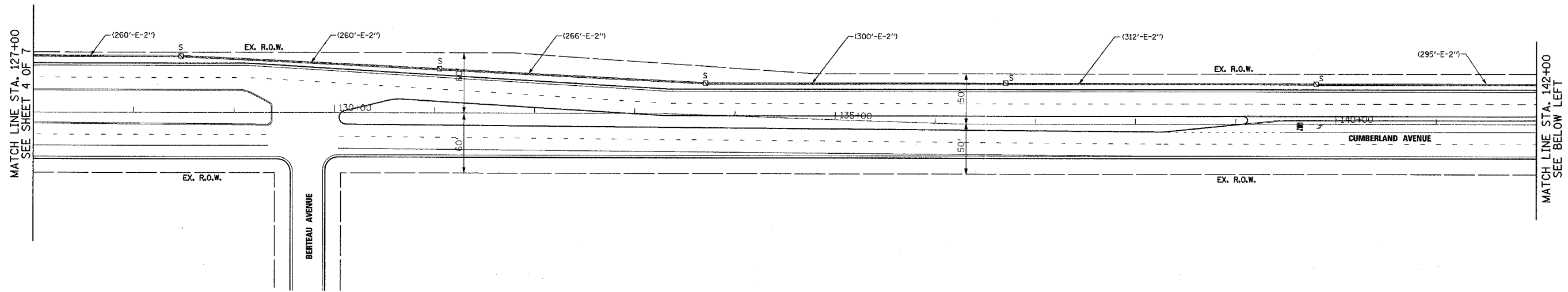
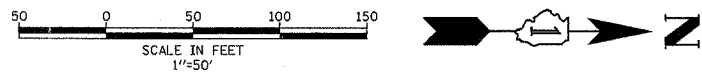

INTERCONNECT PLAN LEGEND

	PROPOSED	EXISTING
CONTROLLER	[Symbol]	[Symbol]
HANDHOLE	[Symbol]	[Symbol]
DOUBLE HANDHOLE	[Symbol]	[Symbol]
HEAVY DUTY HANDHOLE	[Symbol]	[Symbol]
G.S. CONDUIT IN TRENCH (T) OR PUSHED (P)	[Symbol]	[Symbol]
DETECTOR LOOP	[Symbol]	[Symbol]
UNIT DUCT SYSTEM	UD	S
INTERSECTION	IP	I
TELEPHONE CONNECTION	[Symbol]	[Symbol]

SETON ENGINEERING
 SERVICE CORPORATION
 CIVIL ENGINEERS
 19 S. BOWWELL STREET
 PALATINE, ILLINOIS 60067
 VOICE: 847-776-7200 FAX: 847-776-7239

REVISIONS	
NAME	DATE

ILLINOIS DEPARTMENT OF TRANSPORTATION
INTERCONNECT PLAN
 IL RTE 171 (CUMBERLAND AVENUE)
 FROM FULLERTON AVENUE TO FOSTER AVENUE
 CHICAGO, ILL.
 SHEET 5 OF 7
 SCALE: 1"=50'
 DATE 10-23-06
 DRAWN BY CWC, BR
 DESIGNED BY VO
 CHECKED BY TJM