

*REF-top7111
*REF-p7111

F.A. RTE.	SECTION	COUNTY	TOTAL SHEETS	SHEET NO.
*	2004-025 RS	LAKE	116	34
STA. 23+61.92		TO STA. 37+00		
FED. ROAD DIST. NO.		ILLINOIS FED. AID PROJECT		
* PARK ROADS		CONTRACT NO. 62745		
IDNR FILE NO. 2-03-025A				

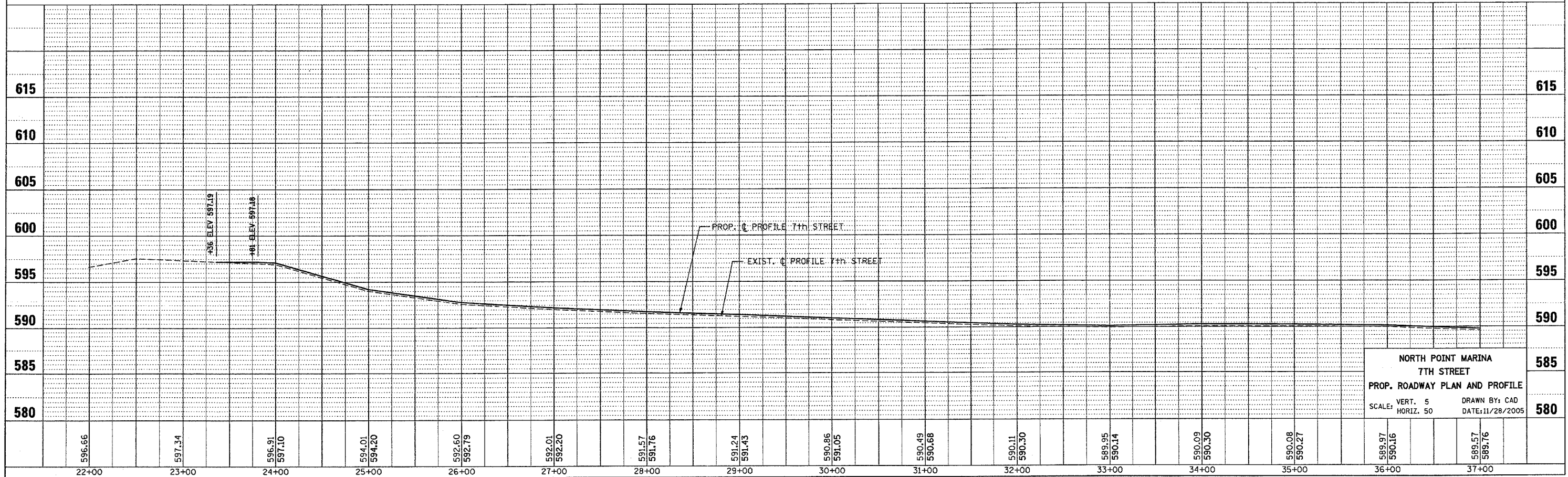
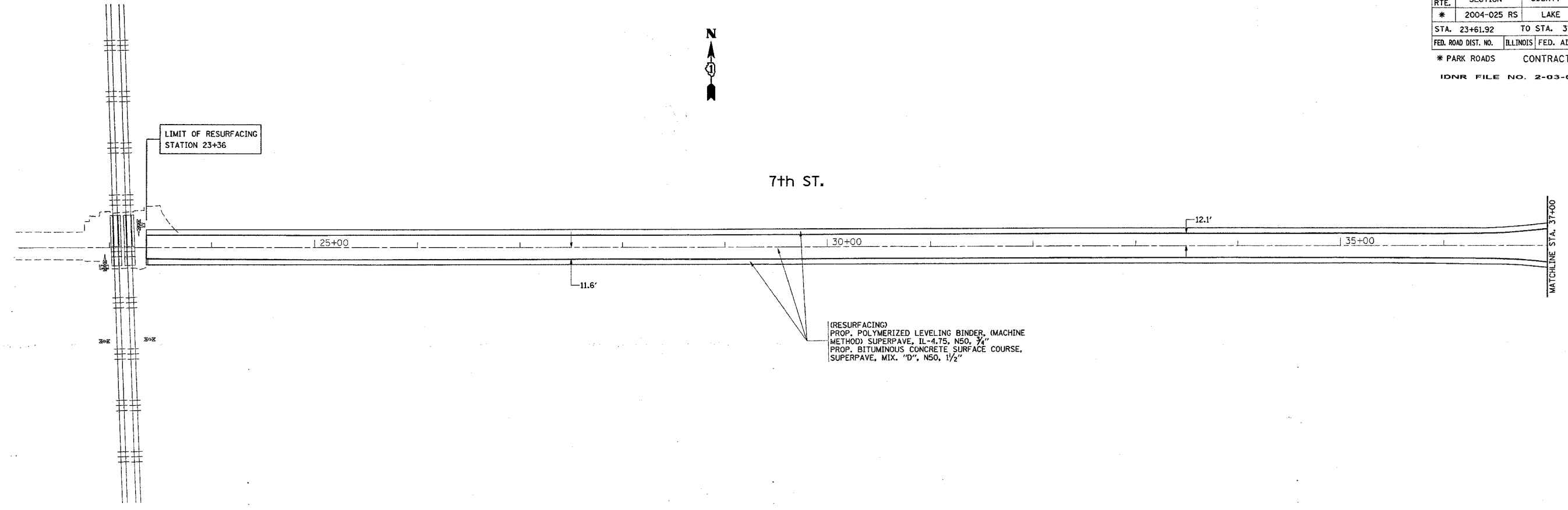

NORTH POINT MARINA
7TH STREET
PROP. ROADWAY PLAN AND PROFILE
SCALE: VERT. 5
HORIZ. 50
DRAWN BY: CAD
DATE: 11/28/2005