

*REF-topcat
 *REF-pfyat1
 *REF-pfyat1a
 *REF-pfyat2

F.A. RTE.	SECTION	COUNTY	TOTAL SHEETS	SHEET NO.
* 2004-025 RS	LAKE		116	40
STA. TO STA.				
FED. ROAD DIST. NO.		ILLINOIS FED. AID PROJECT		
* PARK ROADS		CONTRACT NO. 62745		
		IDNR FILE NO. 02-03-025A		

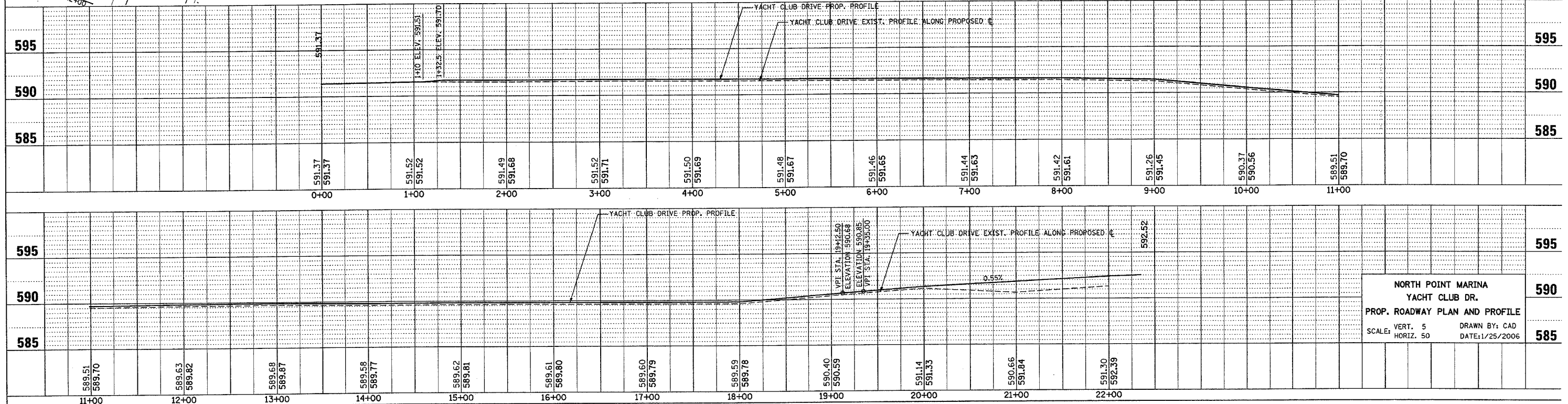
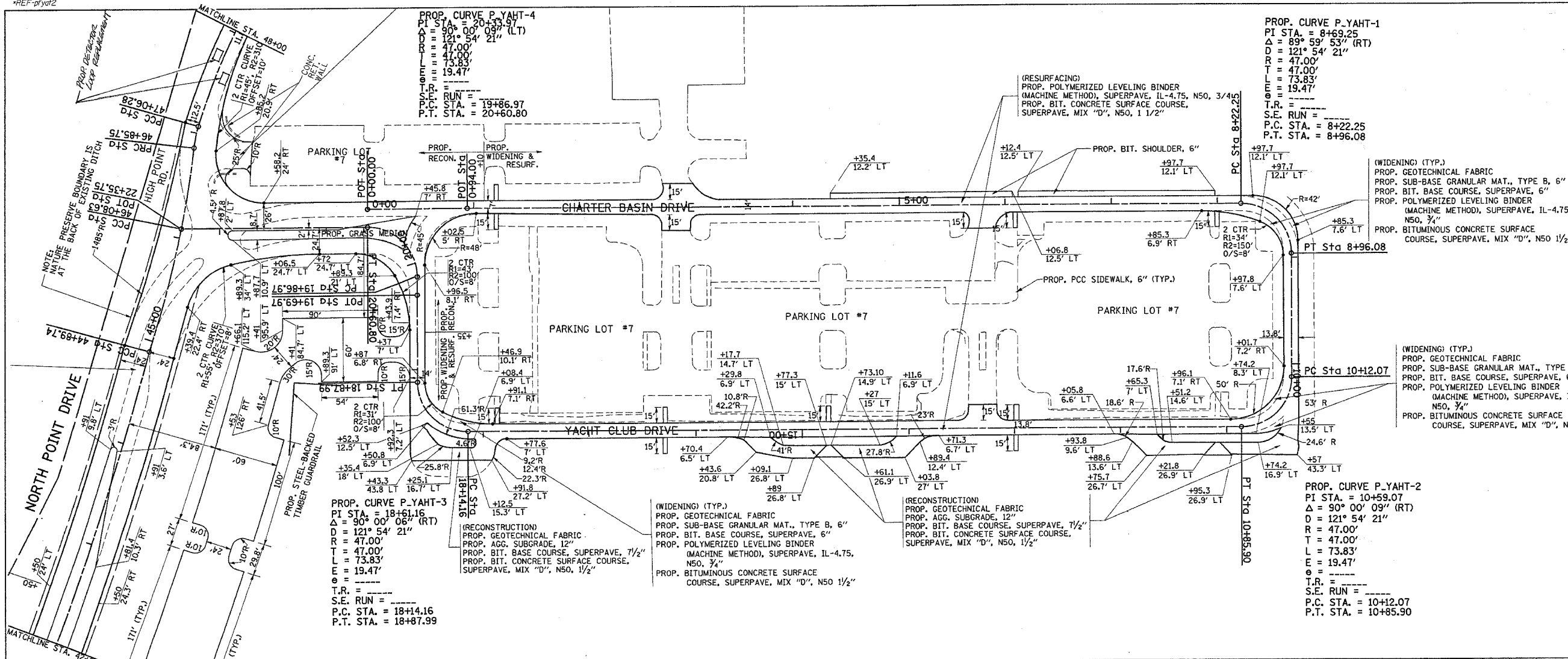

NORTH POINT MARINA
 YACHT CLUB DR.
 PROP. ROADWAY PLAN AND PROFILE
 SCALE: VERT. 5
 HORIZ. 50
 DRAWN BY: CAD
 DATE: 1/25/2006