

*REF-PMK08

F.A. RTE.	SECTION	COUNTY	TOTAL SHEETS	SHEET NO.
* 2004-025 RS	LAKE	116	66	
STA. 0+00		TO STA. 22+35		
FED. ROAD DIST. NO.	ILLINOIS	FED. AID PROJECT		
* PARK ROADS		CONTRACT NO. 62745 IDNR FILE NO. 2-03-0254		

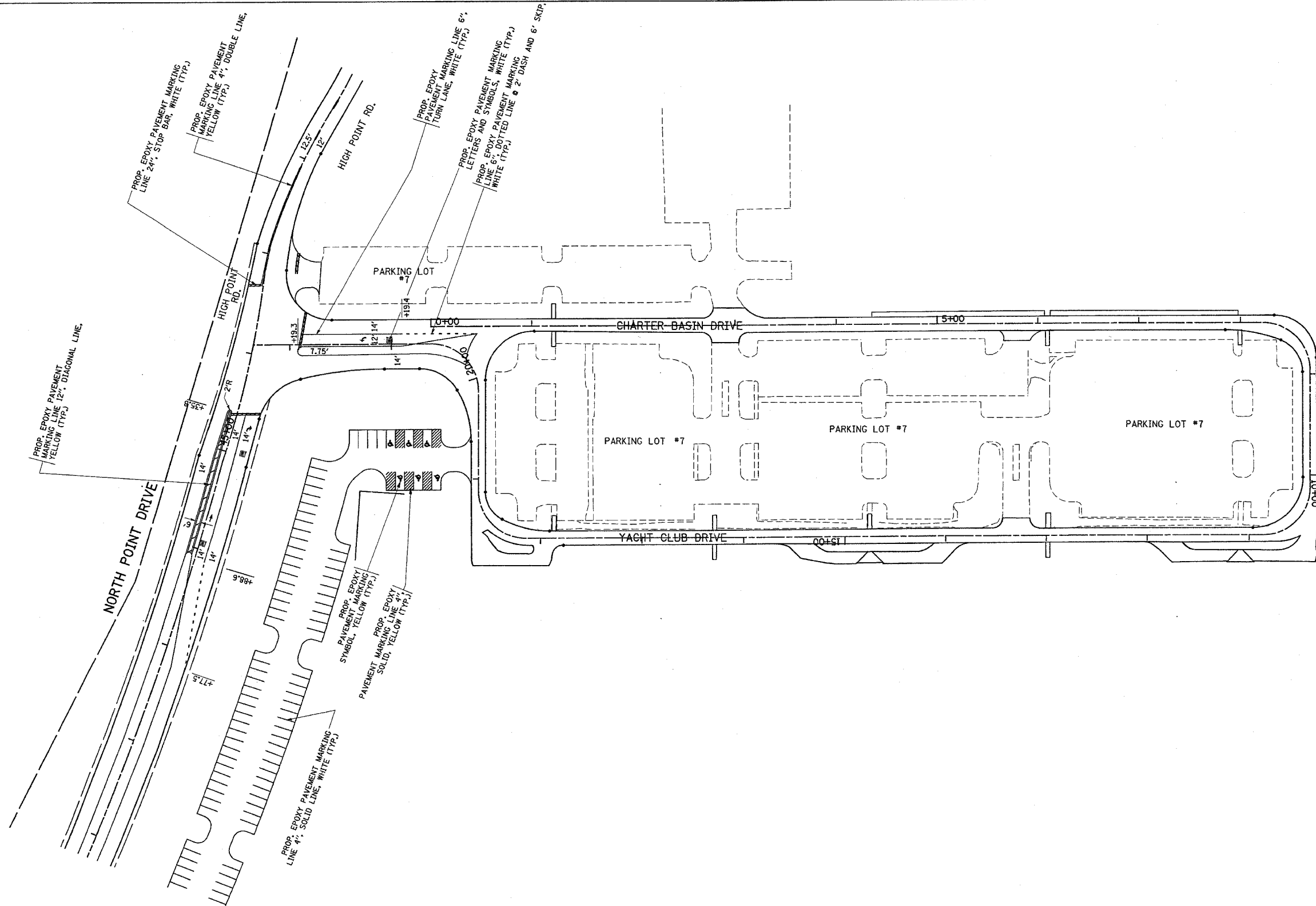

NOTE: FOR PARKING LOT DEMENSIONS SEE "PARKING LOT PAVEMENT MARKING" DETAIL

REVISIONS	
NAME	DATE

ILLINOIS DEPARTMENT OF TRANSPORTATION
PAVEMENT MARKING PLAN
NORTH POINT MARINA
YACHT CLUB DRIVE

SCALE: VERT. 1"=50'
 HORIZ. 1"=50'
 DATE 1/9/2006

DRAWN BY
 CHECKED BY