

F.A.P. RTE.	SECTION	COUNTY	TOTAL SHEETS	SHEET NO.
342	(G & 12) 1-N-1	LAKE	10	10
STA.		TO STA.		
FED. ROAD DIST. NO.		ILLINOIS FED. AID PROJECT		

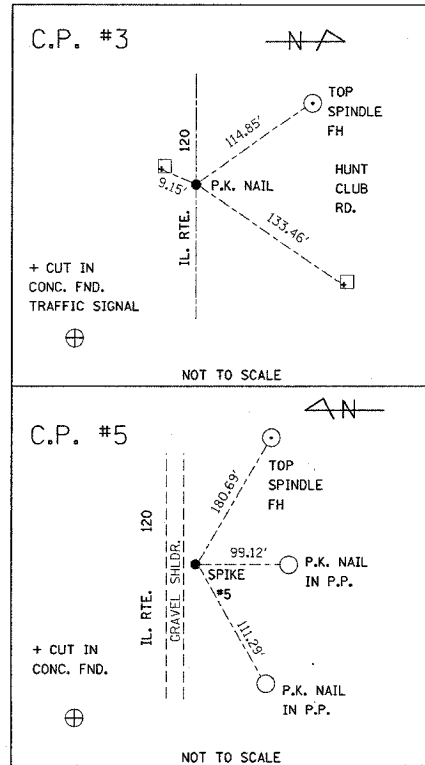

EXIST. CURVE E-IL120-1
 PI STA. = 89+27.49
 $\Delta = 4^\circ 19' 05''$ (LT)
 $D = 0^\circ 59' 28''$
 $R = 5,781.16'$
 $T = 217.95'$
 $L = 435.69'$
 $E = 4.11'$
 $e =$
 T.R. =
 S.E. RUN =
 P.C. STA. = 87+09.54
 P.T. STA. = 91+45.23

ILLINOIS ROUTE 120
 (BELVIDERE ROAD)

HUNT CLUB ROAD

