

F.A.P. RTE.	SECTION	COUNTY	TOTAL SHEETS	SHEET NO.
342	(G & I2) 1-N-1	LAKE	70	24
STA. 89+00		TO STA. 103+00		
FED. ROAD DIST. NO.		ILLINOIS FED. AID PROJECT		

PIN # 07-33-100-001
STATE OF ILLINOIS
DEPARTMENT OF TRANSPORTATION

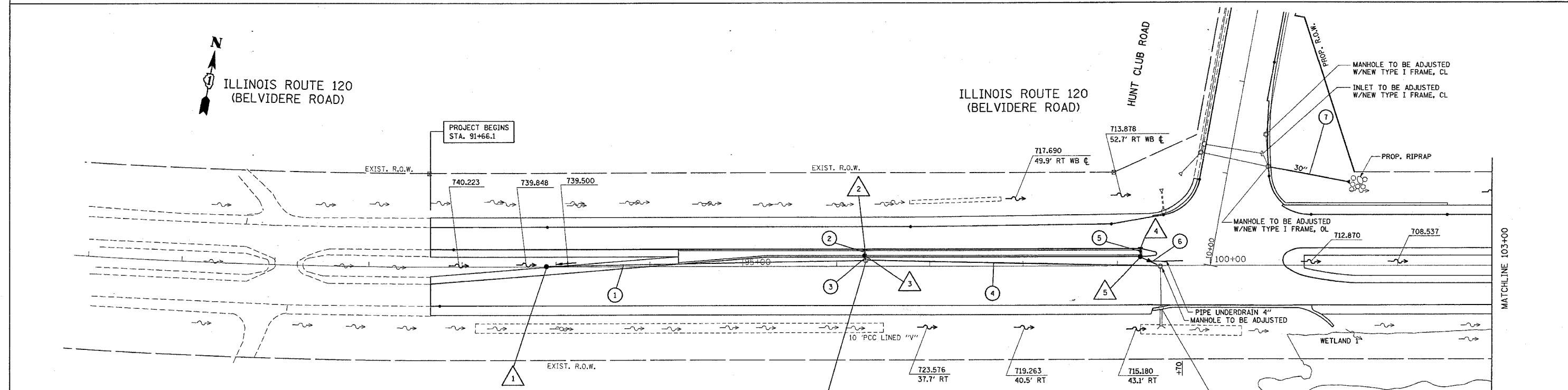
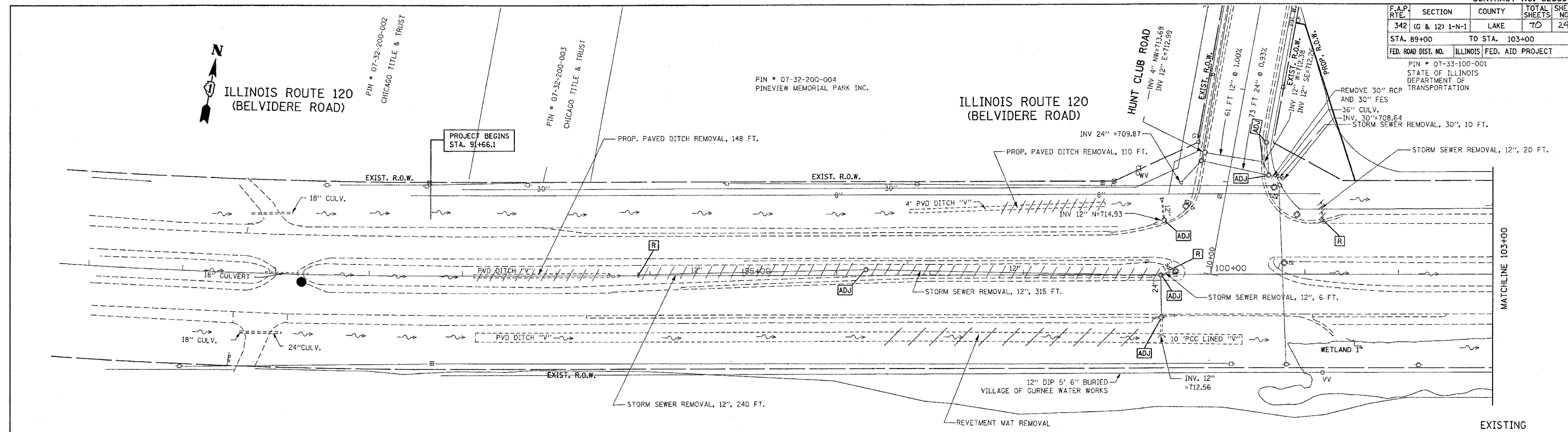

- 1 STA. 92+90, CL CATCH BASIN, TYPE C W/TYPE B, GRATE T.O.G. = 739.00 INV. = 733.15 (E)
- 2 STA. 96+30, EOP INLET, TYPE A W/TYPE 24, FRAME & GRATE T.O.G. = 729.799 INV. = 726.30 (S)

- 3 STA. 96+30, EOP, WB CATCH BASIN, TYPE C W/TYPE 24, FRAME & GRATE T.O.G. = 729.457 INV. = 725.31 (S) INV. = 726.24 (N)
- 4 STA. 99+25, EOP, EB INLET, TYPE A W/TYPE 24, FRAME & GRATE T.O.G. = 719.830 INV. = 716.33 (S)

- 5 STA. 99+25, EOP, EB CATCH BASIN, TYPE C W/TYPE 24, FRAME & GRATE T.O.G. = 719.565 INV. = 713.520 (SE)

- 1 PROP. STORM SEWER, CLASS A, TYPE II, 15", 343 FT T. B. F. = 275
- 2 PROP. STORM SEWER, CLASS A, TYPE II, 12", 8 FT T. B. F. = 2.9
- 3 PROP. STORM SEWER, CLASS A, TYPE II, 12", 5 FT T. B. F. = 1.8
- 4 PROP. STORM SEWER, CLASS A, TYPE II, 15", 315 FT T. B. F. = 251

- 5 PROP. STORM SEWER, CLASS A, TYPE II, 12", 8 FT T. B. F. = 5.4
- 6 PROP. STORM SEWER, CLASS A, TYPE II, 12", 20 FT T. B. F. = 15.5
- 7 PROP. STORM SEWER, CLASS A, TYPE I, 30" 85 FT W/PRECAST REINFORCED CONCRETE FLARED END, 30" INV. = 705.00

REVISIONS	
NAME	DATE

ILLINOIS DEPARTMENT OF TRANSPORTATION
**IL. RTE. 120 AT HUNT CLUB RD.
DRAINAGE PLAN**

SCALE: VERT. 1"=50'
HORIZ. 1"=50'
DATE 10/16/2006

DRAWN BY
CHECKED BY

PLOT DATE: 10/16/2006
 FILE NAME: c:\p\100\1003\1003.dwg
 PLOT SCALE: 500000 / 1"
 USER NAME: bawerf