

F.A.P. RTE.	SECTION	COUNTY	TOTAL SHEETS	SHEET NO.
342	(G & 12) 1-N-1	LAKE	20	25
STA. 103+00		TO STA. 111+00		
FED. ROAD DIST. NO.		ILLINOIS FED. AID PROJECT		

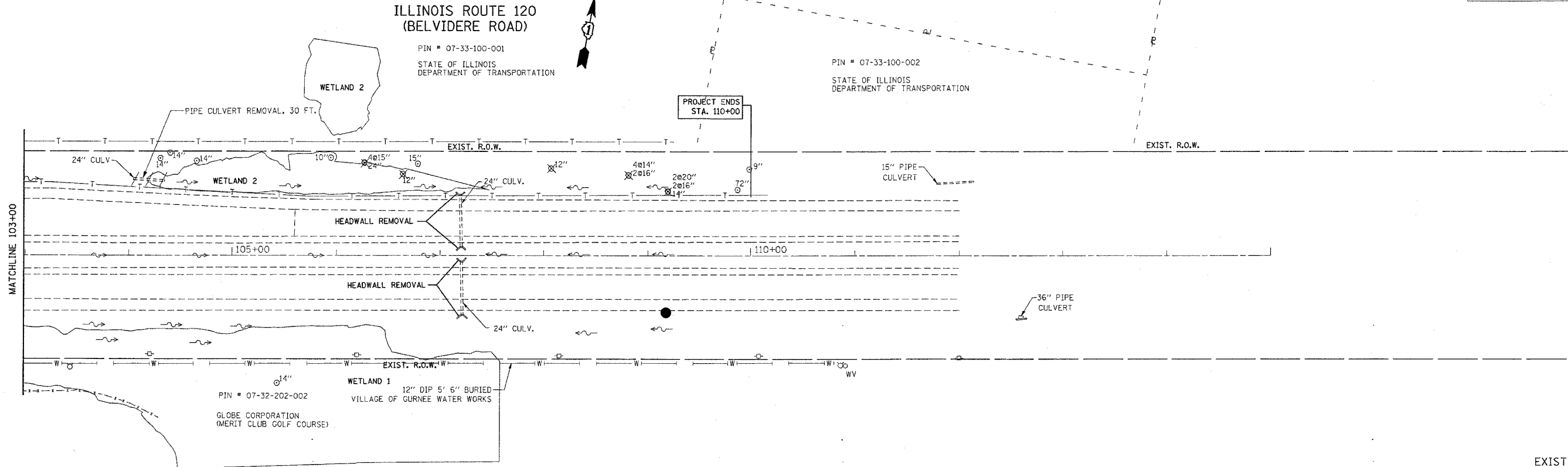

EXISTING

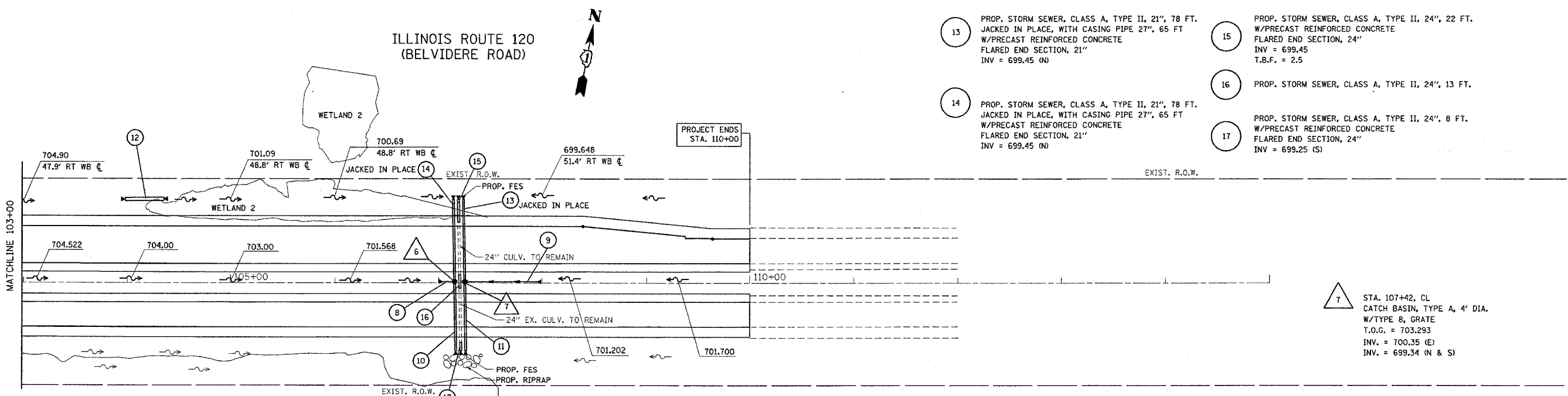

PROPOSED

- 13 PROP. STORM SEWER, CLASS A, TYPE II, 21", 78 FT. JACKED IN PLACE, WITH CASING PIPE 27", 65 FT W/PRECAST REINFORCED CONCRETE FLARED END SECTION, 21" INV = 699.45 (N)
- 14 PROP. STORM SEWER, CLASS A, TYPE II, 21", 78 FT. JACKED IN PLACE, WITH CASING PIPE 27", 65 FT W/PRECAST REINFORCED CONCRETE FLARED END SECTION, 21" INV = 699.45 (N)
- 15 PROP. STORM SEWER, CLASS A, TYPE II, 24", 22 FT. W/PRECAST REINFORCED CONCRETE FLARED END SECTION, 24" INV = 699.45 T.B.F. = 2.5
- 16 PROP. STORM SEWER, CLASS A, TYPE II, 24", 13 FT.
- 17 PROP. STORM SEWER, CLASS A, TYPE II, 24", 8 FT. W/PRECAST REINFORCED CONCRETE FLARED END SECTION, 24" INV = 699.25 (S)

- 8 PROP. STORM SEWER, CLASS A, TYPE I, 12", 10 FT W/PRECAST REINFORCED CONCRETE FLARED END SECTION, 12" INV = 700.650
- 9 PROP. STORM SEWER, CLASS A, TYPE I, 12", 69 FT W/PRECAST REINFORCED CONCRETE FLARED END SECTION, 12" INV = 701.037
- 10 PROP. STORM SEWER, CLASS A, TYPE II, 21", 66 FT. W/PRECAST REINFORCED CONCRETE FLARED END SECTION, 21" INV = 699.25 (S) T.B.F. = 18.9
- 11 PROP. STORM SEWER, CLASS A, TYPE II, 21", 66 FT. W/PRECAST REINFORCED CONCRETE FLARED END SECTION, 21" INV = 699.25 (S) T.B.F. = 18.9
- 12 PROP. PIPE CULVERT, CLASS A, TYPE I, 30", 38 FT. W/2 FLARED END SECTION INV = 701.50 (E) INV = 701.90 (W)

- T STA. 107+42, CL CATCH BASIN, TYPE A, 4' DIA. W/TYPE B, GRATE T.O.G. = 703.293 INV. = 700.35 (E) INV. = 699.34 (N & S)
- 6 STA. 107+25, CL CATCH BASIN, TYPE A, 4' DIA. W/TYPE B, GRATE T.O.G. = 703.293 INV. = 700.35 (W) INV. = 699.34 (N & S)

REVISIONS	
NAME	DATE

ILLINOIS DEPARTMENT OF TRANSPORTATION
**IL. RTE. 120 AT HUNT CLUB RD.
 DRAINAGE PLAN**

SCALE: VERT. 1"=50'
 HORIZ. 1"=50'
 DATE 10/15/2006
 DRAWN BY
 CHECKED BY

PLOT DATE: 10/15/2006
 FILE NAME: C:\PROJ\103000\103000.dwg
 PLOT SCALE: 1"=50'
 USER NAME: JPH/103