

F.A.U. RTE.	SECTION	COUNTY	TOTAL SHEETS	SHEET NO.
5564	111-M-1	WHITESIDE	78	22
STA.		TO STA.		
FED. ROAD DIST. NO.		ILLINOIS FED. AID PROJECT		

BOBBY J. ROBBINS

PAUL BARTOLOMEI

RODNEY G. KLECKLER

GUILLERMO SILVA

JOHN E. GAFFEY

PAUL D. TYLER

AHMAD FARRAJ

WEDAD FARRAJ

PAUL I. HARVEY

EVELYN M. BANNICK

X = TREE REMOVAL

CONTAMINATED SOIL LOCATION

50'-PIPE CULVERTS, CLASS D, TYPE 1, 15"
2 EACH END SECTIONS 15"

4' BITUMINOUS SHOULDERS

50'-PIPE CULVERTS, CLASS D, TYPE 1, 15"
2 EACH END SECTIONS 15"

ABANDON ENTRANCE
STA 1546+64

PROPOSED R.O.W.

EXIST ROW

CONST LIMITS

44' - PIPE CULVERTS, CLASS D, TYPE 1, 15"
2 EACH END SECTIONS 15"

ABANDON ENTRANCE
STA 1546+97

40'-PIPE CULVERTS, CLASS D, TYPE 1, 15"
2 EACH END SECTIONS 15"

MATCH LINE STA. 1543+50

MATCH LINE STA. 1548+50

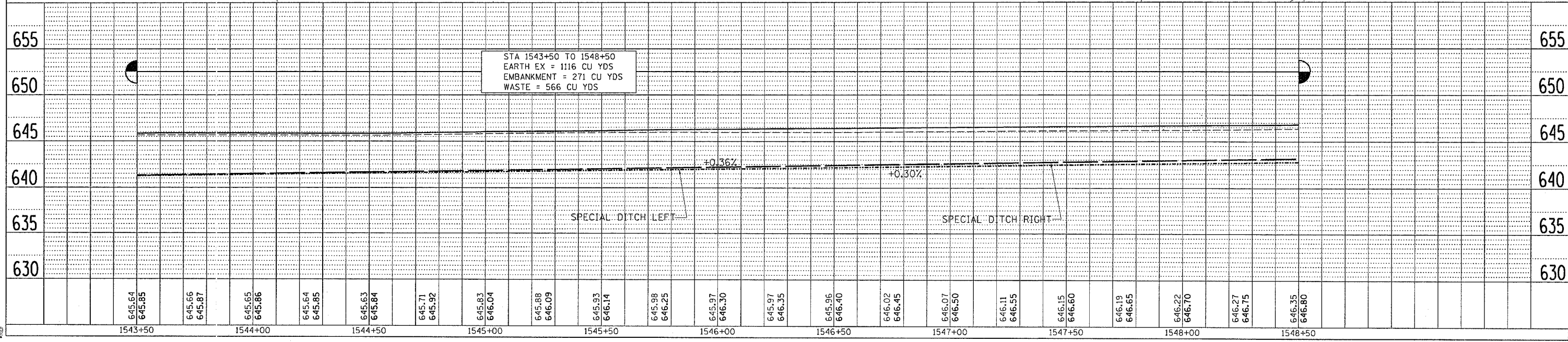
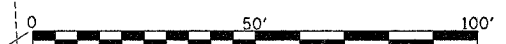
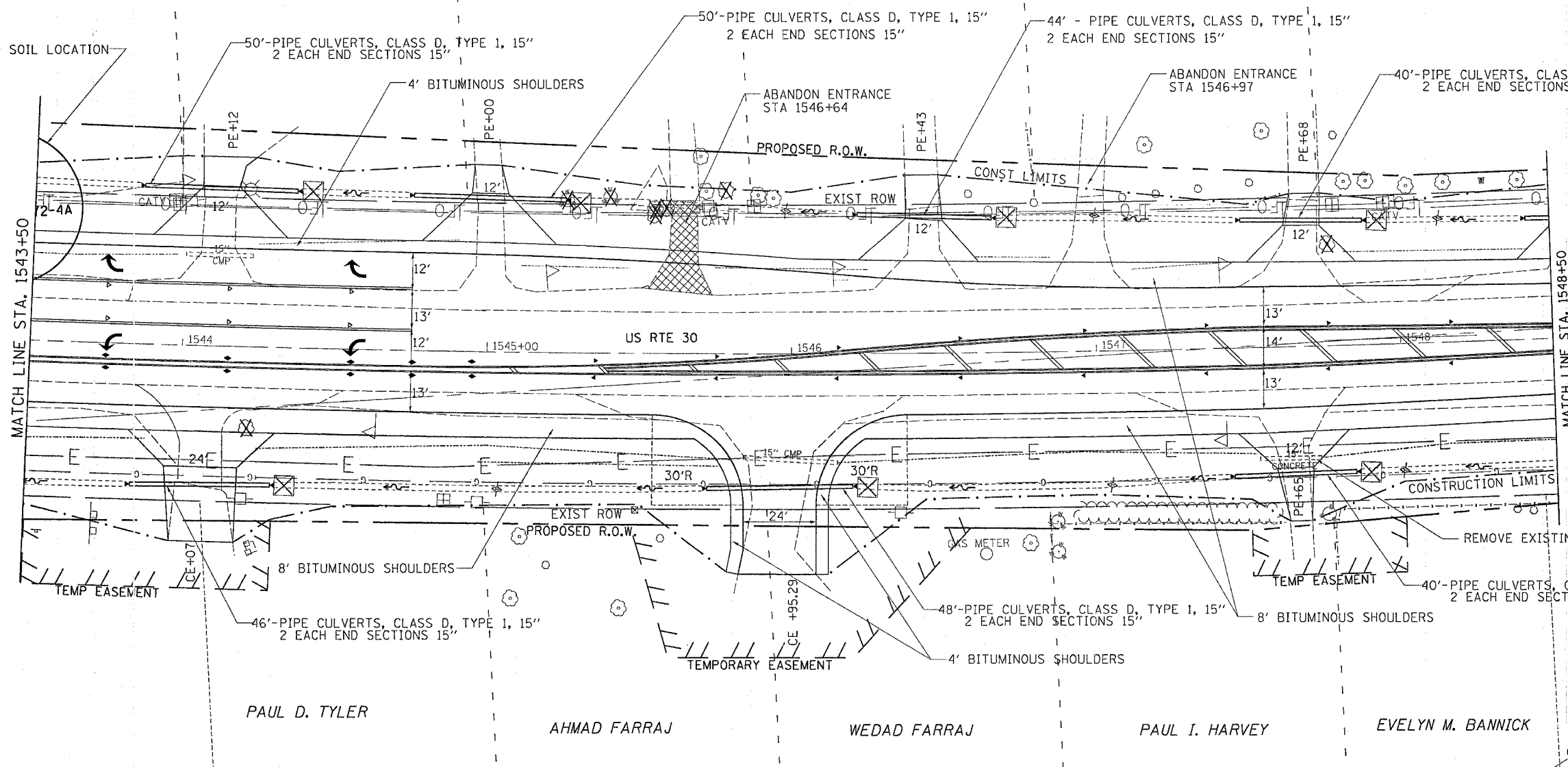

STA 1543+50 TO 1548+50
EARTH EX = 1116 CU YDS
EMBANKMENT = 271 CU YDS
WASTE = 566 CU YDS

DATE	BY

DATE	BY

DATE TIME
DRAWN BY
CHECKED BY
DATE TIME
REF 13
REF