

F.A.I. RTE.	SECTION	COUNTY	TOTAL SHEETS	SHEET NO.
80	37-1HBR-1	HENRY	133	24
STA.		TO STA.		
FED. ROAD DIST. NO.		ILLINOIS FED. AID PROJECT		

EXISTING HORIZONTAL & VERTICAL CONTROL

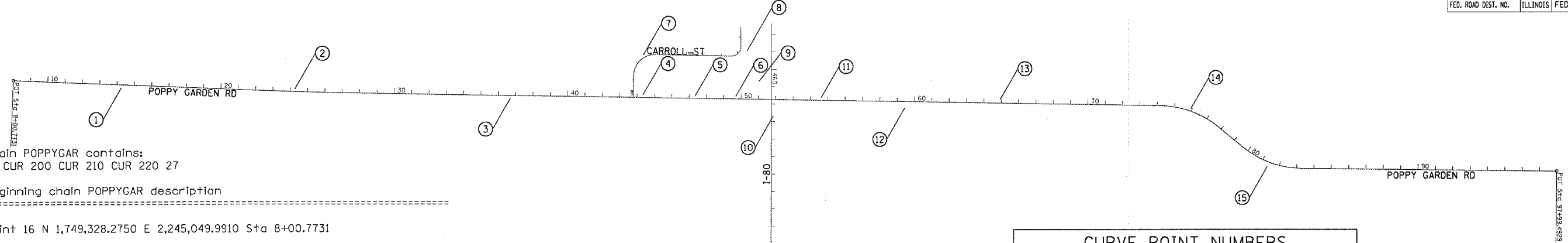

Chain POPPYGAR contains:
16 CUR 200 CUR 210 CUR 220 27

Beginning chain POPPYGAR description

Point 16 N 1,749,328.2750 E 2,245,049.9910 Sta 8+00.7731

Course from 16 to PC 200 92° 23' 04.7695" Dist 1,365.8555'

Curve Data

Curve 200
P.I. Station 24+90.8572 N 1,749,257.9538 E 2,246,738.6115
Delta = 1° 23' 08.0644" (LT)
Degree = 0° 12' 49.2577"
Tangent = 324.2286'
Length = 648.4257'
Radius = 26,813.4852'
External = 1.9602'
Long Chord = 648.4099'
Mid. Ord. = 1.9601'
P.C. Station 21+66.6286 N 1,749,271.4443 E 2,246,414.6637
P.T. Station 28+15.0543 N 1,749,252.3004 E 2,247,062.7909
C.C. N 1,776,061.7092 E 2,247,530.3225

Course from PT 200 to PC 210 90° 59' 56.7051" Dist 4,600.6055'

Curve Data

Curve 210
P.I. Station 76+10.9805 N 1,749,168.6765 E 2,251,857.9881
Delta = 38° 45' 28.9166" (RT)
Degree = 10° 19' 05.2569"
Tangent = 195.3208'
Length = 375.6305'
Radius = 555.2924'
External = 33.3500'
Long Chord = 368.5095'
Mid. Ord. = 31.4605'
P.C. Station 74+15.6598 N 1,749,172.0822 E 2,251,662.6970
P.T. Station 77+91.2903 N 1,749,043.7621 E 2,252,008.1433
C.C. N 1,748,616.8742 E 2,251,653.0146

Course from PT 210 to PC 220 129° 45' 25.6216" Dist 159.8876'

Curve Data

Curve 220
P.I. Station 81+48.2892 N 1,748,815.4490 E 2,252,282.5907
Delta = 39° 05' 50.1993" (LT)
Degree = 10° 19' 16.3060"
Tangent = 197.1114'
Length = 378.8057'
Radius = 555.1273'
External = 33.9561'
Long Chord = 371.4989'
Mid. Ord. = 31.9988'
P.C. Station 79+51.1778 N 1,748,941.5085 E 2,252,131.0589
P.T. Station 83+29.9835 N 1,748,813.1790 E 2,252,479.6890
C.C. N 1,749,368.2696 E 2,252,486.0819

Course from PT 220 to 27 90° 39' 35.4223" Dist 1,469.5094'

Point 27 N 1,748,796.2560 E 2,253,949.1010 Sta 97+99.4929

Ending chain POPPYGAR description

CURVE	PI	CC	PC	PT
200	200	201	202	203
210	210	211	212	213
220	220	221	222	223

SURVEY WORK POINTS

POINT	NORTH	EAST	ELEVATION	CHAIN	STATION	OFFSET	DESCRIPTION
100	1749250.7830	2248204.4720	608.0250	POPPYGAR	39+56.5883	18.3897' LT	SURVEY POINT, PIN
101	1749202.8360	2249049.3590	621.4820	POPPYGAR	48+02.1829	14.8182' RT	SURVEY POINT, PIN
102	1749199.9840	2249211.7340	625.6640	POPPYGAR	49+64.5829	14.8385' RT	SURVEY POINT, PIN

BENCH MARKS

POINT	NORTH	EAST	ELEVATION	CHAIN	STATION	OFFSET	DESCRIPTION
401	1749335.5410	2245264.3900	586.2580	POPPYGAR	10+14.6841	16.1804' LT	WALL, CROSS CUT
403	1749266.0770	2247792.3290	608.6080	POPPYGAR	35+44.2413	26.4951' LT	TELEPHONE POLE, RAILROAD SPIKE
411	1749223.6600	2249529.0850	629.0030	POPPYGAR	52+81.4728	14.3673' LT	SIDEWALK, PLUG
903333	1752406.9530	2249430.7550	609.8590	POPPYGAR	51+27.6525	3195.4619' LT	GPS CONTROL POINT, PIN
903334	1750219.5480	2249403.5260	608.1410	POPPYGAR	51+38.5682	1007.9146' LT	GPS CONTROL POINT, PIN
903335	1748306.4600	2249423.7560	606.9390	POPPYGAR	51+92.1525	904.5298' RT	GPS CONTROL POINT, PIN
AH3000	1738758.4740	2247391.8410	690.7510	POPPYGAR	33+27.0293	10486.4936' RT	TD2-NETWORK MONUMENT, PERMANENT SURVEY MARKER

APPARENT PROPERTY CORNERS

POINT	NORTH	EAST	ELEVATION	CHAIN	STATION	OFFSET	DESCRIPTION
700	1749206.0860	2247941.3530	608.3500	POPPYGAR	36+94.2886	30.8884' RT	PROPERTY CORNER, PIN
701	1749204.0700	2248111.4920	608.8600	POPPYGAR	38+64.4369	29.9374' RT	PROPERTY CORNER, PIN
702	1749267.3340	2248103.9180	608.8750	POPPYGAR	38+55.7610	33.1849' LT	PROPERTY CORNER, PIN
703	1749291.0090	2248881.5980	606.5020	POPPYGAR	46+32.9099	70.4162' LT	PROPERTY CORNER, PIN
704	1749504.5520	2248713.0460	607.9440	POPPYGAR	44+60.6601	280.9878' LT	PROPERTY CORNER, PIN
705	1749436.8610	2248743.1400	607.4730	POPPYGAR	44+91.9299	213.8319' LT	PROPERTY CORNER, PIN
706	1749435.1750	2248883.0860	606.4460	POPPYGAR	46+31.8840	214.5863' LT	PROPERTY CORNER, PIN
707	1749428.6200	2249212.7820	607.7600	POPPYGAR	49+61.6441	213.7810' LT	PROPERTY CORNER, PIN
708	1749494.6360	2249212.9290	607.0090	POPPYGAR	49+60.6400	279.7895' LT	PROPERTY CORNER, PIN
709	1749295.0910	2249211.7520	608.4440	POPPYGAR	49+62.9426	80.2543' LT	PROPERTY CORNER, PIN
710	1749157.3720	2250866.3350	610.3230	POPPYGAR	66+19.6754	28.5937' RT	PROPERTY CORNER, PIN

FILE NAME = 111111
LEVELS = 111111
PLOT SCALE = 1"=100'
PLOT DATE = 11/11/11
OPERATOR = J. J. J.
REF =
REF =