

F.A.P. RTE.	SECTION	COUNTY	TOTAL SHEETS	SHEET NO.
505	115BR-1	WINNEBAGO	36	1

# STATE OF ILLINOIS DEPARTMENT OF TRANSPORTATION DIVISION OF HIGHWAYS PLANS FOR PROPOSED FEDERAL AID HIGHWAY

FAP ROUTE 505 (IL 75)  
SECTION 115BR-1  
OVER TIMOTHY CREEK  
WINNEBAGO COUNTY  
PROJECT NO. BRF-0505(018)

**C-92-083-06**  
R. 1 E. 3rd P.M.

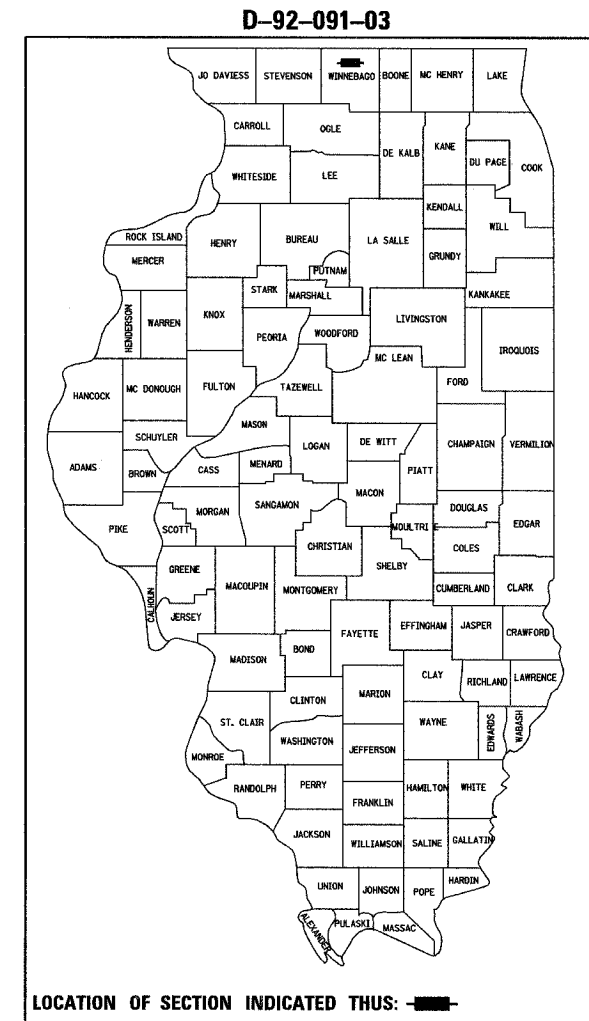

INDEX OF SHEETS

1.	COVER SHEET
2.	GENERAL NOTES
3.	SUMMARY OF QUANTITIES
4.	TYPICAL SECTIONS
5.	VERTICAL AND HORIZONTAL CONTROL
6.-7.	SCHEDULE OF QUANTITIES
8.	PLAN AND PROFILE IL RTE 75
9.	TRAFFIC CONTROL PLANS
10.-19.	STRUCTURAL PLANS
20.-21.	SOIL BORINGS
22.-29.	EXISTING BRIDGE PLANS (FOR INFORMATION ONLY)
30.	DETAIL OF BITUMINOUS SHOULDER AT GUARD RAIL (23.4)
	BITUMINOUS SHOULDER (23.4A)
31.	EROSION CONTROL DETAILS FOR SILT FENCE (29.2)
	DELINEATOR AND POST ORIENTATION (37.4)
	WITNESS MARKER FOR PERMANENT SURVEY MARKERS, TYPE II (38.4)
	INFORMATIONAL WARNING SIGN (FOR NARROW TRAVEL LANES) (39.4)
	STOP LINE SIGN FOR TEMPORARY SIGNALS (99.4)
32.-35.	CROSS SECTIONS
31A	WITNESS MARKER + PERMANENT SURVEY MARKERS, TYPE II (66.2)

HIGHWAY STANDARDS

000001-04	STANDARD SYMBOLS, ABBREVIATIONS AND PATTERNS
001001-01	AREA OF REINFORCEMENT BARS
280001-03	TEMPORARY EROSION CONTROL SYSTEMS
482001-01	BITUMINOUS SHOULDER ADJACENT TO FLEXIBLE PAVEMENT
515001-02	NAME PLATE FOR BRIDGES
630001-07	STEEL PLATE BEAM GUARDRAIL
630201-04	PCC/BITUMINOUS STABILIZATION AT STEEL PLATE BEAM GUARDRAIL
630301-04	SHOULDER WIDENING FOR TYPE 1 (SPECIAL) GUARDRAIL TERMINALS
635001	DELINEATORS
635006-02	REFLECTOR AND TERMINAL MARKER PLACEMENT
635011-01	REFLECTOR MARKER AND MOUNTING DETAILS
667101	PERMANENT SURVEY MARKERS
701006-02	OFF-ROAD OPERATIONS, 2L, 2W 4.5 M (15') TO 600 MM (24") FROM EDGE OF PAVEMENT
701011-01	OFF-ROAD OPERATIONS 2L, 2W, DAY ONLY
701301-02	LANE CLOSURE, 2L, 2W, SHORT TIME OPERATIONS
701306-01	LANE CLOSURE, 2L, 2W, SLOW MOVING OPERATIONS DAY ONLY, FOR SPEEDS ≥ 45 MPH
701311-02	LANE CLOSURE, 2L, 2W, MOVING OPERATIONS-DAY ONLY
701321-08	LANE CLOSURE, 2L, 2W, BRIDGE REPAIR WITH BARRIER
701326-02	LANE CLOSURE, 2L, 2W, PAVEMENT WIDENING, FOR SPEEDS ≥ 45 MPH
702001-06	TRAFFIC CONTROL DEVICES
704001-03	TEMPORARY CONCRETE BARRIER
720011	METAL POSTS FOR SIGNS, MARKERS AND DELINEATORS
780001-01	TYPICAL PAVEMENT MARKINGS
781001-02	TYPICAL APPLICATIONS RAISED REFLECTIVE PAVEMENT MARKERS

TRAFFIC DATA  
HIGHWAY CLASSIFICATION: RURAL MINOR ARTERIAL  
2008 ADT = 2700  
DESIGN SPEED 55 MPH  
POSTED SPEED 55 MPH

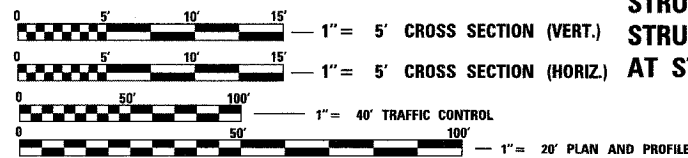

FULL SIZE PLANS HAVE BEEN PREPARED USING STANDARD ENGINEERING SCALES. REDUCED SIZED PLANS WILL NOT CONFORM TO STANDARD SCALES. IN MAKING MEASUREMENTS ON REDUCED PLANS, THE ABOVE SCALES MAY BE USED.

J.U.L.I.E.  
JOINT UTILITY LOCATION INFORMATION FOR EXCAVATION  
1-800-892-0123

CONTRACT NO. 64940

IMPROVEMENT BEGINS  
STA. 60 + 06

SECTION 115BR-1  
INCLUDES THE REMOVAL OF EXISTING STRUCTURE NO. 101-0114 AND CONSTRUCTION OF THE NEW STRUCTURE 101-0183, A THREE SIDED STRUCTURE OVER TIMOTHY CREEK AT STA 63 + 23.20

IMPROVEMENT ENDS  
STA. 65 + 90

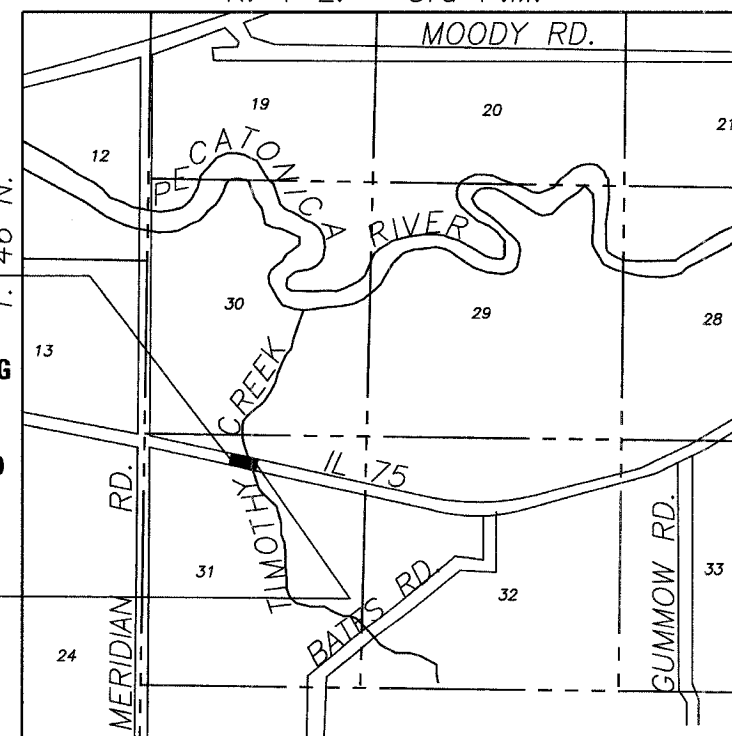

NET LENGTH OF SECTION 584 FEET (0.111 MILES)  
GROSS LENGTH OF SECTION 584 FEET (0.111 MILES)

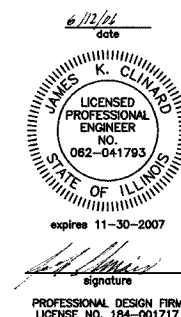
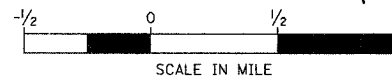

CHAMLIN & ASSOCIATES  
PERU ILLINOIS MORRIS

STATE OF ILLINOIS  
DEPARTMENT OF TRANSPORTATION  
DIVISION OF HIGHWAYS

SUBMITTED June 22, 2006  
Deputy Director of Highways, Region Engineer  
August 18, 2006  
Engineer of Design and Environment  
August 18, 2006  
Director of Highways, Chief Engineer

DISTRICT 2 DIXON IL  
PRINTED BY THE AUTHORITY  
OF THE STATE OF ILLINOIS

PROJECT ENGINEER  
BECKY MARRUFFO

SQUAD LEADER  
THOMAS HALLA 815-284-5993

SENIOR SQUAD LEADER  
MIKE YUSEF 815-284-5354

JAMES K. CLINARD  
CHAMLIN & ASSOCIATES  
815-223-3344