

CONTRACT NO. 64940				
F.A.P. RTE.	SECTION	COUNTY	TOTAL SHEETS	SHEET NO.
505	115BR-1	WINNEBAGO	35	9
STA.		TO STA.		
FED. ROAD DIST. NO. -		ILLINOIS FED. AID PROJECT		

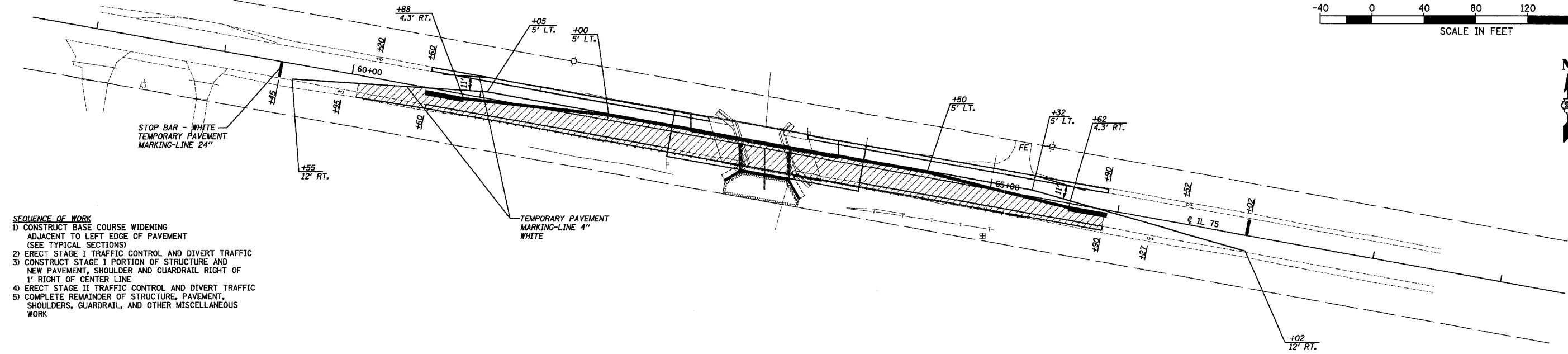
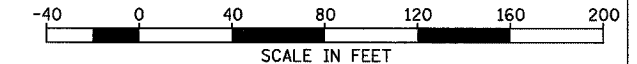

- SEQUENCE OF WORK**
- 1) CONSTRUCT BASE COURSE WIDENING ADJACENT TO LEFT EDGE OF PAVEMENT (SEE TYPICAL SECTIONS)
 - 2) ERECT STAGE I TRAFFIC CONTROL AND DIVERT TRAFFIC
 - 3) CONSTRUCT STAGE I PORTION OF STRUCTURE AND NEW PAVEMENT, SHOULDER AND GUARDRAIL RIGHT OF 1' RIGHT OF CENTER LINE
 - 4) ERECT STAGE II TRAFFIC CONTROL AND DIVERT TRAFFIC
 - 5) COMPLETE REMAINDER OF STRUCTURE, PAVEMENT, SHOULDERS, GUARDRAIL, AND OTHER MISCELLANEOUS WORK

STAGE I

NOTES

1. ADVANCE WARNING SIGNS, BARRIER WALL TREATMENT AND PAVEMENT MARKERS SHALL BE IN ACCORDANCE WITH HIGHWAY STANDARD 701321
2. FOR ADDITIONAL DETAILS SEE HIGHWAY STANDARD 701321
3. R10-6A-2430 SIGN AT STOP BAR SHALL BE SUPPLEMENTED WITH "TO ACTUATE SIGNAL" SIGN SEE SHEET 31

LEGEND

- TEMPORARY CONCRETE BARRIER
- TEMPORARY TRAFFIC SIGNAL
- IMPACT ATTENUATORS
- WORK AREA

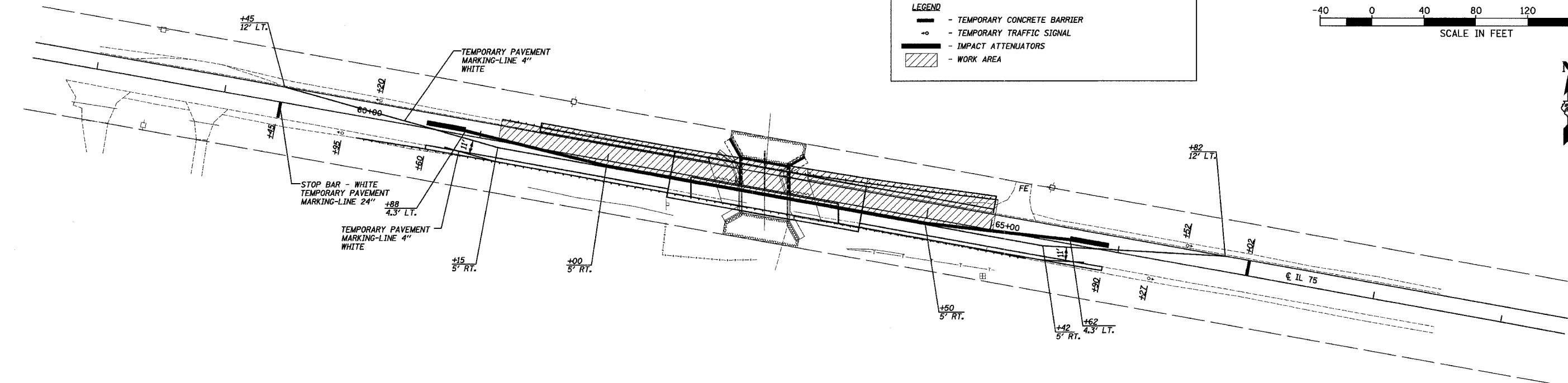
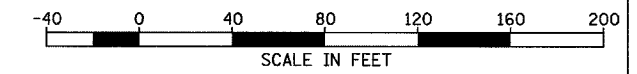

STAGE II

REVISIONS	
NAME	DATE

ILLINOIS DEPARTMENT OF TRANSPORTATION
 TRAFFIC CONTROL PLAN
 FAP 505 (IL 75)
 SECTION 115BR-1
 WINNEBAGO COUNTY

SCALE: VERT. 1" = 40'
 HORIZ. 1" = 40'
 DATE 03/06
 DRAWN BY NOE
 CHECKED BY JKC

PLOT DATE = 04/06
 FILE NAME = Z09103TRAFPCNTL
 PLOT SCALE = 1" = 40'
 USER NAME = CHMS