

F.A.P. RTE.	SECTION	COUNTY	TOTAL SHEETS	SHEET NO.
301	(2,3,4)RS	WINNEBAGO	46	29
STA.		TO STA.		
FED. ROAD DIST. NO.	ILLINOIS	FED. AID PROJECT		

# PAVEMENT PATCHING FOR HOT-MIX ASPHALT SURFACED PAVEMENT

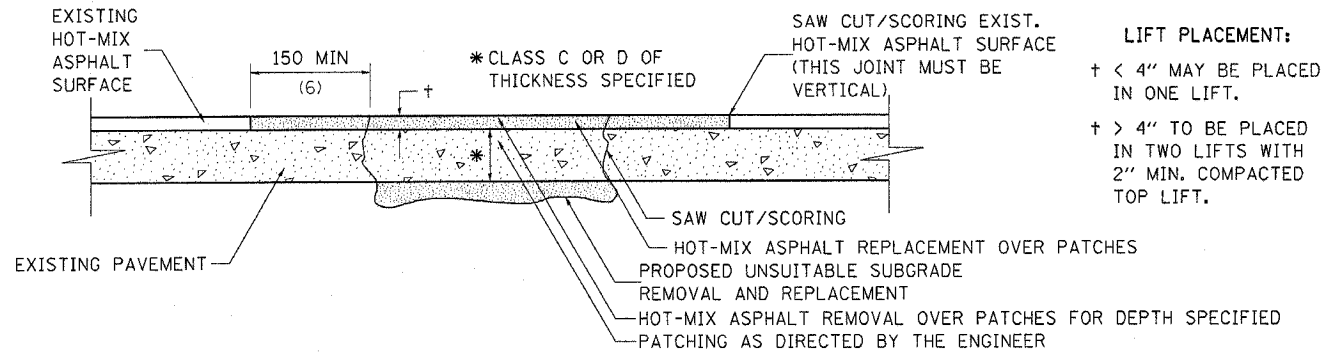

**SEQUENCE OF CONSTRUCTION:**

1. REMOVE THE EXISTING HOT-MIX ASPHALT SURFACE.
2. RESIDENT ENGINEER WILL DETERMINE IF LOCATION IS TO BE PATCHED OR TO ONLY REPLACE HOT-MIX ASPHALT SURFACE.
3. REMOVE AND REPLACE FULL DEPTH PATCHES AT LOCATIONS DIRECTED BY THE ENGINEER.
4. REPLACE HOT-MIX ASPHALT SURFACE OVER FULL DEPTH PATCHES AND AT LOCATIONS OF HOT-MIX ASPHALT SURFACE REMOVAL.

**GENERAL NOTES:**

1. THE WIDTH OF THE FULL DEPTH PATCH OVER A TRENCH SHALL BE 300 (12) WIDER ON EACH SIDE OF THE TRENCH.
2. FOR BASIS OF PAYMENT: SEE SPECIAL PROVISION "PATCHING WITH HOT-MIX ASPHALT OVERLAY REMOVAL".

ALL DIMENSIONS ARE IN MILLIMETERS (INCHES) UNLESS OTHERWISE NOTED.

**PAVEMENT PATCHING FOR HOT-MIX ASPHALT SURFACED PAVEMENT 32.4**

REVISED 10-10-06

# AERIAL SPEED CHECK ZONES

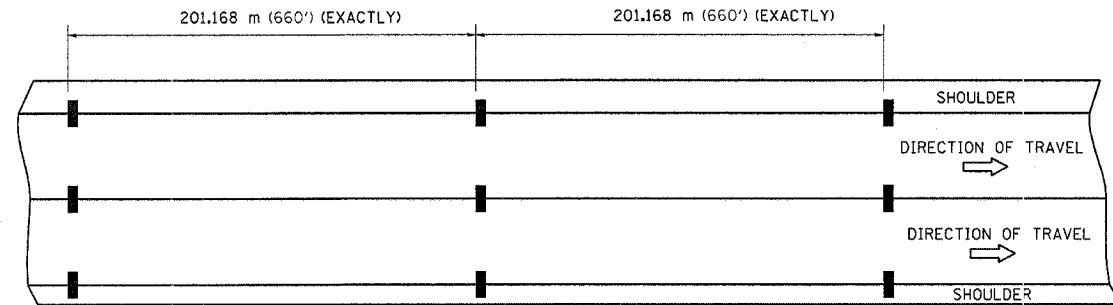

ALWAYS USE PREFORMED THERMOPLASTIC PAVEMENT MARKINGS

**POLICE AERIAL SPEED CHECK ZONES**

ESTABLISHED ZONES AND NEW ZONES REQUESTED BY THE ILLINOIS STATE POLICE SHALL BE MARKED CONSISTENT WITH THE REQUIREMENTS OF SECTION 38-23 OF THE MUTCD. WHEN NEW ZONES ARE PLACED IT WILL BE NECESSARY TO HAVE A REPRESENTATIVE OF THE STATE POLICE PRESENT SO THAT THE ACCURACY OF THE MEASUREMENT CAN BE ATTESTED TO IN COURT.

**PAVEMENT MARKING DETAIL**

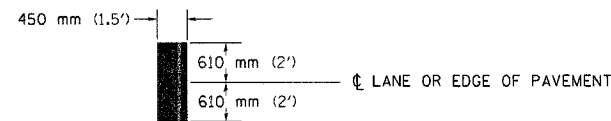

**AERIAL SPEED CHECK ZONES 46.4**

REVISED 2-7-05

# TYPICAL MEDIAN CROSSOVER CLOSURE (WITH EMERGENCY OPENING)

**GENERAL NOTES**

WOOD POSTS, CABLE, AND SIGN SUPPORTS SHALL BE IN ACCORDANCE WITH SECTION 634 & 636 OF THE STANDARD SPECIFICATIONS FOR ROAD AND BRIDGE CONSTRUCTION. THE PANELS SHALL BE ANCHORED TO THE (3/8) CABLE IN SUCH A MANNER SO THEY CANNOT SLIDE ALONG THE CABLE.

THE REFLECTIVE SHEETING USED FOR THE PANELS SHALL MEET THE REQUIREMENTS OF SECTION 1091 OF THE STANDARD SPECIFICATIONS FOR ROAD & BRIDGE CONSTRUCTION AND SHALL BE ON BOTH SIDES.

ALL PANELS SHALL HAVE ALTERNATING REFLECTORIZED WHITE & RED STRIPES SLOPING DOWNWARD AT 45° TOWARD THE SIDE ON WHICH TRAFFIC WILL PASS AND ON BOTH SIDES OF PANEL. THE DRILLING OF 75 (3) AND 100 (4) HOLES SHALL BE INCIDENTAL TO THE MEDIAN CLOSURE.

THIS WORK SHALL BE PAID FOR AT THE CONTRACT UNIT PRICE EACH FOR MEDIAN CLOSURE.

ALL DIMENSIONS ARE IN MILLIMETERS (INCHES) UNLESS OTHERWISE NOTED.

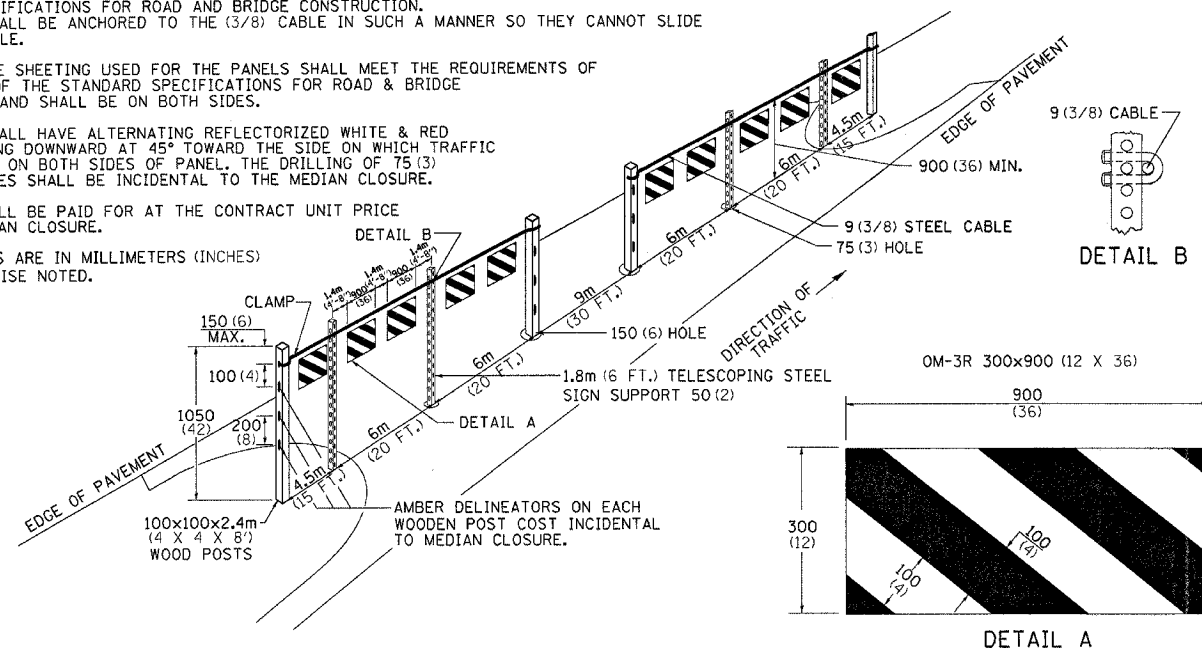

**TYPICAL MEDIAN CROSSOVER CLOSURE (WITH EMERGENCY OPENING) 87.4**

REVISED 10-10-06

# SUBGRADE REPLACEMENT

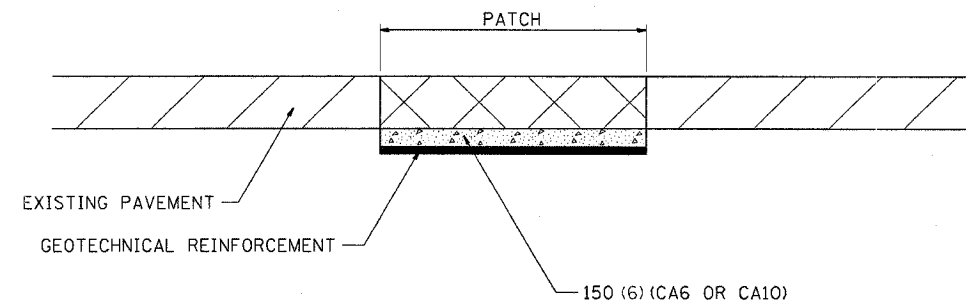

**NOTES:**

GRANULAR SUBGRADE REPLACEMENT and per m<sup>2</sup> (SQ. YD.) for

3 (CU. YD.)

ALL DIMENSIONS ARE IN MILLIMETERS (INCHES) UNLESS OTHERWISE NOTED.

**SUBGRADE REPLACEMENT 97.4**

REVISED 4-23-93

PLOT DATE = Mon Oct 16 14:31:11 2006  
 FILE NAME = P:\Excel\NUS28\uningham\391\3-28-06\F1e1e1f-0a0a0a0a\28690501.dgn  
 PLOT SCALE = 1:1000000  
 REFERENCE = 0