

F.A.P. RTE.	SECTION	COUNTY	TOTAL SHEETS	SHEET NO.
734	(77-1)TS-3	WINNEBAGO	10	1

- INDEX OF SHEETS**  
**1 COVER SHEET**  
**INDEX OF SHEETS STANDARDS**  
**2 -3 SUMMARY OF QUANTITIES**  
**4 UTILITIES**  
**GENERAL NOTES**  
**5 IL 2 WITH UNION ST SIGNAL MODIFICATION PLANS**  
**6 IL 2 WITH UNION ST CABLE DETAILS**  
**7 IL 2 WITH PRAIRIE HILL SIGNAL MODIFICATION PLANS**  
**8 IL 2 WITH PRAIRIE HILL CABLE DETAIL**  
**9 IL 2 WITH IL 75 NOTES AND PHASING**  
**10 SERVICE INSTALLATION DETAIL SIGN DETAIL**

**STATE OF ILLINOIS**  
**DEPARTMENT OF TRANSPORTATION**  
**DIVISION OF HIGHWAYS**  
**PROPOSED**  
**HIGHWAY PLANS**

**FAP ROUTE 734 (IL 2)**  
**SECTION (77-1)TS-3**  
**PROJECT HSIP-0734 (040)**  
**WINNEBAGO COUNTY**  
**C-92-014-07**

**LOCATION OF INTERSECTIONS**  
**IL 2 WITH UNION ST- ROCKTON**  
**IL 2 WITH PAIRIE HILL - SOUTH BELOIT**  
**IL 2 WITH IL 75 - SOUTH BELOIT**

- STANDARDS
- 701006-02 OFF-ROAD OPERATIONS 2L, 2W, 4.5 m (15') TO 600 mm (24") FROM PAVEMENT EDGE
  - 701101-01 OFF-ROAD OPERATIONS, MULTILANE LESS 4.5 m (15') TO 600 mm (24") FROM PAVEMENT EDGE
  - 701301-02 LANE CLOSURE, 2L, 2W, SHORT TIME OPERATIONS
  - 701501-03 URBAN LANE CLOSURE, 2L, 2W, UNDIVIDED
  - 701701-04 URBAN LANE CLOSURE MULTILANE INTERSECTION
  - 702001-06 TRAFFIC CONTROL DEVICES
  - 720016-01 MAST ARM MOUNTED STREET NAME SIGNS
  - 805001 ELECTRICAL SERVICE INSTALLATION DETAILS
  - 814006-01 DOUBLE HANDHOLES
  - 857001 STANDARD DESIGNATION DIAGRAM AND PHASE SEQUENCE
  - 877011-02 STEEL COMBINATION MAST ARM ASSEMBLY AND POLE
  - 878001-05 CONCRETE FOUNDATION DETAILS
  - 880006 TRAFFIC SIGNAL MOUNTING DETAILS

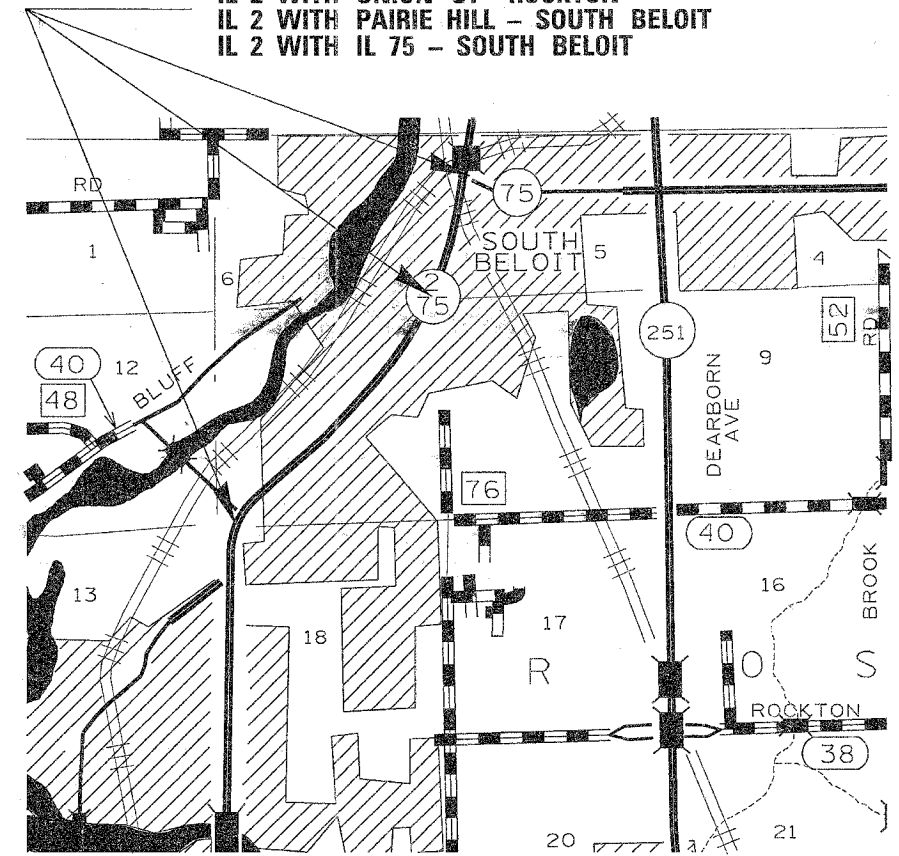

T46N-R.1-2E

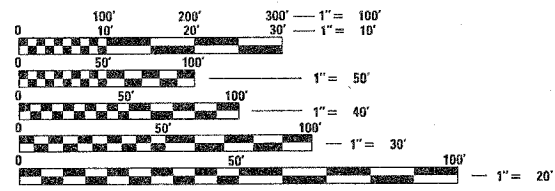

FULL SIZE PLANS HAVE BEEN PREPARED USING STANDARD ENGINEERING SCALES. REDUCED SIZED PLANS WILL NOT CONFORM TO STANDARD SCALES. IN MAKING MEASUREMENTS ON REDUCED PLANS, THE ABOVE SCALES MAY BE USED.

J.U.L.I.E.  
 JOINT UTILITY LOCATION INFORMATION FOR EXCAVATION  
 1-800-892-0123

**CONTRACT NO. 64C54**

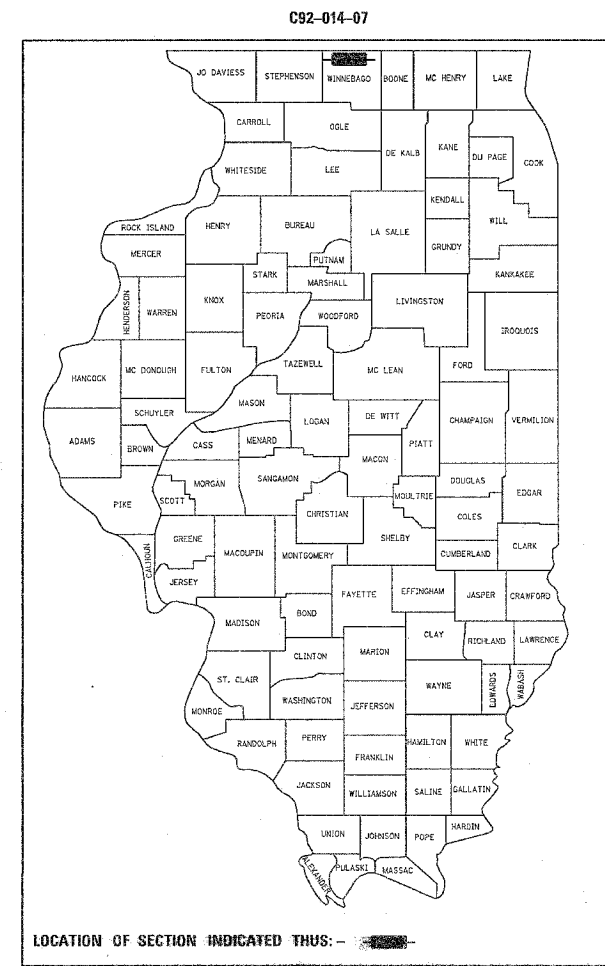

LOCATION OF SECTION INDICATED THUS: [Symbol]

STATE OF ILLINOIS  
 DEPARTMENT OF TRANSPORTATION  
 DIVISION OF HIGHWAYS

SUBMITTED October 23, 2006

Joseph E. Crowe  
 DEPUTY DIRECTOR OF HIGHWAYS, REGION ENGINEER

December 8, 2006  
Eric E. Hahn  
 INTERIM ENGINEER OF DESIGN AND ENVIRONMENT

December 8, 2006  
Milton R. See, P.E.  
 DIRECTOR OF HIGHWAYS, CHIEF ENGINEER

**PRINTED BY THE AUTHORITY**  
**OF THE STATE OF ILLINOIS**

F.A.P. RIE.	SECTION	COUNTY	TOTAL SHEETS	SHEET NO.
734	(77-1)TS-3	WINNEBAGO	10	2
STA.		TO STA.		
FED. ROAD DIST. NO.		ILLINOIS FED. AID PROJECT		

TABULATION OF QUANTITIES FOR IL 2 @ UNION ST, PRAIRIE HILL RD AND IL 76							
PAY CODE	ITEM	UNIT	UNION 90% FED. 5% ST. 5% VILLAGE OF ROCKTON	PRAIRIE HILL 90% FED. 10% WINNEBAGO CO.	IL 76 90% FED. 10% STATE	URBAN Y031-1F TOTAL	
44003900	MEDIAN SURFACE REMOVAL AND REPLACEMENT	SQ FT	450	40	0	490	
67100100	MOBILIZATION	L SUM	0.4	0.5	0.1	1	
70100450	TRAFFIC CONTROL AND PROTECTION, STANDARD 701201	L SUM	0.4	0.5	0.1	1	
70102635	TRAFFIC CONTROL AND PROTECTION, STANDARD 701701	L SUM	0.4	0.5	0.1	1	
* 72000100	SIGN PANEL - TYPE I	SQ FT	0	18	0	18	
80501000	SERVICE INSTALLATION, (SPECIAL)	EACH	1	1	0	2	
81400300	DOUBLE HANDHOLE	EACH	1	1	0	2	
81702110	ELECTRIC CABLE IN CONDUIT, 600V (XLP TYPE USE) I/C No 10	FOOT	0	1800	0	1800	
82103400	LUMINAIRE, SODIUM VAPOR, HORIZONTAL MOUNT, PHOTO-CELL CONTROL, 400 WATT	EACH	0	2	0	2	
85000300	MAINTENANCE OF EXISTING TRAFFIC SIGNAL INSTALLATION	L SUM	0.4	0.5	0.1	1	
85700100	FULL-ACTUATED CONTROLLER AND TYPE III CABINET	EACH	0	0	1	1	
85700200	FULL-ACTUATED CONTROLLER AND TYPE IV CABINET	EACH	1	1	0	2	
87301215	ELECTRIC CABLE IN CONDUIT, SIGNAL, NO. 14 2C	FOOT	366	0	0	366	
87301225	ELECTRIC CABLE IN CONDUIT, SIGNAL, NO. 14 3C	FOOT	752	0	0	752	
87301245	ELECTRIC CABLE IN CONDUIT, SIGNAL, NO. 14 5C	FOOT	2929	2453	0	5382	
87301255	ELECTRIC CABLE IN CONDUIT, SIGNAL, NO. 14 7C	FOOT	1838	1322	0	3160	
87301815	ELECTRIC CABLE IN CONDUIT, SERVICE, NO 6 3C	FOOT	25	26	0	51	
87502490	TRAFFIC SIGNAL POST GALVANIZED STEEL 15 FT	EACH	2	0	0	2	
87702920	STEEL COMBINATION MAST ARM ASSEMBLY AND POLE 38 FT	EACH	0	1	0	1	
87702930	STEEL COMBINATION MAST ARM ASSEMBLY AND POLE 40 FT	EACH	0	1	0	1	
87800100	CONCRETE FOUNDATION, TYPE A	FOOT	3	0	0	3	
87800415	CONCRETE FOUNDATION, TYPE E, 36 INCH	FOOT	0	22	0	22	

\* SPECIALTY ITEM

REVISIONS		ILLINOIS DEPARTMENT OF TRANSPORTATION
NAME	DATE	
		SCALE: VERT. HORIZ. DATE
DRAWN BY		CHECKED BY

SUMMARY OF QUANTIES

Plot Date = Mon Oct 23 07:55:08 2006  
 File Name = c:\p\projects\p281778\c09786\signal plan.dgn  
 Plot Scale = 20.0000 / 1 in.  
 User Name = h31k1

F.A.P. RTE.	SECTION	COUNTY	TOTAL SHEETS	SHEET NO.
734	177-17S-3	WINNEBAGO	10	3
STA.		TO STA.		
FED. ROAD DIST. NO.		ILLINOIS	FED. AID PROJECT	

TABULATION OF QUANTITIES FOR IL 2 @ UNION ST, PRAIRIE HILL RD AND IL 76 CONT.				90% FED. 5% ST. 5% VILLAGE OR ROCKTON	90% FED. 10% WINNEBAGO CO.	90% FED. 10% ST.	URBAN Y031-1F
PAY CODE	ITEM	UNIT	UNION TOTAL	PRAIRIE HILL TOTAL	IL 76 TOTAL	TOTAL	
87800200	CONCRETE FOUNDATION, TYPE D	FOOT	0	4	0	4	
87900200	DRILL EXISTING HANDHOLE	EACH	4	13	0	17	
88040090	SIGNAL HEAD, POLYCARBONATE, LED, 1-FACE, 3-SECTION, MAST-ARM MOUNTED	EACH	4	4	0	8	
88040150	SIGNAL HEAD, POLYCARBONATE, LED, 1-FACE, 5-SECTION, BRACKET MOUNTED	EACH	4	2	0	6	
88040160	SIGNAL HEAD, POLYCARBONATE, LED, 1-FACE, 5-SECTION, MAST-ARM MOUNTED	EACH	0	2	0	2	
88102717	PEDESTRIAN SIGNAL HEAD, LED, 1-FACE, BRACKET MOUNTED, WITH COUNT-DOWN TIMER	EACH	4	0	0	4	
88200100	TRAFFIC SIGNAL BACKPLATE	EACH	4	6	0	10	
88500500	INDUCTIVE LOOP DETECTOR AMPLIFIER	EACH	5	0	0	5	
89502380	REMOVE EXISTING HANDHOLE	EACH	0	2	0	2	
X0324886	CONDUIT INSTALLED, 1 1/4" DIA., NON-METALLIC	FOOT	18	10	0	28	
X0324887	CONDUIT INSTALLED, 2 1/2" DIA., NON-METALLIC	FOOT	10	10	0	20	
X0324888	CONDUIT INSTALLED, 4" DIA., NON-METALLIC	FOOT	309	436	0	745	
X0656300	PAVEMENT REMOVAL AND REPLACEMENT	SQ YD	1	1	0	2	
X4402810	ISLAND SURFACE REMOVAL AND REPLACEMENT	SQ FT	0	500	0	500	
X8140205	MODIFY EXISTING CONCRETE HANDHOLE	EACH	2	0	0	2	
XX003165	VIDEO CAMERA DETECTOR SYSTEM	EACH	0	1	0	1	
XX004440	SIGNAL HEAD, LED, 1-FACE, 3-SECTION, BRACKET MOUNTED, RETROFIT	EACH	4	0	0	4	
XX004441	SIGNAL HEAD, LED, 1-FACE, 3-SECTION, MAST-ARM MOUNTED, RETROFIT	EACH	4	4	0	8	
XX004442	SIGNAL HEAD, LED, 1-FACE, 5-SECTION, BRACKET MOUNTED, RETROFIT	EACH	2	0	0	2	
XX004443	SIGNAL HEAD, LED, 1-FACE, 5-SECTION, MAST-ARM MOUNTED, RETROFIT	EACH	2	0	0	2	
XX004921	PEDESTRIAN PUSHBUTTON, SPECIAL	EACH	2	0	0	2	
XX005703	REMOVE EXISTING TRAFFIC SIGNAL EQUIPMENT, SPECIAL	L SUM	0.4	0.5	0.1	1	

REVISIONS		ILLINOIS DEPARTMENT OF TRANSPORTATION
NAME	DATE	
SCALE:	VERT. HORIZ.	DRAWN BY CHECKED BY
DATE		

PLOT DATE = Mon Oct 23 07:55:18 2006  
 FILE NAME = c:\p\projects\2006\177-17S-3\signal\plan.dgn  
 PLOT SCALE = 20.0000 / 1 IN.  
 USER NAME = RLJLN

F.A.P. RTE.	SECTION	COUNTY	TOTAL SHEETS	SHEET NO.
734	177-DTS-3	WINNEBAGO	10	4
STA.		TO STA.		
FED. ROAD DIST. NO.		ILLINOIS	FED. AID PROJECT	

# GENERAL NOTES - UTILITIES

**GENERAL NOTES:**

1. THE MOUNTING HEIGHT OF THE LUMINAIRES ON THE PROPOSED COMBINATION MAST- ARM ASSEMBLIES AT THE INTERSECTION OF IL 2 WITH PRAIRIE HILL SHALL BE 40' HORIZONTAL MOUNTED WITH A 8' ARM

2. THE PAY ITEM "REMOVE EXISTING TRAFFIC SIGNAL EQUIPMENT" SHALL BE PREFORMED BY THE CONTRACTOR AND SHALL INCLUDE ALL MATERIAL AND LABOR TO COMPLETE. THE FOLLOWING SHALL BE REMOVED AND BY THE CONTRACTOR AND RETAINED BY THE CONTRACTOR FOR SALVAGE VALUE.

- 12 EACH - 1-FACE, 3-SECTION SIGNAL HEAD
- 4 EACH - 1-FACE, PEDESTRAIN SIGNAL HEAD
- 2 EACH - PEDESTRAIN PUSH BUTTON
- 2 EACH - SERVICE DISCONNECT
- 2- EACH CONTROLLER AND CABINET
- 1- EACH CABINET FOUNDATION
- 3 EACH - SIGNAL POST AND FOUNDATION
- ALL LIN FT ELECTRIC CABLE BEING REPLACED

ALL MATERIAL UNMENTIONED ABOVE SHALL BE REMOVED BY THE CONTRACTOR AND RETAINED BY THE CONTRACTOR FOR SALVAGE. ANY HOLES RESULTING FROM REMOVAL OR RELOCATION OF SIGNAL EQUIPMENT SHALL BE PLUGGED.

3. NO SIGNAL WORK SHALL BE ALLOWED UNTIL ALL COMPONENT FOR THE MODIFICATION OF THE SIGNAL AT THE LOCATIONS LISTED IN THIS CONTRACT HAVE ARRIVED AT THE JOB SITE.

4. THE CONTRACTOR SHALL BE RESPONSIBLE FOR PROTECTING UTILITY PROPERTY DURING CONSTRUCTION OPERATIONS AS OUTLINED IN ARTILCE 107.31 OF THE STANDARD SPECIFICATIONS. A MINIMUM OF 48 HOURS ADVANCE NOTICE IS REQUIRED FOR NON-EMERGENCY WORK. THE JULIE NUMBER IS 800-892-0123.

THE FOLLOWING LISTED ARE KNOWN UTILITIES LOCATED WITHIN THE PROJECT LIMITS OR IMMEDIATELY ADJACENT TO THIS PROJECT.

UTILITIES			
NAME	TYPE	TELEPHONE	JULIE MEMBER
MR. DAVE SCHACHT COMMONWEALTH EDISON CO. 123 ENERGY AVE ROCKFORD, IL 61109	ELECTRIC	630-437-2129	YES 800-892-0123
MR. KALIN HINSHAW VERIZON 112 WEST ELM STREET SYCAMORE IL 60178	TELEPHONE	815-895-1515	YES 800-892-0123
MR. JEREMY SCHNACK AT&T 635 - 18TH STREET ROCK ISLAND, IL 61201	TELEPHONE	309-793-4456	YES 800-892-0123
MR. GARY QUADE ALLIANT ENERGY P.O. BOX 77007 MADISON WI 53707-1007	ELECTRIC	563-584-7395	YES 800-892-0123
NICOR GAS CO. 1844 FERRY ROAD NAPERVILLE IL 60563-9600	GAS	630-983-8676	YES 800-892-0123
ME MARK BURKS CITIZENS 225 NORTH BROAD CARLINVILLE IL 62626	TELEPHONE	217-854-4013	YES 800-892-0123
MR. PAUL BAUMANN McLEOD USA 900 COMMERCE DRIVE SUITE 203 OAK BROOK IL 60523	TELEPHONE	217-525-0078	YES 800-892-0123
MR. EDWARD RICE VILLAGE OF ROCKTON 110 E MAIN STREET ROCKTON IL 61072	WATER & SEWER	815-624-7600	NO
MR. BRIAN HEDRINGTON CITY OF SOUTH BELOIT 519 BLACKHAWK BLVD SOUTH BELOIT IL 61080	WATER & SEWER	815-389-3023	NO
MR. KEITH STEWART CHARTER COMMUNICATIONS 1837 PARK AVENUE BELOIT WI 53511	COMMUNICATIONS	608-365-3382	YES 800-892-0123













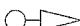

REVISIONS		ILLINOIS DEPARTMENT OF TRANSPORTATION
NAME	DATE	
		SCALE: VERT. HORIZ. DATE
DRAWN BY		CHECKED BY

PLOT DATE = Mon Oct 23 07:55:18 2006  
 FILE NAME = c:\projects\2006\705\99726\signal\_plandgn  
 USER NAME = RJKK1

F.A.P. RTE.	SECTION	COUNTY	TOTAL SHEETS	SHEET NO.
734	(77-1)TS-3	WINNEBAGO	10	5
STA.		TO STA.		
FED. ROAD DIST. NO.	ILLINOIS	FED. AID PROJECT		

# IL 2/UNION ST SIGNAL MODIFICATION PLANS

## LEGEND

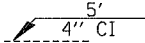
-  EXISTING CONTROLLER
  -  NEW CONTROLLER
  -  EXISTING STEEL MAST ARM ASSEMBLY AND POLE
  -  NEW STEEL MAST ARM ASSEMBLY AND POLE
  -  EXISTING SIGNAL HEAD AND POST
  -  NEW SIGNAL HEAD AND POST
  -  EXISTING SIGNAL HEAD
  -  NEW SIGNAL HEAD WITH BACKPLATE
  -  EXISTING PEDESTRIAN HEAD
  -  NEW PEDESTRIAN HEAD
  -  PEDESTRIAN PUSHBUTTON
  -  EXISTING HANDHOLE
  -  NEW HANDHOLE
  -  NEW DOUBLE HANDHOLE
-  UPPER NUMERAL INDICATES LENGTH  
 LOWER NUMERAL INDICATES SIZE  
 NEW CONDUIT INSTALLED, NON-METALLIC  
 CI INDICATES CONDUIT INSTALLED

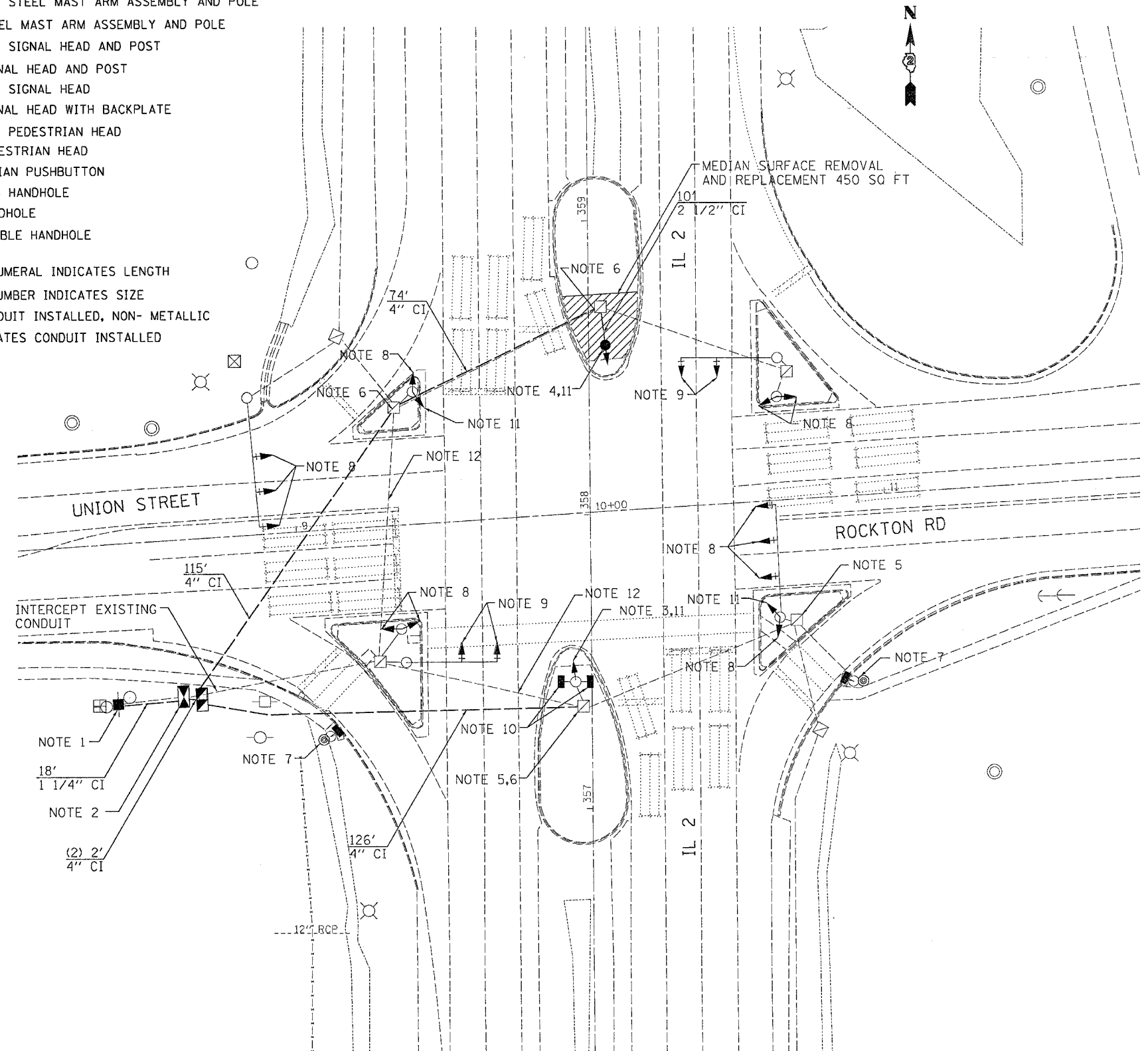

### NOTES:

1. REMOVE EXISTING SERVICE AND INSTALL NEW SERVICE WITH DISCONNECT
2. REMOVE EXISTING CONTROLLER AND CABINET AND INSTALL NEW CONTROLLER AND CABINET ON EXISTING FOUNDATION.
3. REMOVE EXISTING SIGNAL POST AND INSTALL NEW 15' SIGNAL POST ON EXISTING FOUNDATION
4. INSTALL NEW 15' SIGNAL POST AND ON NEW FOUNDATION
5. MODIFY EXISTING HANDHOLE, REPLACE LID
6. DRILL EXISTING HANDHOLE TO RECEIVE NEW CONDUIT INSTALLED
7. REMOVE EXISTING PEDESTRIAN SIGNAL HEAD AND PUSH BUTTONS AND INSTALL NEW COUNTDOWN PEDESTRIAN SIGNAL HEAD AND BULLDOG PEDESTRIAN PUSH BUTTONS
8. RETROFIT EXISTING SIGNAL HEAD WITH LED LENSES
9. REMOVE EXISTING 3-SECTION SIGNAL HEAD AND INSTALL NEW 3-SECTION LED SIGNAL HEADS
10. NEW PEDESTRIAN COUNTDOWN SIGNAL HEADS
11. NEW 5-SECTION SIGNAL HEAD
12. ABANDON EXISTING CONDUIT
13. THE FOLLOWING EXISTING TRAFFIC SIGNAL EQUIPMENT SHALL BE REMOVED BY THE CONTRACTOR AND RETAINED BY HIM/HER FOR SALVAGE.
  - 4 EACH 1-FACE, 3-SECTION SIGNAL HEAD
  - 4 EACH 1-FACE, PEDESTRIAN SIGNAL HEAD
  - 2 EACH PEDESTRIAN PUSH BUTTONS
  - 1 EACH SERVICE DISCONNECT
  - 1 EACH CONTROLLER AND CABINET
  - 1 EACH SIGNAL POST
  - ALL LIN FT ELECTRIC CABLE BEING REPLACED

REVISIONS		ILLINOIS DEPARTMENT OF TRANSPORTATION
NAME	DATE	

SCALE: VERT. \_\_\_\_\_  
 HORIZ. \_\_\_\_\_  
 DATE \_\_\_\_\_ DRAWN BY \_\_\_\_\_  
 CHECKED BY \_\_\_\_\_

PLOT DATE = Mon Oct 23 07:55:08 2006  
 FILE NAME = c:\projects\11081706\11081706signal plan.dgn  
 USER NAME = N1141

F.A.P. RTE.	SECTION	COUNTY	TOTAL SHEETS	SHEET NO.
734	(77-1)TS-3	WINNEBAGO	10	6
STA.		TO STA.		
FED. ROAD DIST. NO.	ILLINOIS	FED. AID PROJECT		

# IL 2 UNION ST CABLE DETAIL



DETECTOR ASSIGNMENT		
DETECTOR	PHASE NO.	DIRECTION
A	8	WB PRESENT
B	3	WB LEFT
C	4	EB PRESENT
D	7	EB LEFT
E	6	NB FAR ADVANCE
F	6	NB PRESENT
G	1	NB LEFT
H	2	SB FAR ADVANCE
I	2	SB PRESENT
J	5	SB LEFT

### PHASE DESIGNATION DIAGRAM

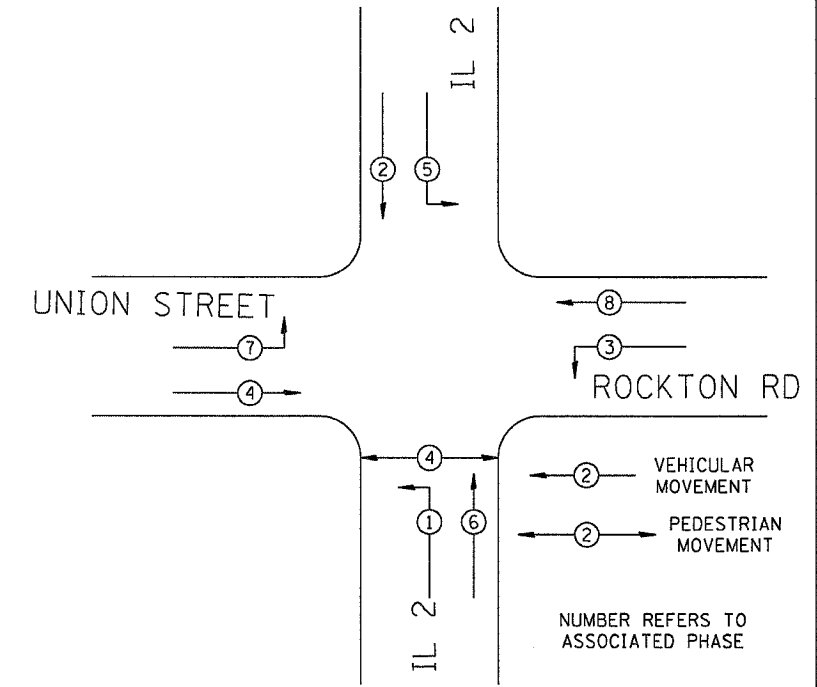

REFER TO STANDARD 857001

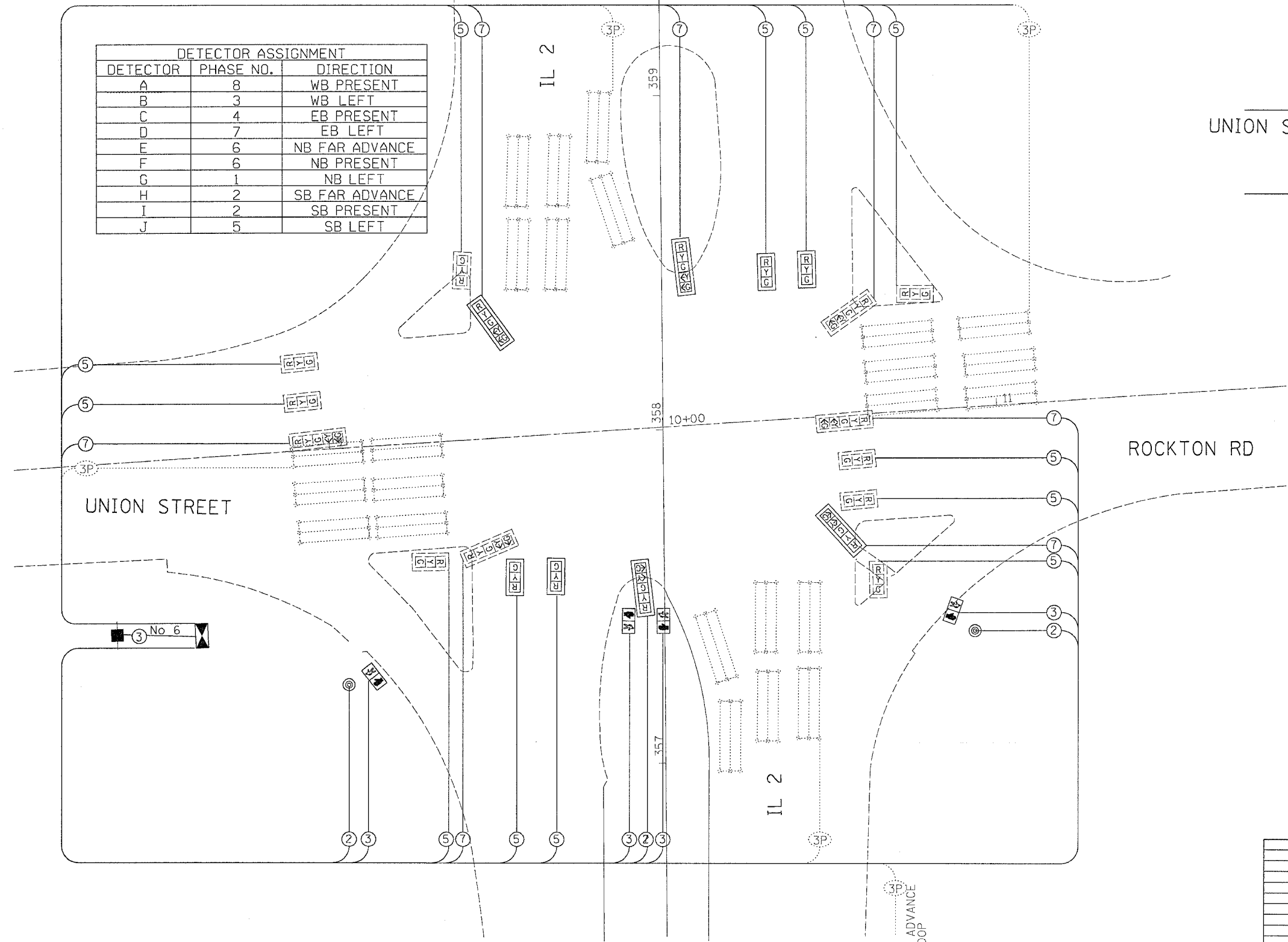

- LEGEND
- (2) INDICATES NUMBER OF NEW CONDUCTORS. ALL CABLE IS NO. 14 EXCEPT AS INDICATED. "P" INDICATES PAIR CABLE
  - [R Y G] NEW SIGNAL HEAD WITH OR WITHOUT BACKPLATE
  - [R Y G] RETROFIT EXISTING SIGNAL HEAD WITH LED WITH OR WITHOUT BACKPLATE
  - [P] NEW COUNTDOWN PEDESTRIAN HEAD - LED
  - (P) PEDESTRIAN PUSHBUTTON
  - ..... EXISTING DETECTION CABLES

REVISIONS	
NAME	DATE

ILLINOIS DEPARTMENT OF TRANSPORTATION

SCALE: VERT.  
HORIZ.  
DATE

DRAWN BY  
CHECKED BY

## IL 2 UNION ST - SIGNAL CABLE DETAIL

PLOT DATE = Mon Oct 23 07:55:18 2006  
 FILE NAME = c:\projects\64c54\64c54\_081706\081706signal\_plendgn  
 USER NAME = N1281

F.A.P. RTE.	SECTION	COUNTY	TOTAL SHEETS	SHEET NO.
734	(77-1)TS-3	WINNEBAGO	10	7
STA.		TO STA.		
FED. ROAD DIST. NO.		ILLINOIS FED. AID PROJECT		

# IL 2/PRAIRIE HILL RD SIGNAL MODIFICATION PLANS

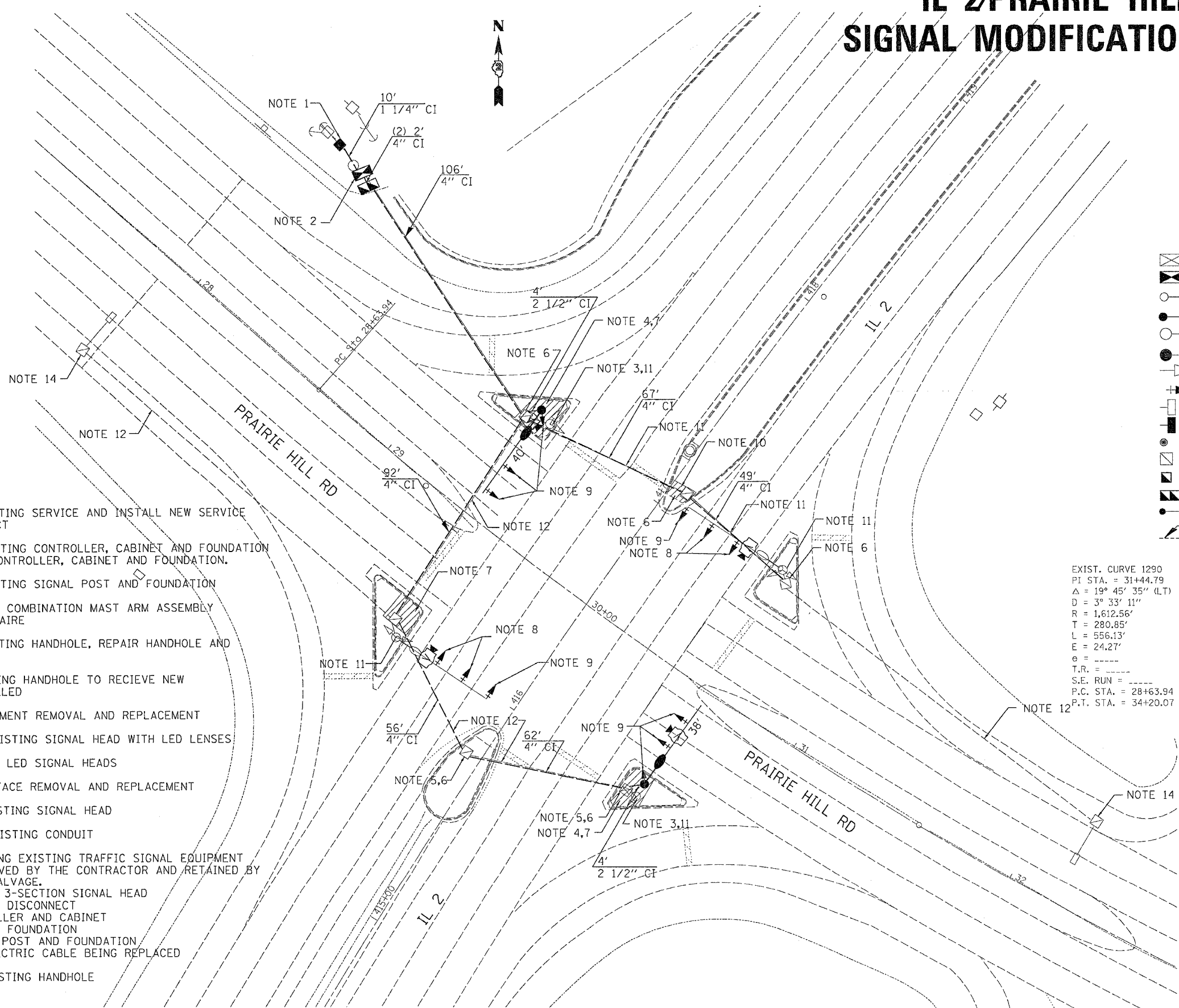

### LEGEND

- EXISTING CONTROLLER
- NEW CONTROLLER
- EXISTING STEEL MAST ARM ASSEMBLY AND POLE
- NEW STEEL MAST ARM ASSEMBLY AND POLE
- EXISTING SIGNAL HEAD AND POST
- NEW SIGNAL HEAD AND POST
- EXISTING SIGNAL HEAD
- NEW SIGNAL HEAD WITH BACKPLATE
- EXISTING PEDESTRIAN HEAD
- NEW PEDESTRIAN HEAD
- PEDESTRIAN PUSHBUTTON
- EXISTING HANDHOLE
- NEW HANDHOLE
- NEW DOUBLE HANDHOLE
- NEW LUMINAIRE
- UPPER NUMERAL INDICATES LENGTH
- LOWER NUMERAL INDICATES SIZE
- NEW CONDUIT INSTALLED, NON-METALLIC
- CI INDICATES CONDUIT INSTALLED

EXIST. CURVE 1290  
 PI STA. = 31+44.79  
 $\Delta = 19^\circ 45' 35''$  (LT)  
 $D = 3^\circ 33' 11''$   
 $R = 1,612.56'$   
 $T = 280.85'$   
 $L = 556.13'$   
 $E = 24.27'$   
 $e = \text{---}$   
 $T.R. = \text{---}$   
 $S.E. \text{ RUN} = \text{---}$   
 $P.C. \text{ STA.} = 28+63.94$   
 $P.T. \text{ STA.} = 34+20.07$

### NOTES:

1. REMOVE EXISTING SERVICE AND INSTALL NEW SERVICE WITH DISCONNECT
2. REMOVE EXISTING CONTROLLER, CABINET AND FOUNDATION. INSTALL NEW CONTROLLER, CABINET AND FOUNDATION.
3. REMOVE EXISTING SIGNAL POST AND FOUNDATION
4. INSTALL NEW COMBINATION MAST ARM ASSEMBLY WITH 40' LUMINAIRE
5. MODIFY EXISTING HANDHOLE, REPAIR HANDHOLE AND REPLACE LID
6. DRILL EXISTING HANDHOLE TO RECEIVE NEW CONDUIT INSTALLED
7. ISLAND PAVEMENT REMOVAL AND REPLACEMENT
8. RETROFIT EXISTING SIGNAL HEAD WITH LED LENSES
9. INSTALL NEW LED SIGNAL HEADS
10. MEDIAN SURFACE REMOVAL AND REPLACEMENT
11. REMOVE EXISTING SIGNAL HEAD
12. ABANDON EXISTING CONDUIT
13. THE FOLLOWING EXISTING TRAFFIC SIGNAL EQUIPMENT SHALL BE REMOVED BY THE CONTRACTOR AND RETAINED BY HIM/HER FOR SALVAGE.
  - 8 EACH 1-FACE, 3-SECTION SIGNAL HEAD
  - 1 EACH SERVICE DISCONNECT
  - 1 EACH CONTROLLER AND CABINET
  - 1 EACH CABINET FOUNDATION
  - 2 EACH SIGNAL POST AND FOUNDATION
  - ALL LIN FT ELECTRIC CABLE BEING REPLACED
14. REMOVE EXISTING HANDHOLE

REVISIONS	
NAME	DATE

ILLINOIS DEPARTMENT OF TRANSPORTATION

SCALE: VERT. \_\_\_\_\_  
 HORIZ. \_\_\_\_\_  
 DATE \_\_\_\_\_

DRAWN BY \_\_\_\_\_  
 CHECKED BY \_\_\_\_\_

PLOT DATE = Mon Oct 23 07:55:18 2006  
 FILE NAME = c:\projects\6297706\sig\706signal.plt\cdgn  
 USER NAME = n1141

F.A.P. RTE.	SECTION	COUNTY	TOTAL SHEETS	SHEET NO.
734	(77-1)TS-3	WINNEBAGO	10	8
STA.		TO STA.		
FED. ROAD DIST. NO.	ILLINOIS	FED. AID PROJECT		

# IL 2 UNION ST CABLE DETAIL



## PHASE DESIGNATION DIAGRAM

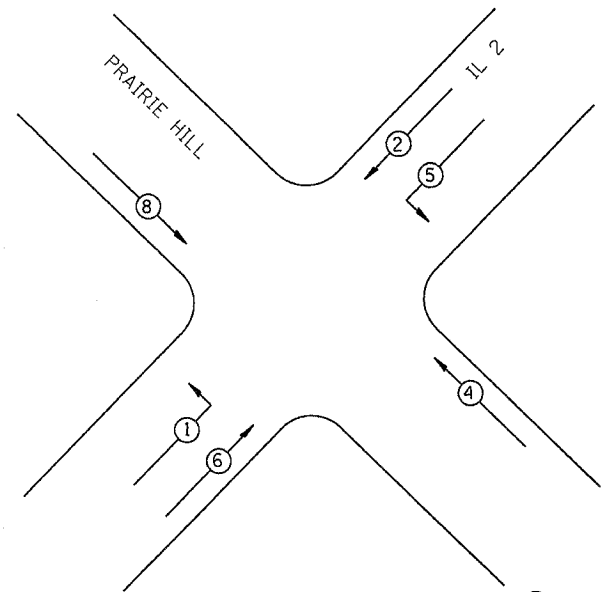

← ② → VEHICULAR MOVEMENT

NUMBER REFERS TO ASSOCIATED PHASE

REFER TO STANDARD 857001

LEGEND  
INDICATES NUMBER OF NEW CONDUCTORS.  
ALL CABLE IS NO. 14 EXCEPT AS INDICATED.  
"P" INDICATES PAIR CABLE



NEW SIGNAL HEAD WITH OR WITHOUT BACKPLATE



RETROFIT EXISTING SIGNAL HEAD WITH LED WITH OR WITHOUT BACKPLATE



NEW COUNTDOWN PEDESTRIAN HEAD - LED



PEDESTRIAN PUSHBUTTON



LUMINAIRE, 250 WATT



EXISTING DETECTION CABLES

DETECTOR ASSIGNMENT		
DETECTOR	PHASE NO.	DIRECTION
A	8	WB PRESENT
B	4	EB PRESENT
C	6	IL 2 NB FAR ADVANCE
D	6	IL 2 NB PRESENT
E	1	IL 2 NB LEFT
F	2	IL 2 SB FAR ADVANCE
G	2	IL 2 SB PRESENT
H	5	IL 2 SB LEFT

REVISIONS	
NAME	DATE

ILLINOIS DEPARTMENT OF TRANSPORTATION

SCALE: VERT. \_\_\_\_\_  
HORIZ. \_\_\_\_\_  
DATE \_\_\_\_\_

DRAWN BY \_\_\_\_\_  
CHECKED BY \_\_\_\_\_

## IL 2 UNION ST - SIGNAL CABLE DETAIL

PLT DATE = Mon Oct 23 10:18:55 2006  
PLT SCALE = 20.0000 7 IN.  
USER NAME = h11141

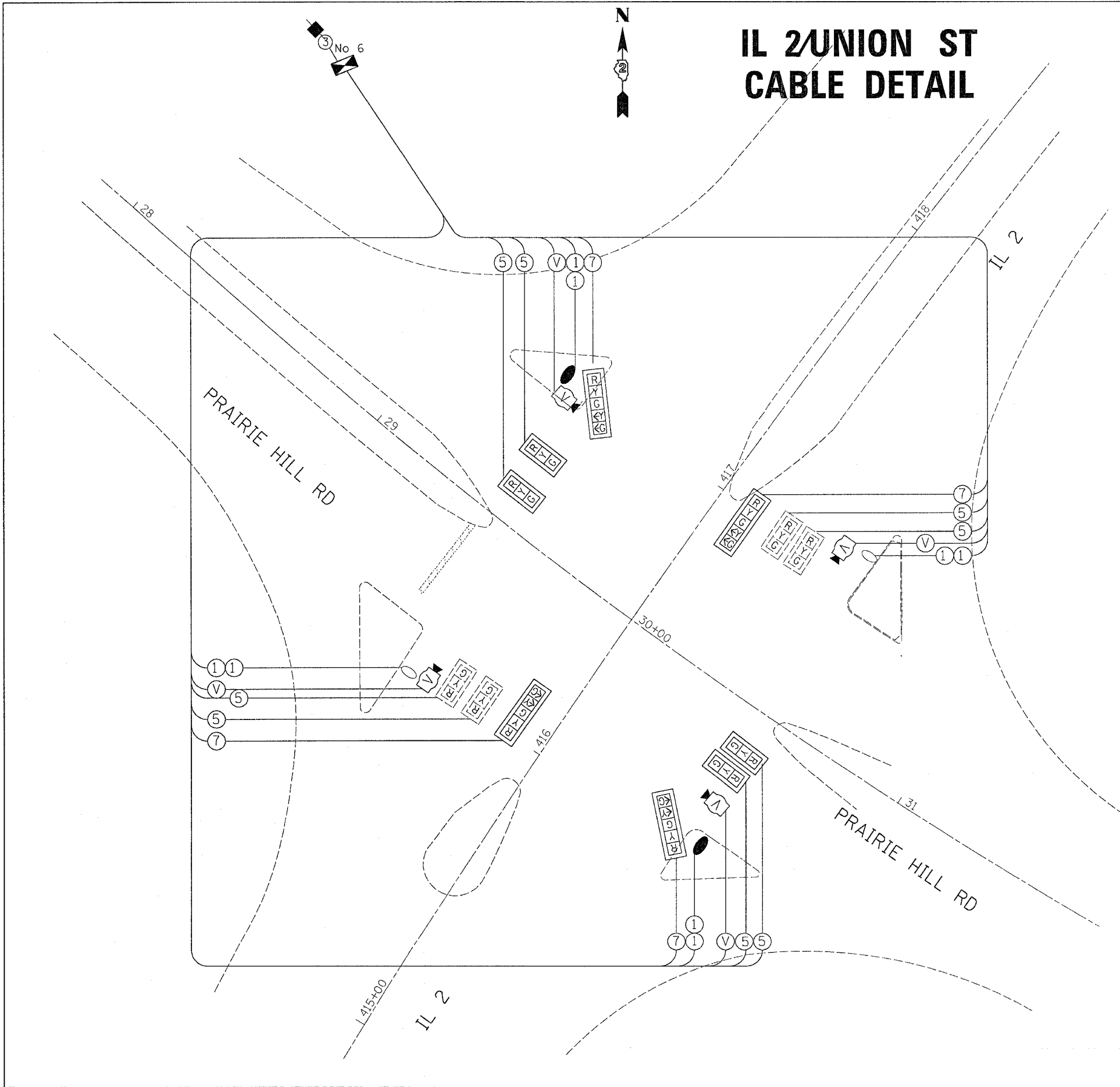



F.A.P. RTE.	SECTION	COUNTY	TOTAL SHEETS	SHEET NO.
734	(77-1)TS-3	WINNEBAGO	10	9
STA.		TO STA.		
FED. ROAD DIST. NO.		ILLINOIS FED. AID PROJECT		

# IL 2/IL 75 NOTES AND PHASING

NOTE: REMOVE EXISTING CONTROLLER AND CABINET AND INSTALL PROPOSED CONTROLLER AND TYPE III CABINET AT THE INTERSECTION OF IL 2 WITH IL 75.

## PHASE DESIGNATION DIAGRAM

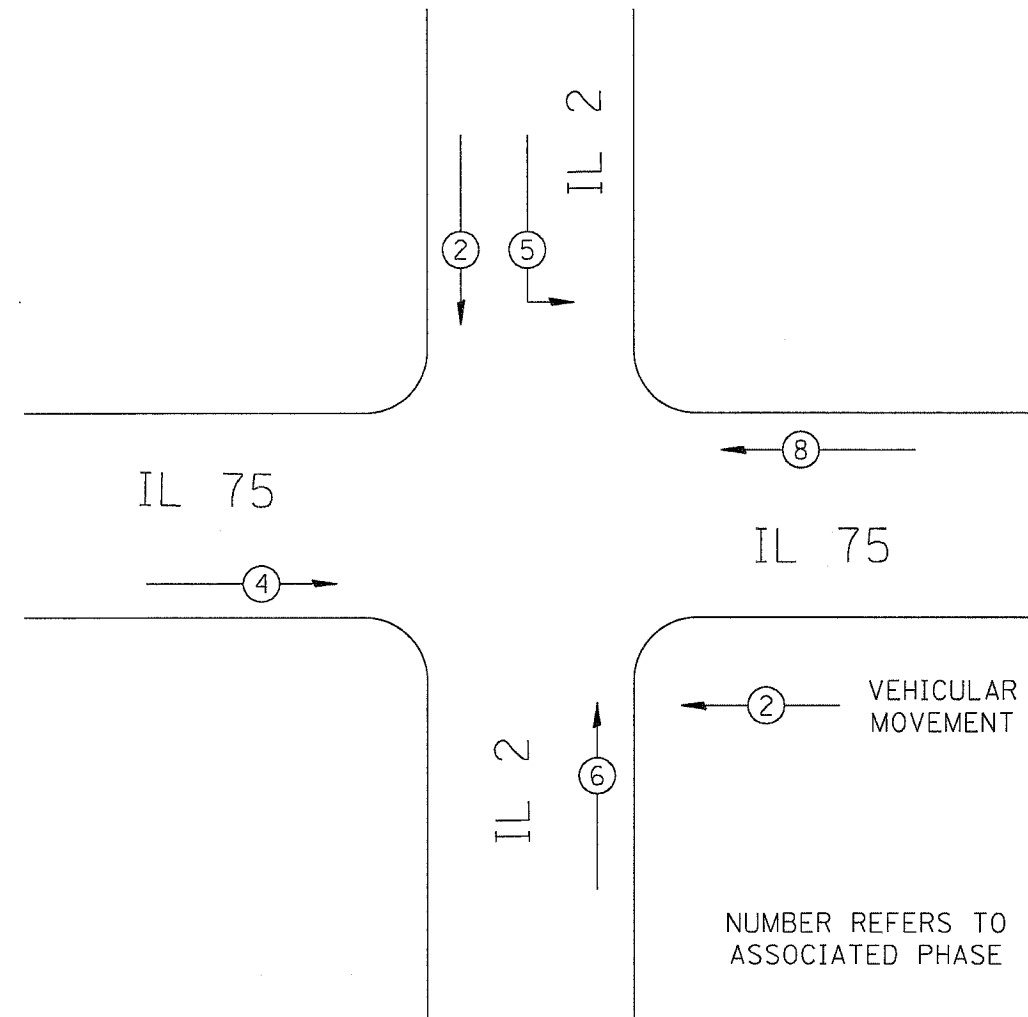

DETECTOR ASSIGNMENT		
DETECTOR	PHASE NO.	DIRECTION
A	2	SB PRESENT
B	4	EB PRESENT
C	5	SB LEFT
D	6	NB PRESENT
E	8	WB PRESENT

VEHICULAR MOVEMENT

NUMBER REFERS TO ASSOCIATED PHASE

REFER TO STANDARD 857001

PLOT DATE = Mon Oct 23 07:55:19 2006  
 FILE NAME = C:\projects\1026708\sig\76signal.plt\sig.dgn  
 USER NAME = h31kx

REVISIONS		ILLINOIS DEPARTMENT OF TRANSPORTATION
NAME	DATE	

SCALE: VERT. DATE  
HORIZ. DATE

DRAWN BY  
CHECKED BY

F.A.P. RTE.	SECTION	COUNTY	TOTAL SHEETS	SHEET NO.
734	(77-1)TS-3	WINNEBAGO	10	10
STA.		TO STA.		
FED. ROAD DIST. NO.		ILLINOIS FED. AID PROJECT		

# BLACKHAWK BLVD SIGN AND SERVICE INSTALLATION DETAIL FOR UNION AND PRAIRIE HILL

SERVICE INSTALLATION AT IL 2 WITH UNION AND IL 2 WITH PRAIRIE HILL

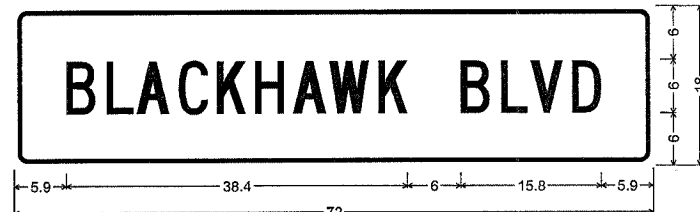

1.5" Radius, 0.5" Border, 0.4" Indent, White on Green;  
[BLACKHAWK BLVD] C;  
Table of letter and object lefts.

B	L	A	C	K	H	A	W	K	B	L	V	D
5.9	10.4	13.8	18.5	22.8	27.1	31.4	35.5	41.0	50.3	54.8	58.2	62.8

NOTES:  
SIGN DETAIL FOR THE PROPOSED MAST-ARM AT THE INTERSECTION OF IL 2 WITH PRAIRIE HILL RD

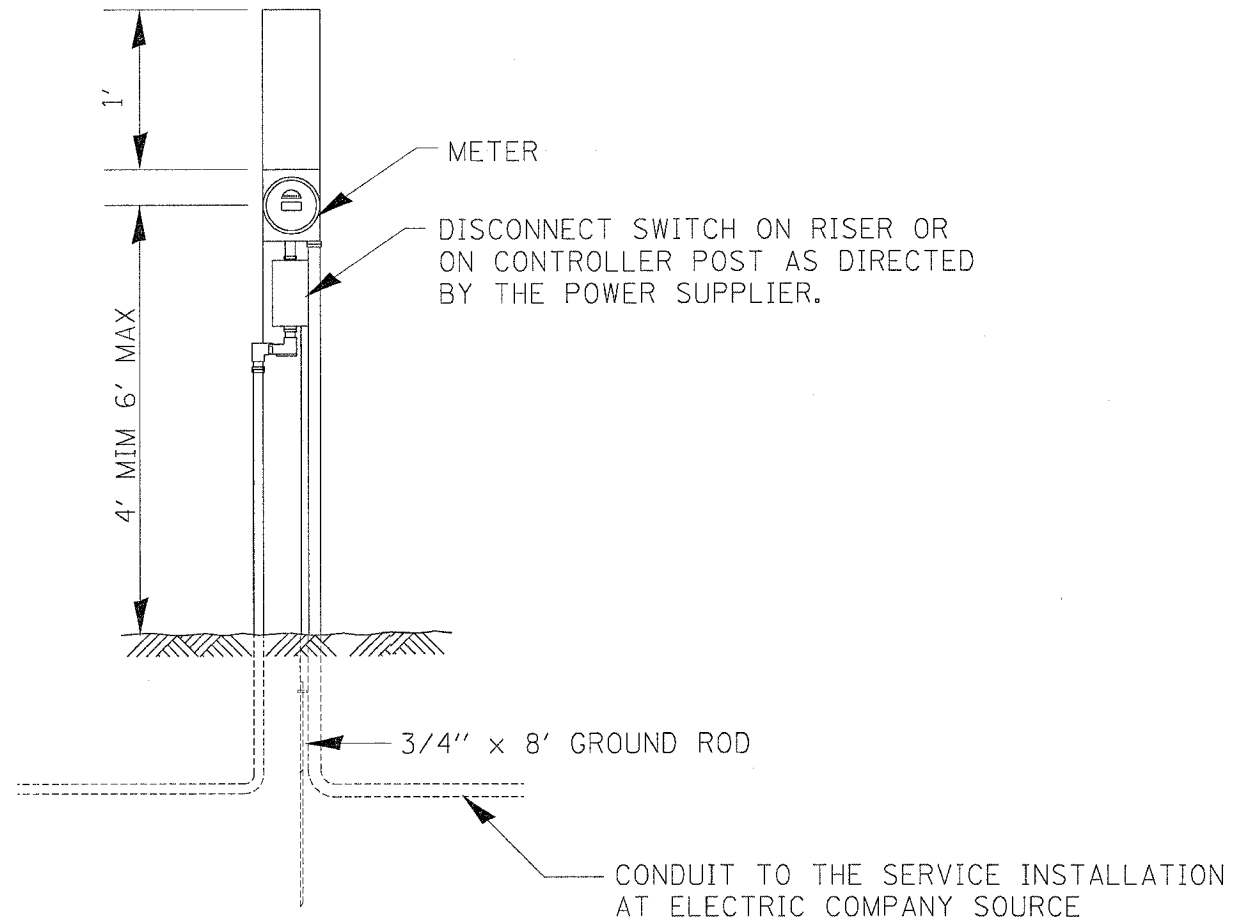

ELECTRIC SERVICE INSTALLATION, SPECIAL (SEE SPECIAL PROVISIONS)  
(DETAIL ONLY SHOW GENERAL SERVICE WHICH VARIES BY PROVIDERS)

PLOT DATE = Mon Oct 23 07:55:18 2006  
 PLOT SCALE = 1/8" = 1'-0"  
 USER NAME = HJL

REVISIONS		ILLINOIS DEPARTMENT OF TRANSPORTATION
NAME	DATE	
		SCALE: VERT. DATE: HORIZ. DRAWN BY CHECKED BY