

CONTRACT NO. 66543			
F.A.P. RTE.	SECTION	COUNTY	TOTAL SHEETS
840	139 BR-1	KANKAKEE	69
STA. 193+40		TO STA. 199+60	
FED. ROAD DIST. NO.		ILLINOIS FED. AID PROJECT	

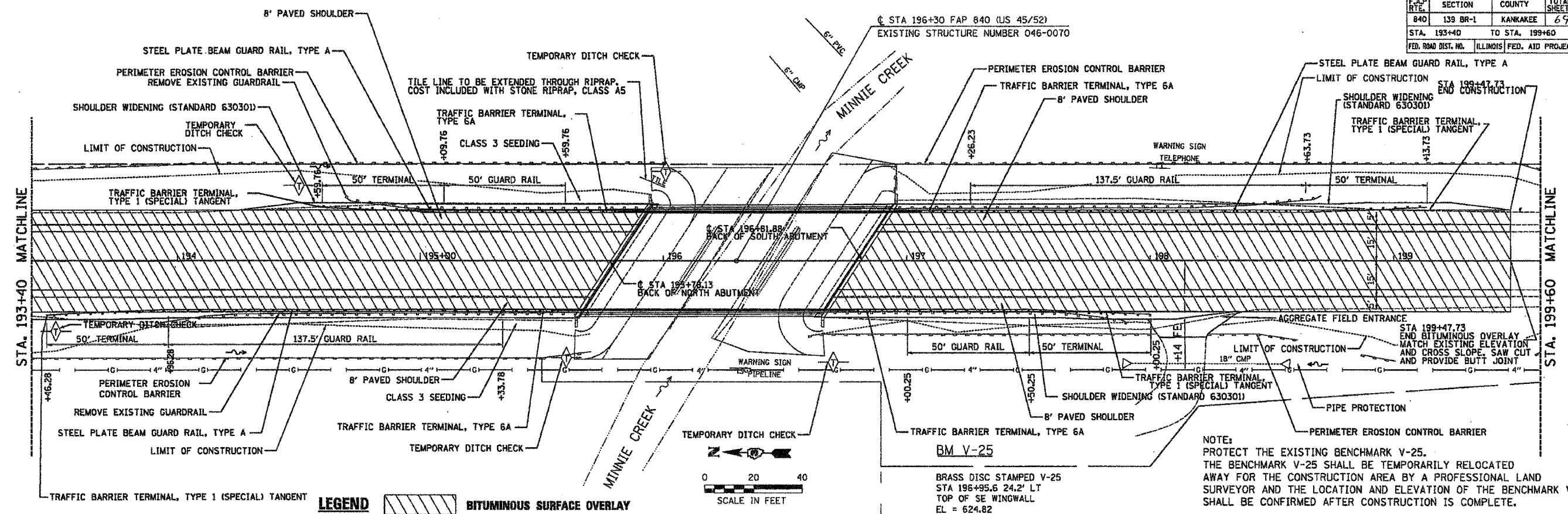

NOTE:
 PROTECT THE EXISTING BENCHMARK V-25.
 THE BENCHMARK V-25 SHALL BE TEMPORARILY RELOCATED AWAY FOR THE CONSTRUCTION AREA BY A PROFESSIONAL LAND SURVEYOR AND THE LOCATION AND ELEVATION OF THE BENCHMARK V-25 SHALL BE CONFIRMED AFTER CONSTRUCTION IS COMPLETE.

BM V-25
 BRASS DISC STAMPED V-25
 STA 196+95.6 24.2' LT
 TOP OF SE WINGWALL
 EL = 624.82

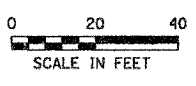

LEGEND BITUMINOUS SURFACE OVERLAY

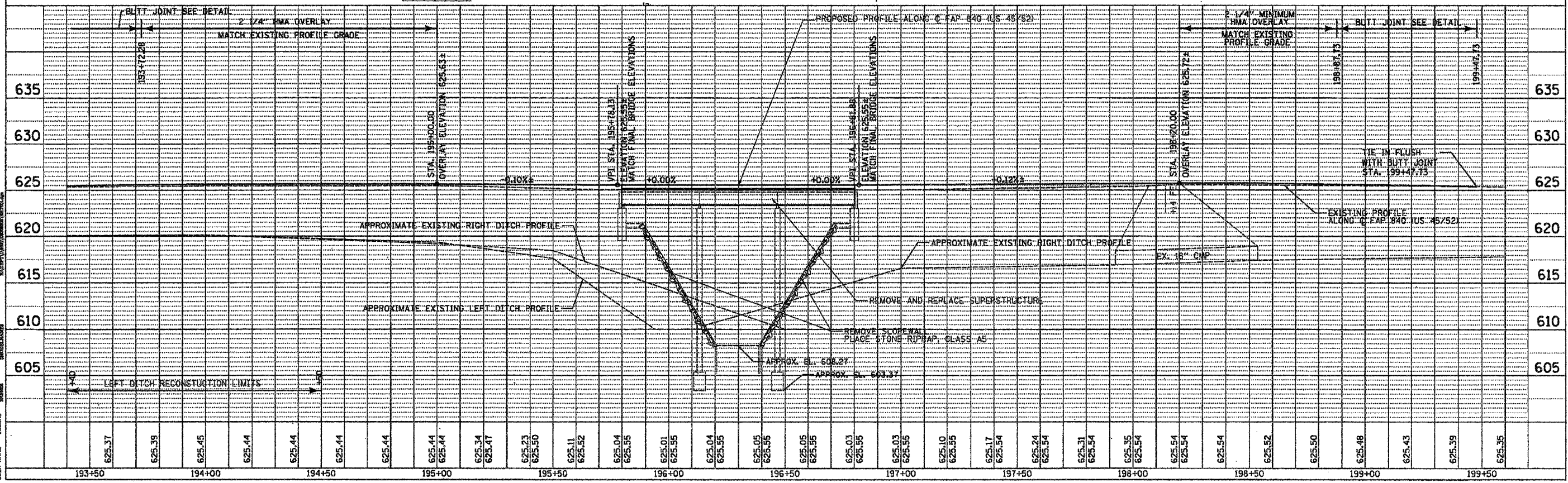

PLAN AND PROFILE — F.A.P. 840 (US 45/52) KANKAKEE COUNTY

DATE	BY
REVISION	BY
PLAN	DATE
NOTE BOOK	NO.
FILE NAME	
STRUCTURE NOTATION	

DATE	BY
REVISION	BY
PROFILE	DATE
NOTE BOOK	NO.
FILE NAME	
STRUCTURE NOTATION	

PLAT DATE = 10/12/2000
 FILE NAME = W06P11\193+40\046280\SHITTEL.dgn
 PLOT SCALE = 8"=100'
 USER NAME = LIBERT