

F.A.P. RTE.	SECTION	COUNTY	TOTAL SHEETS	SHEET NO.
840	139 BR-2	KANKAKEE	69	55
STA. 214+00		TO STA. 216+50		
FED. ROAD DIST. NO.	ILLINOIS	FED. AID PROJECT		

EDDENA HISSONG
17-29-300-001



BENCHMARKS

BM2 - CHISELED "D" SW CORNER ABUTMENT
SN 046-0098 STA. 219+34, 21.55' RT. ELEV. 623.24

LEGEND

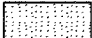
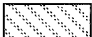
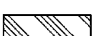
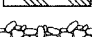
-  BITUMINOUS REMOVAL BUTT JT.
-  PAVEMENT REMOVAL
-  AGGREGATE SHOULDERS, TY B
-  RIPRAP, CLASS A4

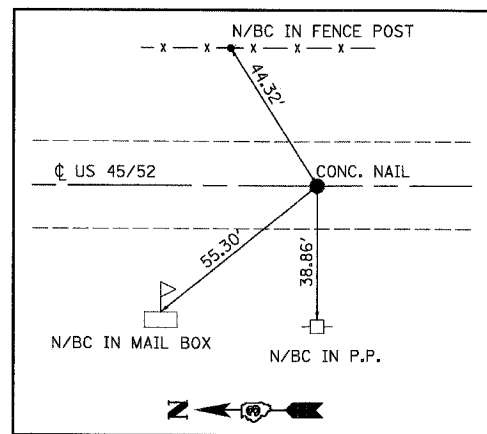

CENTERLINE TIE

POT: STA. 207+01.72
POINT# 204

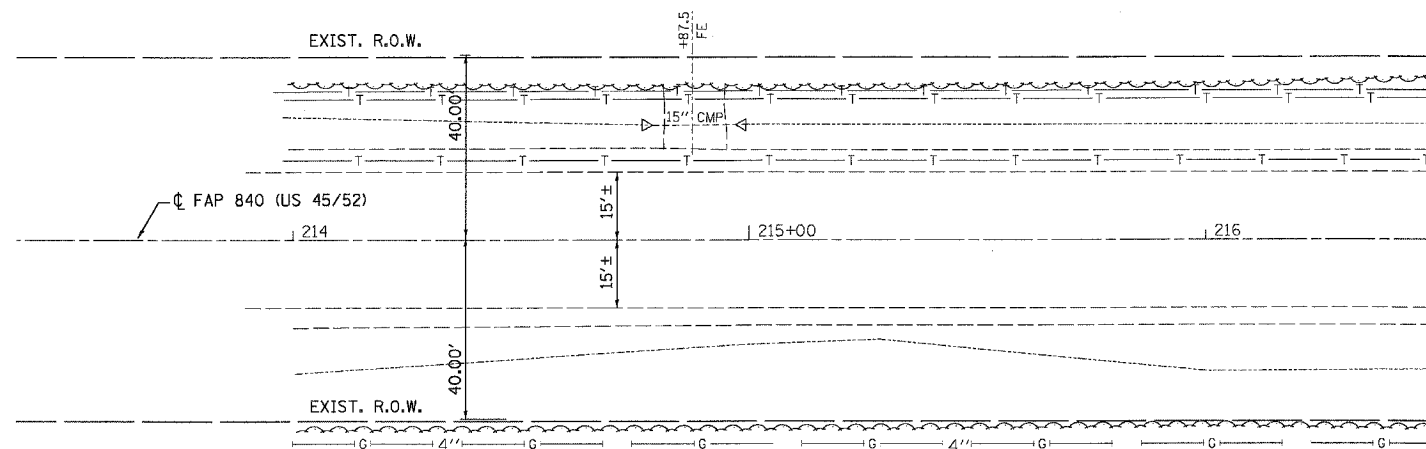

RICHARD & MONICA DEUTSCHE
17-30-400-002

PLAN	SURVEYED	DATE
	PLOTTED	
	CHECKED	
	BY	
	DATE	
	NO. OF MAY CHECKED	
	CADD FILE NAME	

PROFILE	SURVEYED	DATE
	PLOTTED	
	CHECKED	
	BY	
	DATE	
	NO. OF MAY CHECKED	
	STRUCTURE NOTATIONS CHKD	

