

ROUTE NO.	SECTION	COUNTY	SHEET	SHEET NO.
F.A.P. 41	15BR	LIVINGSTON	38	15
FED. ROAD DIST. NO. 7	ILLINOIS	PAID AID PROJECT		

Contract #66665

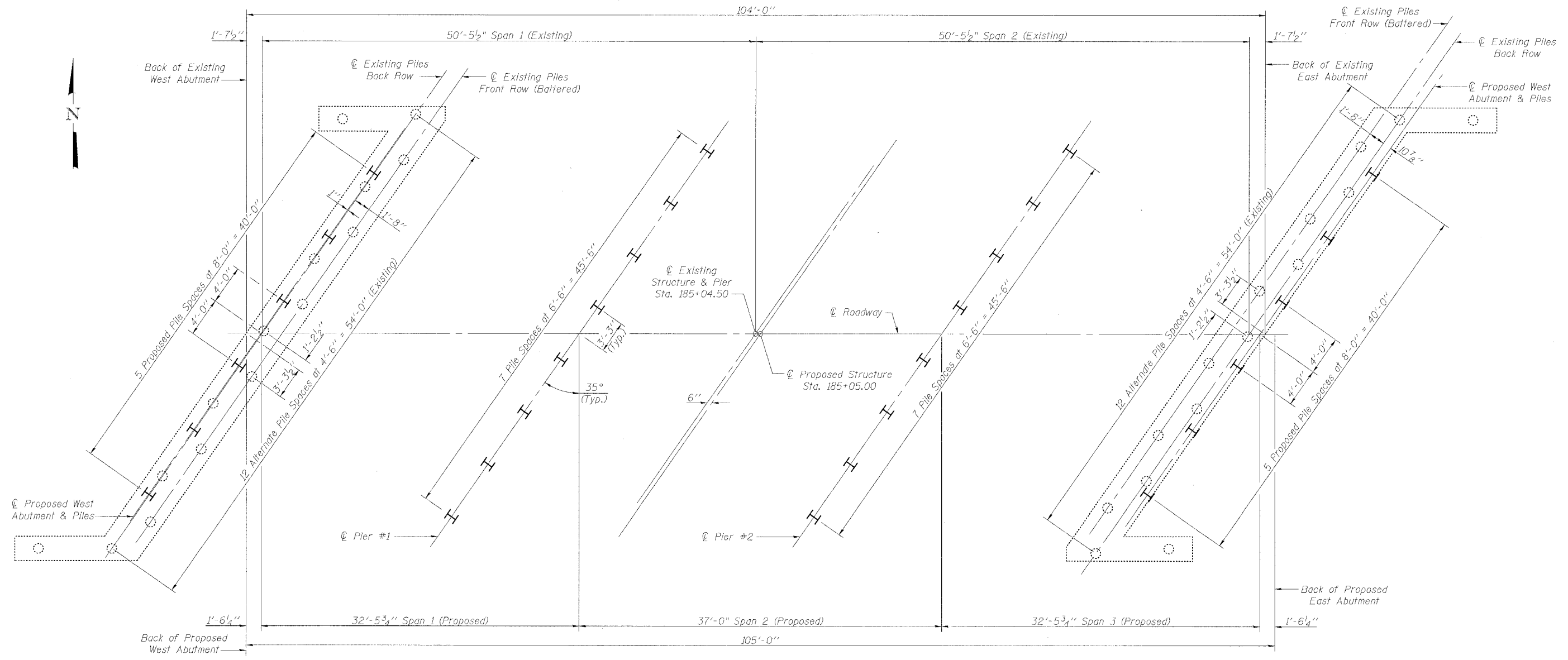

PILING LAYOUT PLAN

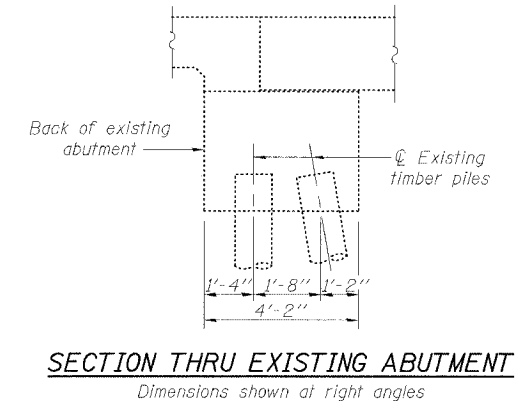

NOTE

Pile locations shown are based on existing drawings and are subject to nominal field variations. The proposed piles shall be driven as closely as possible to their intended locations. If the location of an existing timber pile conflicts with the location of a proposed pile, the pile location may be adjusted to miss the existing pile. Pile locations shall not deviate from the pile centerlines shown here. The maximum spacing along the pile centerline between any two piles shall be limited to a maximum of ten feet (10'). The Contractor shall notify the Engineer of all conflicts and the proposed adjustment prior to any driving of piles.

<p>Excellence through Ownership</p> <p>200 West Front Street Wheaton, IL 60187</p>	<p>ILLINOIS DEPARTMENT OF TRANSPORTATION</p> <p>PILING LAYOUT IL 17 OVER UNNAMED DRAINAGE DITCH FAP RTE 41 - SECTION 15BR LIVINGSTON COUNTY STATION 185+05 STRUCTURE NO. 053-0182</p>
	<p>DATE: 10/20/2006</p> <p>DRAWN BY: BLB CHECKED BY: JMT</p>

12/17/2006 R:\1120663\Structures\Final Plans\Final Plans.dgn