

F.A.P. RTE.	SECTION	COUNTY	TOTAL SHEETS	SHEET NO.
315	(34-6,55-1)	HANCOCK/McDONOUGH	433	41
STA. 1+00		TO STA. 31+00		
FED. ROAD DIST. NO.	ILLINOIS	FED. AID PROJECT		
STATE CONTRACT NO. 68206				

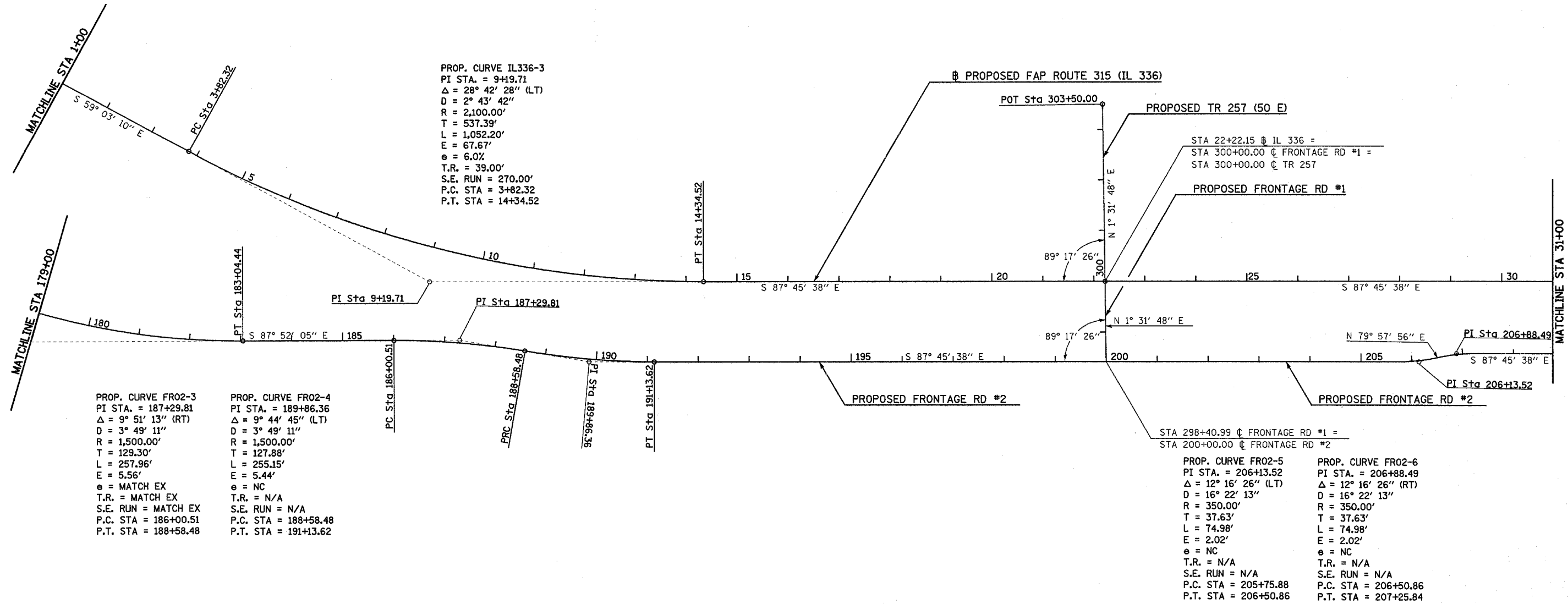

PROP. CURVE IL336-3  
 PI STA. = 9+19.71  
 $\Delta = 28^\circ 42' 28''$  (LT)  
 $D = 2^\circ 43' 42''$   
 $R = 2,100.00'$   
 $T = 537.39'$   
 $L = 1,052.20'$   
 $E = 67.67'$   
 $e = 6.0\%$   
 $T.R. = 39.00'$   
 $S.E. RUN = 270.00'$   
 $P.C. STA = 3+82.32$   
 $P.T. STA = 14+34.52$

PROP. CURVE FR02-3  
 PI STA. = 187+29.81  
 $\Delta = 9^\circ 51' 13''$  (RT)  
 $D = 3^\circ 49' 11''$   
 $R = 1,500.00'$   
 $T = 129.30'$   
 $L = 257.96'$   
 $E = 5.56'$   
 $e = \text{MATCH EX}$   
 $T.R. = \text{MATCH EX}$   
 $S.E. RUN = \text{MATCH EX}$   
 $P.C. STA = 186+00.51$   
 $P.T. STA = 188+58.48$

PROP. CURVE FR02-4  
 PI STA. = 189+86.36  
 $\Delta = 9^\circ 44' 45''$  (LT)  
 $D = 3^\circ 49' 11''$   
 $R = 1,500.00'$   
 $T = 127.88'$   
 $L = 255.15'$   
 $E = 5.44'$   
 $e = \text{NC}$   
 $T.R. = \text{N/A}$   
 $S.E. RUN = \text{N/A}$   
 $P.C. STA = 188+58.48$   
 $P.T. STA = 191+13.62$

PROP. CURVE FR02-5  
 PI STA. = 206+13.52  
 $\Delta = 12^\circ 16' 26''$  (LT)  
 $D = 16^\circ 22' 13''$   
 $R = 350.00'$   
 $T = 37.63'$   
 $L = 74.98'$   
 $E = 2.02'$   
 $e = \text{NC}$   
 $T.R. = \text{N/A}$   
 $S.E. RUN = \text{N/A}$   
 $P.C. STA = 205+75.88$   
 $P.T. STA = 206+50.86$

PROP. CURVE FR02-6  
 PI STA. = 206+88.49  
 $\Delta = 12^\circ 16' 26''$  (RT)  
 $D = 16^\circ 22' 13''$   
 $R = 350.00'$   
 $T = 37.63'$   
 $L = 74.98'$   
 $E = 2.02'$   
 $e = \text{NC}$   
 $T.R. = \text{N/A}$   
 $S.E. RUN = \text{N/A}$   
 $P.C. STA = 206+50.86$   
 $P.T. STA = 207+25.84$

Plot Date: 7/8/2006  
 Time: 10:00 AM  
 Plotter: AutoCAD  
 Plot Table: Isot-101  
 Filename: h:\03033\cody\1\construction\plans\02.nc02.mxd

