

F.A.P. RTE.	SECTION	COUNTY	TOTAL SHEETS	SHEET NO.
315	(34-6,55-1)	HANCOCK/McDONOUGH	433	45
STA. 1392+00		TO STA. 1407+00		
FED. ROAD DIST. NO.		ILLINOIS	FED. AID PROJECT	STATE CONTRACT NO. 68206

PROP. CURVE IL336-1  
 PI STA. = 1399+83.51  
 $\Delta = 16^\circ 28' 12''$  (LT)  
 $D = 2^\circ 33' 00''$   
 $R = 2,246.89'$   
 $T = 325.18'$   
 $L = 645.88'$   
 $E = 23.41'$   
 $e = 5.9\%$   
 $T.R. = 39'$   
 $S.E. RUN = 265'$   
 $P.C. STA = 1396+58.32$   
 $P.T. STA = 1403+04.21$

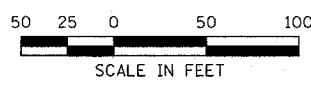
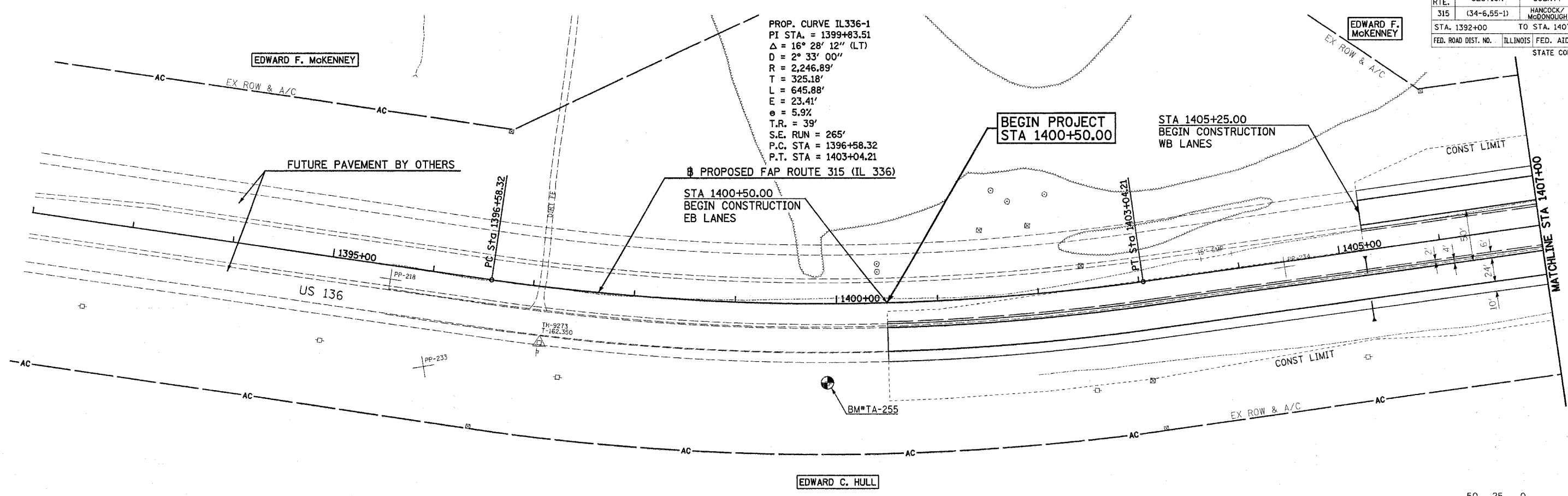

DATE	
BY	
PLAN	
NO.	
NO.	
NO.	
NO.	
NO.	

DATE	
BY	
PROFILE	
NO.	
NO.	
NO.	
NO.	
NO.	

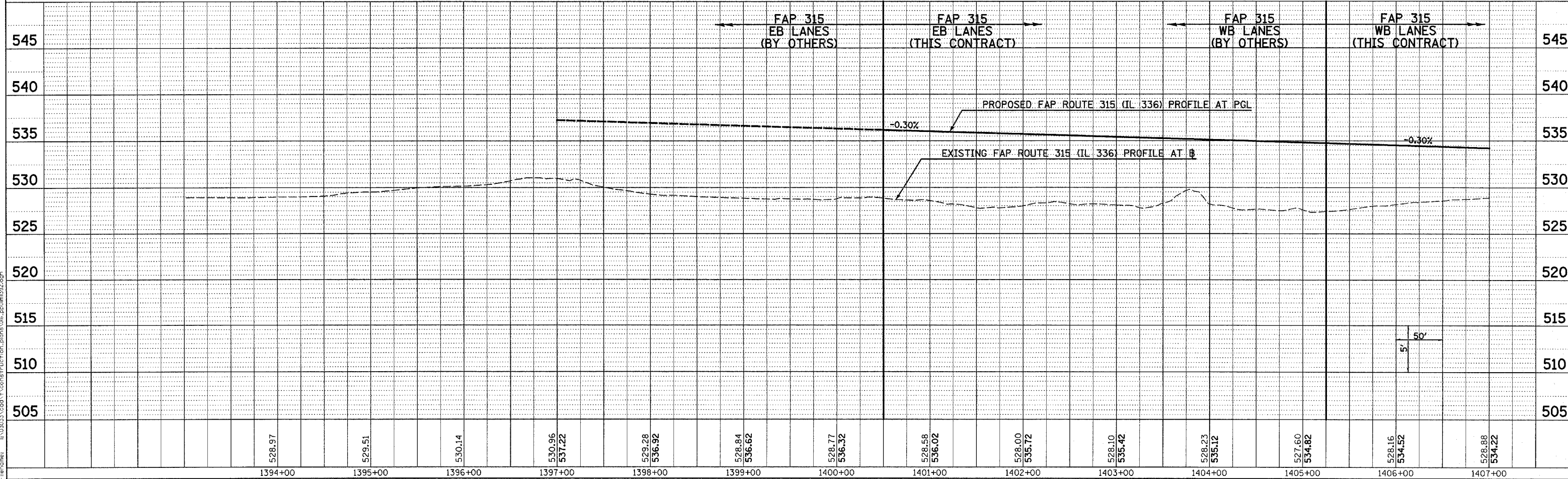

Plot Date: 7/18/2006  
 Plot Time: 3:24:35 PM  
 Plotted By: bccmndt  
 File Name: R:\03033\cd\1\construction\plans\06\_pp01m1992.dgn

ROADWAY PLAN & PROFILE - FAP ROUTE 315 (IL 336) STA 1392+00 TO STA 1407+00