

F.A.P. RTE.	SECTION	COUNTY	TOTAL SHEETS	SHEET NO.
315	(34-6,55-1)	HANCOCK/McDONOUGH	433	159
STA.	TO STA.			
FED. ROAD DIST. NO.	ILLINOIS	FED. AID PROJECT		
STATE CONTRACT NO. 68206				

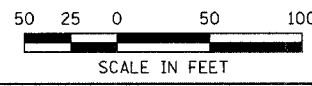

REMOVAL LEGEND

	PAVEMENT REMOVAL
	EXISTING OIL & CHIP PAVEMENT TO BE REMOVED. COST INCIDENTAL TO EARTH EXCAVATION.
	STRUCTURE REMOVAL
	EXISTING GRAVEL PAVEMENT TO BE REMOVED. COST INCIDENTAL TO EARTH EXCAVATION.
	EXISTING ENTRANCE PAVEMENT TO BE REMOVED. COST INCIDENTAL TO EARTH EXCAVATION.
	TREE REMOVAL, ACRES
	BUILDING REMOVAL
X	TREE REMOVAL
XXXXXX	GUTTER REMOVAL

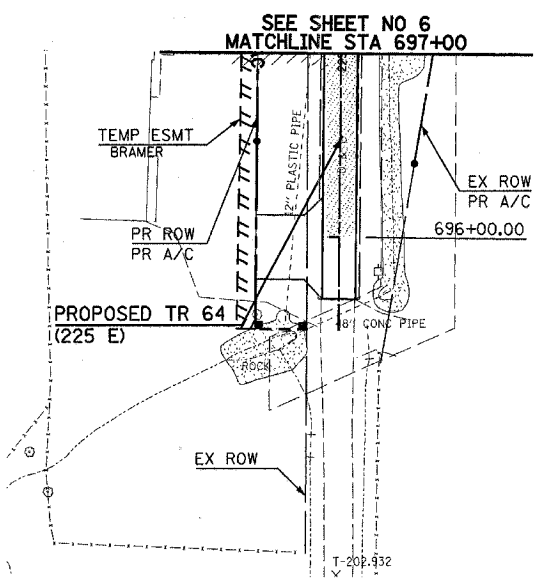
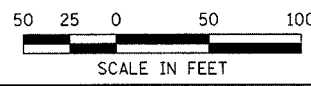
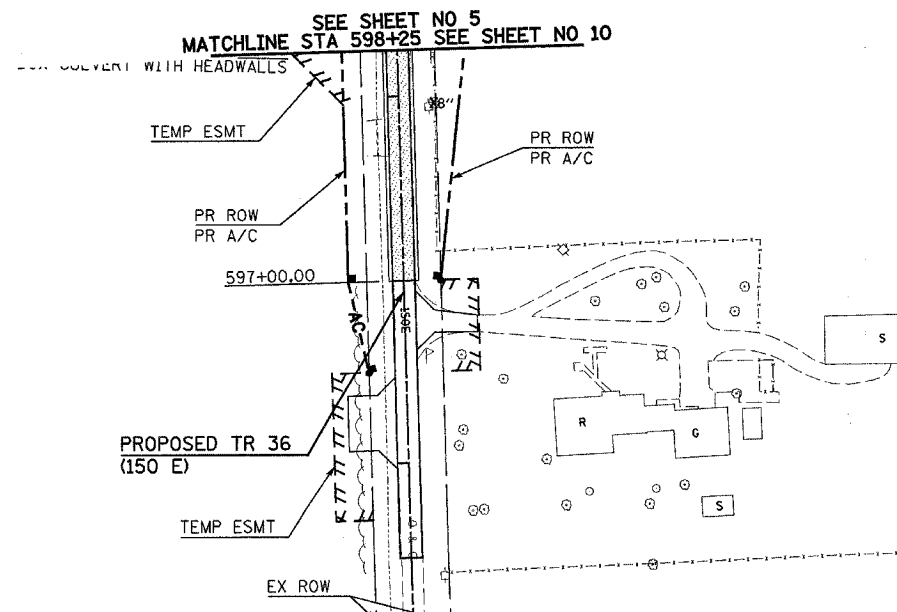
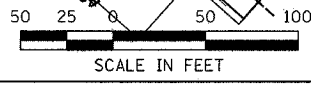
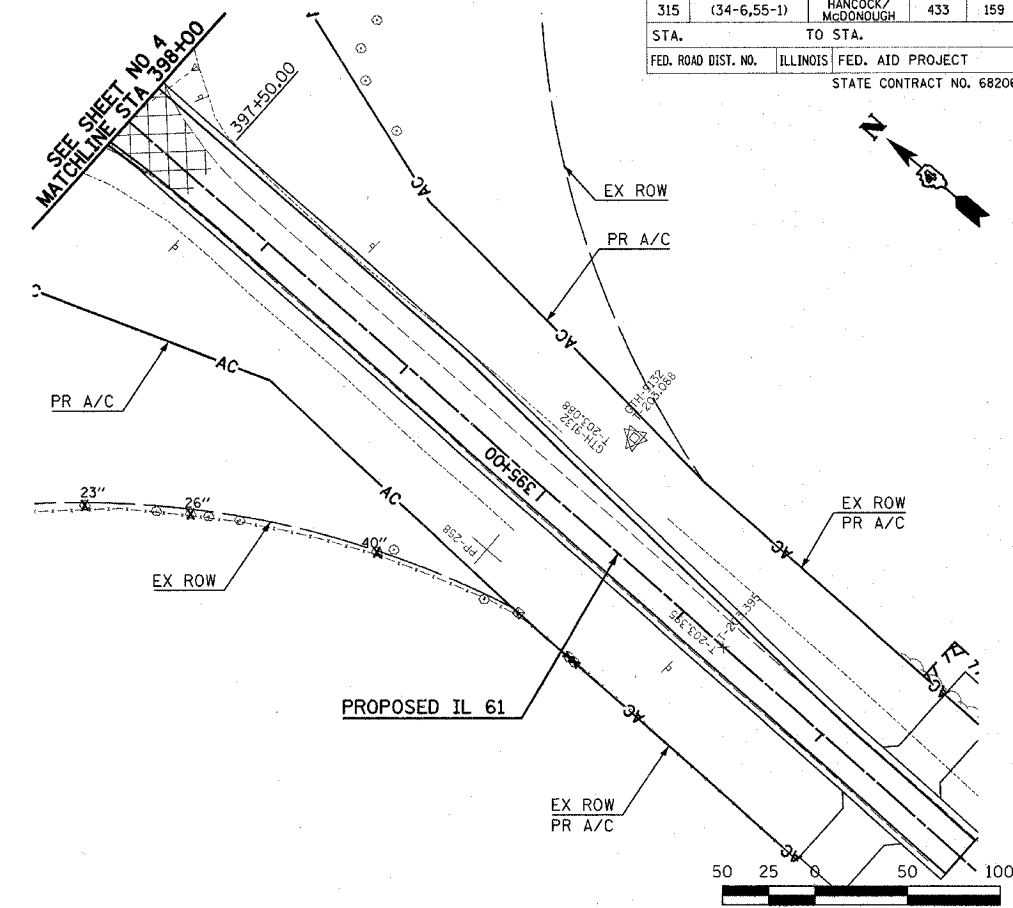
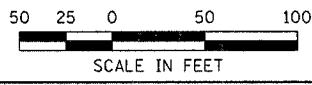
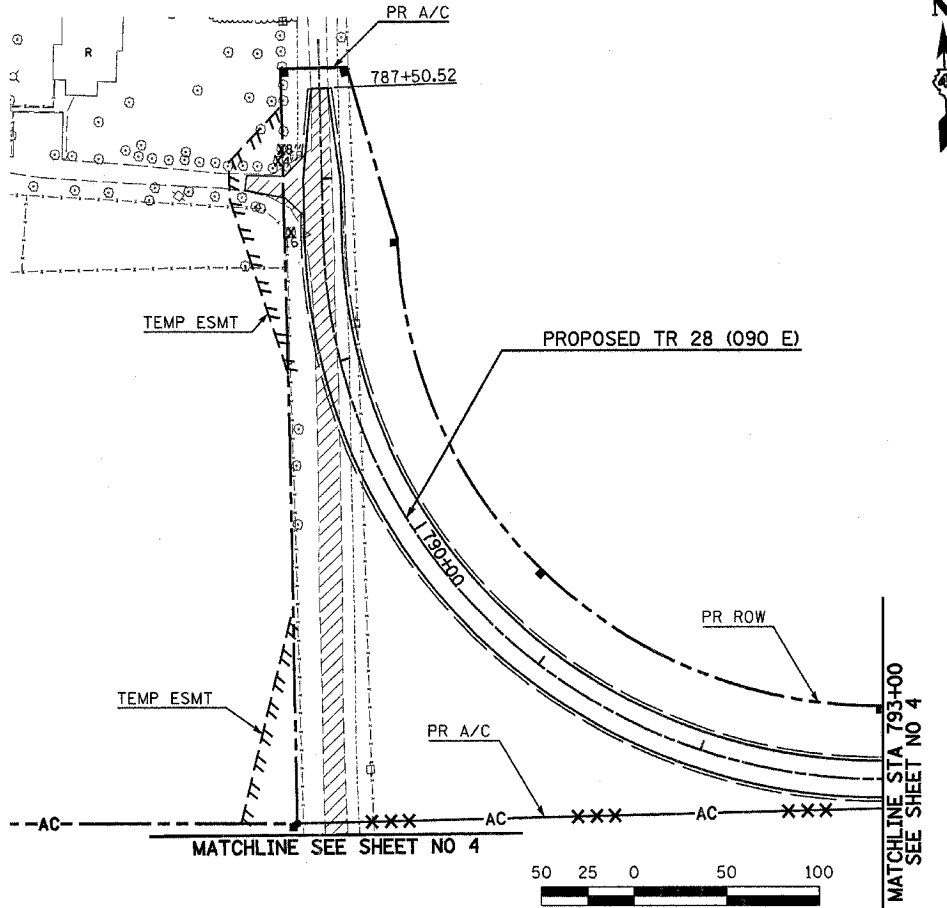
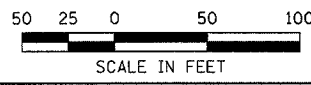
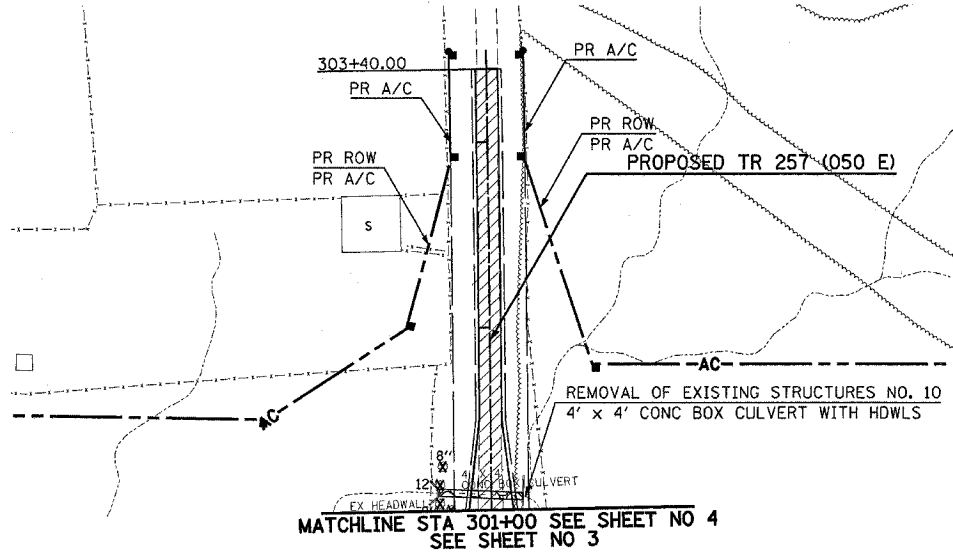
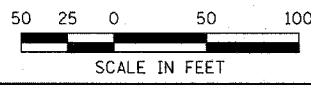
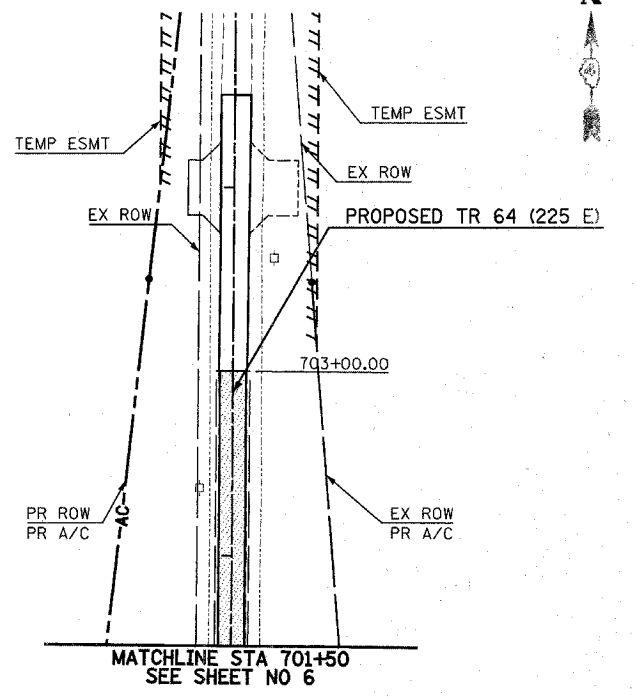

Plot Date: 7/18/2006
 Plot Time: 3:47:58 PM
 Plotted By: bscmacth
 Pen Table: ldx+tbl
 File Name: h:\03033\work\construction\plans\52_rmd\8m132.dgn