

POINT	ILLINOIS 336		TOWNSHIP ROAD 257		ELEVATION
	STATION	OFFSET	STATION	OFFSET	
A1	21+58.92	49.00' LT	300+49.78	62.62' LT	633.61
A2	21+74.45	51.60' LT	300+52.18	47.06' LT	634.00
A3	21+88.44	58.79' LT	300+59.20	32.98' LT	634.33
A4	21+99.49	69.98' LT	300+70.26	21.79' LT	634.22
A5	22+06.51	84.06' LT	300+84.24	14.60' LT	633.76
A6	22+08.92	99.62' LT	300+99.78	12.00' LT	633.28

POINT	ILLINOIS 336		TOWNSHIP ROAD 257		ELEVATION
	STATION	OFFSET	STATION	OFFSET	
B1	22+32.93	98.38' LT	300+98.24	12.00' RT	633.32
B2	22+35.53	83.08' LT	300+82.91	14.41' RT	633.99
B3	22+42.70	69.31' LT	300+69.05	21.40' RT	634.66
B4	22+53.74	58.40' LT	300+58.01	32.31' RT	635.34
B5	22+67.60	51.41' LT	300+50.84	46.08' RT	636.01
B6	22+82.93	49.00' LT	300+48.24	61.38' RT	636.68

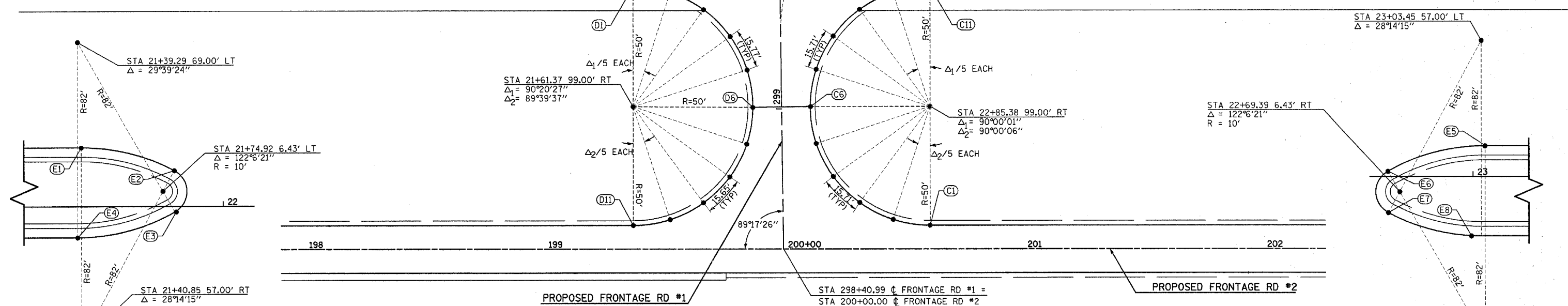
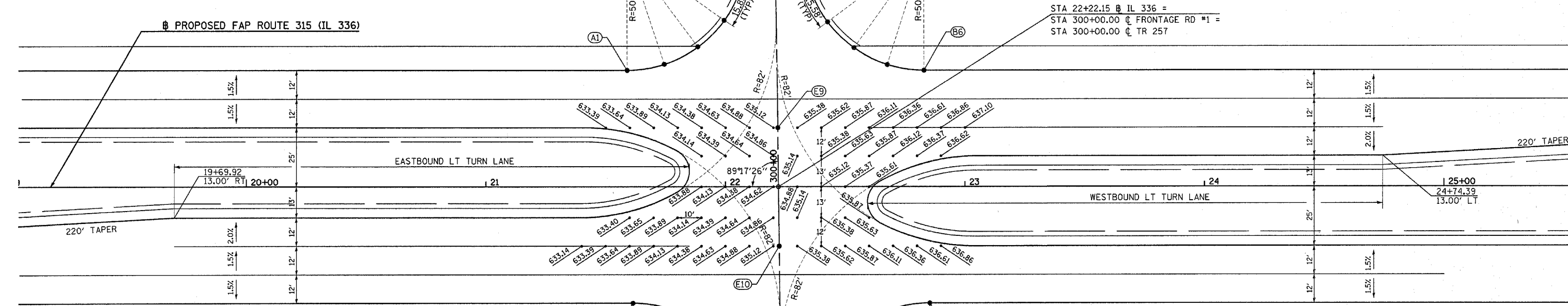

POINT	ILLINOIS 336		FRONTAGE ROAD #1		ELEVATION
	STATION	OFFSET	STATION	OFFSET	
D1	21+61.37	49.00' RT	299+51.76	61.38' LT	633.67
D2	21+76.88	51.47' RT	299+49.10	45.91' LT	633.77
D3	21+90.86	58.62' RT	299+41.77	32.02' LT	633.87
D4	22+01.93	69.76' RT	299+30.50	21.09' LT	633.98
D5	22+09.00	83.78' RT	299+16.40	14.19' LT	634.08
D6	22+11.37	99.30' RT	299+00.85	12.01' LT	634.18
D7	22+08.85	114.68' RT	298+85.50	14.72' LT	633.46
D8	22+01.72	128.53' RT	298+71.73	22.02' LT	632.74
D9	21+90.66	139.52' RT	298+60.88	33.21' LT	632.02
D10	21+76.77	146.57' RT	298+54.00	47.20' LT	631.30
D11	21+61.37	149.00' RT	298+51.77	62.62' LT	630.58

POINT	ILLINOIS 336		FRONTAGE ROAD #1		ELEVATION
	STATION	OFFSET	STATION	OFFSET	
C1	22+85.38	149.00' RT	298+50.23	61.38' RT	635.96
C2	22+69.93	146.55' RT	298+52.87	45.96' RT	635.36
C3	22+55.99	139.45' RT	298+60.14	32.11' RT	634.94
C4	22+44.93	128.39' RT	298+71.34	21.19' RT	634.72
C5	22+37.83	114.45' RT	298+85.37	14.26' RT	634.69
C6	22+35.50	99.00' RT	299+00.84	12.12' RT	634.85
C7	22+37.83	83.55' RT	299+16.27	14.64' RT	635.19
C8	22+44.93	69.61' RT	299+30.11	21.92' RT	635.57
C9	22+55.99	58.55' RT	299+41.04	33.11' RT	635.96
C10	22+69.93	51.45' RT	299+47.97	47.14' RT	636.35
C11	22+85.38	49.00' RT	299+50.22	62.62' RT	636.74

POINT	STATION	OFFSET	ELEVATION
E1	21+40.85	25.00' LT	633.17
E2	21+79.65	15.24' LT	633.93
E3	21+79.86	2.26' RT	633.68
E4	21+39.29	13.00' RT	632.89
E5	23+05.01	13.00' LT	636.99
E6	22+64.44	2.26' LT	635.77
E7	22+64.65	15.24' RT	636.03
E8	23+03.45	25.00' RT	637.19
E9	22+21.84	25.00' LT	635.17
E10	22+22.46	25.00' RT	635.18

NAME	DATE

ILLINOIS DEPARTMENT OF TRANSPORTATION

**INTERSECTION DETAILS**

IL 336 & TR 257 / FRONTAGE RD #1

FRONTAGE RD #1 / FRONTAGE RD #2

SCALE: VERT. N/A  
HORIZ. 1"=20'

DATE 7/16/03

DRAWN BY HH  
CHECKED BY BDS

Plot Date: 7/16/2006  
 Plot Time: 3:59:00 PM  
 Plotted By: bbschmidt  
 Pen Table: Isot.tbl  
 Filename: I:\02033\coord\1\constr\action\pans\IL-INT0212TR01.dgn