

PROPOSED FAP ROUTE 315 (IL 336)

F.A.P. RTE.	SECTION	COUNTY	TOTAL SHEETS	SHEET NO.
315	(34-6.55-1)	HANCOCK/MCDONOUGH	433	162
STA.	TO STA.			
FED. ROAD DIST. NO.	ILLINOIS	FED. AID PROJECT	STATE CONTRACT NO. 68206	

POINT	ILLINOIS 336		ILLINOIS 61		ELEVATION
	STATION	OFFSET	STATION	OFFSET	
D1	47+96.81	61.00' RT	399+41.88	103.90' LT	666.55
D2	48+18.77	63.98' RT	399+38.30	82.06' LT	666.51
D3	48+39.13	72.71' RT	399+29.01	61.97' LT	666.47
D4	48+56.42	86.56' RT	399+14.69	45.10' LT	666.30
D5	48+69.38	104.52' RT	398+96.37	32.67' LT	666.13
D6	48+77.06	125.28' RT	398+75.40	25.60' LT	665.99
D7	48+82.77	153.41' RT	398+47.13	20.91' LT	665.81
D8	48+87.40	181.73' RT	398+18.68	16.90' LT	665.63
D9	48+90.95	210.21' RT	397+90.11	14.18' LT	665.39
D10	48+93.42	238.80' RT	397+61.46	12.55' LT	665.13
D11	48+94.80	267.46' RT	397+32.77	12.00' LT	664.95

POINT	ILLINOIS 336		TOWNSHIP ROAD 28		ELEVATION
	STATION	OFFSET	STATION	OFFSET	
A1	48+34.33	49.00' LT	799+49.18	63.39' RT	666.94
A2	48+50.03	51.54' LT	799+47.08	47.61' RT	666.88
A3	48+64.13	58.89' LT	799+40.13	33.29' RT	666.71
A4	48+75.21	70.30' LT	799+29.04	21.88' RT	666.45
A5	48+82.14	84.63' LT	799+14.92	14.53' RT	666.28
A6	48+84.22	100.41' LT	798+99.20	12.00' RT	666.06
A7	48+84.21	100.96' LT	798+98.65	12.00' RT	666.06
A8	48+81.40	116.13' LT	798+83.41	14.38' RT	665.77
A9	48+74.11	129.72' LT	798+69.62	21.29' RT	665.02
A10	48+63.04	140.43' LT	798+08.33	19.29' RT	664.86
A11	48+49.24	147.26' LT	797+94.54	12.38' RT	664.80
A12	48+34.02	149.55' LT	797+79.30	10.00' RT	664.74

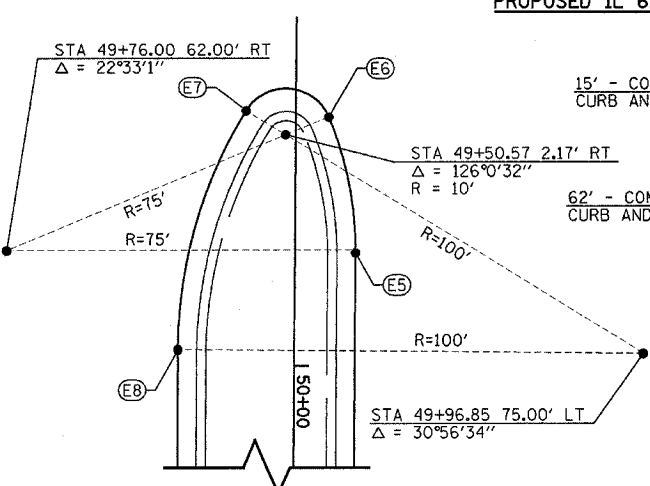
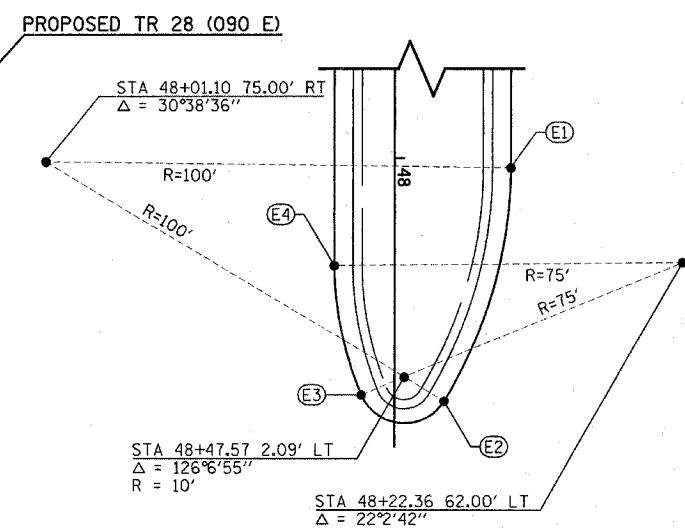
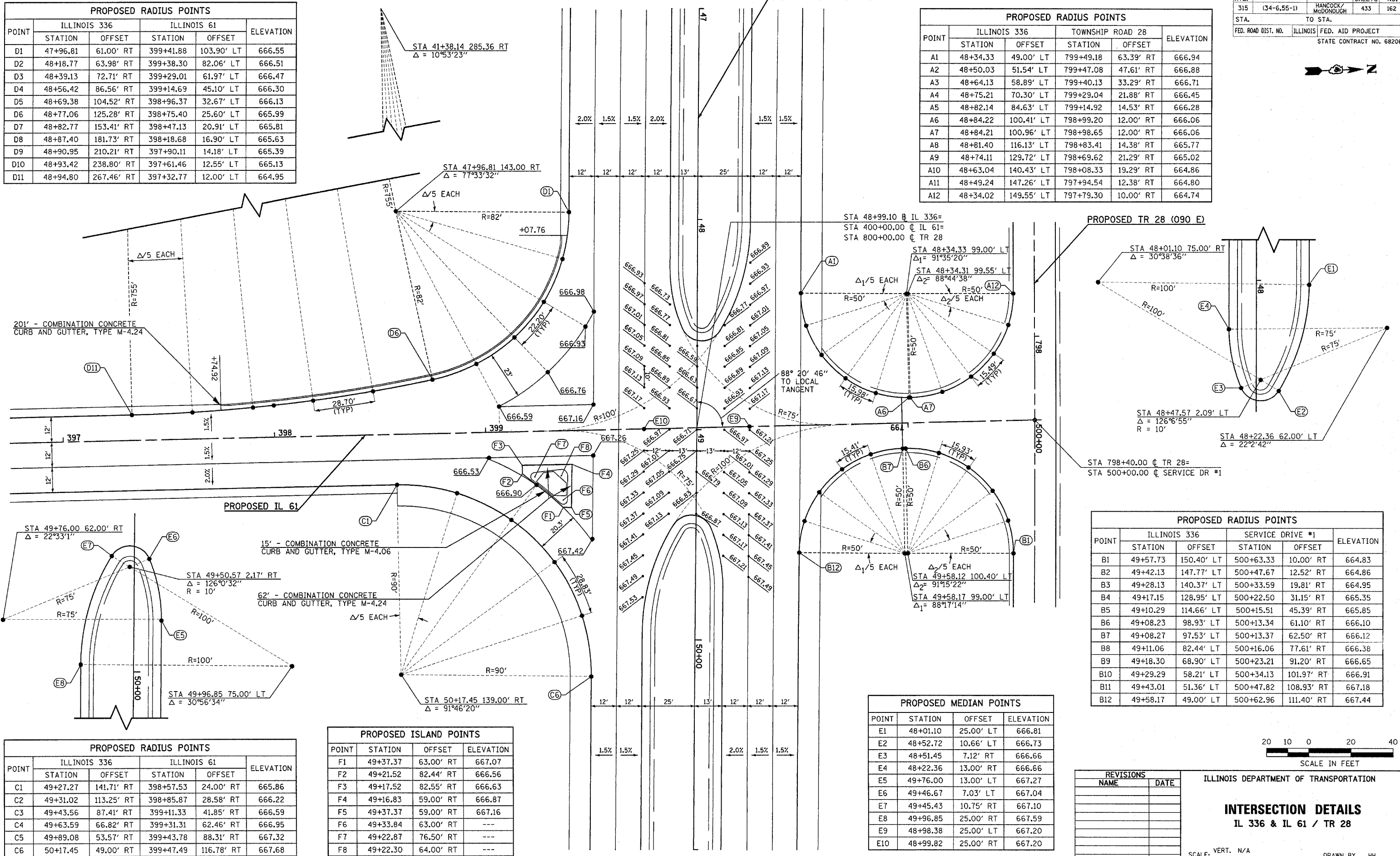

POINT	ILLINOIS 336		ILLINOIS 61		ELEVATION
	STATION	OFFSET	STATION	OFFSET	
C1	49+27.27	141.71' RT	398+57.53	24.00' RT	665.86
C2	49+31.02	113.25' RT	398+85.87	28.58' RT	666.22
C3	49+43.56	87.41' RT	399+11.33	41.85' RT	666.59
C4	49+63.59	66.82' RT	399+31.31	62.46' RT	666.95
C5	49+89.08	53.57' RT	399+43.78	88.31' RT	667.32
C6	50+17.45	49.00' RT	399+47.49	116.78' RT	667.68

PROPOSED ISLAND POINTS			
POINT	STATION	OFFSET	ELEVATION
F1	49+37.37	63.00' RT	667.07
F2	49+21.52	82.44' RT	666.56
F3	49+17.52	82.55' RT	666.63
F4	49+16.83	59.00' RT	666.87
F5	49+37.37	59.00' RT	667.16
F6	49+33.84	63.00' RT	---
F7	49+22.87	76.50' RT	---
F8	49+22.30	64.00' RT	---

PROPOSED MEDIAN POINTS			
POINT	STATION	OFFSET	ELEVATION
E1	48+01.10	25.00' LT	666.81
E2	48+52.72	10.66' LT	666.73
E3	48+51.45	7.12' RT	666.66
E4	48+22.36	13.00' RT	666.66
E5	49+76.00	13.00' LT	667.27
E6	49+46.67	7.03' LT	667.04
E7	49+45.43	10.75' RT	667.10
E8	49+96.85	25.00' RT	667.59
E9	48+98.38	25.00' LT	667.20
E10	48+99.82	25.00' RT	667.20

POINT	ILLINOIS 336		SERVICE DRIVE #1		ELEVATION
	STATION	OFFSET	STATION	OFFSET	
B1	49+57.73	150.40' LT	500+63.33	10.00' RT	664.83
B2	49+42.13	147.77' LT	500+47.67	12.52' RT	664.86
B3	49+28.13	140.37' LT	500+33.59	19.81' RT	664.95
B4	49+17.15	128.95' LT	500+22.50	31.15' RT	665.35
B5	49+10.29	114.66' LT	500+15.51	45.39' RT	665.85
B6	49+08.23	98.93' LT	500+13.34	61.10' RT	666.10
B7	49+08.27	97.53' LT	500+13.37	62.50' RT	666.12
B8	49+11.06	82.44' LT	500+16.06	77.61' RT	666.38
B9	49+18.30	68.90' LT	500+23.21	91.20' RT	666.65
B10	49+29.29	58.21' LT	500+34.13	101.97' RT	666.91
B11	49+43.01	51.36' LT	500+47.82	108.93' RT	667.18
B12	49+58.17	49.00' LT	500+62.96	111.40' RT	667.44

REVISIONS	
NAME	DATE

ILLINOIS DEPARTMENT OF TRANSPORTATION

INTERSECTION DETAILS
IL 336 & IL 61 / TR 28

SCALE: VERT. N/A
HORIZ. 1"=20'
DATE 7/16/03

DRAWN BY HH
CHECKED BY BDS

Plot Date: 7/16/2006
Plot Time: 3:29:45 PM
Plotted By: bschmidt
Pen Table: idot.tbl
Filename: I:\0303\constr\construction\plans\05_in\0318tr28.dgn