

F.A.P. RTE.	SECTION	COUNTY	TOTAL SHEETS	SHEET NO.
315	(34-6.55-1)	HANCOCK/McDONOUGH	433	314
STA. 1442+00.00	TO STA. 1443+00.00			
FED. ROAD DIST. NO.	ILLINOIS	FED. AID PROJECT	STATE CONTRACT NO. 68206	
260	280	300	320	

DATE	BY
FINAL SURVEY	SURVEYED
NOTE BOOK	TEMPLATE
NO.	AREAS CHECKED

DATE	BY
ORIGINAL SURVEY	SURVEYED
NOTE BOOK	TEMPLATE
NO.	AREAS CHECKED

Plot Date: 8/20/2006
 Plot Time: 02:52:41 PM
 Plot By: [Name]
 File Name: I:\030333\cadd\1\constr\action\plan\336_xss\mainline.dgn

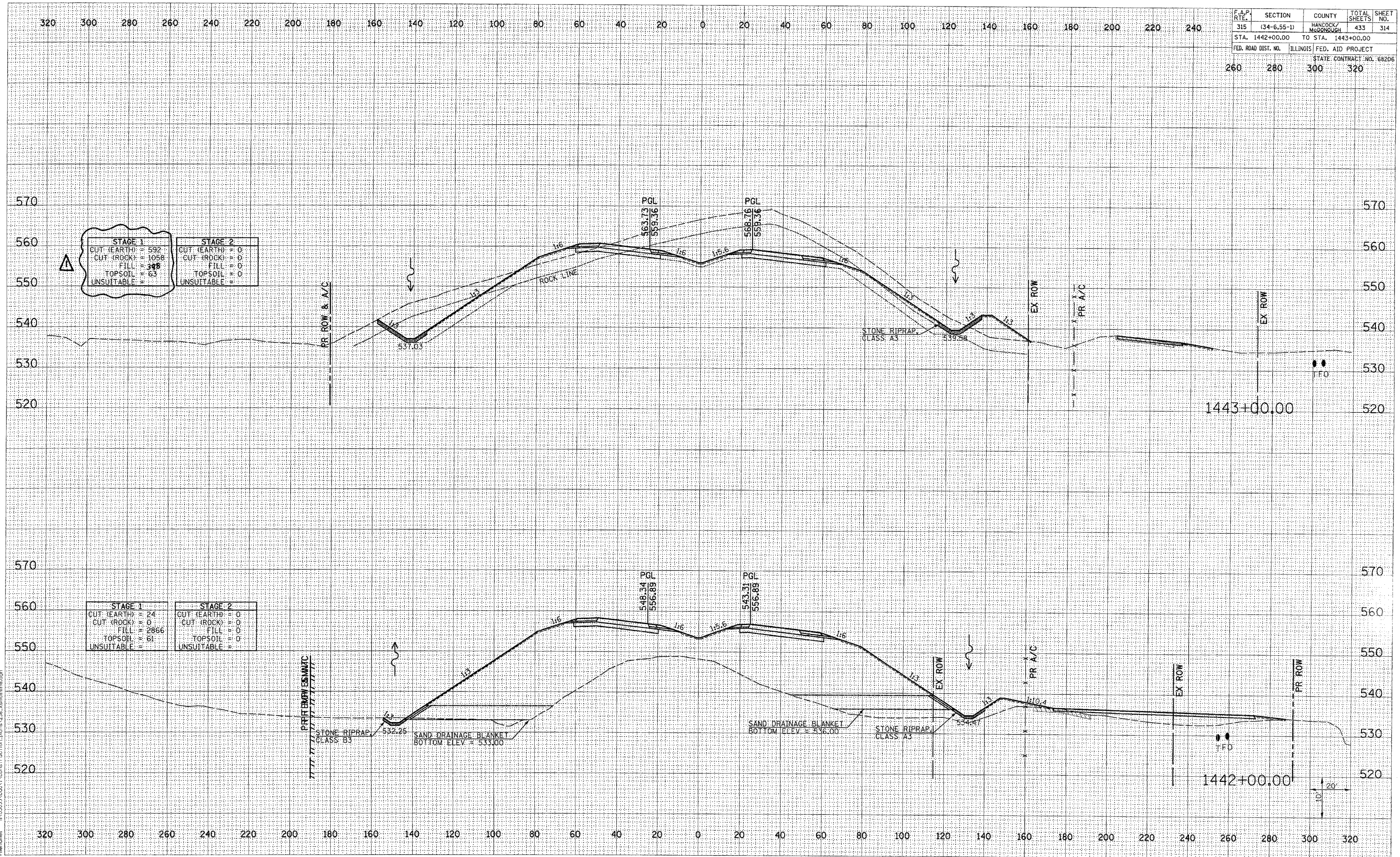

STAGE 1		STAGE 2	
CUT (EARTH)	592	CUT (EARTH)	0
CUT (ROCK)	1058	CUT (ROCK)	0
FILL	395	FILL	0
TOPSOIL	0	TOPSOIL	0
UNSUITABLE	0	UNSUITABLE	0

STAGE 1		STAGE 2	
CUT (EARTH)	24	CUT (EARTH)	0
CUT (ROCK)	0	CUT (ROCK)	0
FILL	2866	FILL	0
TOPSOIL	0	TOPSOIL	0
UNSUITABLE	0	UNSUITABLE	0

REVISION 11/10/06

FAP ROUTE 315 (IL 336) CROSS SECTIONS STA 1442+00.00 TO 1443+00.00