

F.P. ROUTE	SECTION	COUNTY	TOTAL SHEETS	SHEET NO.
693	(119B-3)I	TAZEWELL	31	8
STA.	TO STA.			
EXISTING CONDITIONS:				
CONTRACT NO. 68415				

# STAGE II TRAFFIC CONTROL

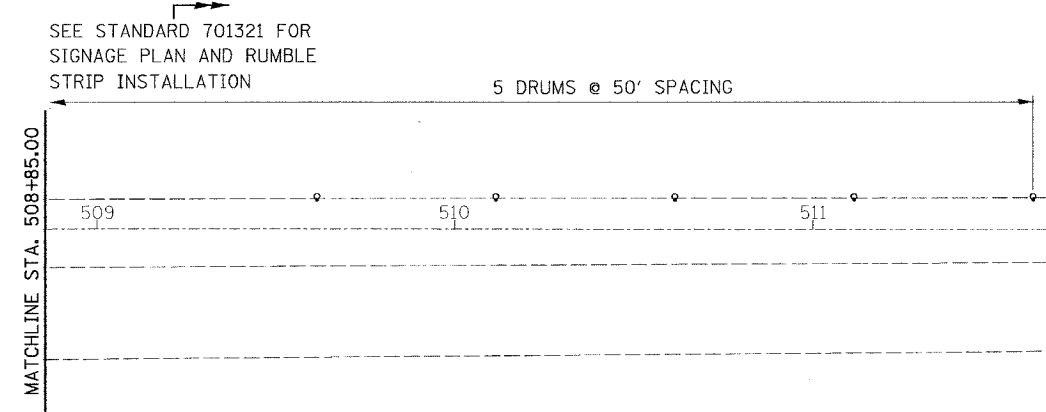
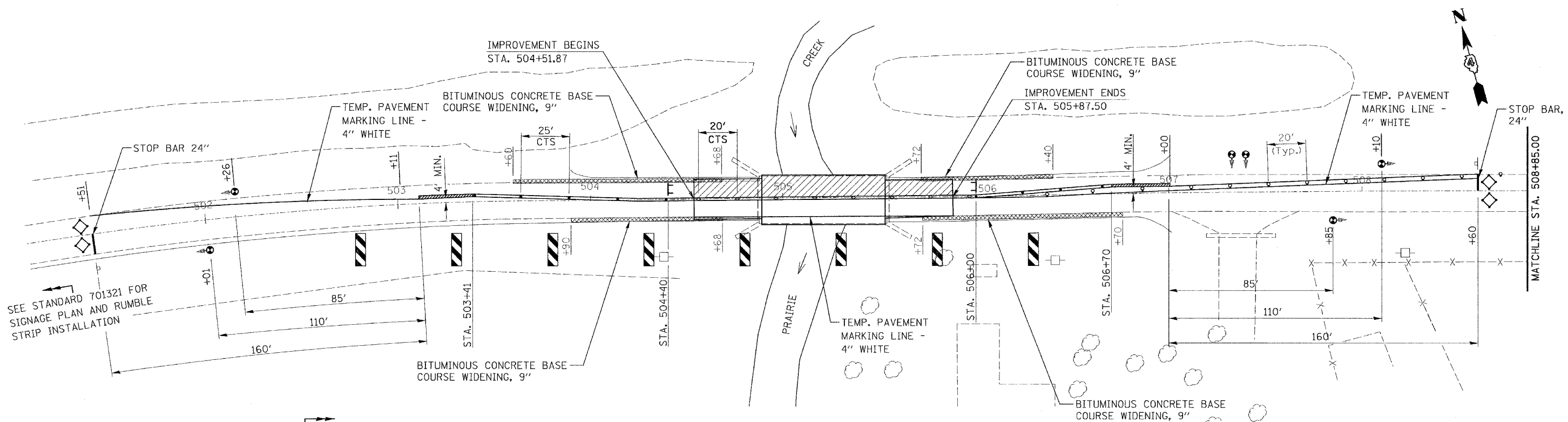

### NOTES

TRAFFIC CONTROL SHALL CONFORM TO HIGHWAY STANDARD 701321.

CONTRACTOR TO ADJUST TRAFFIC CONTROL AS NECESSARY TO MAINTAIN ACCESS TO ALL PRIVATE AND FIELD ENTRANCES.

- SYMBOLS**
- DRUM WITH STEADY BURNING LIGHT
  - ◑ TRAFFIC SIGNAL
  - INDUCTION LOOP DETECTOR
  - ▨ DOUBLE VERTICAL PANEL
  - ◇ TYPE C BIDIRECTIONAL REFLECTOR
  - STEADY BURNING LIGHTS AND DOUBLE VERTICAL PANELS
  - ▭ TEMPORARY CONCRETE BARRIER
  - ▨ IMPACT ATTENUATOR TEMP., (FULLY REDIRECTIVE), TEST LEVEL 2
  - ▭ TYPE III BARRICADE
  - ▨ WORK AREA

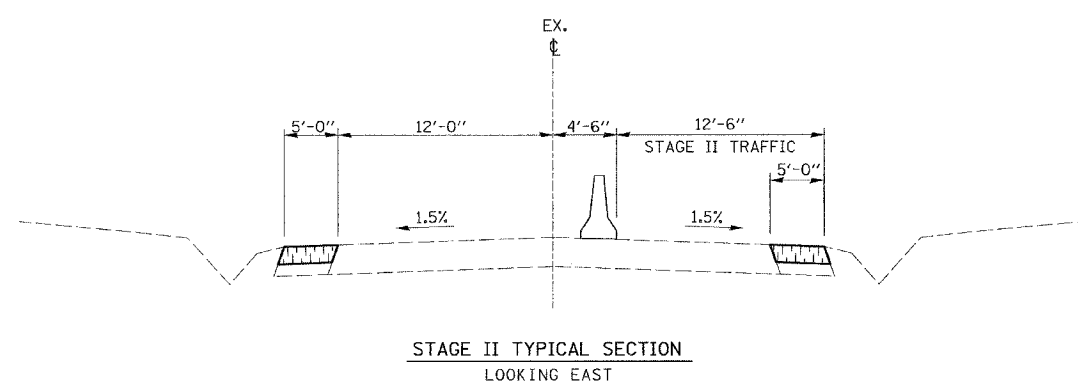

REVISIONS	
NAME	DATE

ILLINOIS DEPARTMENT OF TRANSPORTATION  
 STAGE II TRAFFIC CONTROL  
 STANDARD 701321

F.A.P. RTE. 693  
 SECTION (119B-3)I  
 TAZEWELL COUNTY

SCALE: NONE  
 DATE: 03/24/2006

DRAWN BY: KBF  
 CHECKED BY: AJE

PLOT DATE: \*DATE-TIME\*