

WHEN "A" IS 1.067 METERS OR LESS, THE TEMPORARY CONCRETE BARRIER SHALL BE ANCHORED TO THE NEW SLAB ACCORDING TO DETAIL I OR DETAIL II. NO ANCHORAGE IS REQUIRED WHEN "A" IS GREATER THAN 1.067 METERS.

SEE DETAIL I OR DETAIL II. DRILL 30 mm  $\phi$  HOLES IN EXISTING SLAB FOR 25 mm  $\phi$  x 280 mm DOWEL BARS. TRAFFIC SIDE ONLY. COST INCLUDED WITH TEMPORARY CONCRETE BARRIER.

**SECTIONS THRU SLAB**

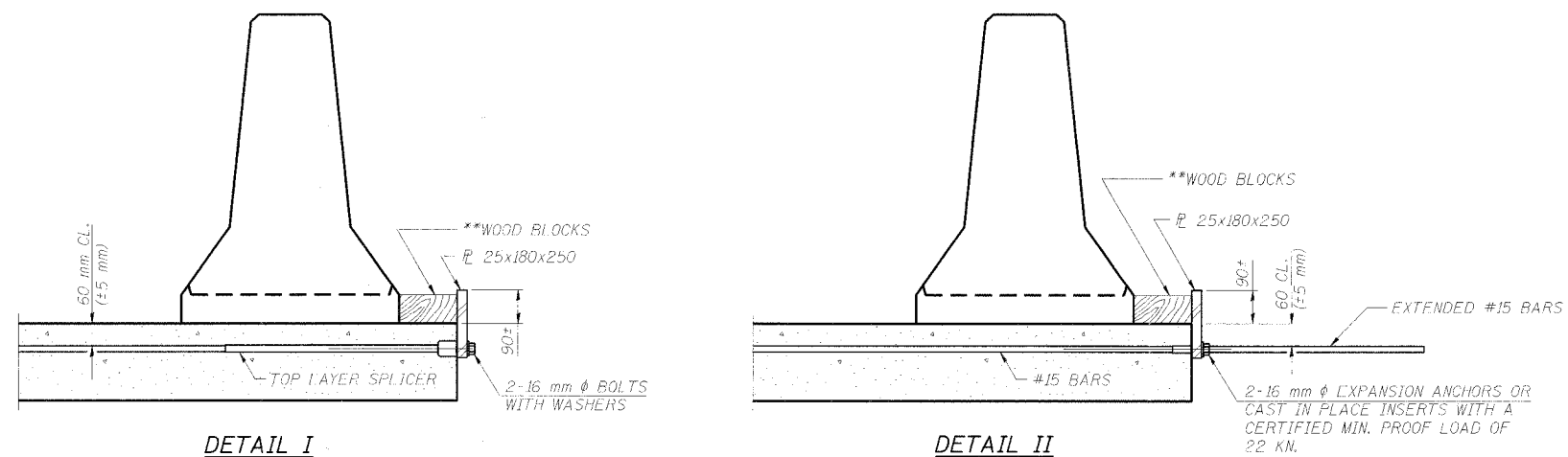

\*\* WOOD BLOCKS MAY BE OMITTED WHEN REQUIRED TO PROVIDE MINIMUM STAGE TRAFFIC LANE WIDTH. WHEN THE WOOD BLOCKS ARE OMITTED, THE CONCRETE BARRIER SHALL BE IN DIRECT CONTACT WITH THE STEEL RETAINER PLATE.

**NOTES**

DETAIL I - WITH BAR SPLICER OR COUPLERS: CONNECT ONE (1) 25x180x250 STEEL  $\bar{L}$  TO THE TOP LAYER OF COUPLERS WITH 2-16 mm  $\phi$  BOLTS SCREWED TO COUPLER AT APPROXIMATE  $\phi$  OF EACH BARRIER PANEL.

DETAIL II - WITH EXTENDED REINFORCEMENT BARS: CONNECT ONE (1) 25x180x250 STEEL  $\bar{L}$  TO THE CONCRETE SLAB WITH 2-16 mm  $\phi$  EXPANSION ANCHORS OR CAST IN PLACE INSERTS SPACED BETWEEN THE TOP LAYER OF REINFORCEMENT AT APPROXIMATE  $\phi$  OF EACH BARRIER PANEL.

COST OF ANCHORAGE IS INCLUDED WITH TEMPORARY CONCRETE BARRIER. THE 25x180x250 PLATE SHALL NOT BE REMOVED UNTIL STAGE II CONSTRUCTION FORMS AND ALL REINFORCEMENT BARS ARE IN PLACE AND THE CONCRETE IS READY TO BE PLACED.

ALL DIMENSIONS ARE IN MILLIMETERS (mm) EXCEPT AS NOTED.

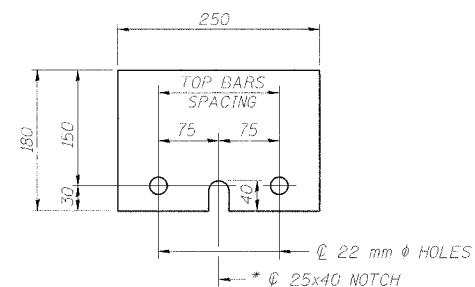

**STEEL RETAINER L 25x180x250**  
\* REQUIRED ONLY WITH DETAIL II

REVISIONS	
NAME	DATE

ILLINOIS DEPARTMENT OF TRANSPORTATION  
**TEMPORARY CONCRETE BARRIER FOR STAGE CONSTRUCTION**  
 ILLINOIS ROUTE 71 OVER AN INTERMITTENT STREAM  
 F.A.P. RT. 619 - SECTION 120 BR-1  
 PUTNAM COUNTY  
 STATION 9+268.500  
 STRUCTURE No. 078-2008

DATE: 11/21/06    DESIGNED BY: MW    DRAWN BY: KDS  
 CHECKED BY: SG    CHECKED BY: MW

**TRANSYSTEMS CORPORATION**  
100 PROGRESS DRIVE, SUITE 200  
 CHANDLER, ILLINOIS 60510-1000  
 TEL: (815) 465-2000  
 FAX: (815) 465-2001