

# BRIDGE NO 7- THIS STRUCTURE DELETED

F.A. RTE.	SECTION	COUNTY	TOTAL SHEETS	SHEET NO.
VAR	D4 BRDG PNT 07	VARIOUS	17	16
STA.		TO STA.		
FED. ROAD DIST. NO. 4		ILLINOIS		

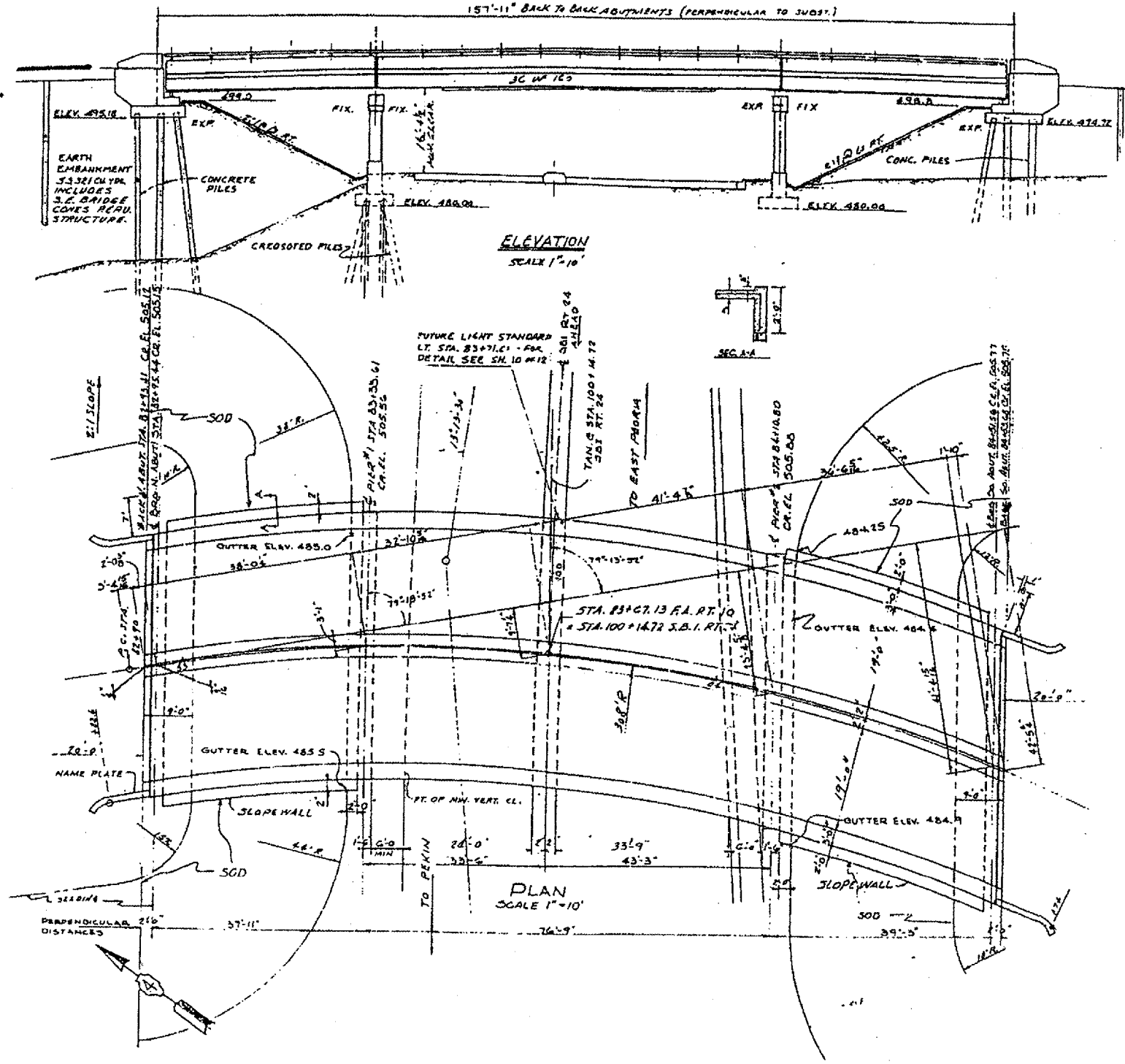

FOR  
INFORMATION ONLY

ILLINOIS DEPARTMENT OF TRANSPORTATION  
BRIDGE NO 7  
PLAN & ELEVATION

DATE 07-26-2006 DRAWN BY