

STATE OF ILLINOIS  
DEPARTMENT OF TRANSPORTATION

ROUTE NO.	SECTION	COUNTY	TOTAL SHEETS	SHEET NO.
FA 645		MARSHALL	9	6
FED. ROAD DIST. NO. 7	ILLINOIS	FED. AID PROJECT		

SHEET NO. 1  
4 SHEETS

Contract Number: 68696

**GENERAL NOTES**

Plan dimensions and details relative to existing plans are subject to routine variations. The Contractor shall field verify existing dimensions and details affecting new construction and make necessary approved adjustments prior to construction or ordering of materials. Such variations shall not be cause for additional compensation for a change in scope of the work, however, the Contractor will be paid for the quantity actually furnished based upon the unit price bid for the work.

Any damage done to the bridge during beam removal shall be repaired by the Contractor. Cost to be included in the cost of "Removal of Existing PPC Deck Beams".

The top surface of the beams shall be finished according to the IDOT Manual for Fabrication of Precast Prestressed Concrete Products.

The cut strands at each beam end shall be given two coats of zinc dust spray or paint meeting the requirements of ASTM A780. The zinc dust spray or paint shall be applied before corrosion appears and allowed to dry according to manufacturer's specifications prior to another coat of zinc. This work shall be performed by the producer and included with the cost of the beam.

A concrete sealer meeting the requirements of Section 587 of the Standard Specifications shall be applied to the exterior face & 9" on the underside of the fascia beams. The sealer shall be applied after visible crack growth has subsided. Cost included with PPC Deck Beams.

Temporary concrete barrier shall only be anchored into the overlay and not the PPC Deck Beams.

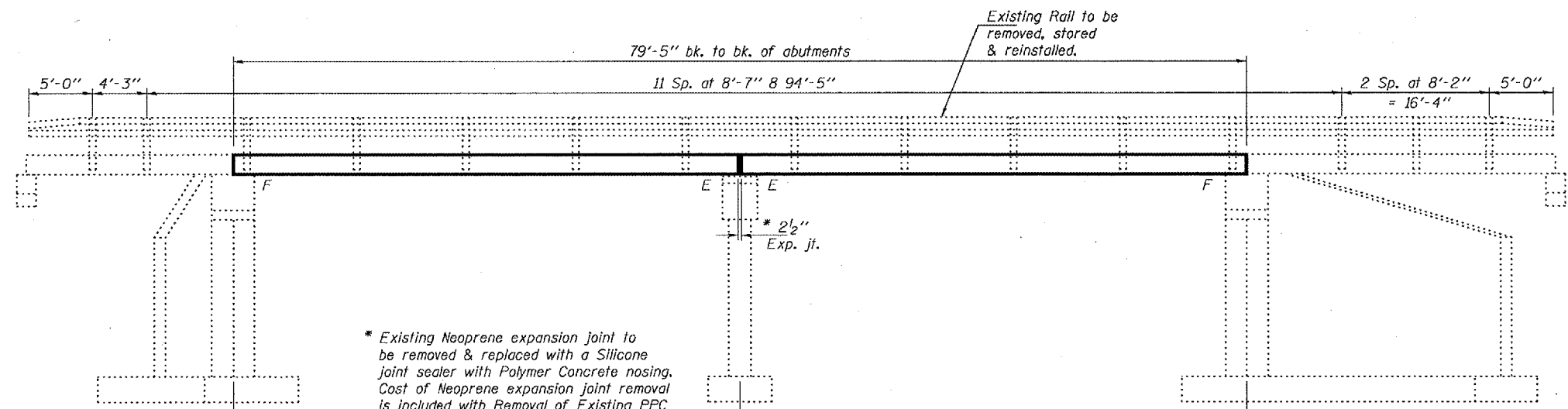

\* Existing Neoprene expansion joint to be removed & replaced with a Silicone joint sealer with Polymer Concrete nosing. Cost of Neoprene expansion joint removal is included with Removal of Existing PPC Deck Beams.

**ELEVATION**

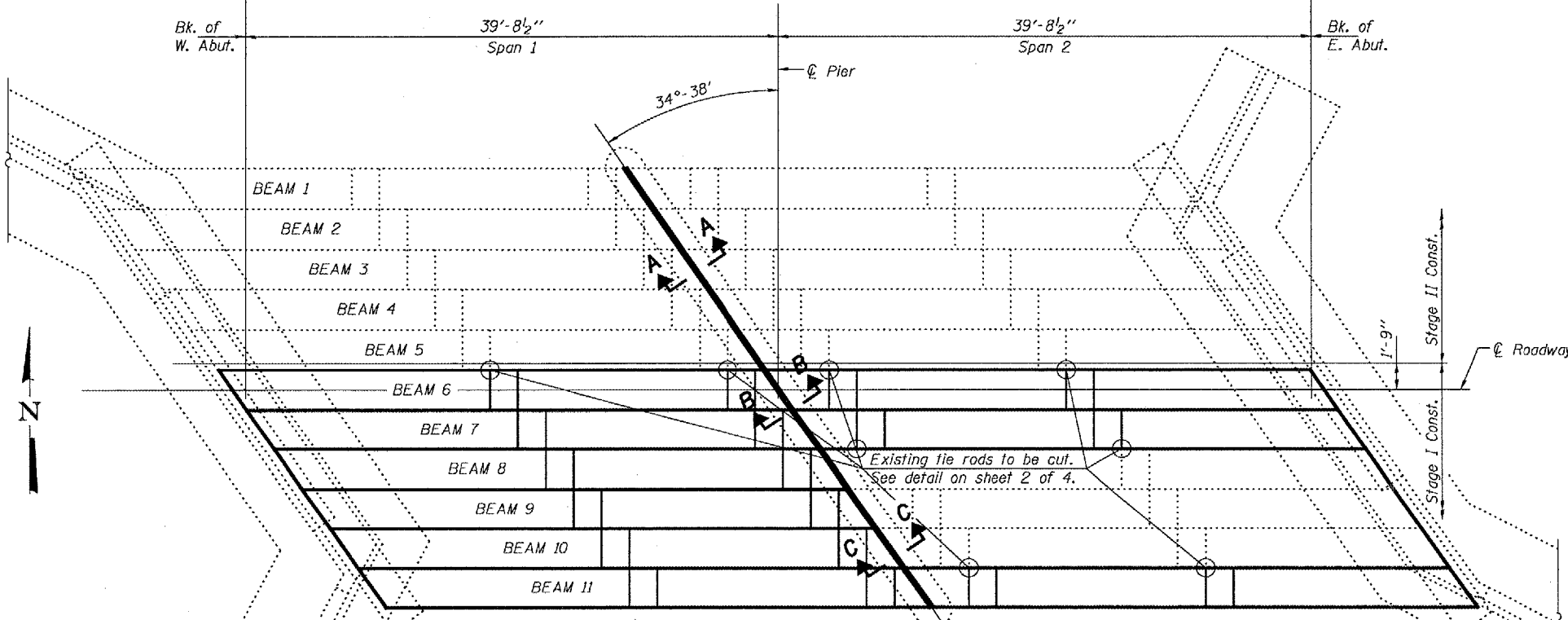

**FRAMING PLAN**

For Sections A-A, B-B & C-C  
see sheet 3 of 4.

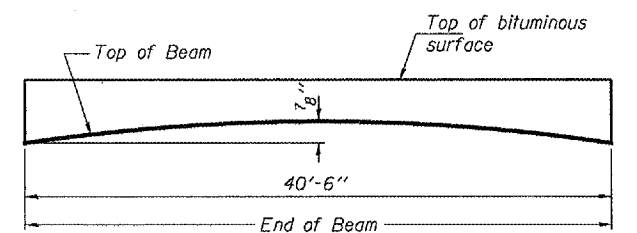

**ANTICIPATED INITIAL CAMBER DIAGRAM**

**TOTAL BILL OF MATERIAL**

ITEM	UNIT	QUANTITY
* HMA Surface Course, Mix "D" N50	Tons	25.2
* HMA Surface Removal	Sq. Yd.	45
Removal of Existing PPC Deck Beams	Sq. Ft.	1095
Precast Prestressed Concrete Deck Beams (17" Depth)	Sq. Ft.	1091
* Waterproofing Membrane System	Sq. Yd.	168
PC Mortar Fairing Course	Foot	406
Silicone Joint Sealer	Foot	40
Polymer Concrete	Cu. Ft.	4.9
Removing and Re-erecting Existing Railing	Foot	79
Asbestos Bearing Pad Removal	Each	9

\* Includes quantity for work over Beams 8, 9 & 10 in Span 2.

**PLAN AND ELEVATION**  
**FA 645 OVER SENACHWINE CREEK**  
**MARSHALL COUNTY**  
**SN 062-0016**

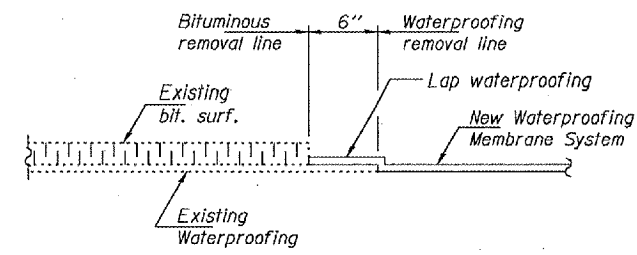

**WATERPROOFING TREATMENT**

**DESIGN STRESSES**  
**PRESTRESS UNITS**

f'c = 5,000 psi  
f'cl = 4,000 psi  
f's = 270,000 psi (1/2" low lax strands)  
f'si = 201,960 psi (1/2" low lax strands)

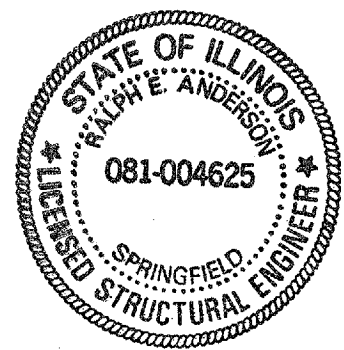

DESIGNED: Victor H. Veltz December 4, 2006  
CHECKED: [Signature] EXAMINED: John A. Morris  
DRAWN: baliva PASSED: Ralph E. Anderson  
CHECKED: SJB VHV